

City of Detroit
**City Engineering Division, Department of Public Works
Survey Bureau**

NOTICE OF PROPOSED CHANGE IN PROPERTY

Date: 01/14/2019

Petition: x639

- | | |
|--|---|
| <input type="checkbox"/> AT&T Telecommunication | <input type="checkbox"/> Berm Use |
| <input type="checkbox"/> Comcast Television (CATV) | <input type="checkbox"/> Conversion to Easement |
| <input type="checkbox"/> Detroit Edison (DTE) | <input type="checkbox"/> Dedication |
| <input type="checkbox"/> Fire Department | <input type="checkbox"/> Encroachment |
| <input type="checkbox"/> Great Lakes Water Authority | <input checked="" type="checkbox"/> Outright Vacation |
| <input type="checkbox"/> Land Bank Authority | <input type="checkbox"/> Temporary Closing |
| <input type="checkbox"/> Michcon (DTE) | |
| <input type="checkbox"/> Planning & Development Department | |
| <input type="checkbox"/> Public Lighting Authority | |
| <input type="checkbox"/> Public Lighting Department | |
| <input type="checkbox"/> Police Department | |
| <input type="checkbox"/> Solid Waste Division, DPW | |
| <input type="checkbox"/> Street Design Bureau, DPW | |
| <input type="checkbox"/> Street Maintenance Division, DPW | |
| <input type="checkbox"/> Traffic Engineering Division, DPW | |
| <input type="checkbox"/> Water and Sewerage Department | |
| <input type="checkbox"/> _____ | |

A petition drawing is attached. Property shown on the attached print is proposed to be changed as indicated. Kindly report (using the back of this sheet) the nature of your services, if any affected by the proposed change and the estimated costs of removing and rerouting such services (if necessary).

Please return one copy to City Engineering Division, DPW within two weeks of the submittal date. Retain one copy and print for you file.

Ron Brundidge, Director, Department of Public Works

By: Richard Doherty, CED DPW
City Engineer

**TO: City Engineering Division, DPW
2 Woodward Ave., Suite 642
Detroit, Michigan 48226-3462
Survey Bureau: 313-224-3970**

Petition: x639

The proposed change in property (referred to on the other side of this sheet) would affect our services as follows:

- Not Involved

- Involved; but asking you to hold action on this petition until further notice.

- Involved; but no objections to the property change.

- Involved; objection to the property change.

- Involved; but no objections to the property change...provided as easement of the full width of the public right-of-way (street, alley or other public place) is reserved.

- Involved; the nature of our services and the estimated costs of removing and/or rerouting such services are:

PUBLIC LIGHTING

(Utility or City Department)

By 

DIRECTOR

Title

Date 3/24/19

(313) 267-5130

Area code – Telephone number

PETITION NO. 639
 POPE FRANCIS CENTER (C/O RXMC CONSULTING, LLC)
 3769 E. CANFIELD ST.
 DETROIT, MICHIGAN 48226
 ROCH X. MCCLAIN
 PHONE NO. (313) 949-3560



ELLERY ST. 60 FT. WD.

CANFIELD AVE. 60 FT. WD.

GARFIELD AVE. 60 FT. WD.

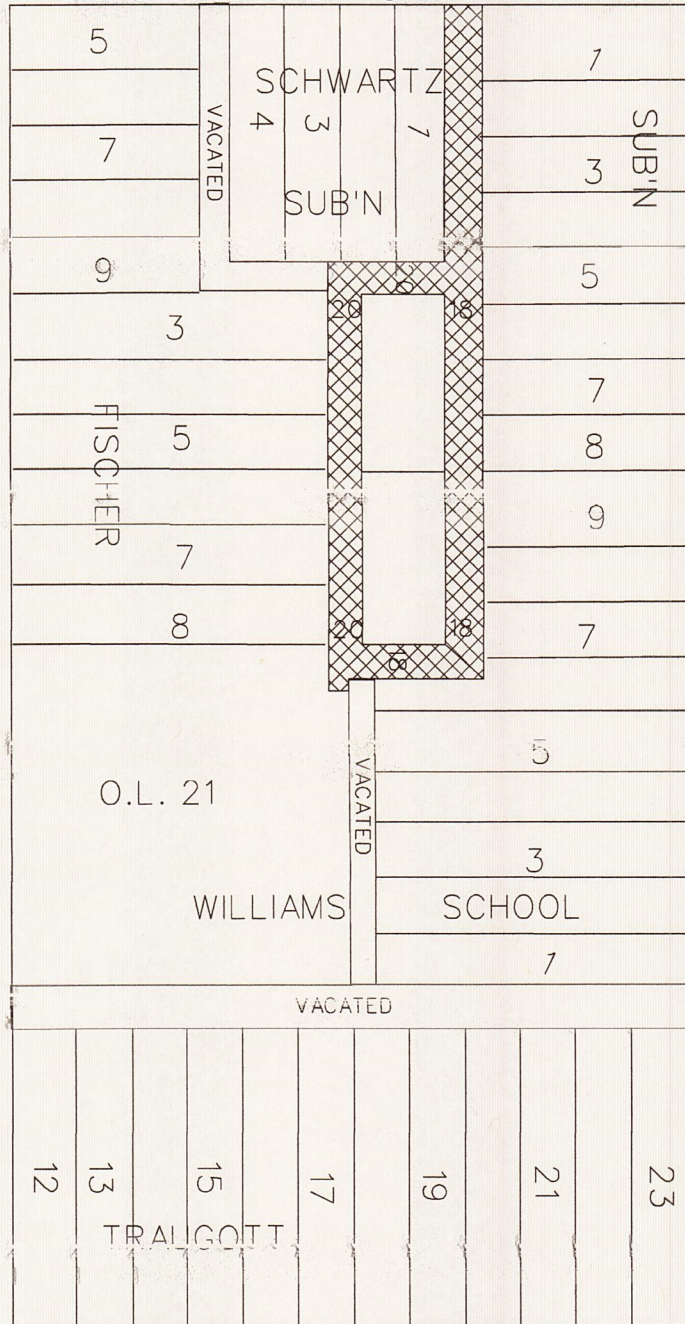

MT. ELLIOTT AVE. 60 FT. WD.



- OUTRIGHT VACATION

(FOR OFFICE USE ONLY)

CARTO 40 F

B					
A					
DESCRIPTION	DRWN	CHKD	APPD	DATE	
REVISIONS					
DRAWN BY	SA	CHECKED	KSM		
DATE	01-14-19	APPROVED			

REQUEST TO OUTRIGHT VACATE
 VARIOUS PUBLIC ALLEYS, VARIOUS WIDTHS
 BOUND BY
 ELLERY ST., GARFIELD AVE., MT. ELLIOTT AVE.,
 AND CANFIELD AVE.

CITY OF DETROIT CITY ENGINEERING DIVISION SURVEY BUREAU	
JOB NO.	01-01
DRWG. NO.	X 639



GARFIELD

86'
2-3"

6545

**AREA OF PROPOSED
OUTRIGHT VACATION**

WILLIAMS
SCHOOL
(VACATED)

M.F.R.

4-3"

2-4"

6545

2-4"

60'
2-3"

C.F.

MT. ELLIOTT

NO PUBLIC LIGHTING UTILITIES IN AREA

CANFIELD

PETITION x639

ELLERY