

PETITION NO. 1149
 JUAN ROMO
 1930 SPRINGWELLS ST
 DETROIT, MICHIGAN 48209
 PHONE NO. (313) 415-2703

SPRINGWELLS AVE.
 66 FT. WD.

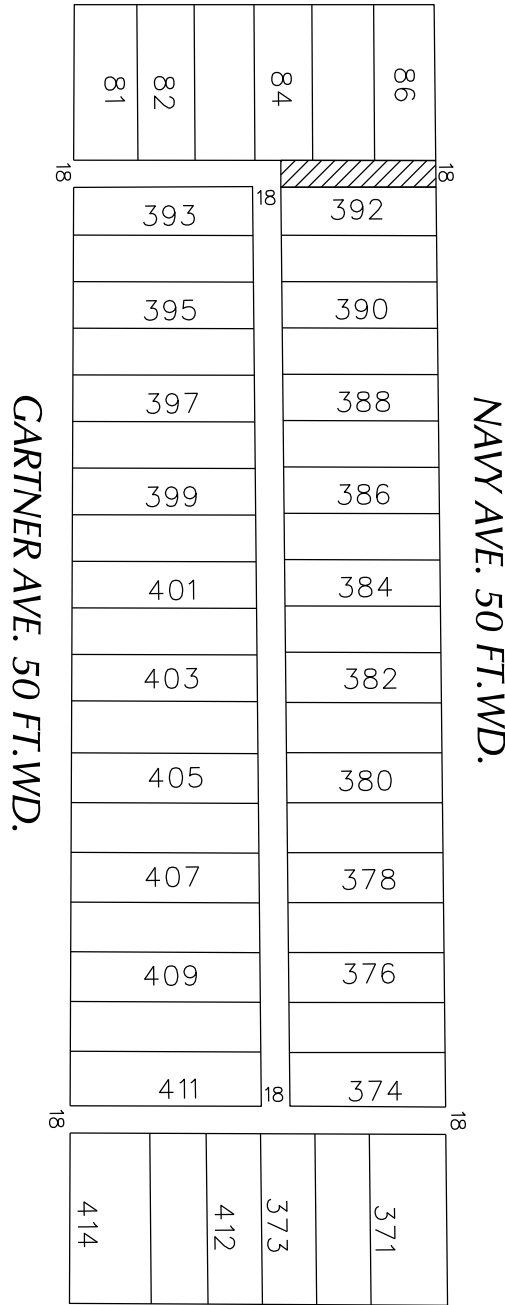

CENTRAL AVE.
 60 FT. WD.

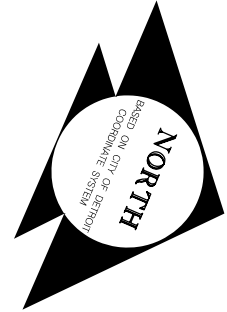

- CONVERSION TO EASEMENT

(FOR OFFICE USE ONLY)

CARTO 2 A

B					
A					
DESCRIPTION	DRWN	CHKD	APPD	DATE	
REVISIONS					
DRAWN BY	SA	CHECKED	KSM		
DATE	11-25-19	APPROVED			

CONVERSION TO EASEMENT
 THE NORTH/WEST SECTION OF PUBLIC ALLEY,
 18 FT. WD. IN THE BLOCK BOUND BY
 GARTNER AVE., SPRINGWELLS AVE. ,
 NAVY AVE. AND CENTRAL AVE.

CITY OF DETROIT CITY ENGINEERING DIVISION SURVEY BUREAU	
JOB NO.	01-01
DRWG. NO.	X 1149