

TO: City Engineering Division, DPW
2 Woodward Avenue
Suite 642
Detroit, Michigan 48226-3462
Survey Bureau: 313-224-3970

Petition No. 1148

The proposed change in property (referred to above) would affect our services as follows:

- () Not Involved.
- () Involved; but asking you to hold action on this petition until further notice.
- () Involved; the nature of our services, and the estimated costs of removing and/or rerouting such services are:
- (X) Involved; have no objection to request for encroachment into Second Ave. at 4128 Second Ave as shown on drawing number X1148 dated 12/11/2019 provided that the Petitioner shall maintain a minimum clear height of 8 feet and 6 inches from the ground/sidewalk level to underneath the proposed aerial encroachment.

Traffic Engineering Division - DPW
(Utility or City Department)

Ashok Patel
By

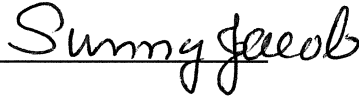

City Traffic Engineer
Title

January 07, 2020
Date

313 224-1610
Area code-Telephone number

AA/aa

PETITION NO. 1148
 HEIRLOOM HOSPITALITY GROUP
 C/O PARKSTON DEVELOPMENT PARTNERS
 28 W ADAMS AVE. SUITE 1300
 DETROIT, MICHIGAN 48226
 JANELLE BULAT
 PHONE NO. (313) 636-1518



CASS AVE. 80 FT. WD

WILLIS AVE. 100 FT. WD.

ALEXANDRINE AVE. 100 FT. WD.

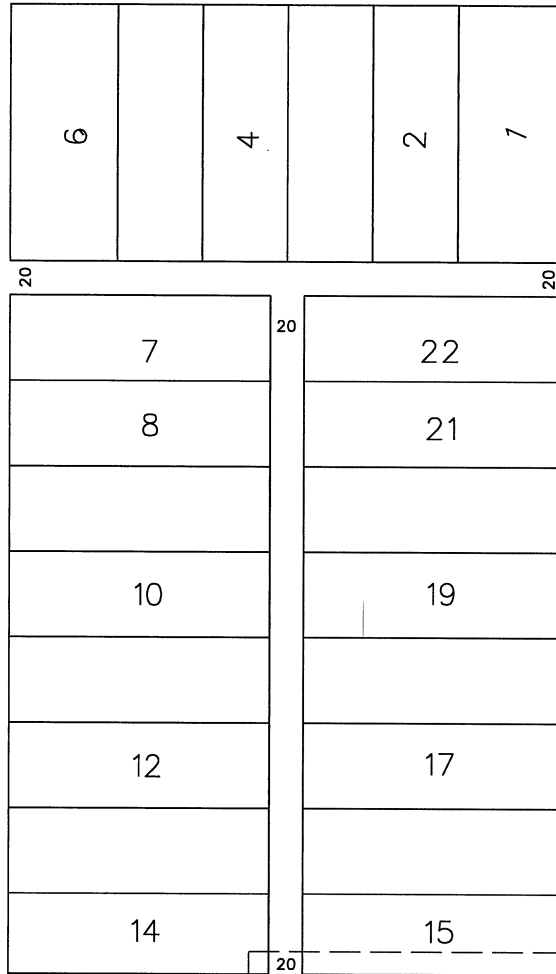

SECOND BLVD. 100 FT. WD.

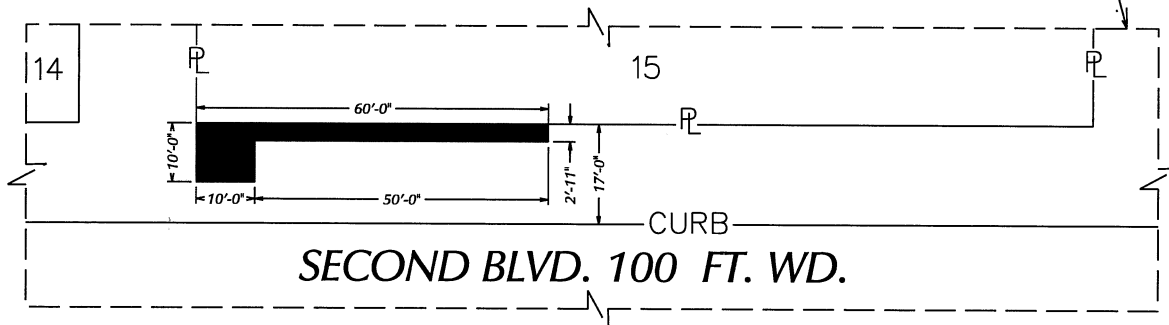

- REQUEST ENCROACHMENT

(FOR OFFICE USE ONLY)

CARTO 30 E

B					
A					
DESCRIPTION		DRWN	CHKD	APPD	DATE
REVISIONS					
DRAWN BY	SA	CHECKED		KSM	
DATE	12-11-19	APPROVED			

REQUEST ENCROACHMENT
 INTO SECOND AVE.
 AT 4128 SECOND AVE.

CITY OF DETROIT	
CITY ENGINEERING DIVISION	
SURVEY BUREAU	
JOB NO.	01-01
DRWG. NO.	X 1148