

TO: City Engineering Division, DPW
2 Woodward Ave., Suite 642
Detroit, MI 48226-3462
Survey Bureau: 313-224-3970

Petition No.1100

The proposed change in property (referred to above) would affect our services as follows:

- () Not Involved.
- () Involved; but asking you to hold action on this petition until further notice.
- () Involved; the nature of our services, and the estimated costs of removing and/or rerouting such services are:
- (X) Involved; have no objection to request for the conversion to easement the public alleys in the area bounded by Helen Ave., Frederick Ave., E. Grand Boulevard and Theodore Ave. as shown on drawing no. X1100 dated 10/03/19 provided that 100% signatures of abutting property owners are secured.

Traffic Engineering Division - DPW
(Utility or City Department)

Ashok Patel
By

Sunny jacob

City Traffic Engineer
Title

October 16, 2019
Date

313 224-1610
Area code-Telephone number

Aa/aa

PETITION NO. 1100
 THE EL-BETH-EL DEL MIN,
 7040 RARNSWORTH AVE
 DETROIT, MICHIGAN 48211
 PHONE NO. (313) 897-6543



FREDERICK AVE. 60 FT. WD.

HELEN AVE. 60 FT. WD.

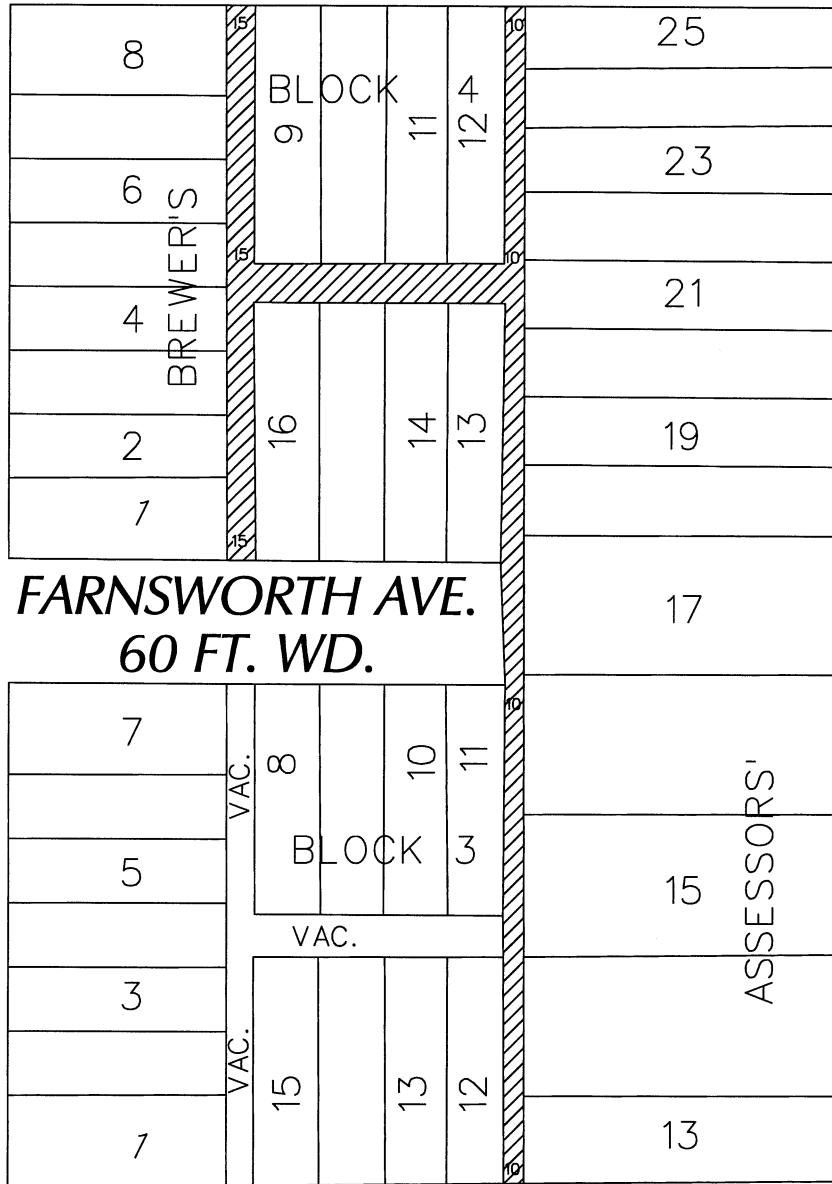

FARNSWORTH AVE.
 60 FT. WD.

GRAND BOULEVARD E. 150 FT. WD.

THEODORE AVE. 50 FT. WD.



- CONVERSION TO EASEMENT

(FOR OFFICE USE ONLY)

CARTO 48 C

B					
A					
DESCRIPTION		DRWN	CHKD	APPD	DATE
REVISIONS					
DRAWN BY	SA	CHECKED		KSM	
DATE	10-03-19	APPROVED			

CONVERSION TO EASEMENT
 PUBLIC ALLEYS, IN THE AREA BOUND BY
 HELEN AVE., FREDERICK AVE.,
 E. GRAND BOULEVARD
 AND THEODORE AVE.

CITY OF DETROIT CITY ENGINEERING DIVISION SURVEY BUREAU	
JOB NO.	01-01
DRWG. NO.	X 1100