

**City of Detroit  
City Engineering Division, Department of Public Works  
Survey Bureau**

**NOTICE OF PROPOSED CHANGE IN PROPERTY**

**Date:** 10/8/2019

**Petition:** x1076

- |  |  |
|--|--|
| <input type="checkbox"/> AT&T Telecommunication            |  |
| <input type="checkbox"/> Comcast Television (CATV)         | <input type="checkbox"/> Berm Use                          |
| <input type="checkbox"/> Detroit Edison (DTE)              |  |
| <input type="checkbox"/> Fire Department                   | <input checked="" type="checkbox"/> Conversion to Easement |
| <input type="checkbox"/> Great Lakes Water Authority       |  |
| <input type="checkbox"/> Land Bank Authority               | <input type="checkbox"/> Dedication                        |
| <input type="checkbox"/> Michcon (DTE)                     |  |
| <input type="checkbox"/> Planning & Development Department | <input type="checkbox"/> Encroachment                      |
| <input type="checkbox"/> Public Lighting Authority         |  |
| <input type="checkbox"/> Public Lighting Department        | <input type="checkbox"/> Outright Vacation                 |
| <input type="checkbox"/> Police Department                 |  |
| <input type="checkbox"/> Solid Waste Division, DPW         | <input type="checkbox"/> Temporary Closing                 |
| <input type="checkbox"/> Street Design Bureau, DPW         |  |
| <input type="checkbox"/> Street Maintenance Division, DPW  |  |
| <input type="checkbox"/> Traffic Engineering Division, DPW |  |
| <input type="checkbox"/> Water and Sewerage Department     |  |
| <input type="checkbox"/> _____                             |  |

A petition drawing is attached. Property shown on the attached print is proposed to be changed as indicated. Kindly report (using the back of this sheet) the nature of your services, if any affected by the proposed change and the estimated costs of removing and rerouting such services (if necessary).

Please return one copy to City Engineering Division, DPW within two weeks of the submittal date. Retain one copy and print for you file.

Ron Brundidge, Director, Department of Public Works

By: Richard Doherty, CED DPW  
City Engineer

**TO: City Engineering Division, DPW  
2 Woodward Ave., Suite 642  
Detroit, Michigan 48226-3462  
Survey Bureau: 313-224-3970**

**Petition: x 1076**

The proposed change in property (referred to on the other side of this sheet) would affect our services as follows:

Not Involved

Involved; but asking you to hold action on this petition until further notice.

Involved; but no objections to the property change.

Involved; objection to the property change.

Involved; but no objections to the property change...provided as easement of the full width of the public right-of-way (street, alley or other public place) is reserved.

Involved; the nature of our services and the estimated costs of removing and/or rerouting such services are:

AT+T  
(Utility or City Department)

Angela Wesson  
By

Row Manager  
Title

Oct 21, 2019  
Date

248 877 9518  
Area code – Telephone number

PETITION NO. 1076  
 KAREEM HOPKINS  
 19274 MITCHELL ST.  
 DETROIT, MICHIGAN 48234  
 PHONE NO. (313) 826-2438



EMERY AVE. 50 FT.WD.

MITCHELL ST. 50 FT.WD.

CHAREST AVE. 50 FT.WD.

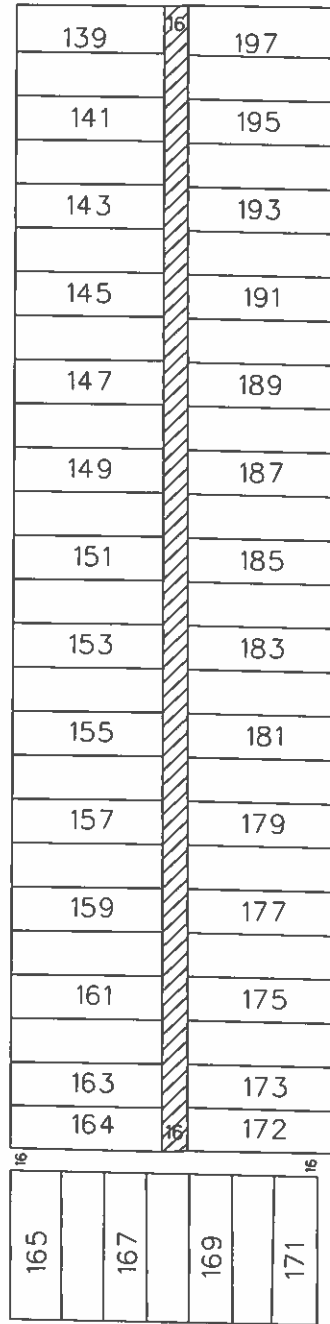

SEVEN MILE ROAD  
 E. 66 FT.WD.

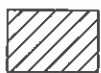

- CONVERSION TO EASEMENT

(FOR OFFICE USE ONLY)

CARTO 91 E

<b>B</b>					
<b>A</b>					
DESCRIPTION	DRWN	CHKD	APPD	DATE	
REVISIONS					
DRAWN BY	SA	CHECKED	KSM		
DATE	10-07-19	APPROVED			

CONVERSION TO EASEMENT  
 THE NORTH/SOUTH PUBLIC ALLEY, 16 FT. WD.  
 IN THE BLOCK BOUND BY  
 MITCHELL ST., EMERY AVE.,  
 CHAREST AVE. AND SEVEN MILE ROAD .

<b>CITY OF DETROIT</b> CITY ENGINEERING DIVISION SURVEY BUREAU	
JOB NO.	01-01
DRWG. NO.	X 1076