

**City of Detroit**  
OFFICE OF THE CITY CLERK

Janice M. Winfrey  
City Clerk

Andre P. Gilbert II  
Deputy City Clerk

**DEPARTMENTAL REFERENCE COMMUNICATION**

*Friday, August 16, 2019*

*To: The Department or Commission Listed Below*

*From: Janice M. Winfrey, Detroit City Clerk*

---

The following petition is herewith referred to you for report and recommendation to the City Council.

In accordance with that body's directive, kindly return the same with your report in duplicate within four (4) weeks.

---

PLANNING AND DEVELOPMENT DEPARTMENT    DPW - CITY ENGINEERING DIVISION

**1043**    *Trinity Investments Limited LLC, request to vacate and convert to subsurface easement Townsend between Medbury and Hendrie*



1043

August 7, 2019

**The Honorable City Council**

Attn: Office of the City Clerk  
200 Coleman A. Young Municipal Center  
2 Woodward Avenue  
Detroit, Michigan 48226

**RE: Petition to Vacate and Convert to Subsurface Easement Townsend between Medbury and Hendrie.**

The Honorable City Council:

On behalf of Trinity Investments Limited, LLC, we are petitioning the City of Detroit to:

**Vacate and convert to subsurface easement Townsend between Medbury and Hendrie as shown on attached Exhibit 1.**

This request on behalf of Trinity Investments Limited, LLC for the vacation and convert to a subsurface easement of Townsend is being proposed due to future construction activity planned on the former Kettering High School and Rose Middle School Sites. The development will include a 632,500 sf. light industrial building with parking. All of the property adjacent to Townsend is within the boundary of the future development.

This petition is for a vacation and conversion to a subsurface easement of Townsend within the limits shown on Exhibit 1.

Respectfully Submitted,

A handwritten signature in blue ink that reads "David A. Rzyzi".

David A. Rzyzi, PE  
The Mannik & Smith Group, Inc.

c: J. Knoll

Attachments: Exhibit 1

**TECHNICAL SKILL.  
CREATIVE SPIRIT.**

# EXHIBIT 1 – VACATE TOWNSEND R.O.W. AND CONVERT TO SUBSURFACE EASEMENT

– VACATE 60' TOWNSEND RIGHT-OF-WAY AND CONVERT TO SUBSURFACE EASEMENT BETWEEN HENDRIE AND MEDBURY

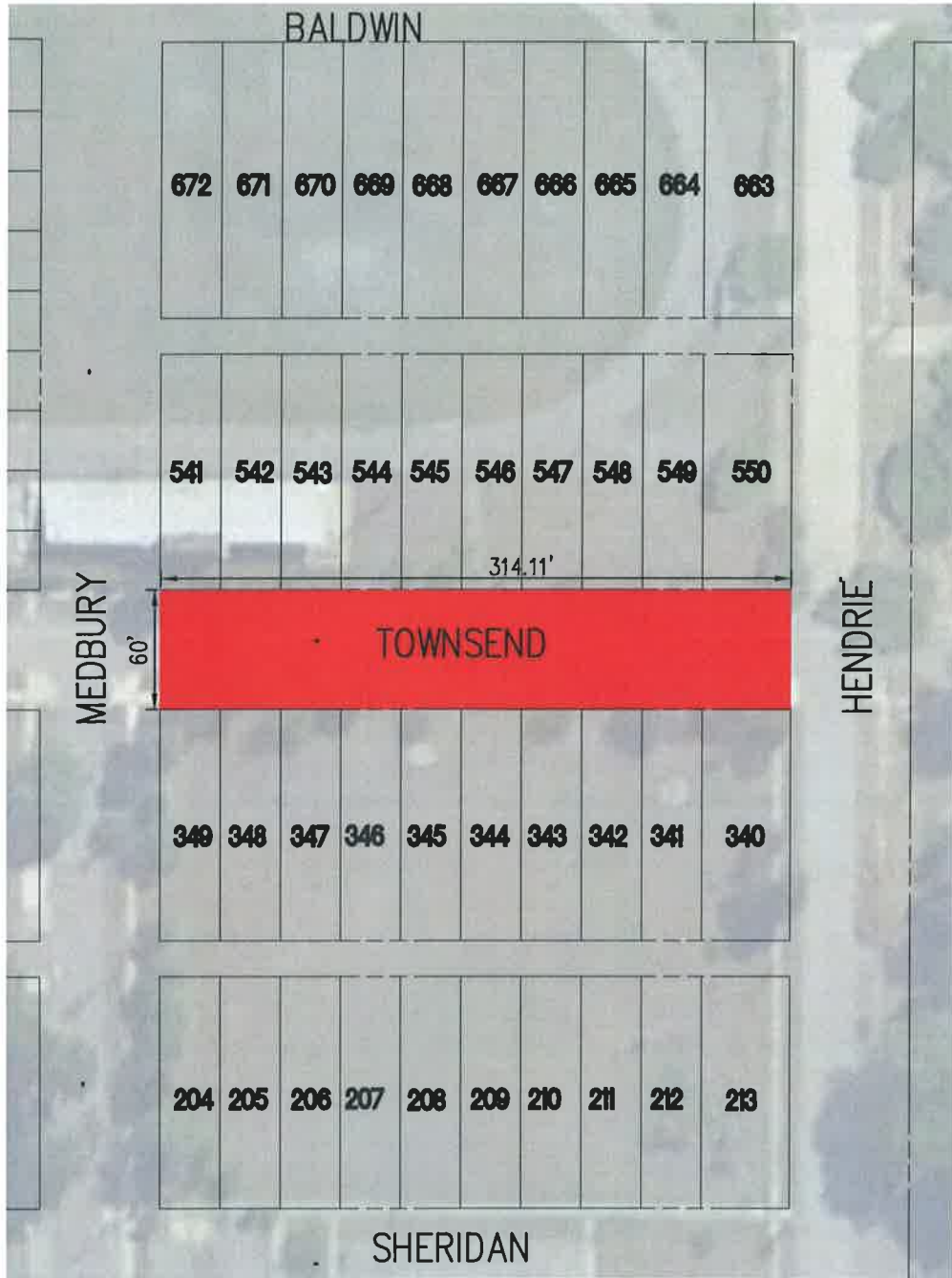

**LEGEND**

PROPOSED VACATE RIGHT-OF-WAY AND  
CONVERT TO SUBSURFACE EASEMENT

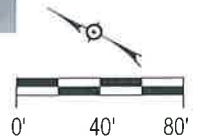

PREPARED BY:



PREPARED FOR:



KETTERING SITE REDEVELOPMENT  
CITY OF DETROIT

EXHIBIT 1

W:\SPLES\B\MS\CD\Map\Projects\U-2\1110410\AC\EXHIBITS\Subj\Essement\Vacate E\3501\Median Enh\6\_60x140.dwg - Last printed: 6/5/2019 2:05 PM

2019-08-09

**1043**

**1043** *Petition of Trinity Investments Limited  
LLC, request to vacate and convert to  
subsurface easement Townsend  
between Medbury and Hendrie*

---

REFERRED TO THE FOLLOWING DEPARTMENT(S)

PLANNING AND DEVELOPMENT DEPARTMENT    DPW -  
CITY ENGINEERING DIVISION