

Site Plan
SCALE: 1" = 20'-0"
1 INCH = 20'-0"
North

Mechanical, Plumbing and Electrical Notes:

ALL PLUMBING, ELECTRICAL AND MECHANICAL WORK TO BE DONE BY LICENSED CONTRACTORS AND PERMITS PULLED AS DESIGN BUILD

ELECTRICAL NOTES:
THE EXISTING ELECTRICAL PANELS ARE 200 AMP 208V/120V AC SERVICE

HVAC EQUIPMENT WILL BE ON THE ROOF OF THE BUILDING, NOT ON THE SITE ITSELF

SUMMARY: THE TOTAL FRESH AIR VENTILATION/MAKE UP REQUIRED IS 960 CFM WITH 3-4 CHANGES PER HOUR THE (2) 5 TON SYSTEM IS CAPABLE OF 2,000 CFM

Site Information:
Owner:
Hana Properties Investment, LLC
14400 Prairie Street
Detroit, MI 48238

Legal: S LYNDON N 149.35 FT OF W 252.43 FT
 219 ASSESSORS DETROIT PLAT NO 16
 L74 P24 PLATS, W C R 16/465 37700 SQ FT

Subdivision: 16 Census: 1 Tract: 536500 Lot: 219

ZONING: M4
 CURRENT USE: WAREHOUSE
 PROPOSED USE: MEICAL MARIHUANA GROWER & PROCESSOR CENTER -
 THIS IS A CONDITIONAL USE, THEREFORE A SPECIAL LAND USE & A HEARING IS REQUIRED

GROSS SITE AREA:
 Lot Size: 37,700 sqft .86 acres

Built in: 1957
 Parcel Number: 16005902011

PARKING REQUIRES 30 TOTAL SPACES

SF OF BLDG = 20,502

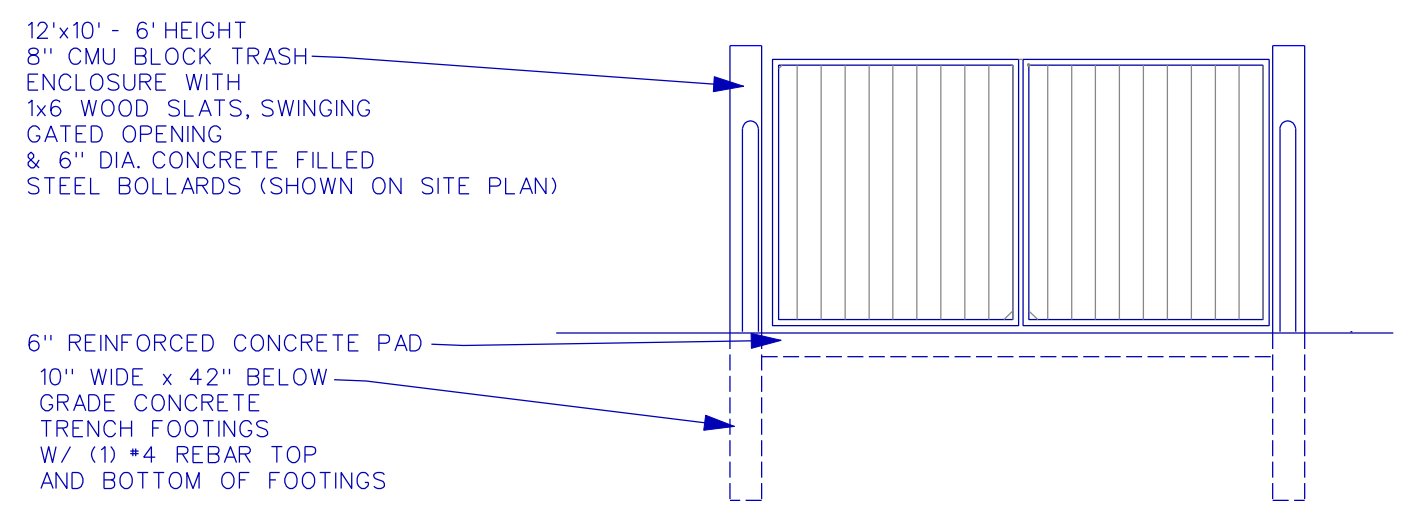
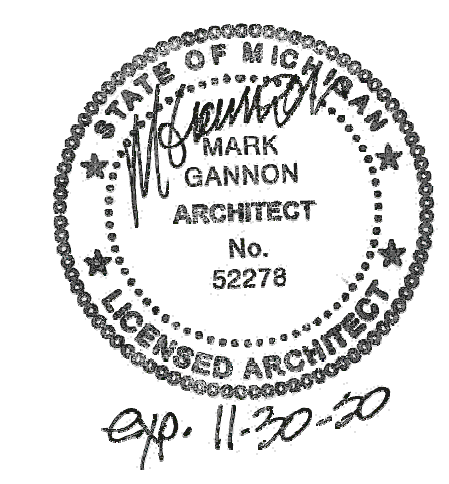

Dumpster Enclosure
(LOCATED ON SITE PLAN)
1/4" = 1'-0"

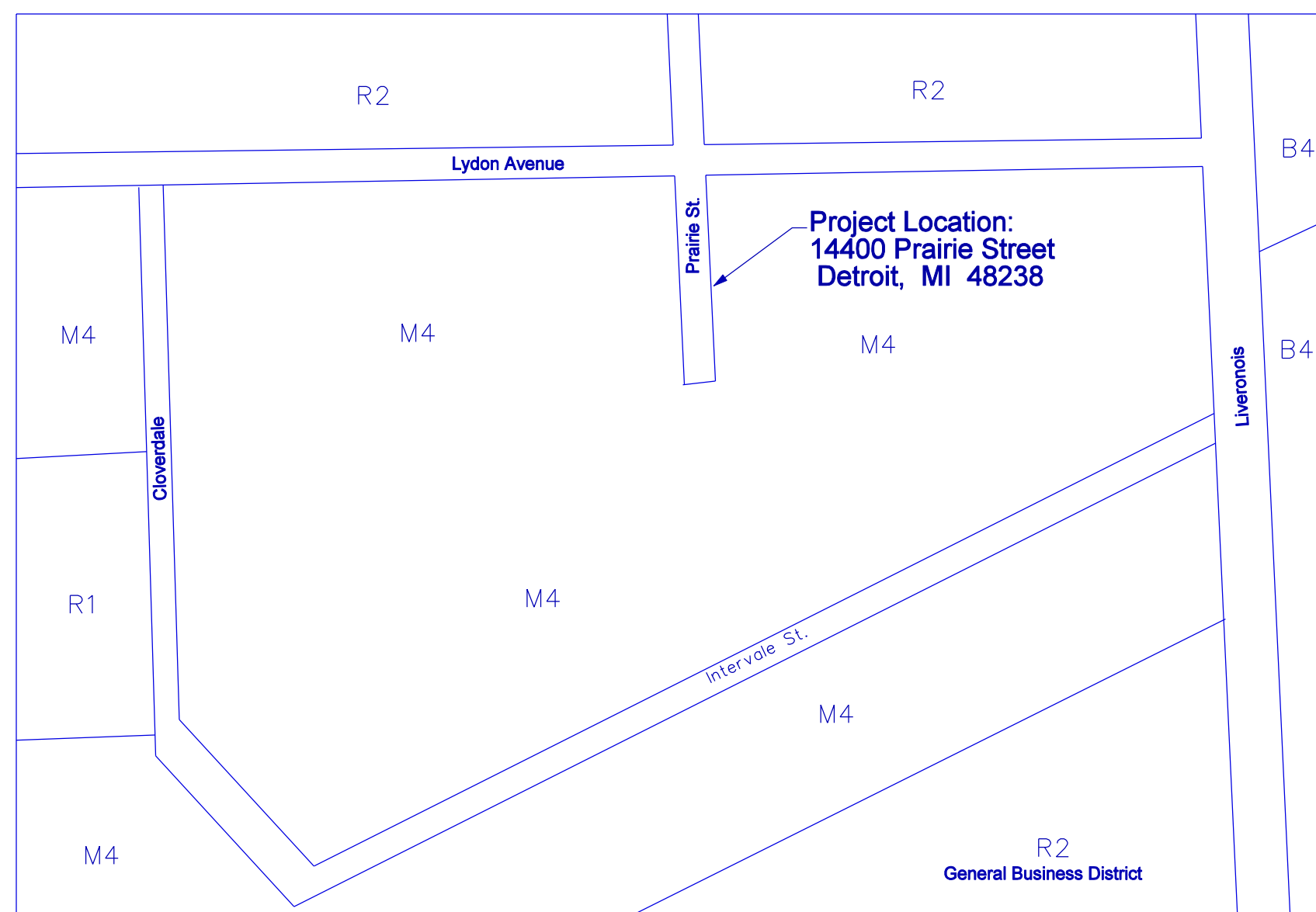

North **Adjacent / Zoning Map** n.t.s.



North **Location Map** n.t.s.

Prepared By: **Gannon Architecture, LLC**
 2041 Arbor Way Dr. N. #73
 mgannon_4@gannon.com
 Mark Gannon, Architect
 ph: 734-709-7568

Special Conditions Use - Site Plan

Project Address:
14400 Prairie Street
Detroit, MI 48238

Owner:
Michigan Caretaker Collective

Date: Dec. 3, 2016
 submittal

Rev. 1 Dec. 14, 2017

Rev. 2
 May 30, 2019

Sheet
1 of 3