

V:\18750-06D MCCH Brooklyn Elm Garage Addition Re-Design III\Drawing Files\Easements - ROW\Temple Street Drop Off Lane Easement\Temple Street Drop Off Lane Easement.dwg

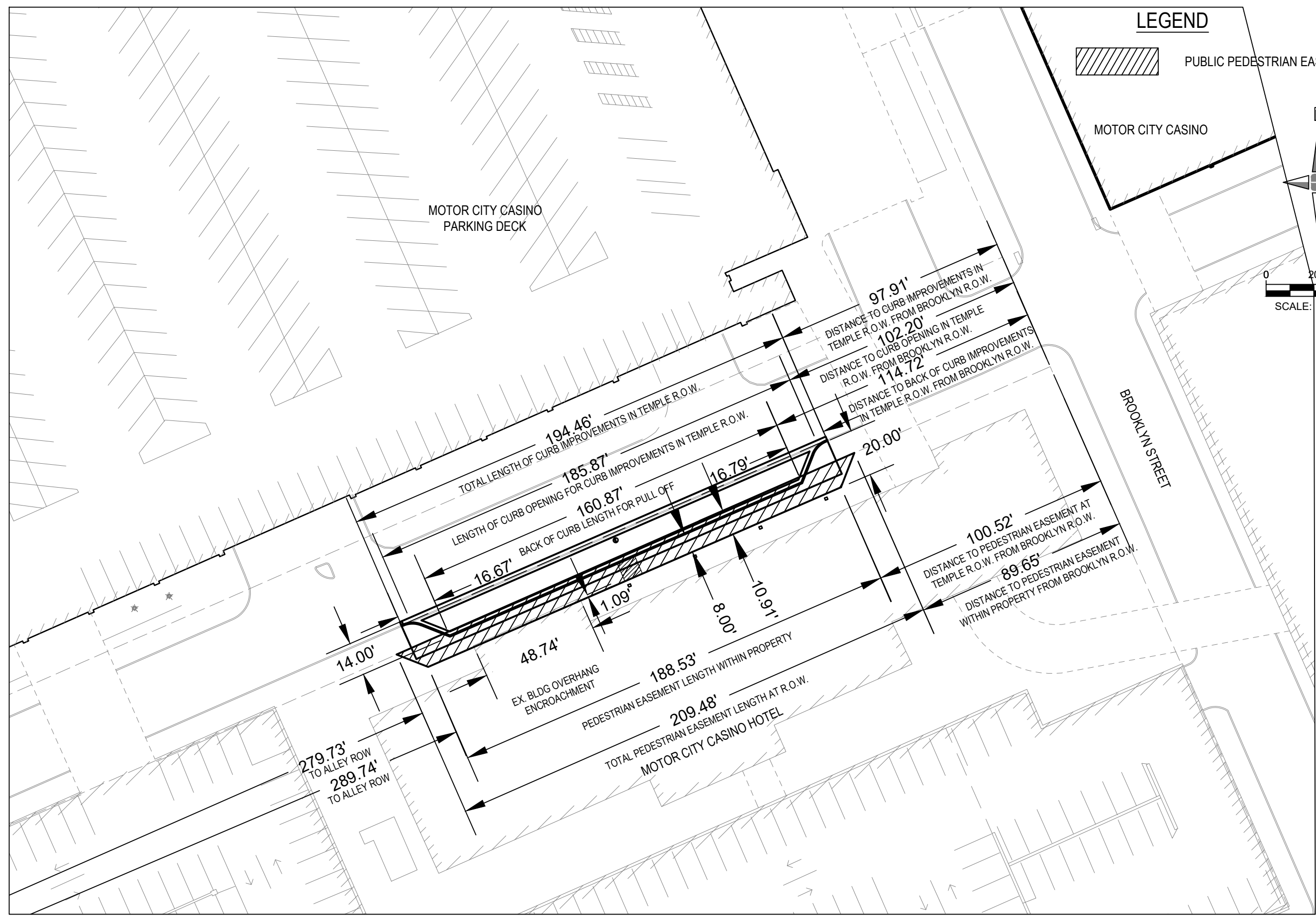

giffels webster

Engineers
Surveyors
Planners
Landscape Architects

28 West Adams Road
Suite 1200
Detroit, MI 48226
p (313) 962-4442
f (313) 962-5068
www.giffelswebster.com

Executive: M. Marks
Manager: D. Root
Designer: L. Overbeck
Quality Control: -
Section: Private Claim



Know what's below.
Call before you dig.

DATE:	ISSUE:
2019-07-09	City Council Petition
2019-09-04	Owner Review
2019-09-05	Revision Per Survey Bureau
2019-09-10	Revision Per Survey Bureau
2019-11-19	Revision Per Survey Bureau
2019-12-02	Revision Per Survey Bureau

Developed For:
MotorCity Casino Hotel
2901 GRAND RIVER
DETROIT, MI 48201

Pedestrian Easement Exhibit

TEMPLE STREET
DROP-OFF LANE

City of Detroit
County
MICHIGAN

Date: 06.13.2019
Scale: 1"=40'
Sheet: 01
Project: 18750-07D

Copyright © 2019 Giffels Webster.
No reproduction shall be made without the prior written consent of Giffels Webster.