

TO: City Engineering Division, DPW
2 Woodward Ave., Suite 642
Detroit, MI 48226-3462
Survey Bureau: 313-224-3970

Petition No. 595

The proposed change in property (referred to above) would affect our services as follows:

- () Not Involved.
- () Involved; but asking you to hold action on this petition until further notice.
- () Involved; the nature of our services, and the estimated costs of removing and/or rerouting such services are:
- (X) Involved; have no objection to request for a series of vacations and encroachments into the rights-of way within the block bounded by Elizabeth St., Woodward Ave., Adams Ave and park as shown on drawing no. X595 dated 12/12/18 and revised on 05/15/19 provided that 100% signatures of abutting property owners are secured and a minimum of 6 feet clear/unobstructed sidewalk is maintained in front of the proposed encroachments.

Traffic Engineering Division - DPW
(Utility or City Department)

Ashok Patel
By

Sunny Jacob

City Traffic Engineer
Title

June 26, 2019
Date

313 224-1610
Area code-Telephone number

SJ/aa

PETITION NO. 595
 CHEMICAL BANK
 2130 W. BIG BEAVER RD., TROY, MI 48084
 C/O GIFFELS WEBSTER
 28 W. ADAMS, SUITE 1200
 DETROIT, MICHIGAN 48226
 MICHAEL MARKS
 PHONE NO. (313) 962-4442

REVISION - B -



ELIZABETH ST. 60 FT. WD.

PARK AVE. 60 FT.

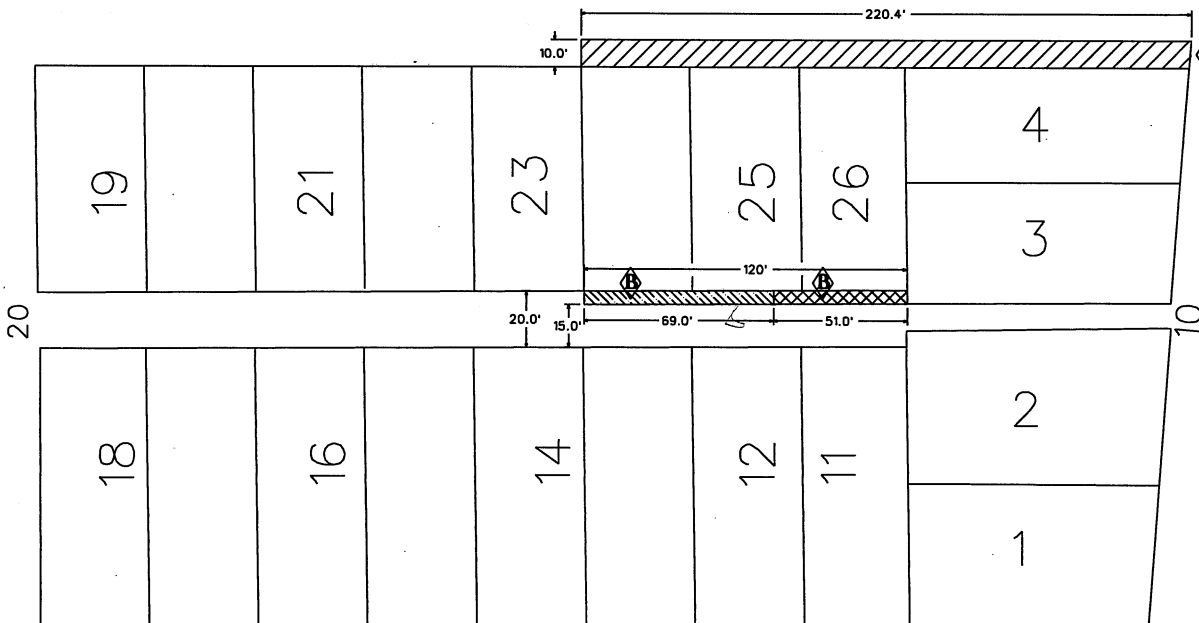

WOODWARD AVE. 120 FT. WD.

ADAMS AVE. 60 FT. WD.



- OUTRIGHT VACATION
 (MAINTAIN PUBLIC PEDESTRIAN EASEMENT FROM GRADE
 TO 10 FEET ABOVE GRADE WITH SUPPORT COLUMNS.)



- ABOVE GRADE ENCROACHMENT
 (STARTING 15 FEET ABOVE GRADE AND EXTENDING TO 300 FEET ABOVE GRADE)



- ABOVE GRADE ENCROACHMENT
 (STARTING 40 FEET ABOVE GRADE AND EXTENDING TO 300 FEET ABOVE GRADE)

(FOR OFFICE USE ONLY)

CARTO 28 B

B	Changing The Description	SA	KSM		05/15/19
A	Changing The Description	SA	KSM		12/18/18
REVISIONS					
DESCRIPTION	DRWN	CHKD	APPD	DATE	
DRAWN BY	SA		CHECKED	KSM	
DATE	12-12-18		APPROVED		

- REQUEST FOR A SERIES OF VACATIONS AND ENCROACHMENTS
 INTO OF THE RIGHTS-OF-WAY WITHIN THE BLOCK BOUNDED BY
 ELIZABETH ST., WOODWARD AVE., ADAMS AVE. AND PARK AVE.

CITY OF DETROIT
CITY ENGINEERING DIVISION
SURVEY BUREAU

JOB NO. 01-01
 DRWG. NO. X 595