

City of Detroit  
**City Engineering Division, Department of Public Works  
Survey Bureau**

**NOTICE OF PROPOSED CHANGE IN PROPERTY**

Date: 11/30/2018

Petition: x594

- |  |  |
|--|--|
| <input type="checkbox"/> AT&T Telecommunication                      | <input type="checkbox"/> Berm Use                          |
| <input type="checkbox"/> Comcast Television (CATV)                   | <input checked="" type="checkbox"/> Conversion to Easement |
| <input type="checkbox"/> Detroit Edison (DTE)                        | <input checked="" type="checkbox"/> Dedication             |
| <input type="checkbox"/> Fire Department                             | <input type="checkbox"/> Encroachment                      |
| <input type="checkbox"/> Great Lakes Water Authority                 | <input type="checkbox"/> Outright Vacation                 |
| <input type="checkbox"/> Land Bank Authority                         | <input type="checkbox"/> Temporary Closing                 |
| <input type="checkbox"/> Michcon (DTE)                               |  |
| <input type="checkbox"/> Planning & Development Department           |  |
| <input type="checkbox"/> Public Lighting Authority                   |  |
| <input type="checkbox"/> Public Lighting Department                  |  |
| <input type="checkbox"/> Police Department                           |  |
| <input type="checkbox"/> Solid Waste Division, DPW                   |  |
| <input type="checkbox"/> Street Design Bureau, DPW                   |  |
| <input checked="" type="checkbox"/> Street Maintenance Division, DPW |  |
| <input type="checkbox"/> Traffic Engineering Division, DPW           |  |
| <input type="checkbox"/> Water and Sewerage Department               |  |
| <input type="checkbox"/> _____                                       |  |

A petition drawing is attached. Property shown on the attached print is proposed to be changed as indicated. Kindly report (using the back of this sheet) the nature of your services, if any affected by the proposed change and the estimated costs of removing and rerouting such services (if necessary).

Please return one copy to City Engineering Division, DPW within two weeks of the submittal date. Retain one copy and print for you file.

Ron Brundidge, Director, Department of Public Works

By: Richard Doherty, CED DPW  
City Engineer

TO: City Engineering Division, DPW  
2 Woodward Ave., Suite 642  
Detroit, Michigan 48226-3462  
Survey Bureau: 313-224-3970

Petition: x594

The proposed change in property (referred to on the other side of this sheet) would affect our services as follows:

Not Involved

Involved; but asking you to hold action on this petition until further notice.

Involved; but no objections to the property change.

Involved; objection to the property change.

Involved; but no objections to the property change...provided as easement of the full width of the public right-of-way (street, alley or other public place) is reserved.

Involved; the nature of our services and the estimated costs of removing and/or rerouting such services are:

DPW/SMD

(Utility or City Department)

Mr. Leslie R Walker

By

Supervisor

Title

Nov 30, 2018

Date

313.224.0018

Area code - Telephone number

PETITION NO. 594  
 GRAND JEFFERSON LLC.  
 3011 W. GRAND BLVD., SUITE 2300  
 DETROIT, MICHIGAN 48202  
 C/O GIFFELS WEBSTER  
 TRICIA DEMARCO  
 PHONE NO. (313) 962-4442

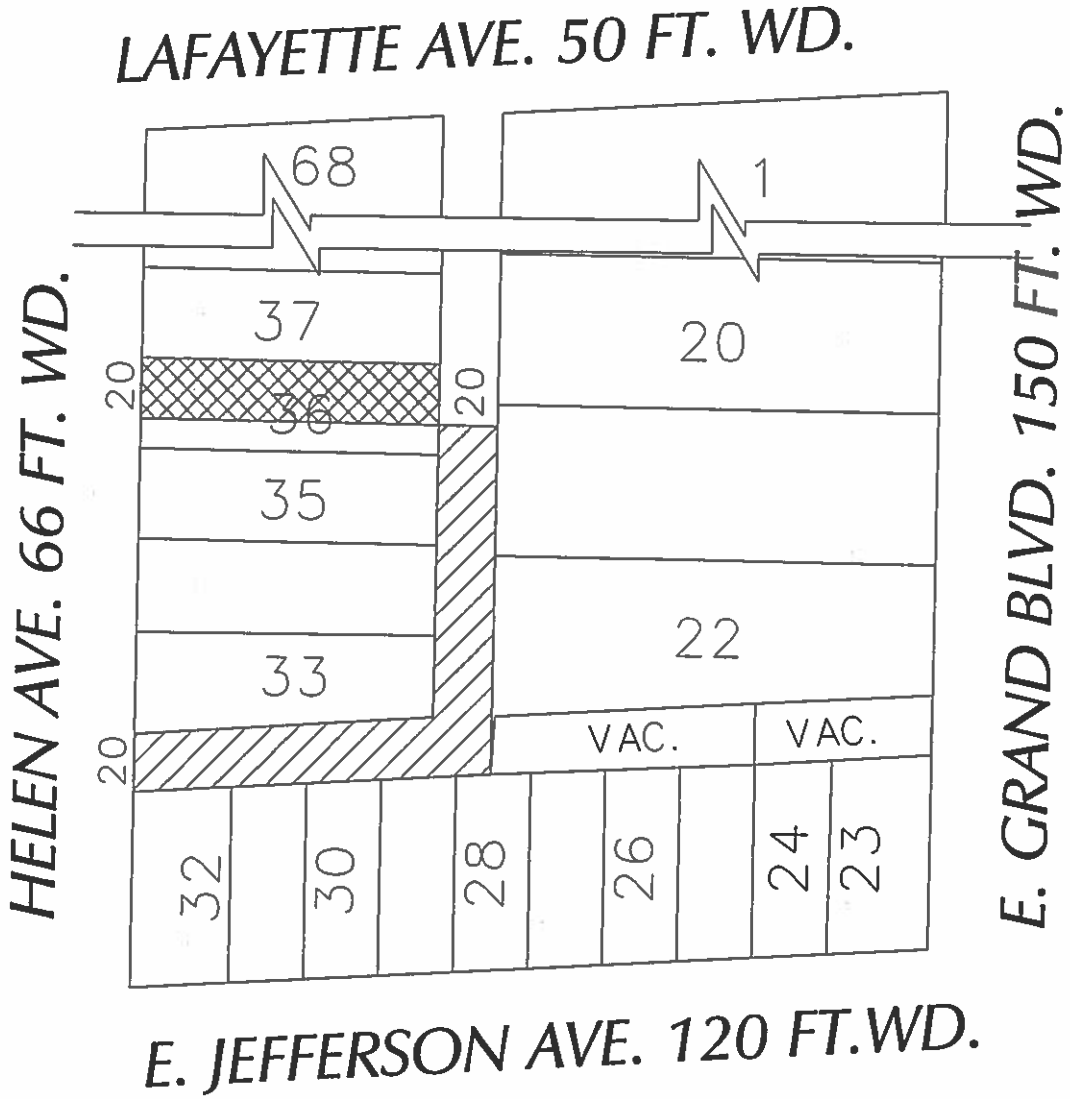

- OUTRIGHT VACATION
- DEDICATION

(FOR OFFICE USE ONLY)

CARTO 46 C

B						- REQUEST TO OUTRIGHT VACATE THE NORTH/SOUTH AND EAST/WEST PORTION OF PUBLIC ALLEY, 20 FT. WD. - REQUEST FOR DEDICATION THE EAST/WEST OF PUBLIC ALLEY, 20 FT. WD. IN THE BLOCK BOUND BY HELEN AVE., LAFAYETTE AVE., E. GRAND BLVD. AND E. JEFFERSON AVE.	<b>CITY OF DETROIT</b> CITY ENGINEERING DEPARTMENT SURVEY BUREAU																				
A	<table border="1" style="width: 100%; border-collapse: collapse;"> <thead> <tr> <th style="width: 15%;">DESCRIPTION</th> <th style="width: 10%;">DRWN</th> <th style="width: 10%;">CHKD</th> <th style="width: 10%;">APPD</th> <th style="width: 10%;">DATE</th> </tr> </thead> <tbody> <tr> <td colspan="5" style="text-align: center;">REVISIONS</td> </tr> <tr> <td>DRAWN BY SA</td> <td colspan="4">CHECKED KSM</td> </tr> <tr> <td>DATE 11-30-18</td> <td colspan="4">APPROVED</td> </tr> </tbody> </table>						DESCRIPTION	DRWN	CHKD	APPD	DATE	REVISIONS					DRAWN BY SA	CHECKED KSM				DATE 11-30-18	APPROVED				JOB NO. 01-01 DRWG. NO. X 594
DESCRIPTION	DRWN	CHKD	APPD	DATE																							
REVISIONS																											
DRAWN BY SA	CHECKED KSM																										
DATE 11-30-18	APPROVED																										