

TO: City Engineering Division, DPW
2 Woodward Ave., Suite 642
Detroit, MI 48226-3462
Survey Bureau: 313-224-3970

Petition No. 574

The proposed change in property (referred to above) would affect our services as follows:

- Not Involved.

- Involved; but asking you to hold action on this petition until further notice.
- Involved; the nature of our services, and the estimated costs of removing and/or rerouting such services are:
- Involved; have no objection to request for conversion to easement Pierson Ave. 50 ft wide in the area bound by Glendale, Stout, Fullerton Ave, Burt Rd. and Chesapeake and Ohio R. R as shown on drawing no. X 574 dated 11/09/2018 provided that 100% signatures of abutting property owners are secured.

Traffic Engineering Division - DPW
(Utility or City Department)

Ashok Patel
By

Sunny Jacob

City Traffic Engineer
Title

January 8, 2019
Date

313 224-1610
Area code-Telephone number

SJ/aa

PETITION NO. 574
 JOAN MCGOWAN
 20745 GLENDALE AVE.
 DETROIT, MICHIGAN 48223
 PHONE NO. 248 252-6126



GLENDALE AVE. 50 FT. WD.

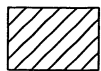
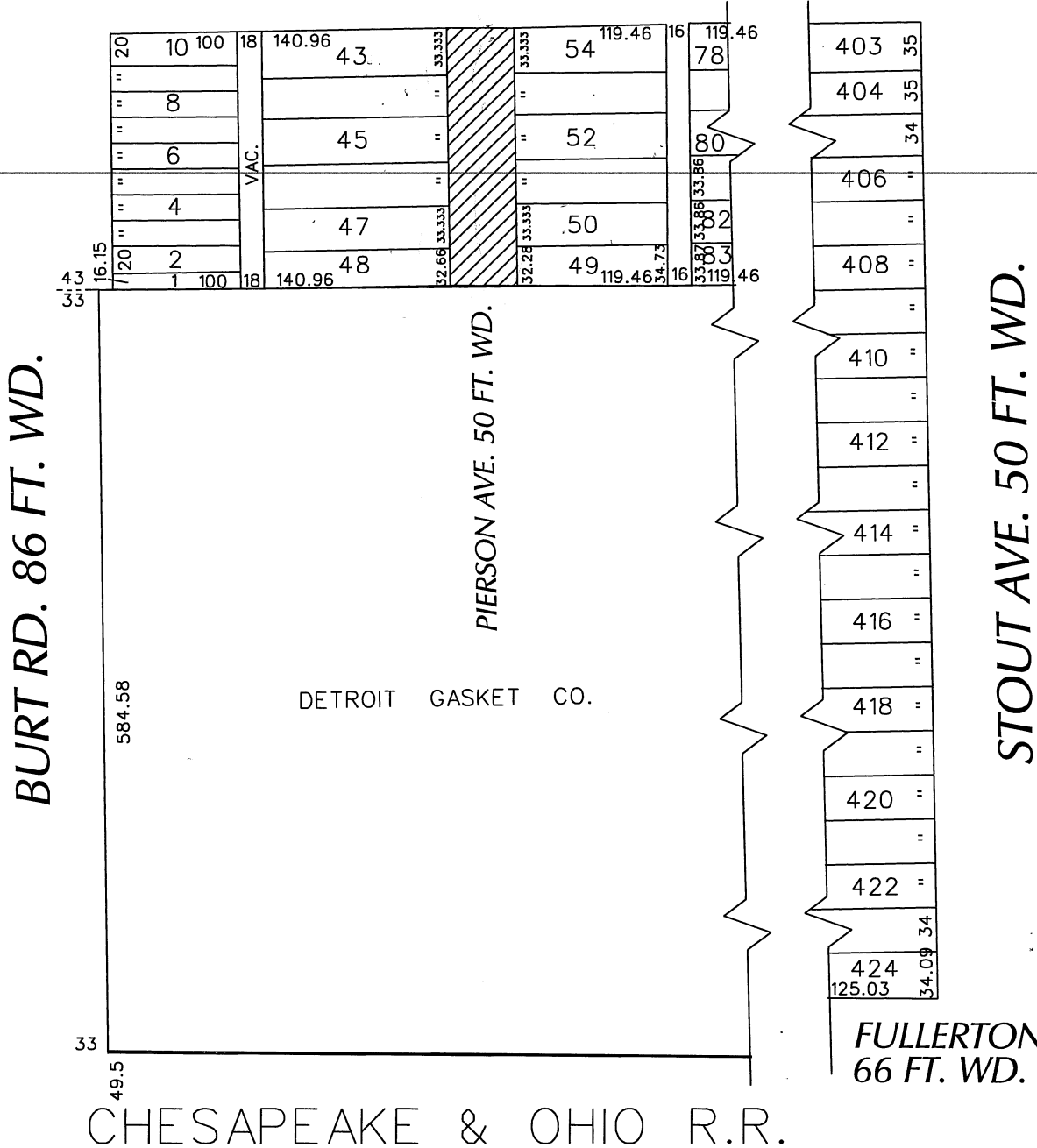

- CONVERSION TO EASEMENT

(FOR OFFICE USE ONLY)

CARTO 111 B

B					
A					
DESCRIPTION	DRWN	CHKD	APPD	DATE	
REVISIONS					
DRAWN BY	CHECKED				
WLW	KSM				
DATE	APPROVED				
11-09-18					

CONVERSION TO EASEMENT
 PIERSON AVE. 50 FT. WD.
 IN THE AREA BOUND BY
 GLENDALE, STOUT, FULLERTON AVE, BURT RD.
 AND CHESAPEAKE & OHIO R.R.

CITY OF DETROIT
 CITY ENGINEERING DIVISION
 SURVEY BUREAU

JOB NO. 01-01

DRWG. NO. X 574