

City of Detroit  
City Engineering Division, Department of Public Works  
Survey Bureau

NOTICE OF PROPOSED CHANGE IN PROPERTY

Date: 10/24/2018

Petition: X527

- |  |  |
|--|--|
| <input type="checkbox"/> AT&T Telecommunication                      | <input type="checkbox"/> Berm Use                |
| <input type="checkbox"/> Comcast Television (CATV)                   | <input type="checkbox"/> Conversion to Easement  |
| <input type="checkbox"/> Detroit Edison (DTE)                        | <input type="checkbox"/> Dedication              |
| <input type="checkbox"/> Fire Department                             | <input checked="" type="checkbox"/> Encroachment |
| <input type="checkbox"/> Great Lakes Water Authority                 | <input type="checkbox"/> Outright Vacation       |
| <input type="checkbox"/> Land Bank Authority                         | <input type="checkbox"/> Temporary Closing       |
| <input type="checkbox"/> Michcon (DTE)                               |  |
| <input type="checkbox"/> Planning & Development Department           |  |
| <input type="checkbox"/> Public Lighting Authority                   |  |
| <input type="checkbox"/> Public Lighting Department                  |  |
| <input type="checkbox"/> Police Department                           |  |
| <input type="checkbox"/> Solid Waste Division, DPW                   |  |
| <input checked="" type="checkbox"/> Street Design Bureau, DPW        |  |
| <input checked="" type="checkbox"/> Street Maintenance Division, DPW |  |
| <input type="checkbox"/> Traffic Engineering Division, DPW           |  |
| <input type="checkbox"/> Water and Sewerage Department               |  |
| <input type="checkbox"/> _____                                       |  |

A petition drawing is attached. Property shown on the attached print is proposed to be changed as indicated. Kindly report (using the back of this sheet) the nature of your services, if any affected by the proposed change and the estimated costs of removing and rerouting such services (if necessary).

Please return one copy to City Engineering Division, DPW within two weeks of the submittal date.  
Retain one copy and print for you file.

Ron Brundidge, Director, Department of Public Works

By: Richard Doherty, CED DPW  
City Engineer

TO: City Engineering Division, DPW  
2 Woodward Ave., Suite 642  
Detroit, Michigan 48226-3462  
Survey Bureau: 313-224-3970

Petition: X527

The proposed change in property (referred to on the other side of this sheet) would affect our services as follows:

- Not Involved
- Involved; but asking you to hold action on this petition until further notice.
- Involved; but no objections to the property change.
- Involved; objection to the property change.
- Involved; but no objections to the property change... provided as easement of the full width of the public right-of-way (street, alley or other public place) is reserved.
- Involved; the nature of our services and the estimated costs of removing and/or rerouting such services are:

DPW/SMB  
(Utility or City Department)

By M. Jessica R Walker

Title Supervisor

Date Nov. 14, 2018

313.224.0018  
Area code - Telephone number

PETITION NO. 527  
 PAUL HAGOPIAN  
 C/O CIEFFELS WEBSTER  
 28 W. ADAMS, SUITE 1200  
 DETROIT MICHIGAN 48226  
 C/O MICHAEL MARKS P.E.  
 PHONE NO. 313 962-4442

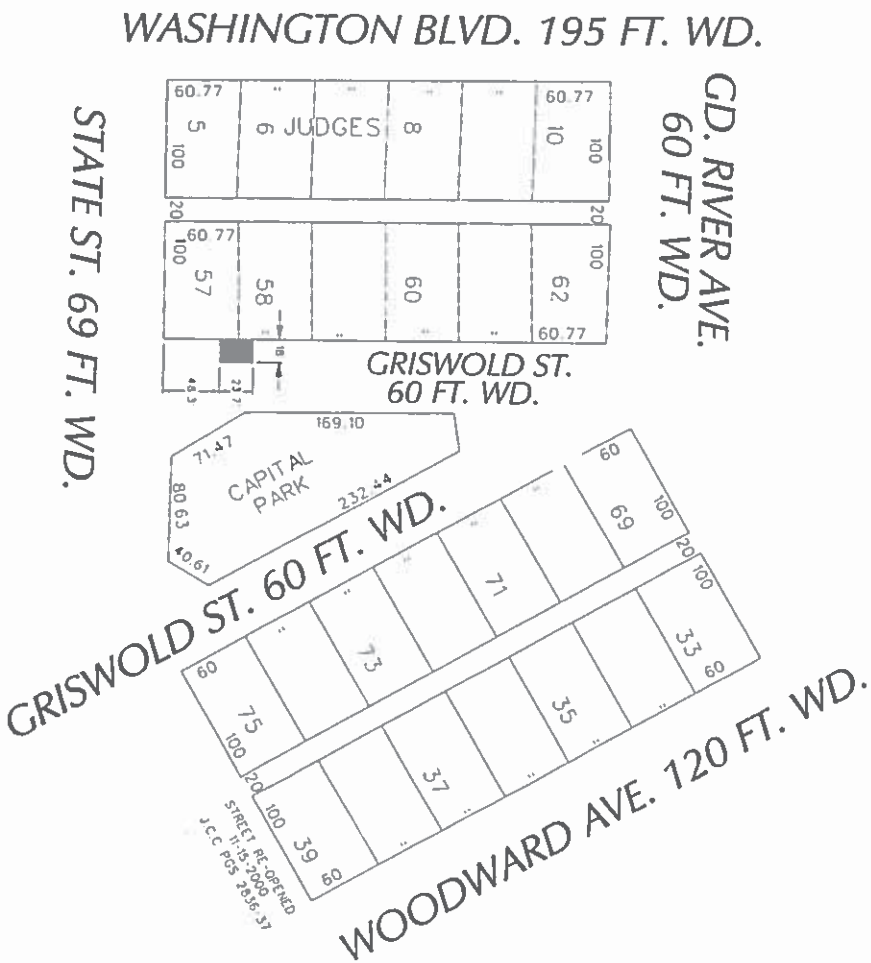

REQUEST ENCROACHMENT  
 (With Outdoor Cafe Seating)

CARTO 28 B

(FOR OFFICE USE ONLY)

A		B	
DESCRIPTION	DRAWN	CHECKED	APPROVED
REVISIONS	DATE	DATE	DATE
WLV	KSM		
DATE	10-24-18		
REQUEST ENCROACHMENT INTO GRISWOLD AT 1211 GRISWOLD (With Outdoor Cafe Seating)			
CITY OF DETROIT CITY ENGINEERING DEPARTMENT SURVEY BUREAU		JOB NO. 01-01	
DRWG. NO. X 527			