

City of Detroit  
**City Engineering Division, Department of Public Works**  
**Survey Bureau**

GLWA GPET 18-71

**NOTICE OF PROPOSED CHANGE IN PROPERTY**

Date: 10/25/2018

Petition: x525

- |   |  |
|---|--|
| <input type="checkbox"/> AT&T Telecommunication                 | <input type="checkbox"/> Berm Use                |
| <input type="checkbox"/> Comcast Television (CATV)              | <input type="checkbox"/> Conversion to Easement  |
| <input type="checkbox"/> Detroit Edison (DTE)                   | <input type="checkbox"/> Dedication              |
| <input type="checkbox"/> Fire Department                        | <input checked="" type="checkbox"/> Encroachment |
| <input checked="" type="checkbox"/> Great Lakes Water Authority | <input type="checkbox"/> Outright Vacation       |
| <input type="checkbox"/> Land Bank Authority                    | <input type="checkbox"/> Temporary Closing       |
| <input type="checkbox"/> Michcon (DTE)                          |  |
| <input type="checkbox"/> Planning & Development Department      |  |
| <input type="checkbox"/> Public Lighting Authority              |  |
| <input type="checkbox"/> Public Lighting Department             |  |
| <input type="checkbox"/> Police Department                      |  |
| <input type="checkbox"/> Solid Waste Division, DPW              |  |
| <input type="checkbox"/> Street Design Bureau, DPW              |  |
| <input type="checkbox"/> Street Maintenance Division, DPW       |  |
| <input type="checkbox"/> Traffic Engineering Division, DPW      |  |
| <input type="checkbox"/> Water and Sewerage Department          |  |
| <input type="checkbox"/> _____                                  |  |

A petition drawing is attached. Property shown on the attached print is proposed to be changed as indicated. Kindly report (using the back of this sheet) the nature of your services, if any affected by the proposed change and the estimated costs of removing and rerouting such services (if necessary).

Please return one copy to City Engineering Division, DPW within two weeks of the submittal date. Retain one copy and print for you file.

Ron Brundidge, Director, Department of Public Works

By: Richard Doherty, CED DPW  
City Engineer

**TO: City Engineering Division, DPW  
2 Woodward Ave., Suite 642  
Detroit, Michigan 48226-3462  
Survey Bureau: 313-224-3970**

**Petition: x525**

The proposed change in property (referred to on the other side of this sheet) would affect our services as follows:

- Not Involved
  
- Involved; but asking you to hold action on this petition until further notice.
  
- Involved; but no objections to the property change.
  
- Involved; objection to the property change.
  
- Involved; but no objections to the property change...provided as easement of the full width of the public right-of-way (street, alley or other public place) is reserved.
  
- Involved; the nature of our services and the estimated costs of removing and/or rerouting such services are:

GLWA

\_\_\_\_\_  
(Utility or City Department)

DALE ECHOLS

\_\_\_\_\_  
By

ET

\_\_\_\_\_  
Title

OCTOBER 26, 2018

\_\_\_\_\_  
Date

(313) 267-4857

\_\_\_\_\_  
Area code – Telephone number

PETITION NO. 525  
 1227 GRISWOLD LLC  
 C/O GIFFELS WEBSTER  
 28 W. ADAMS, SUITE 1200  
 DETROIT, MICHIGAN 48226  
 C/O MICHAEL MARKS P.E.  
 PHONE NO. 313 962-4442



WASHINGTON BLVD. 195 FT. WD.

GD. RIVER AVE.  
 60 FT. WD.



STATE ST. 69 FT. WD.



- REQUEST ENCROACHMENT  
 (With Outdoor Cafe Seating)

(FOR OFFICE USE ONLY)

CARTO 28 B

REQUEST ENCROACHMENT  
 INTO GRISWOLD  
 AT 1227 GRISWOLD  
 (With Outdoor Cafe Seating)

CITY OF DETROIT  
 CITY ENGINEERING DIVISION  
 SURVEY BUREAU

B					
A					
DESCRIPTION	DRWN	CHKD	APPD	DATE	
REVISIONS					
DRAWN BY	WLW	CHECKED	KSM		
DATE	10-25-18	APPROVED			

JOB NO. 01-01  
 DRWG. NO. X 525



CITY CLERK 10 SEP 2018 PM 2:28

August 21, 2018

**HAND DELIVER**

**Honorable Detroit City Council  
C/o Detroit City Clerk  
2 Woodward Avenue  
200 Coleman A. Young Municipal Center  
Detroit, Michigan 48226**

**RE: Giffels Webster – Request to encroach into a public Right of Way.**

Giffels Webster, 28 W. Adams, Suite 1200, Detroit, Michigan 48226 on behalf of 1227 Griswold LLC, 401 S. Washington Square, Suite 102, Lansing, Michigan, 48933 respectfully requests the following café encroachment into the City of Detroit public right of way in front of 1227 Griswold:

- Griswold Street (west – 60 feet wide) beginning 121.9 feet north of the State Street (60 feet wide) right of way and extends north 60.9 feet.

The café encroachment will extend 30.0 feet into the Griswold Street right of way, maintaining 20.0 feet of access for emergency vehicles and of 10.0 feet of access for pedestrians. Limits of the requested encroachment can be found in the attachment, enclosed herein.

Giffels Webster has been asked to facilitate the requested encroachment. If you should have any questions, please do not hesitate to contact me at (P) 313.962.4442 (M) 313.980.1469 or [mmarks@giffelswebster.com](mailto:mmarks@giffelswebster.com).

Respectfully,

A handwritten signature in blue ink, appearing to read "Michael A. Marks".

Michael Marks P.E.,  
Partner  
Giffels Webster

CAPITOL PARK

GRISWOLD STREET (EAST) (60' WIDE)

GRISWOLD STREET (WEST) (60' WIDE)

PEDESTRIAN ZONE  
CONTINUOUS WITH PARK  
EMERGENCY VEHICLE  
ACCESS

10.0'

20.0'

30.0'

60.9'

121.9'

265 GRISWOLD

LOT 62

1249 GRISWOLD

LOT 61

1227 GRISWOLD

LOT 59

1215 GRISWOLD

LOT 58

1201 GR

1211 GRISWOLD

PROPOSED 30' CAFE  
ENCROACHMENT

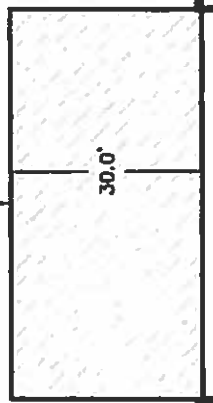



September 20, 2018

HAND DELIVER

Keith McCrary  
DPW, City Engineering Division  
200 Coleman A. Young Municipal Center  
2 Woodward Avenue  
Detroit, Michigan 48226

RE: Giffels Webster – Revision to petitions [REDACTED] 525, [REDACTED], requests to encroach into a public Right of Way.

Giffels Webster, 28 W. Adams, Suite 1200, Detroit, Michigan 48226 on behalf of the property owners of 1249, 1201, 1211, 1215, and 1227 Griswold respectfully requests the following revision to petitions [REDACTED] 525, [REDACTED] for 18.0 foot café encroachments in the Griswold Street right of way (60 feet wide):

- Griswold Street (west – 60 feet wide) beginning 61.0 feet south of Grand River Ave (60 feet wide) extending south 122.0 feet.
- ~~Griswold Street (west – 60 feet wide) beginning at State Street (60 feet wide) extending north 48.3 feet~~
- ~~Griswold Street (west – 60 feet wide) beginning 48.3 feet north of the State Street (60 feet wide) right of way and extends north 32.7 feet~~
- ~~Griswold Street (west – 60 feet wide) beginning 72.9 feet north of the State Street (60 feet wide) right of way and extends north 40.9 feet~~
- ~~Griswold Street (west – 60 feet wide) beginning 121.9 feet north of the State Street (60 feet wide) right of way and extends north 60.9 feet~~

The café encroachments will extend 18.0 feet into the Griswold Street right of way, maintaining 32.0 feet of access for emergency vehicles and 10.0 feet of access for pedestrians. Limits of the requested encroachments can be found in the attachment, enclosed herein.

Giffels Webster has been asked to facilitate the requested encroachment. If you should have any questions, please do not hesitate to contact me at (P) 313.962.4442 (M) 313.980.1469 or [mmarks@giffelswebster.com](mailto:mmarks@giffelswebster.com).

Respectfully,

Michael Marks P.E.,  
Partner  
Giffels Webster

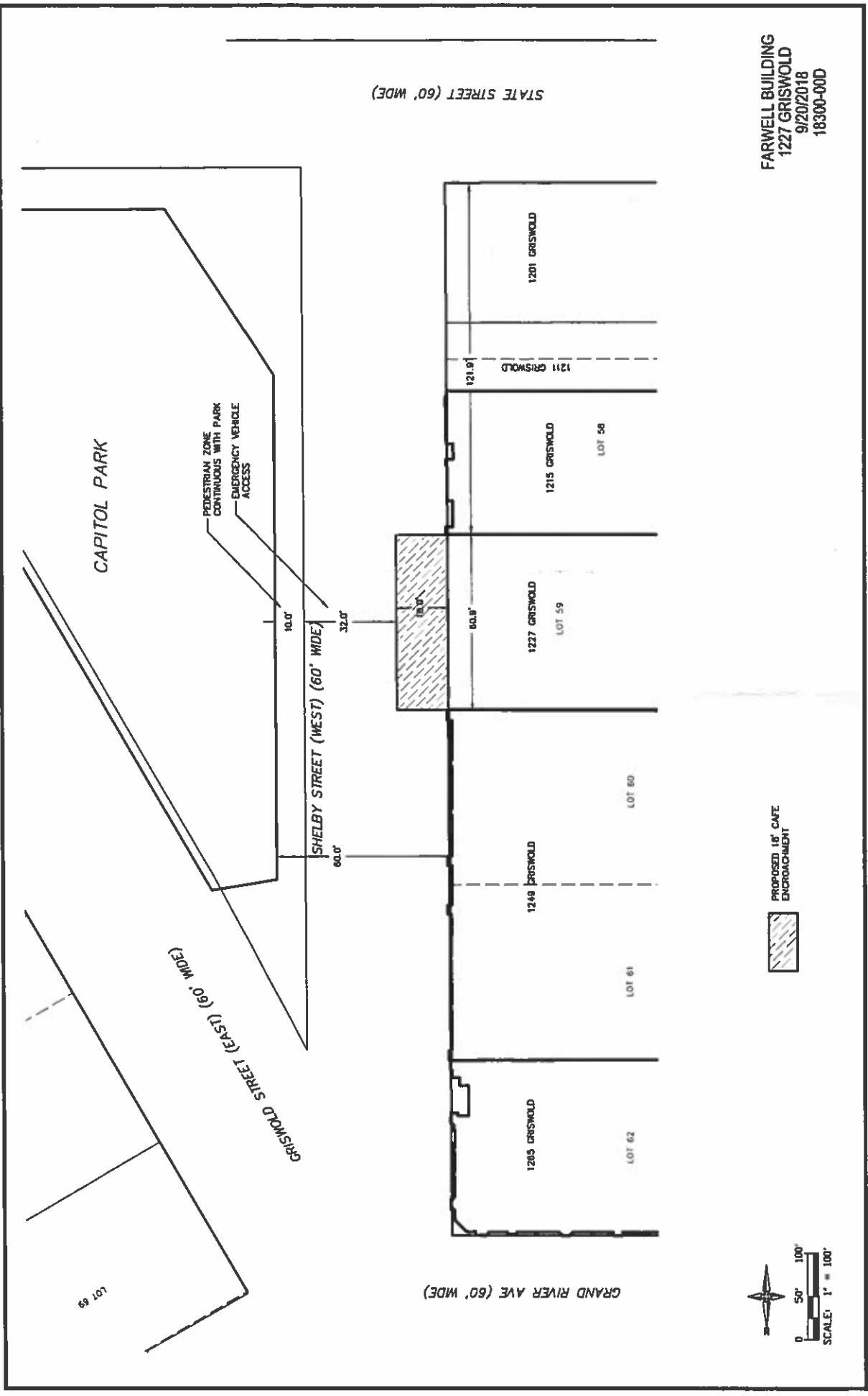

FARWELL BUILDING  
 1227 GRISWOLD  
 9/20/2018  
 18300-000



PROPOSED 18' CAFE ENCROACHMENT

STATE STREET (60' WDE)

GRAND RIVER AVE (60' WDE)

CAPITOL PARK

PEDESTRIAN ZONE  
 CONTINUOUS WITH PARK  
 EMERGENCY VEHICLE  
 ACCESS

SHELBY STREET (WEST) (60' WDE)

GRISWOLD STREET (EAST) (60' WDE)

1201 GRISWOLD

1211 GRISWOLD

1215 GRISWOLD  
 LOT 58

1227 GRISWOLD  
 LOT 59

1248 GRISWOLD  
 LOT 60

1265 GRISWOLD  
 LOT 61

LOT 62

LOT 62