

City of Detroit
**City Engineering Division, Department of Public Works
Survey Bureau**

NOTICE OF PROPOSED CHANGE IN PROPERTY

Date: 08/31/2018

Petition: x490

- | | |
|---|---|
| <input type="checkbox"/> AT&T Telecommunication | <input type="checkbox"/> Berm Use |
| <input type="checkbox"/> Comcast Television (CATV) | <input type="checkbox"/> Conversion to Easement |
| <input type="checkbox"/> Detroit Edison (DTE) | <input type="checkbox"/> Dedication |
| <input type="checkbox"/> Fire Department | <input type="checkbox"/> Encroachment |
| <input type="checkbox"/> Great Lakes Water Authority | <input checked="" type="checkbox"/> Outright Vacation |
| <input type="checkbox"/> Land Bank Authority | <input type="checkbox"/> Temporary Closing |
| <input type="checkbox"/> Michcon (DTE) | |
| <input checked="" type="checkbox"/> Planning & Development Department | |
| <input type="checkbox"/> Public Lighting Authority | |
| <input type="checkbox"/> Public Lighting Department | |
| <input type="checkbox"/> Police Department | |
| <input type="checkbox"/> Solid Waste Division, DPW | |
| <input type="checkbox"/> Street Design Bureau, DPW | |
| <input type="checkbox"/> Street Maintenance Division, DPW | |
| <input type="checkbox"/> Traffic Engineering Division, DPW | |
| <input type="checkbox"/> Water and Sewerage Department | |
| <input type="checkbox"/> _____ | |

A petition drawing is attached. Property shown on the attached print is proposed to be changed as indicated. Kindly report (using the back of this sheet) the nature of your services, if any affected by the proposed change and the estimated costs of removing and rerouting such services (if necessary).

Please return one copy to City Engineering Division, DPW within two weeks of the submittal date. Retain one copy and print for you file.

Ron Brundidge, Director, Department of Public Works

By: Richard Doherty, CED DPW
City Engineer

TO: City Engineering Division, DPW
2 Woodward Ave., Suite 642
Detroit, Michigan 48226-3462
Survey Bureau: 313-224-3970

Petition: x490

The proposed change in property (referred to on the other side of this sheet) would affect our services as follows:

- Not Involved
- Involved; but asking you to hold action on this petition until further notice.
- Involved; but no objections to the property change.
- Involved; objection to a portion of the property change.
Planning agrees with the Eliot St. vacation, but Riopelle is part of the Food Accelerator in the former water building. P&DD does not support the vacation of this portion of Riopelle
- Involved; but no objections to the property change... provided as easement of the full width of the public right-of-way (street, alley or other public place) is reserved.
- Involved; the nature of our services and the estimated costs of removing and/or rerouting such services are:

Planning & Development Department
(Utility or City Department)



By

Greg Moots-Lead Planner-Office of Zoning Innovation
Title

Sep + 19, 18
Date

313-224-1358
Area code – Telephone number

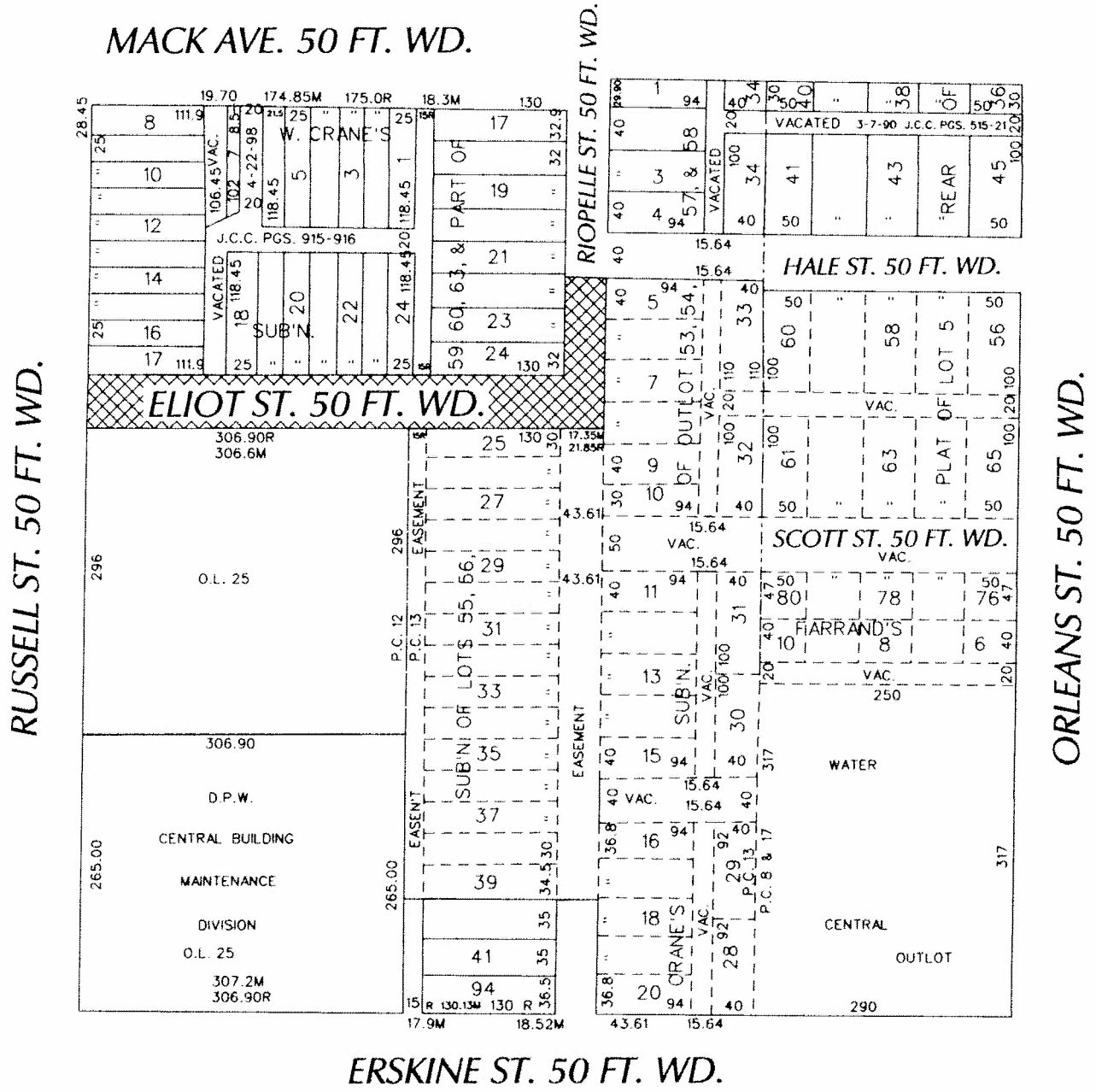
PETITION NO. 490
 MILANO BAKERY
 C/O THOMAS GROUP CONSULTING
 28 W. ADAMS, SUITE 1300
 DETROIT, MICHIGAN 48226
 C/O BUZZ THOMAS
 PHONE NO. 313 334-3481



- OUTRIGHT VACATION

(FOR OFFICE USE ONLY)

CARTO 39 C

B		REQUEST TO OUTRIGHT VACATE ELIOT ST. 50 FT. WD. AND A PORTION OF RIOPELLE ST. 50 FT. WD. IN THE AREA BOUND BY ORLEANS, ERSKINE, RUSSELL ST. AND MACK AVE.		CITY OF DETROIT CITY ENGINEERING DEPARTMENT SURVEY BUREAU	
A				JOB NO. 01-01	
DESCRIPTION		DRWN	CHLD	APPR	DATE
REVISIONS					
DRAWN BY		CHECKED			
WLW		KSM			
DATE		APPROVED			
08-31-18					
		DRWG. NO.		X 490	

