

City of Detroit
City Engineering Division, Department of Public Works
Survey Bureau

NOTICE OF PROPOSED CHANGE IN PROPERTY

Date: 02/27/2019

Petition: x454

- | | |
|--|--|
| <input type="checkbox"/> AT&T Telecommunication | <input type="checkbox"/> Berm Use |
| <input type="checkbox"/> Comcast Television (CATV) | <input checked="" type="checkbox"/> Conversion to Easement |
| <input type="checkbox"/> Detroit Edison (DTE) | <input type="checkbox"/> Dedication |
| <input type="checkbox"/> Fire Department | <input type="checkbox"/> Encroachment |
| <input type="checkbox"/> Great Lakes Water Authority | <input checked="" type="checkbox"/> Outright Vacation |
| <input type="checkbox"/> Land Bank Authority | <input type="checkbox"/> Temporary Closing |
| <input checked="" type="checkbox"/> Michcon (DTE) | |
| <input type="checkbox"/> Planning & Development Department | |
| <input type="checkbox"/> Public Lighting Authority | |
| <input type="checkbox"/> Public Lighting Department | |
| <input type="checkbox"/> Police Department | |
| <input type="checkbox"/> Solid Waste Division, DPW | |
| <input type="checkbox"/> Street Design Bureau, DPW | |
| <input type="checkbox"/> Street Maintenance Division, DPW | |
| <input type="checkbox"/> Traffic Engineering Division, DPW | |
| <input type="checkbox"/> Water and Sewerage Department | |
| <input type="checkbox"/> _____ | |

A petition drawing is attached. Property shown on the attached print is proposed to be changed as indicated. Kindly report (using the back of this sheet) the nature of your services, if any affected by the proposed change and the estimated costs of removing and rerouting such services (if necessary).

Please return one copy to City Engineering Division, DPW within two weeks of the submittal date. Retain one copy and print for you file.

Ron Brundidge, Director, Department of Public Works

By: Richard Doherty, CED DPW
City Engineer

**TO: City Engineering Division, DPW
2 Woodward Ave., Suite 642
Detroit, Michigan 48226-3462
Survey Bureau: 313-224-3970**

Petition: x454

The proposed change in property (referred to on the other side of this sheet) would affect our services as follows:

- Not Involved

- Involved; but asking you to hold action on this petition until further notice.

- Involved; but no objections to the property change.

- Involved; objection to the property change.

- Involved; but no objections to the property change...provided as easement of the full width of the public right-of-way (street, alley or other public place) is reserved.

- Involved; the nature of our services and the estimated costs of removing and/or rerouting such services are:
DTE Gas Company has facilities in this area (see attached map)
Cost of removing and/or relocating said facilities has not been determined.

DTE Gas Company
(Utility or City Department)

Michael C. Harrison
By

Drafter
Title

3/4/2019
Date

313-235-0151
Area code – Telephone number

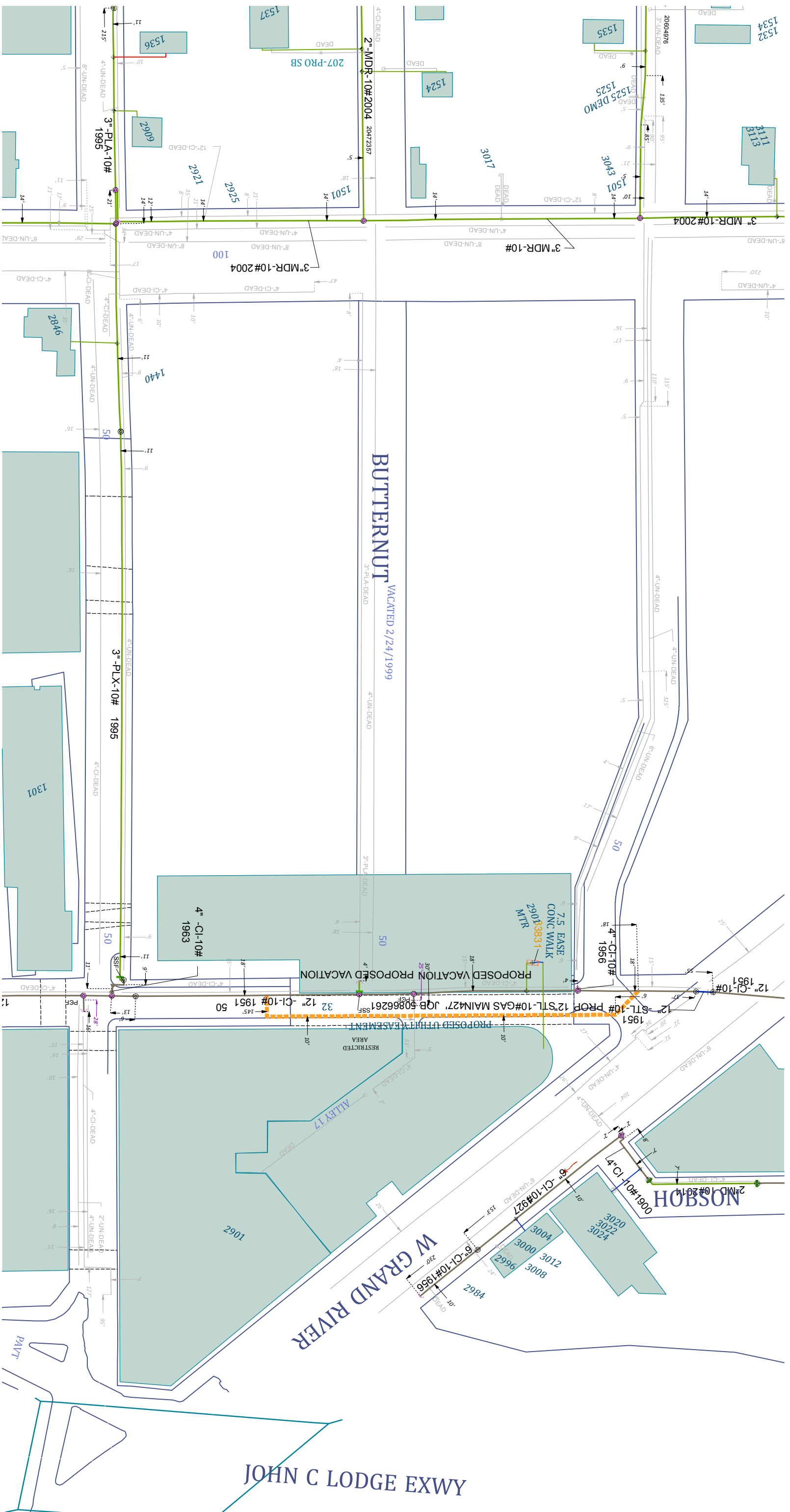

DTE GAS COMPANY FACILITIES AS SHOWN
 INDICATE APPROXIMATE LOCATIONS ONLY AS DISCLOSED BY THE
 COMPANY'S RECORDS AND NO GUARANTEE IS MADE EITHER AS
 TO COMPLETENESS OR ACCURACY.

DTE GAS COMPANY
 SIGNED: /s/ Mike E. Stavrons
 March 04, 2019
 CONSTRUCTION PLANS MADE SUBSEQUENT TO THIS DATE SHOULD
 BE CHECKED WITH THE DTE GAS COMPANY

Pipe Material

- CU - Copper
- PLA - Plastic
- STL - Bare Steel
- STL - Coated Steel
- CI - Cast Iron
- WI - Wrought Iron
- UN - Unknown
- Inactive
- Abandoned

Main Line Styles

- In Design Main (Proposed)
- Distribution Main
- Joint Trench
- Exposed Pipe
- Pipe Lining (CI or WI)
- Transmission Main
- Subtransmission Main



STATE LAW ACT 174
3 WORKING DAYS
BEFORE YOU DIG
DIAL TOLL FREE
1-800-482-7171 OR 811

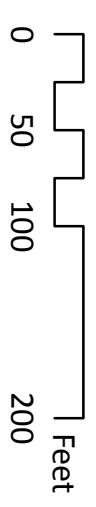

WARNING
 HIGH PRESSURE MAINS ARE HIGHLIGHTED
 THEY SUPPLY GAS TO A LARGE NUMBER OF HOMES AND
 INDUSTRIES OF DETROIT AND VICINITY
 IT IS OF THE UTMOST IMPORTANCE THAT EVERY PRECAUTION
 BE TAKEN SO AS NOT TO ENDANGER ITS USE DURING OR
 FOLLOWING YOUR CONSTRUCTION
DTE GAS COMPANY



Invoice - Rev4

Name Motor City Casino Brooklyn Main Relocation c/o Colasanti & MIG
 Service _____
 Address 2901 Grand River
 City Detroit MI ZIP 48201
 Contact Carlos Moreno 313-400-6808/Gabe Estrada 313-303-4016

Date 5/31/2019
 Project Hdr 50442816
 Acct. Mgr. Julie Jozwiak

Qty	Description	TOTAL
1	Relocate ~450' of 10# Main from the west side to the east side of Brooklyn St from Elm St to ~156' north of Temple. Current 12" 10# Cast Iron main to be abandoned in place, concrete/asphalt restoration by DTE (6' concrete only/does not include 12' joint-to-joint type restoration). Brooklyn St to remain open to traffic (exception of tie-in day). Install new service and 56M double by-pass manifold set at 3# to replace current 38M manifold. DTE to install manifold pad and ballards. Single-day tie in to new meter/minimize gas off time to 4 hour window (early am hours). Remove 38M manifold after new 56M installed and operational.	\$609,254
	Payment Received Feb 19 2019	(\$240,000)
	Payment Received April 22 2019	(\$290,654)
	TIMING: 19 days to complete (includes weekend and off hours work, weather can affect timing). Start June 3 2019. Target tie-over to new service June 24 2019.	
TOTAL DUE		\$78,600.00

This Price is Valid For 30 days from the date issued.

REMIT PAYMENT TO:
 ATTN, Victoria Doebler
 DTE Energy WCB 1755
 One Energy Plaza,
 Detroit, MI 48226

Office Use Only

Price is subject to change after 30 days from the date of this invoice.

DTE Gas appreciates your business and looks forward to serving your energy needs in the future.

MCC Main and Manifold Relocation Schedule as of May 31 2019

Manifold Pad Pour - week of June 3

New manifold installation - target June 15 (may be before this date)

Date	Task
Monday, June 03, 2019	Start at Grand
Tuesday, June 04, 2019	Install Main
Wednesday, June 05, 2019	Install Main
Thursday, June 06, 2019	Install Main
Friday, June 07, 2019	Install Main
Saturday, June 08, 2019	Install Main
Monday, June 10, 2019	Install Main
Tuesday, June 11, 2019	Install Main
Wednesday, June 12, 2019	Install Main
Thursday, June 13, 2019	Install Main
Friday, June 14, 2019	Install Main
Saturday, June 15, 2019	Install Main
Monday, June 17, 2019	Bag and stop both sides of the tie in at Grand River and complete tie in gassing up the New12" STL
Tuesday, June 18, 2019	Bag and stop both sides of the tie in at Grand River and complete tie in gassing up the New12" STL
Wednesday, June 19, 2019	Bag and stop both sides of the tie in at Grand River and complete tie in gassing up the New12" STL Leaving at cap on the 12" STL main on the East end and a cap on the CI main to
Thursday, June 20, 2019	Run the service to the manifold
Friday, June 21, 2019	Gas to manifold tap
Saturday, June 22, 2019	Bag the new 12" STL main on the west end. Bag the CI main to the east of the tie in
Monday, June 24, 2019	Complete tie in