

DEPARTMENTAL REFERENCE COMMUNICATION

Tuesday, July 17, 2018

To: The Department or Commission Listed Below

From: Janice M. Winfrey, Detroit City Clerk

The following petition is herewith referred to you for report and recommendation to the City Council.

In accordance with that body's directive, kindly return the same with your report in duplicate within four (4) weeks.

DPW - CITY ENGINEERING DIVISION PLANNING AND DEVELOPMENT DEPARTMENT

454 *Detroit Entertainment LLC d/b/a MotorCity Casino Hotel, request to vacate Brooklyn Street between Elm Street and Temple Street.*



July 13, 2018

The Honorable City Council
Attn: Office of the City Clerk
200 Coleman A. Young Municipal Center
Detroit, MI 48226

Subject: Vacation of Brooklyn Street between Elm Street and Temple Street

Honorable City Council:

We are writing to you on behalf of our client, Detroit Entertainment, L.L.C. d/b/a MotorCity Casino Hotel ("MCCH"), which owns a casino complex located at 2901 Grand River Avenue, Detroit, MI 48201. MCCH would like to construct an expansion to its existing casino parking structure. The expansion would be located on the west side of Brooklyn Street between Elm Street (50 ft wide) and Temple Street (50 ft wide). MCCH desires to commence construction on or before September 7, 2018. A portion of the contemplated parking structure would need to be constructed in what is now the Brooklyn Street right of way.

Accordingly, to accomplish MCCH's objective, Giffels Webster, on behalf of MCCH, hereby formally petitions the Honorable City Council to vacate Brooklyn Street, from the southern line of Elm Street to the northern line of Temple Street, as illustrated on the attached site plan entitled "ROW Vacation Exhibit." The Brooklyn street right-of-way proposed for vacation is located within the block bounded by Grand River Avenue, Elm Street, Trumbull Avenue, and Temple Street.

Specifically, MCCH requests (i) a full vacation of the westernmost 18 feet of that segment of Brooklyn Street located between the southern line of Elm Street and the northern line of Temple Street, and ii) a vacation of the balance of that segment of Brooklyn Street, but subject to reservation of an easement for the utilities that are in place as of the date of this petition. As a result of so vacating Brooklyn Street, fee title to the vacated segment of Brooklyn Street would vest in MCCH, subject only to the above-described utility easement and no other interests.

Please review this matter and notify us as to how to proceed. If you have any questions, or require additional information, feel free to contact me at (313) 962-4442. Thank you in advance for your assistance in this matter.

Respectfully submitted,

Giffels Webster

A handwritten signature in blue ink, appearing to read "Michael Marks".

Digitally signed by Michael Marks
DN: CN=Michael Marks +
E=mmarks@giffelswebster.com,
OU=Partner, O=Giffels-Webster
Engineers, L=Detroit,
S=Michigan, C=US
Date: 2018.07.13 12:45:16-04'00'

Michael Marks, P.E.
Partner

V:\18750-04D MCCH Brooklyn Elm Garage Addition - 2nd Iteration\Drawing Files\Easements - ROW\ROW Vacation\Brooklyn Street Vacation.dwg

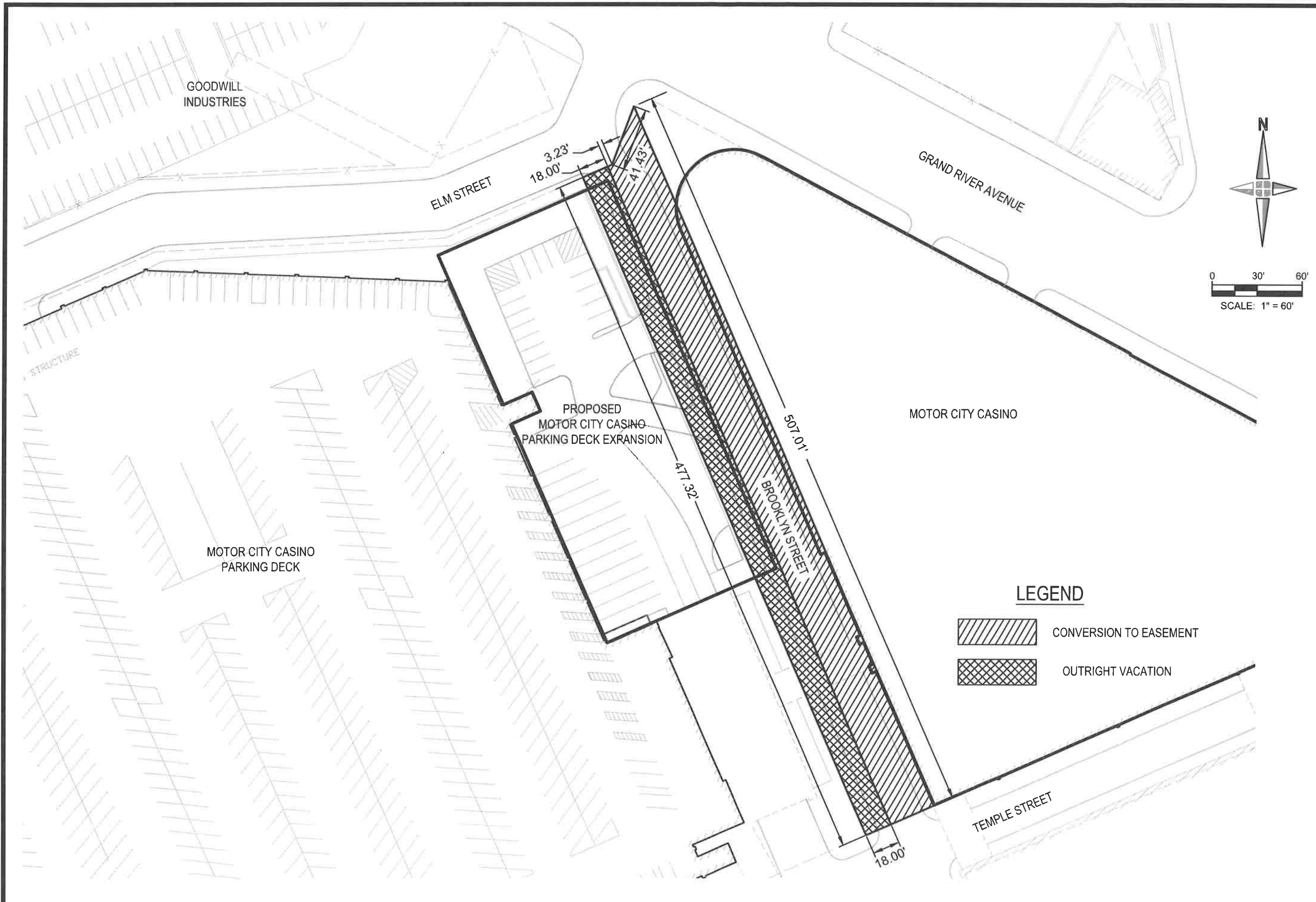

giffels webster

Engineers
Surveyors
Planners
Landscape Architects

28 West Adams Road
Suite 1200
Detroit, MI 48226
p (313) 962-4442
f (313) 962-5068
www.giffelswebster.com

Executive: M. Marks
Manager: D. Root
Designer: L. Overbeck
Quality Control: -
Section: Private Claim

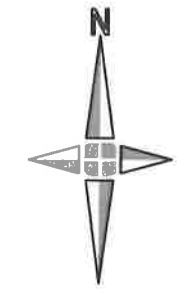

0 30' 60'
SCALE: 1" = 60'



DATE:	ISSUE:
Date	Issue

Developed For:
MotorCity Casino Hotel
Client Address

Client Phone
Client Fax

ROW Vacation Exhibit

Parking Garage Expansion

City of Detroit
County
MICHIGAN

Date: 06.06.2018
Scale: 1"=60'
Sheet: 01
Project: 18750-04D

Copyright © 2018 Giffels Webster.
No reproduction shall be made without the prior written consent of Giffels Webster.

LEGEND

- CONVERSION TO EASEMENT
- OUTRIGHT VACATION

2018-07-17

454

454 *Petition of Detroit Entertainment LLC
d/b/a MotorCity Casino Hotel, request
to vacate Brooklyn Street between Elm
Street and Temple Street.*

REFERRED TO THE FOLLOWING DEPARTMENT(S)

DPW - CITY ENGINEERING DIVISION PLANNING AND
DEVELOPMENT DEPARTMENT