



**City of Detroit**  
**City Engineering Division, Department of Public Works**  
**Survey Bureau**

**NOTICE OF PROPOSED CHANGE IN PROPERTY**

Date: 05/02/2019

Petition: x447

- |  |  |
|--|--|
| <input type="checkbox"/> AT&T Telecommunication                      | <input type="checkbox"/> Berm Use                |
| <input type="checkbox"/> Comcast Television (CATV)                   | <input type="checkbox"/> Conversion to Easement  |
| <input type="checkbox"/> Detroit Edison (DTE)                        | <input type="checkbox"/> Dedication              |
| <input type="checkbox"/> Fire Department                             | <input checked="" type="checkbox"/> Encroachment |
| <input type="checkbox"/> Great Lakes Water Authority                 | <input type="checkbox"/> Outright Vacation       |
| <input type="checkbox"/> Land Bank Authority                         | <input type="checkbox"/> Temporary Closing       |
| <input type="checkbox"/> Michcon (DTE)                               |  |
| <input type="checkbox"/> Planning & Development Department           |  |
| <input type="checkbox"/> Public Lighting Authority                   |  |
| <input type="checkbox"/> Public Lighting Department                  |  |
| <input type="checkbox"/> Police Department                           |  |
| <input type="checkbox"/> Solid Waste Division, DPW                   |  |
| <input type="checkbox"/> Street Design Bureau, DPW                   |  |
| <input checked="" type="checkbox"/> Street Maintenance Division, DPW |  |
| <input type="checkbox"/> Traffic Engineering Division, DPW           |  |
| <input type="checkbox"/> Water and Sewerage Department               |  |
| <input type="checkbox"/> _____                                       |  |

A petition drawing is attached. Property shown on the attached print is proposed to be changed as indicated. Kindly report (using the back of this sheet) the nature of your services, if any affected by the proposed change and the estimated costs of removing and rerouting such services (if necessary).

Please return one copy to City Engineering Division, DPW within two weeks of the submittal date. Retain one copy and print for you file.

Ron Brundidge, Director, Department of Public Works

By: Richard Doherty, CED DPW  
City Engineer

TO: City Engineering Division, DPW  
2 Woodward Ave., Suite 642  
Detroit, Michigan 48226-3462  
Survey Bureau: 313-224-3970

Petition: x447

The proposed change in property (referred to on the other side of this sheet) would affect our services as follows:

Not Involved

Involved; but asking you to hold action on this petition until further notice.

Involved; but no objections to the property change.

Involved; objection to the property change.

Involved; but no objections to the property change...provided as easement of the full width of the public right-of-way (street, alley or other public place) is reserved.

Involved; the nature of our services and the estimated costs of removing and/or rerouting such services are:

DPW/SMD  
(Utility or City Department)

Mr. Estia R. Walker  
By

Supervisor  
Title

May 10, 2019  
Date

313.224.0018  
Area code - Telephone number

PETITION NO. 447  
 DUZAK FURNERAL & CREMATION CENTER  
 16600 W. WARREN AVE.  
 DETROIT, MICHIGAN 48228  
 CHRIS DUZAK  
 PHONE NO. 313 584-5050



MAJESTIC AVE. 50 FT. WD.

ABINGTON RD. 60 FT. WD.

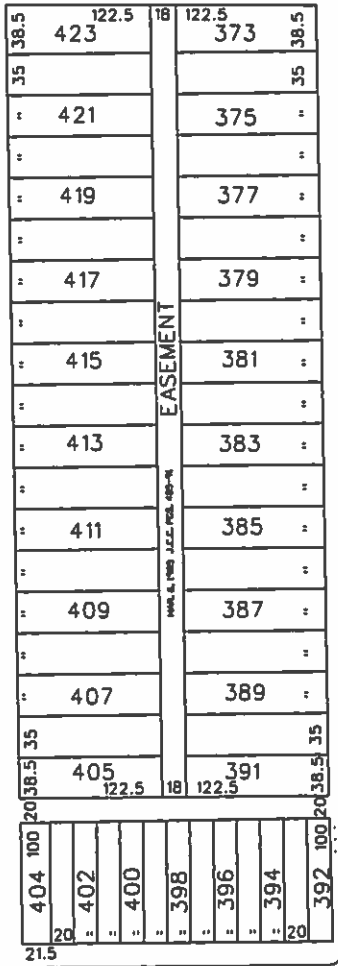

GRANDMONT RD. 50 FT. WD.

W. WARREN AVE. 106 FT. WD.

ALLEY 20' FT. WD.

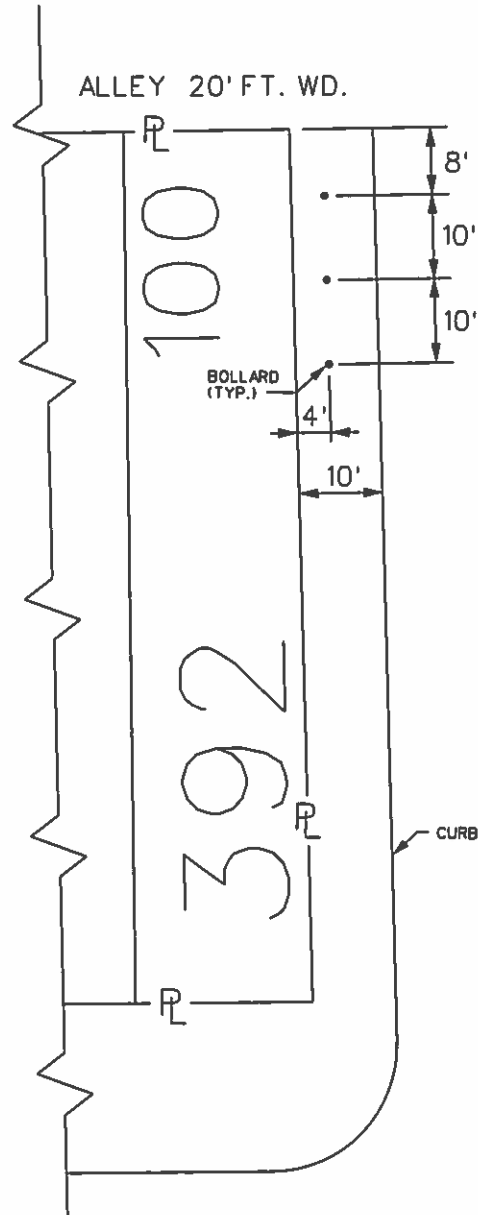

GRANDMONT RD. 50 FT. WD.

W. WARREN AVE.  
 106 FT. WD.



- REQUEST ENCROACHMENT  
 (With Steel Bollards)

(FOR OFFICE USE ONLY)

CARTO 99 E

B					
A					
DESCRIPTION		DRWN	CHEK	APPD	DATE
REVISIONS					
DRAWN BY	WLW	CHECKED		KSM	
DATE	05-02-19	APPROVED			

REQUEST ENCROACHMENT  
 INTO GRANDMONT  
 AT 16600 W. WARREN  
 (With Steel Bollards)

CITY OF DETROIT  
 CITY ENGINEERING DIVISION  
 SURVEY BUREAU

JOB NO. 01-01

DRWG. NO. X 447