



CITY OF DETROIT
DEPARTMENT OF PUBLIC WORKS
CITY ENGINEERING DIVISION

COLEMAN A. YOUNG MUNICIPAL CENTER
2 WOODWARD AVE. SUITE 601
DETROIT, MICHIGAN 48226
PHONE: (313) 224-3949 • TTY: 711
FAX: (313) 224-3471
WWW.DETROITMI.GOV

April 22nd, 2020

Petitioner,

RE: Petition No. x297

Petition No. x297 Intersection Consulting Group, request for encroachment into Oakman Blvd, between Cloverdale Street and Turner, for the purpose of establishing parking for the business located at 12080 Cloverdale.

The petition was referred to the City Engineering Division – DPW for investigation (utility review) and report. This is our report.

The review of petition x297 produced an objection from the Department of Public Works: Traffic Engineering Division regarding the site plan provided with this petition. A site investigation was performed and found the proposed area of encroachment is a paved berm area that is currently occupied by parked personal vehicles associated to the business at 12080 Cloverdale. The paved berm is currently being used for employee parking and the staging of a truck and trailer. The staging of the truck and trailer goes against the current zoning ordinance and the Department of Public Works cannot approve the activity. The petitioner did not provide an adequate site plan to demonstrate how the proposed parking berm would be constructed and utilized in a manner that conforms to the City of Detroit Ordinances.

The Department of Public Works, City Engineering Division **denies** this petition request. Please receive and file this report for you reference.

Respectfully submitted,

Richard Doherty, City Engineer
City Engineering Division – DPW

JMK/

Cc: Ron Brundidge, Director – DPW

PETITION NO. 297
 INTERSECTION CONSULTING GROUP
 C/O AUTO BUD'S AUTO REPAIR
 2233 PARK AVE.
 DETROIT, MICHIGAN 48201
 BRIAN R. ELLISON
 PHONE NO. 313 397-5863



CLOVERDALE AVE.
 60 FT. WD.

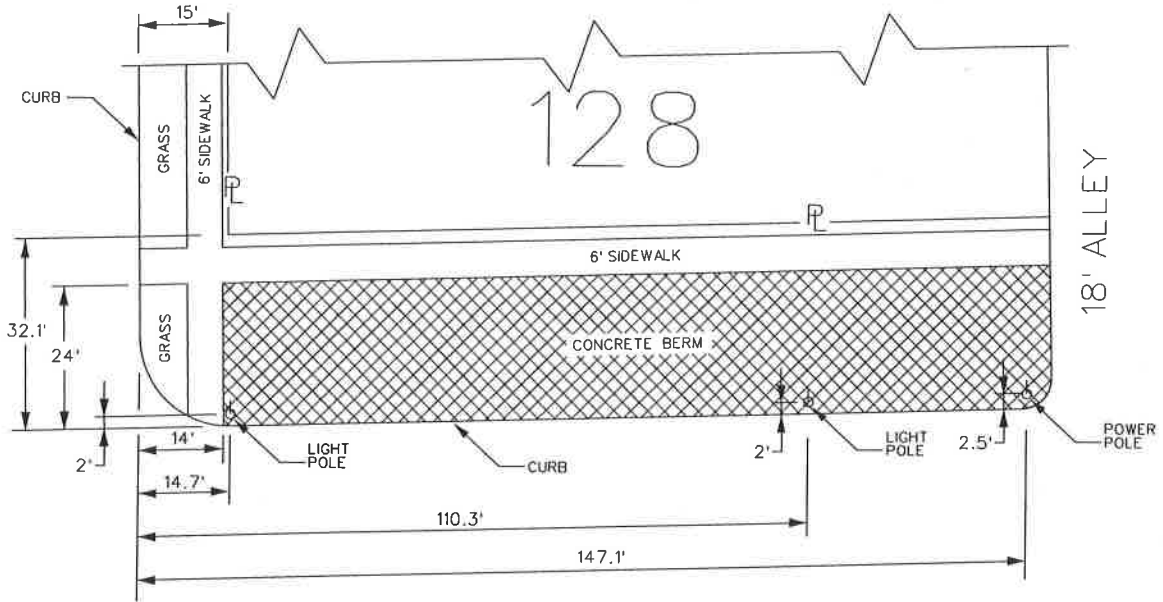

OAKMAN BLVD. 175 FT. WD.

CORTLAND AVE. 60 FT. WD.

CLOVERDALE AVE.
 60 FT. WD.

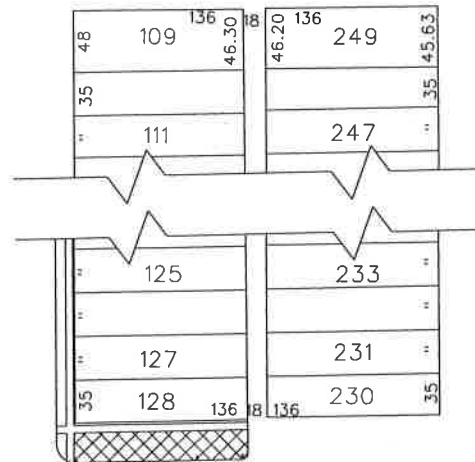

JEFFRIES FWY.

OAKMAN BLVD. 175 FT. WD.

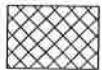

- REQUESTED BERM USE
 (For Parking Only)

(FOR OFFICE USE ONLY)

CARTO 8 F

B					
A					
DESCRIPTION	DRWN	CHKD	APPD	DATE	
REVISIONS					
DRAWN BY	WLW	CHECKED	KSM		
DATE	11-16-18	APPROVED			

**REQUEST BERM USE
 (For Parking Only)
 INTO OAKMAN BLVD.
 AT 12080 CLOVERDALE**

CITY OF DETROIT CITY ENGINEERING DIVISION SURVEY BUREAU	
JOB NO.	01-01
DRWG. NO.	X 297