

**"REVISED"**

City of Detroit

**City Engineering Division, Department of Public Works  
Survey Bureau**

**NOTICE OF PROPOSED CHANGE IN PROPERTY**

Date: 10/24/2018

Petition: x296

- |   |  |
|---|--|
| <input type="checkbox"/> AT&T Telecommunication                       | <input type="checkbox"/> Berm Use                |
| <input type="checkbox"/> Comcast Television (CATV)                    | <input type="checkbox"/> Conversion to Easement  |
| <input type="checkbox"/> Detroit Edison (DTE)                         | <input type="checkbox"/> Dedication              |
| <input type="checkbox"/> Fire Department                              | <input checked="" type="checkbox"/> Encroachment |
| <input type="checkbox"/> Great Lakes Water Authority                  | <input type="checkbox"/> Outright Vacation       |
| <input type="checkbox"/> Land Bank Authority                          | <input type="checkbox"/> Temporary Closing       |
| <input type="checkbox"/> Michcon (DTE)                                |  |
| <input checked="" type="checkbox"/> Planning & Development Department |  |
| <input type="checkbox"/> Public Lighting Authority                    |  |
| <input type="checkbox"/> Public Lighting Department                   |  |
| <input type="checkbox"/> Police Department                            |  |
| <input type="checkbox"/> Solid Waste Division, DPW                    |  |
| <input type="checkbox"/> Street Design Bureau, DPW                    |  |
| <input type="checkbox"/> Street Maintenance Division, DPW             |  |
| <input type="checkbox"/> Traffic Engineering Division, DPW            |  |
| <input type="checkbox"/> Water and Sewerage Department                |  |
| <input type="checkbox"/> _____  |  |

A petition drawing is attached. Property shown on the attached print is proposed to be changed as indicated. Kindly report (using the back of this sheet) the nature of your services, if any affected by the proposed change and the estimated costs of removing and rerouting such services (if necessary).

Please return one copy to City Engineering Division, DPW within two weeks of the submittal date. Retain one copy and print for you file.

Ron Brundidge, Director, Department of Public Works

By: Richard Doherty, CED DPW  
City Engineer

TO: City Engineering Division, DPW  
2 Woodward Ave., Suite 642  
Detroit, Michigan 48226-3462  
Survey Bureau: 313-224-3970

Petition: x296  
**"REVISED"**

The proposed change in property (referred to on the other side of this sheet) would affect our services as follows:

- Not Involved**  
This revision adds a third underground monitoring well for the Leaking Underground Storage Tank (LUST) located at 1830 E. Eight Mile Rd. Subsurface work will be conducted in the alley, south of the subject site..
- Involved; but asking you to hold action on this petition until further notice.
- Involved; but no objections to the property change.
- Involved; objection to the property change.
- Involved; but no objections to the property change...provided as easement of the full width of the public right-of-way (street, alley or other public place) is reserved.
- Involved; the nature of our services and the estimated costs of removing and/or rerouting such services are:

Planning & Development Department  
(Utility or City Department)

  
By

Greg Moots-Lead Planner-Office of Zoning Innovation  
Title

Nov 5, 18  
Date

313-224-1358  
Area code – Telephone number

10/24/2018

PETITION NO. 296  
 PM ENVIRONMENTAL  
 3340 RANGER RD.  
 LANSING, MICHIGAN 48906  
 C/O LENA PAPPAS  
 PHONE NO. 248 336-9988



E. EIGHT MILE RD. 204 FT. WD.

**"REVISED"**

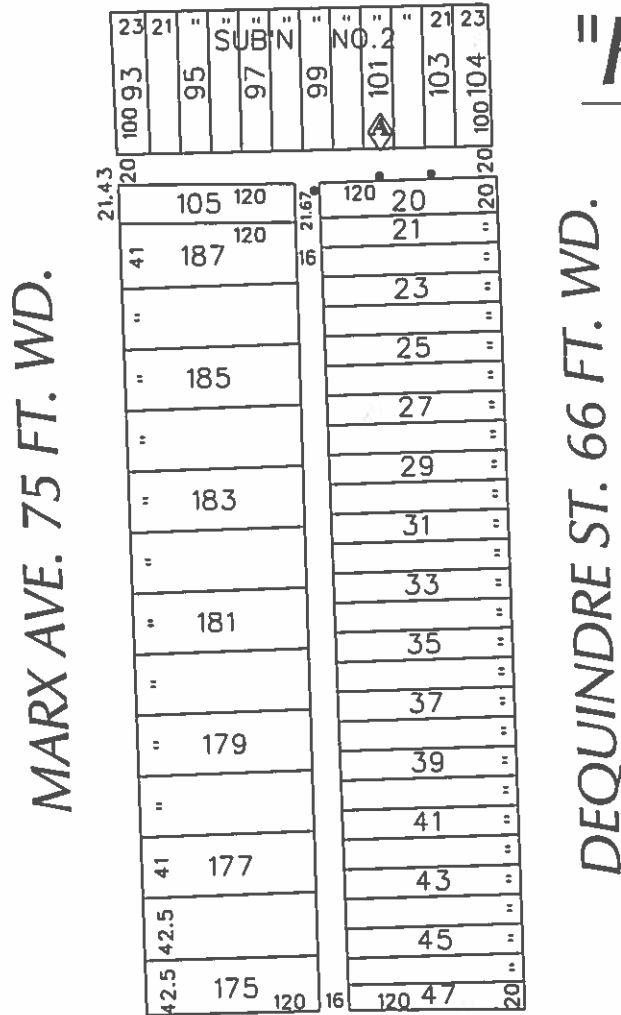

WINCHESTER AVE. 50 FT. WD.

● - REQUEST ENCROACHMENT  
 (With Monitoring Wells)

(FOR OFFICE USE ONLY)

CARTO 37 A

<b>B</b>					
<b>A</b>	ADDING A MONITORING WELL	WLW	KSM	KSM	10/24/18
	<b>DESCRIPTION</b>	<b>DRWN</b>	<b>CHKD</b>	<b>APPD</b>	<b>DATE</b>
<b>REVISIONS</b>					
<b>DRAWN BY</b>	WLW	<b>CHECKED</b>	KSM		
<b>DATE</b>	05-29-18	<b>APPROVED</b>			

REQUEST ENCROACHMENT  
 INTO THE EAST/WEST AND NORTH/SOUTH  
 PUBLIC ALLEYS VARIOUS WIDTHS  
 IN THE BLOCK BOUND BY  
 DEQUINDRE ST., WINCHESTER, MARX AVE.  
 AND E. EIGHT MILE RD.  
 (With Monitoring Wells)

<b>CITY OF DETROIT</b>	
CITY ENGINEERING DEPARTMENT	
SURVEY BUREAU	
<b>JOB NO.</b>	01-01
<b>DRWG. NO.</b>	X 296

