

TO: City Engineering Division, DPW  
2 Woodward Ave., Suite 642  
Detroit, MI 48226-3462  
Survey Bureau: 313-224-3970

Petition No. 283

The proposed change in property (referred to above) would affect our services as follows:

- Not Involved.
- Involved; but asking you to hold action on this petition until further notice.
- Involved; the nature of our services, and the estimated costs of removing and/or rerouting such services are:
- Involved; have no objection to the requested encroachment a portion of Orleans St. 50 ft wide and Dequindre St. 50 ft wide in the area bound by Superior, Riopelle St., Canfield Ave. and Dequindre St. for stair wells and concrete ramp and water main fire suppression lead as shown on drawing no. x283 dated 5/8/2018.

Traffic Engineering Division - DPW  
(Utility or City Department)

Ashok Patel

By

*Sunny Jacob*

City Traffic Engineer  
Title

June 13, 2018  
Date

313 224-1610  
Area code-Telephone number

MA/ma

PETITION NO. 283  
 SME  
 43980 PLYMOUTH OAKS BLVD.  
 PLYMOUTH, MICHIGAN 48170  
 C/O KIRT ANDERSEN P.E.  
 PHONE NO. 734 454-9900 EXT. 1157



CANFIELD AVE. 60 FT. WD.

CANFIELD AVE. 60 FT. WD.

RIOPELLE ST. 50 FT. WD.  
 VACATED

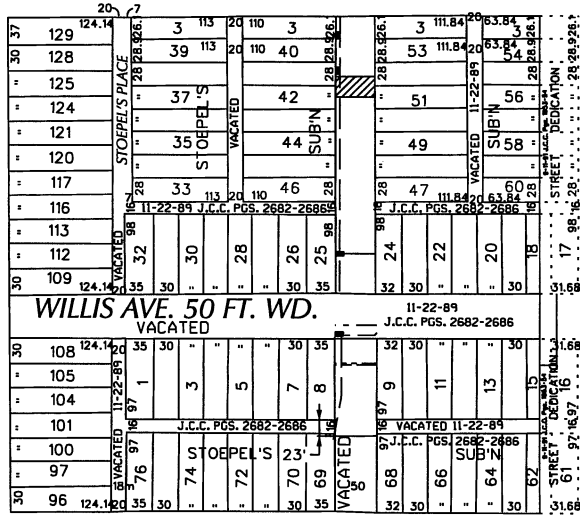

SUPERIOR ST.  
 50 FT. WD.  
 VACATED

ORLEANS ST.  
 50 FT. WD.

DEQUINDRE ST. 78 FT. WD.

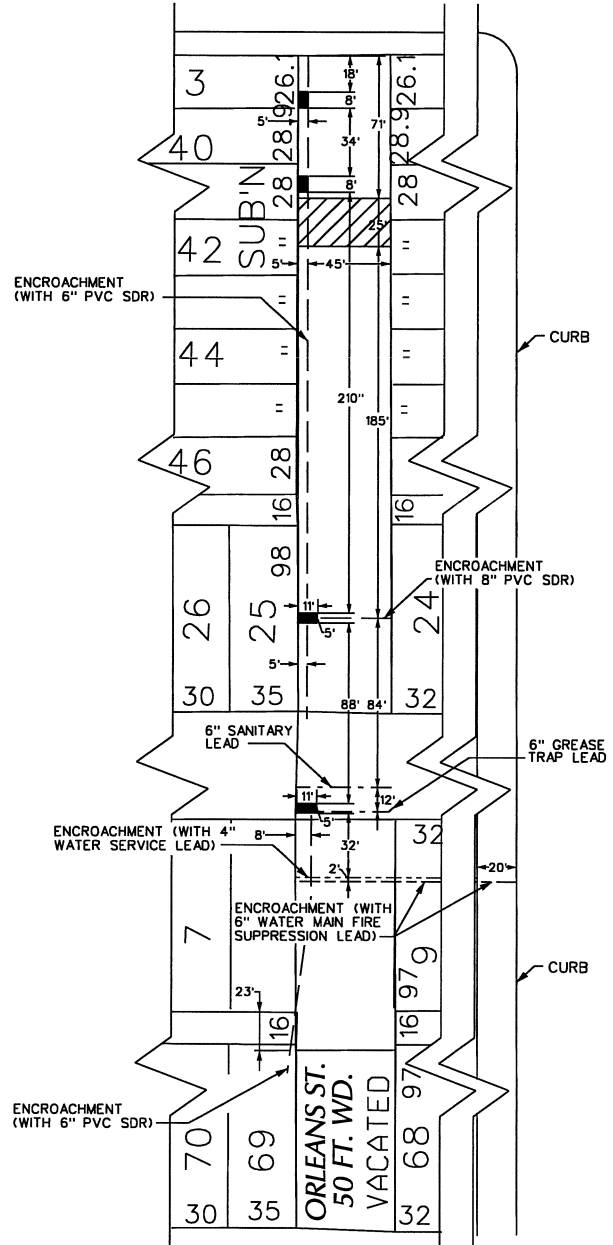

DEQUINDRE ST. 78 FT. WD.



- REQUEST ENCROACHMENT  
 (With Concrete Ramp)



- REQUEST ENCROACHMENT  
 (With Stair Wells)

(FOR OFFICE USE ONLY)

CARTO 40 D

<b>B</b>					<b>REQUEST ENCROACHMENT        A PORTION OF ORLEANS ST. 50 FT. WD.        AND DEQUINDRE ST. 78 FT. WD.        IN THE AREA BOUND BY        SUPERIOR, RIOPELLE ST., CANFIELD AVE.        AND DEQUINDRE ST.</b>	<b>CITY OF DETROIT        CITY ENGINEERING DEPARTMENT        SURVEY BUREAU</b>
	<b>REVISIONS</b>					
<b>A</b>						
	<b>DESCRIPTION</b>	<b>DRWN</b>	<b>CHKD</b>	<b>APPD</b>	<b>DATE</b>	
	<b>REVISIONS</b>					
	<b>DRAWN BY</b>	<b>CHECKED</b>		<b>APPROVED</b>		
	WLW	KSM		KSM		
	<b>DATE</b>	<b>APPROVED</b>				
	05-08-18					
						<b>JOB NO. 01-01</b>
						<b>DRWG. NO. X 283</b>