

City of Detroit
City Engineering Division, Department of Public Works
Survey Bureau

NOTICE OF PROPOSED CHANGE IN PROPERTY

Date: 04/18/2018

Petition: x151

- | | |
|--|--|
| <input type="checkbox"/> AT&T Telecommunication | <input type="checkbox"/> Berm Use |
| <input type="checkbox"/> Comcast Television (CATV) | <input type="checkbox"/> Conversion to Easement |
| <input checked="" type="checkbox"/> Detroit Edison (DTE) | <input type="checkbox"/> Dedication |
| <input type="checkbox"/> Fire Department | <input checked="" type="checkbox"/> Encroachment |
| <input type="checkbox"/> Great Lakes Water Authority | <input type="checkbox"/> Outright Vacation |
| <input type="checkbox"/> Land Bank Authority | <input type="checkbox"/> Temporary Closing |
| <input type="checkbox"/> Michcon (DTE) | |
| <input type="checkbox"/> Planning & Development Department | |
| <input type="checkbox"/> Public Lighting Authority | |
| <input type="checkbox"/> Public Lighting Department | |
| <input type="checkbox"/> Police Department | |
| <input type="checkbox"/> Solid Waste Division, DPW | |
| <input type="checkbox"/> Street Design Bureau, DPW | |
| <input type="checkbox"/> Street Maintenance Division, DPW | |
| <input type="checkbox"/> Traffic Engineering Division, DPW | |
| <input type="checkbox"/> Water and Sewerage Department | |
| <input type="checkbox"/> _____ | |

A petition drawing is attached. Property shown on the attached print is proposed to be changed as indicated. Kindly report (using the back of this sheet) the nature of your services, if any affected by the proposed change and the estimated costs of removing and rerouting such services (if necessary).

Please return one copy to City Engineering Division, DPW within two weeks of the submittal date. Retain one copy and print for you file.

Ron Brundidge, Director, Department of Public Works

By: Richard Doherty, CED DPW
City Engineer

**TO: City Engineering Division, DPW
2 Woodward Ave., Suite 642
Detroit, Michigan 48226-3462
Survey Bureau: 313-224-3970**

Petition: x151

The proposed change in property (referred to on the other side of this sheet) would affect our services as follows:

- Not Involved

- Involved; but asking you to hold action on this petition until further notice.

- Involved; but no objections to the property change.

- Involved; objection to the property change.

- Involved; but no objections to the property change...provided as easement of the full width of the public right-of-way (street, alley or other public place) is reserved.

- Involved; the nature of our services and the estimated costs of removing and/or rerouting such services are:

DJE ENERLY
(Utility or City Department)

CHRISTINE LEW
By

Sr. ENGINEER
Title

7/3/2018
Date

(313) 235-1884
Area code – Telephone number



EASTSIDE COMMUNITY NETWORK

Stronger, Together

4401 Conner, Detroit, MI 48215 • 313.571.2800 • FAX 313.571.7510

January 10, 2018

The Honorable City Council
Attn: Office of the City Clerk
200 Coleman A. Young Municipal Center
Detroit, MI 48226

RE: Petition Request for Eastside Community Network

Dear the Honorable Detroit City Council,

Eastside Community Network (ECN) is seeking approval to place a concrete curb inlet and trench drain in the right-of-way in front of the following properties: 5503, 5511, and 5517 Newport Street. These addresses represent three vacant parcels owned by ECN.

ECN has received a grant from the Kresge Foundation to build a stormwater park in the Chandler Park neighborhood to serve as a park/community gathering space and outdoor learning lab as well as to help manage stormwater in the neighborhood. The proposed park is located on corner lots across from Hamilton Academy, a K-8 school.

The concrete curb inlet and trench drain are proposed in the right-of-way to collect stormwater from Newport Street and divert it into two proposed rain gardens, which will be located within the property owned by ECN. In addition to rain gardens, the park provides community and school amenities such as interpretive signage, benches, picnic tables, and an outdoor classroom. The plans for the park, as well as a model of the proposed inlet and trench drain, are attached to this letter.

Construction for this project will occur in spring 2018. Included with this letter are two renderings of the site. We have hired InSite Design to assist with the planning and implementation of this project.

Sincerely,

Donna Givens
President/CEO

Attachments

PETITION NO. 151
 EASTSIDE COMMUNITY NETWORK
 4401 CONNER AVE.
 DETROIT, MICHIGAN 48215
 C/O LINDSEY NELSON
 PHONE NO. 734 995-4194

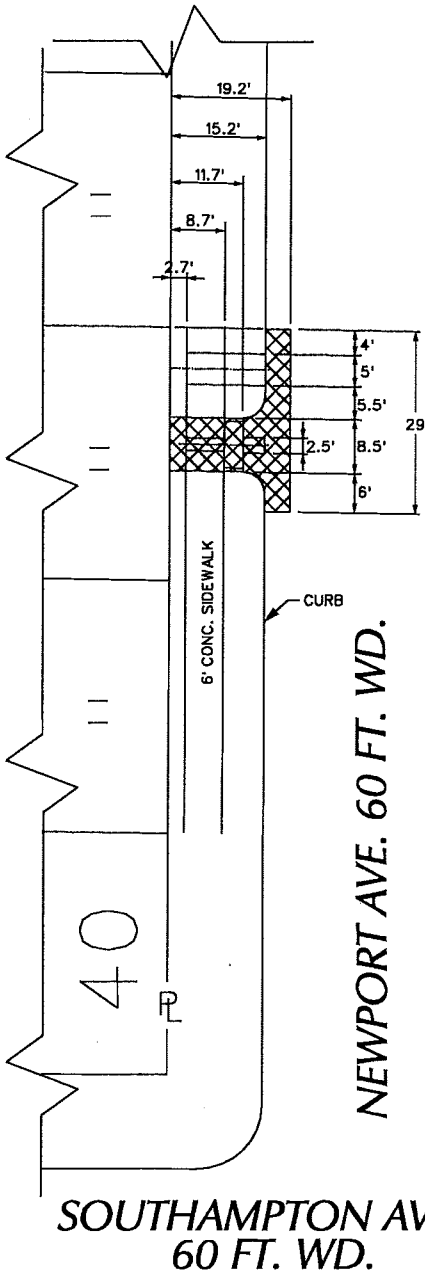

CHANDLER PARK DR. 150 FT. WD.

EASTLAWN AVE. 100 FT. WD.

27.5	2	152.34	28.9	53	54
35	3			40	39
"					
"	5				
"				18 137	18 137
"	7			107	41
"					40
"	9	7			"
"				43	"
"	11				"
"				45	"
"	13				"
"				47	"
"	15				"
"				49	"
37.5 35	17	152.34	28.9	107	50
					40

NEWPORT AVE. 60 FT. WD.

SOUTHAMPTON AVE. 60 FT. WD.



- REQUEST ENCROACHMENT
 (With Concrete Curb Inlet, Trench Drain
 Cobble Spillway, Concrete Curbs and Concrete Sidewalks)
 (FOR OFFICE USE ONLY)

CARTO 64 B

B					
A					
DESCRIPTION		DRWN	CHKD	APPD	DATE
REVISIONS					
DRAWN BY	WLW	CHECKED	KSM		
DATE	04-18-18	APPROVED			

REQUEST ENCROACHMENT
 INTO NEWPORT
 5503, 5511 AND 5517 NEWPORT AVE.
 (With Concrete Curb Inlet, Trench Drain
 Cobble Spillway, Concrete Curbs
 and Concrete Sidewalks)

CITY OF DETROIT CITY ENGINEERING DEPARTMENT SURVEY BUREAU	
JOB NO.	01-01
DRWG. NO.	X 151

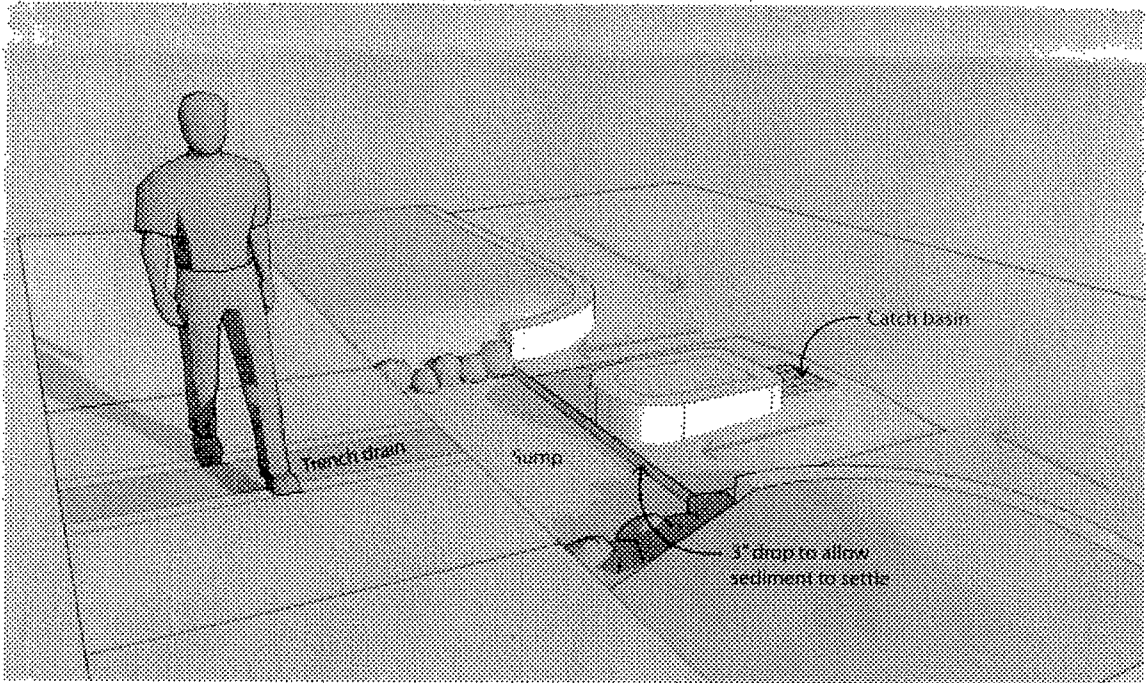
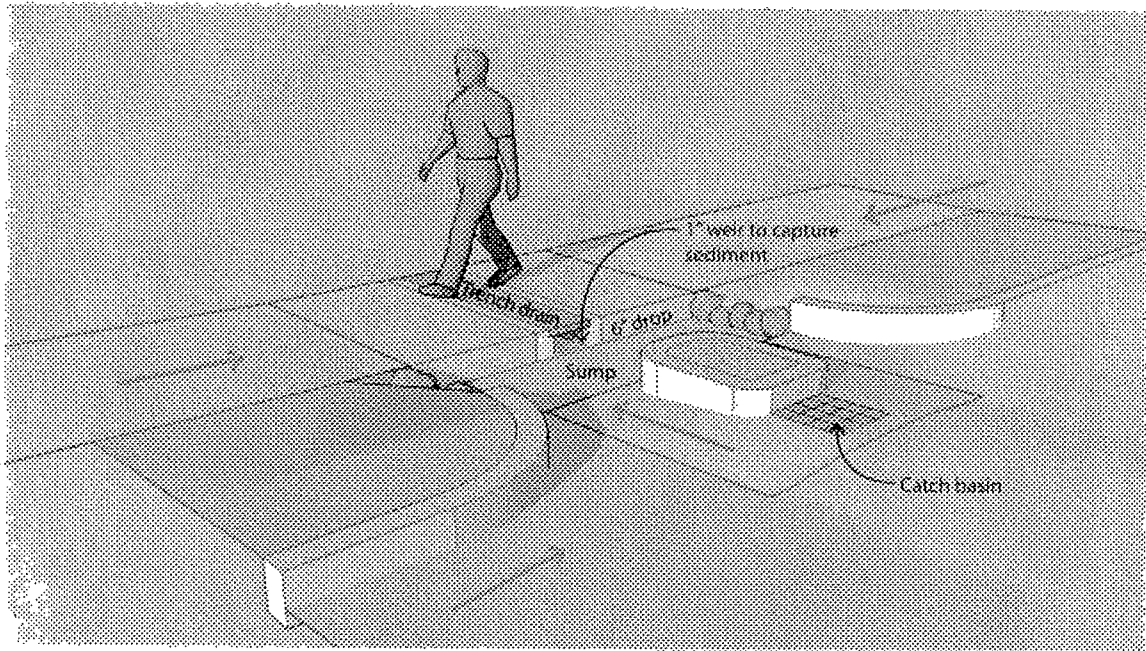

Hamilton Rain Garden Learning Lab
INLET MODEL

September 15, 2017



Hamilton Rain Garden Learning Lab

5503-5517 Newport Street, Detroit, Michigan

INSITE
 InSite Design Studio, Inc.
 415 Cass Street
 Detroit, MI 48226
 Phone: 313.466.4194
 Fax: 313.466.4194

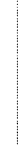
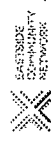

Project:
 Hamilton Rain Garden Learning Lab

Date:
 11/15/2011
 11/15/2011
 11/15/2011
 11/15/2011
 11/15/2011

Drawn by: LM

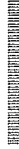

Title:
 Cover

Sheet:
 L-0

Copyright © 2011 InSite Design Studio, Inc.

Client:
 Eastside Community Network
 4401 Corner Street
 Detroit, Michigan 48215

Landscape Architect:
 Shannon Gibb-Randall
 InSite Design Studio
 412 Longshore Drive
 Ann Arbor, MI 48105
 e: sgibb-randall@insite-studio.com
 p: 734-995-4194

Street Index:
 L-0 Cover
 L-1 Demolition and SESC Plan
 L-2 Site Plan
 L-3 Grading Plan
 L-4 Planting Plan

NOTES
 1. Eastside Community Network is the owner of this project and will be responsible for its maintenance.

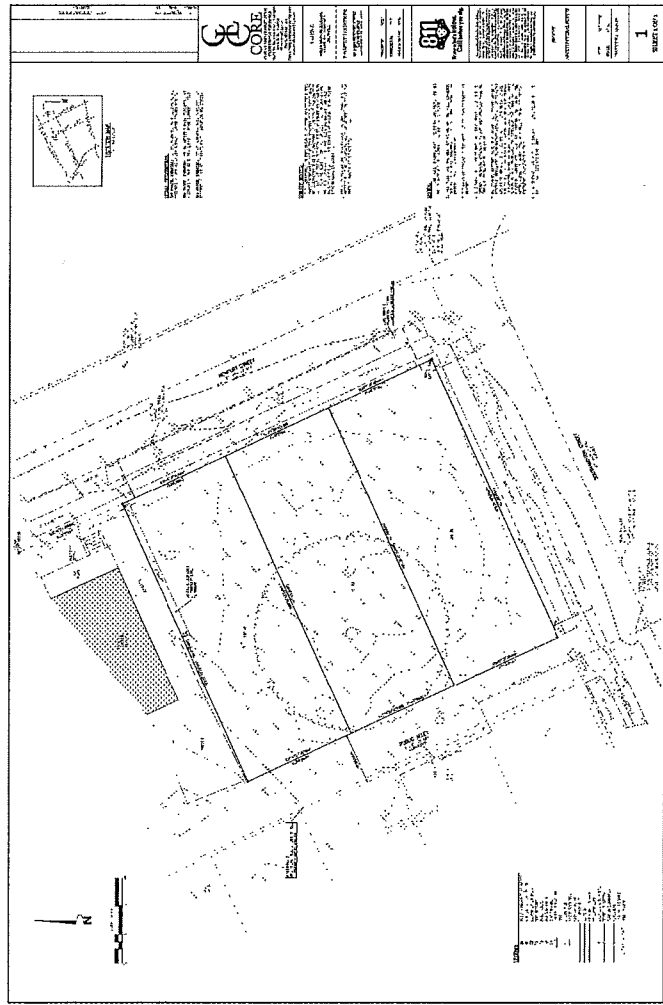

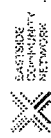

Drawn by: LAM
 Checked by: LAM
 Date: 11/15/2017
 Scale: 1" = 10'-0"

- EXTRACTION JOINTS**
1. ALL JOINTS SHALL BE CONCRETE ON CONCRETE.
 2. JOINTS SHALL BE LOCATED AT THE FOLLOWING LOCATIONS:
 3. AT THE PERIMETER OF THE RAINGARDEN.
 4. AT THE PERIMETER OF THE RAINGARDEN AT THE POINTS OF CHANGE IN THE SHAPE OF THE RAINGARDEN.
 5. AT THE PERIMETER OF THE RAINGARDEN AT THE POINTS OF CHANGE IN THE MATERIAL OF THE RAINGARDEN.
 6. AT THE PERIMETER OF THE RAINGARDEN AT THE POINTS OF CHANGE IN THE FINISH OF THE RAINGARDEN.
 7. AT THE PERIMETER OF THE RAINGARDEN AT THE POINTS OF CHANGE IN THE SLOPE OF THE RAINGARDEN.
 8. AT THE PERIMETER OF THE RAINGARDEN AT THE POINTS OF CHANGE IN THE CURVE OF THE RAINGARDEN.
 9. AT THE PERIMETER OF THE RAINGARDEN AT THE POINTS OF CHANGE IN THE DIRECTION OF THE RAINGARDEN.
 10. AT THE PERIMETER OF THE RAINGARDEN AT THE POINTS OF CHANGE IN THE WIDTH OF THE RAINGARDEN.
 11. AT THE PERIMETER OF THE RAINGARDEN AT THE POINTS OF CHANGE IN THE DEPTH OF THE RAINGARDEN.
 12. AT THE PERIMETER OF THE RAINGARDEN AT THE POINTS OF CHANGE IN THE LENGTH OF THE RAINGARDEN.
 13. AT THE PERIMETER OF THE RAINGARDEN AT THE POINTS OF CHANGE IN THE AREA OF THE RAINGARDEN.
 14. AT THE PERIMETER OF THE RAINGARDEN AT THE POINTS OF CHANGE IN THE VOLUME OF THE RAINGARDEN.
 15. AT THE PERIMETER OF THE RAINGARDEN AT THE POINTS OF CHANGE IN THE WEIGHT OF THE RAINGARDEN.
 16. AT THE PERIMETER OF THE RAINGARDEN AT THE POINTS OF CHANGE IN THE MASS OF THE RAINGARDEN.
 17. AT THE PERIMETER OF THE RAINGARDEN AT THE POINTS OF CHANGE IN THE FORCE OF THE RAINGARDEN.
 18. AT THE PERIMETER OF THE RAINGARDEN AT THE POINTS OF CHANGE IN THE ENERGY OF THE RAINGARDEN.
 19. AT THE PERIMETER OF THE RAINGARDEN AT THE POINTS OF CHANGE IN THE MOMENT OF THE RAINGARDEN.
 20. AT THE PERIMETER OF THE RAINGARDEN AT THE POINTS OF CHANGE IN THE POWER OF THE RAINGARDEN.

2 City of Detroit Sidewalk Jointing Standard
 NO SCALE

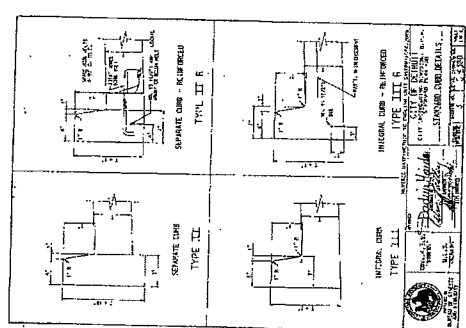

3 City of Detroit Standard Curb Details
 NO SCALE

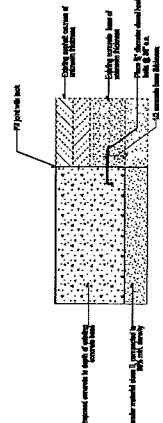

4 Joint Between Existing and Proposed Pavements
 NO SCALE

- LEGEND**
- 1. Proposed Sidewalk
 - 2. Existing Sidewalk
 - 3. Existing Street
 - 4. Existing Utility
 - 5. Existing Tree
 - 6. Existing Plant
 - 7. Existing Light Pole
 - 8. Existing Sign Pole
 - 9. Existing Street Light
 - 10. Existing Street Sign
 - 11. Existing Street Furniture
 - 12. Existing Street Structure
 - 13. Existing Street Enclosure
 - 14. Existing Street Barrier
 - 15. Existing Street Edge
 - 16. Existing Street Corner
 - 17. Existing Street Intersection
 - 18. Existing Street Junction
 - 19. Existing Street Connection
 - 20. Existing Street Transition
 - 21. Existing Street Change
 - 22. Existing Street Shift
 - 23. Existing Street Turn
 - 24. Existing Street Bend
 - 25. Existing Street Curve
 - 26. Existing Street Arc
 - 27. Existing Street Spiral
 - 28. Existing Street S-curve
 - 29. Existing Street Z-curve
 - 30. Existing Street Loop
 - 31. Existing Street Circle
 - 32. Existing Street Oval
 - 33. Existing Street Polygon
 - 34. Existing Street Star
 - 35. Existing Street Cross
 - 36. Existing Street Square
 - 37. Existing Street Rectangle
 - 38. Existing Street Triangle
 - 39. Existing Street Circle
 - 40. Existing Street Oval
 - 41. Existing Street Polygon
 - 42. Existing Street Star
 - 43. Existing Street Cross
 - 44. Existing Street Square
 - 45. Existing Street Rectangle
 - 46. Existing Street Triangle
 - 47. Existing Street Circle
 - 48. Existing Street Oval
 - 49. Existing Street Polygon
 - 50. Existing Street Star

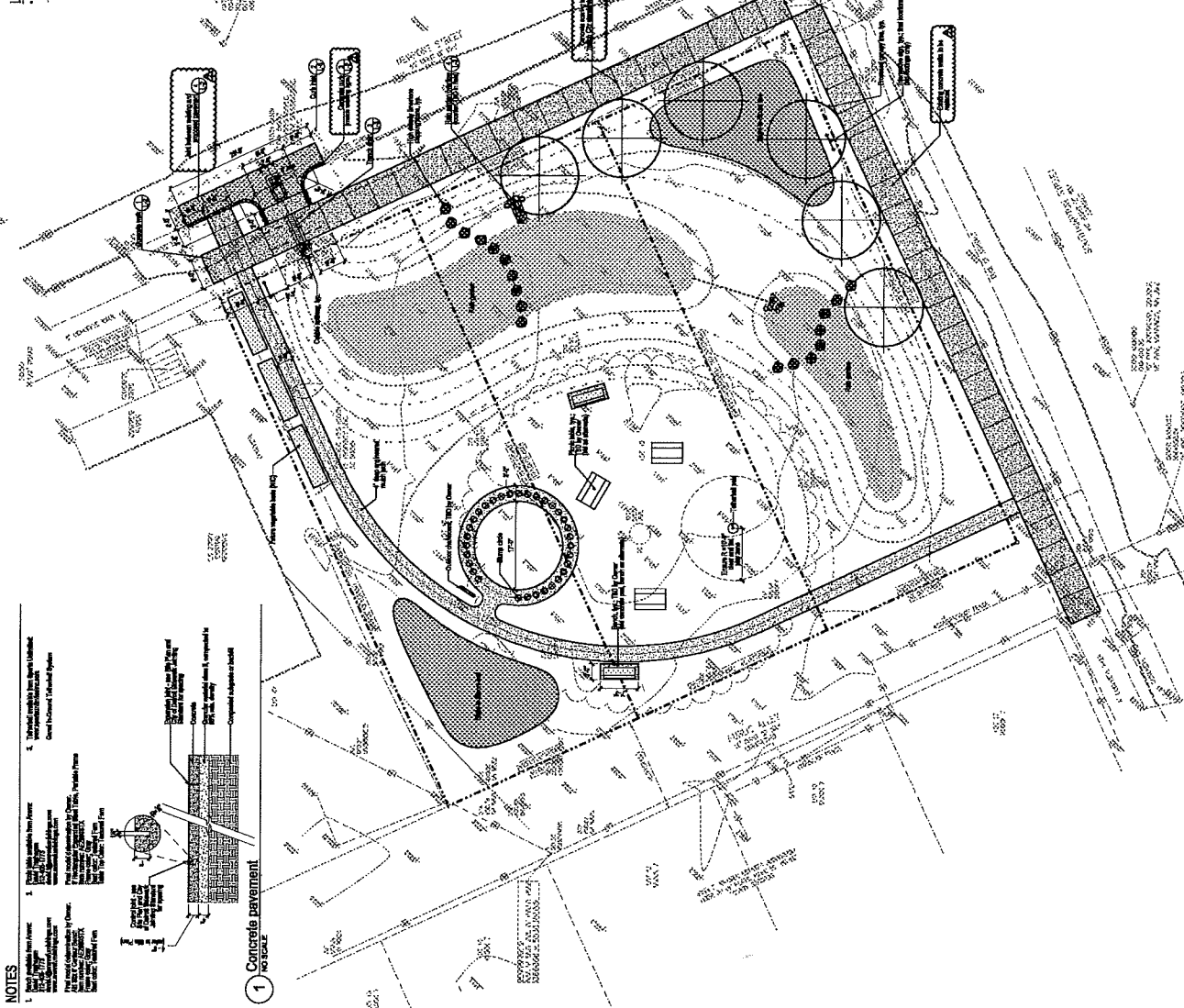

- NOTES**
1. See General Notes for details on materials and construction.
 2. See General Notes for details on planting and maintenance.
 3. See General Notes for details on structural elements.
 4. See General Notes for details on site preparation.
 5. See General Notes for details on drainage and water management.
 6. See General Notes for details on safety and accessibility.
 7. See General Notes for details on environmental considerations.
 8. See General Notes for details on construction methods.
 9. See General Notes for details on quality control and inspection.
 10. See General Notes for details on project completion and handover.

1 Concrete pavement
 NO SCALE

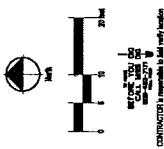

Scale: 1" = 10'-0"
 Date: 11/15/2017
 Project: Hamilton Rain Garden

