

City of Detroit
**City Engineering Division, Department of Public Works
Survey Bureau**

NOTICE OF PROPOSED CHANGE IN PROPERTY

Date: _____
03/02/2018 Petition:
_____ x145

- | | |
|------------------------------------------------------------|--------------------------------------------------------|
| <input type="checkbox"/> AT&T Telecommunication | |
| <input type="checkbox"/> Comcast Television (CATV) | <input type="checkbox"/> Berm Use |
| <input type="checkbox"/> Detroit Edison (DTE) | |
| Fire Department | <input checked="" type="checkbox"/> Conversion to |
| <input type="checkbox"/> Great Lakes Water Authority | Easement |
| <input type="checkbox"/> Land Bank Authority | |
| <input type="checkbox"/> Michcon (DTE) | <input type="checkbox"/> Dedication |
| <input type="checkbox"/> Planning & Development Department | |
| <input type="checkbox"/> Public Lighting Authority | <input type="checkbox"/> Encroachment |
| <input type="checkbox"/> Public Lighting Department | |
| <input checked="" type="checkbox"/> Police Department | <input checked="" type="checkbox"/> Outright Vacation |
| <input type="checkbox"/> Solid Waste Division, DPW | |
| <input type="checkbox"/> | <input type="checkbox"/> Temporary Closing |
| <input type="checkbox"/> Street Design Bureau, DPW | |
| <input type="checkbox"/> Street Maintenance Division, DPW | |
| <input type="checkbox"/> Traffic Engineering Division, DPW | |
| <input type="checkbox"/> Water and Sewerage Department | |
| <input type="checkbox"/> _____ | |

A petition drawing is attached. Property shown on the attached print is proposed to be changed as indicated. Kindly report (using the back of this sheet) the nature of your services, if any affected by the proposed change and the estimated costs of removing and rerouting such services (if necessary).

Please return one copy to City Engineering Division, DPW within two weeks of the submittal date. Retain one copy and print for you file.

Ron Brundidge, Director, Department of Public Works

By: Richard Doherty, CED DPW
 City Engineer

**TO: City Engineering Division, DPW
Woodward Ave., Suite 642
Detroit, Michigan 48226-3462
Survey Bureau: 313-224-3970**

Petition: _____ x145 2

The proposed change in property (referred to on the other side of this sheet) would affect our services as follows:

- Not Involved
- Involved; but asking you to hold action on this petition until further notice.
- Involved; but no objections to the property change.
- Involved; objection to the property change.
- Involved; but no objections to the property change...provided as easement of the full width of the public right-of-way (street, alley or other public place) is reserved.
- Involved; the nature of our services and the estimated costs of removing and/or rerouting such services are:

DETROIT POLICE DEPT 3RD PCT
(Utility or City Department)

CHRIS GIBSON By

POLICE OFFICER 4619 CORE ENFORCEMENT
Title

03-07-2018 Date

313 596-1310, 596-1363
Area code – Telephone number

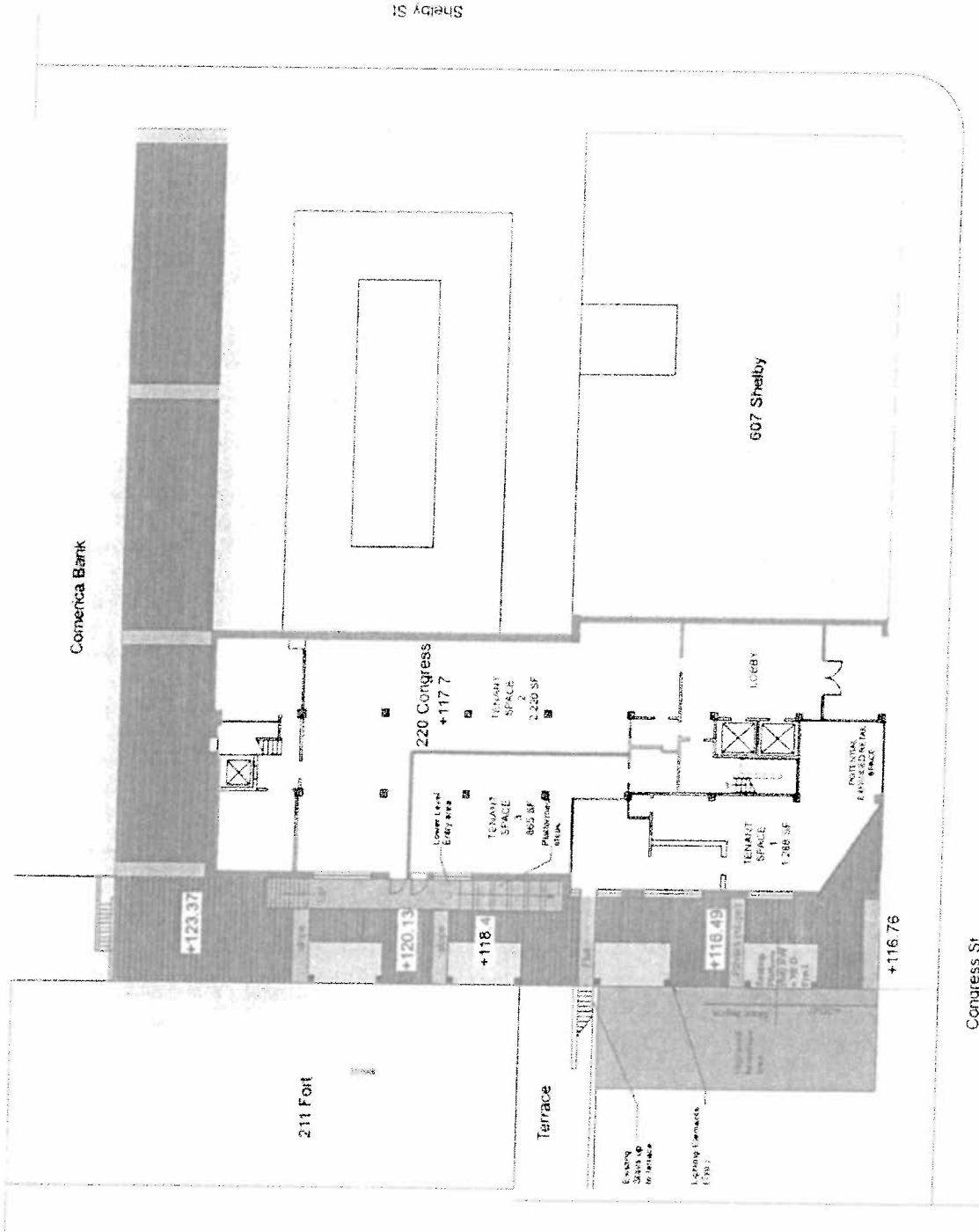

220 Congress, Shelby, Passage
MAY 16, 2017
Concept Site Plan

Shelby St

Comerica Bank

607 Shelby

Congress St.

211 Foit

Terrace

Existing Steps up to Terrace

Lighting Terrace (300)

Plumbing Room

Staircase

Lobby

POTENTIAL EXPANSION SPACE

Tenant Space 1 860 SF

Tenant Space 2 2,220 SF

220 Congress +117.7

+123.37

+120.13

+118.4

+116.49

+116.78