

City of Detroit  
**City Engineering Division, Department of Public Works**  
**Survey Bureau**

NOTICE OF PROPOSED CHANGE IN PROPERTY

Date: 04/17/2018

Petition: x125

- |  |  |
|--|--|
| <input type="checkbox"/> AT&T Telecommunication            |  |
| <input type="checkbox"/> Comcast Television (CATV)         | <input type="checkbox"/> Berm Use                |
| <input type="checkbox"/> Detroit Edison (DTE)              |  |
| <input type="checkbox"/> Fire Department                   | <input type="checkbox"/> Conversion to Easement  |
| <input type="checkbox"/> Great Lakes Water Authority       |  |
| <input type="checkbox"/> Land Bank Authority               | <input type="checkbox"/> Dedication              |
| <input type="checkbox"/> Michcon (DTE)                     |  |
| <input type="checkbox"/> Planning & Development Department | <input checked="" type="checkbox"/> Encroachment |
| <input type="checkbox"/> Public Lighting Authority         |  |
| <input type="checkbox"/> Public Lighting Department        | <input type="checkbox"/> Outright Vacation       |
| <input checked="" type="checkbox"/> Police Department      |  |
| <input type="checkbox"/> Solid Waste Division, DPW         | <input type="checkbox"/> Temporary Closing       |
| <input type="checkbox"/> Street Design Bureau, DPW         |  |
| <input type="checkbox"/> Street Maintenance Division, DPW  |  |
| <input type="checkbox"/> Traffic Engineering Division, DPW |  |
| <input type="checkbox"/> Water and Sewerage Department     |  |
| <input type="checkbox"/> _____                             |  |

A petition drawing is attached. Property shown on the attached print is proposed to be changed as indicated. Kindly report (using the back of this sheet) the nature of your services, if any affected by the proposed change and the estimated costs of removing and rerouting such services (if necessary).

Please return one copy to City Engineering Division, DPW within two weeks of the submittal date. Retain one copy and print for you file.

Ron Brundidge, Director, Department of Public Works

By: Richard Doherty, CED DPW  
City Engineer

TO: City Engineering Division, DPW  
2 Woodward Ave., Suite 642  
Detroit, Michigan 48226-3462  
Survey Bureau: 313-224-3970

Petition: x125

The proposed change in property (referred to on the other side of this sheet) would affect our services as follows:

- Not Involved
- Involved; but asking you to hold action on this petition until further notice.
- Involved; but no objections to the property change.
- Involved; objection to the property change.
- Involved; but no objections to the property change... provided as easement of the full width of the public right-of-way (street, alley or other public place) is reserved.
- Involved; the nature of our services and the estimated costs of removing and/or rerouting such services are:

DETROIT POLICE DEPT 3RD PCT  
(Utility or City Department)

CHRIS GIBSON 4649  
By

POLICE OFFICER 4649 CODE ENFORCEMENT  
Title

4-17-2018  
Date

313 596-1310, 596-1363  
Area code - Telephone number

**APPROVED**  
4/19/2018  
  
THIRD PRECINCT  
COMMANDER

NOTES

- 1. VERIFY ALL UTILITIES AND RECORD THEM AS SHOWN ON THIS PLAN.
- 2. VERIFY ALL UTILITIES AND RECORD THEM AS SHOWN ON THIS PLAN.
- 3. VERIFY ALL UTILITIES AND RECORD THEM AS SHOWN ON THIS PLAN.
- 4. VERIFY ALL UTILITIES AND RECORD THEM AS SHOWN ON THIS PLAN.
- 5. VERIFY ALL UTILITIES AND RECORD THEM AS SHOWN ON THIS PLAN.
- 6. VERIFY ALL UTILITIES AND RECORD THEM AS SHOWN ON THIS PLAN.
- 7. VERIFY ALL UTILITIES AND RECORD THEM AS SHOWN ON THIS PLAN.
- 8. VERIFY ALL UTILITIES AND RECORD THEM AS SHOWN ON THIS PLAN.
- 9. VERIFY ALL UTILITIES AND RECORD THEM AS SHOWN ON THIS PLAN.
- 10. VERIFY ALL UTILITIES AND RECORD THEM AS SHOWN ON THIS PLAN.

UTILITY STATEMENT

THE INFORMATION ON THIS PLAN WAS OBTAINED FROM THE RECORD DRAWINGS AND FIELD SURVEY. THE ENGINEER HAS CONDUCTED A VISUAL INSPECTION OF THE UTILITIES SHOWN ON THIS PLAN. THE ENGINEER HAS NOT CONDUCTED A TEST OF ANY UTILITIES SHOWN ON THIS PLAN. THE ENGINEER HAS NOT CONDUCTED A TEST OF ANY UTILITIES SHOWN ON THIS PLAN.

PROJECT NO. 15123  
 DATE: 10/15/11  
 DRAWN BY: J. [Name]  
 CHECKED BY: [Name]

MATCHLINE SEE SHEET 111

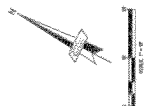
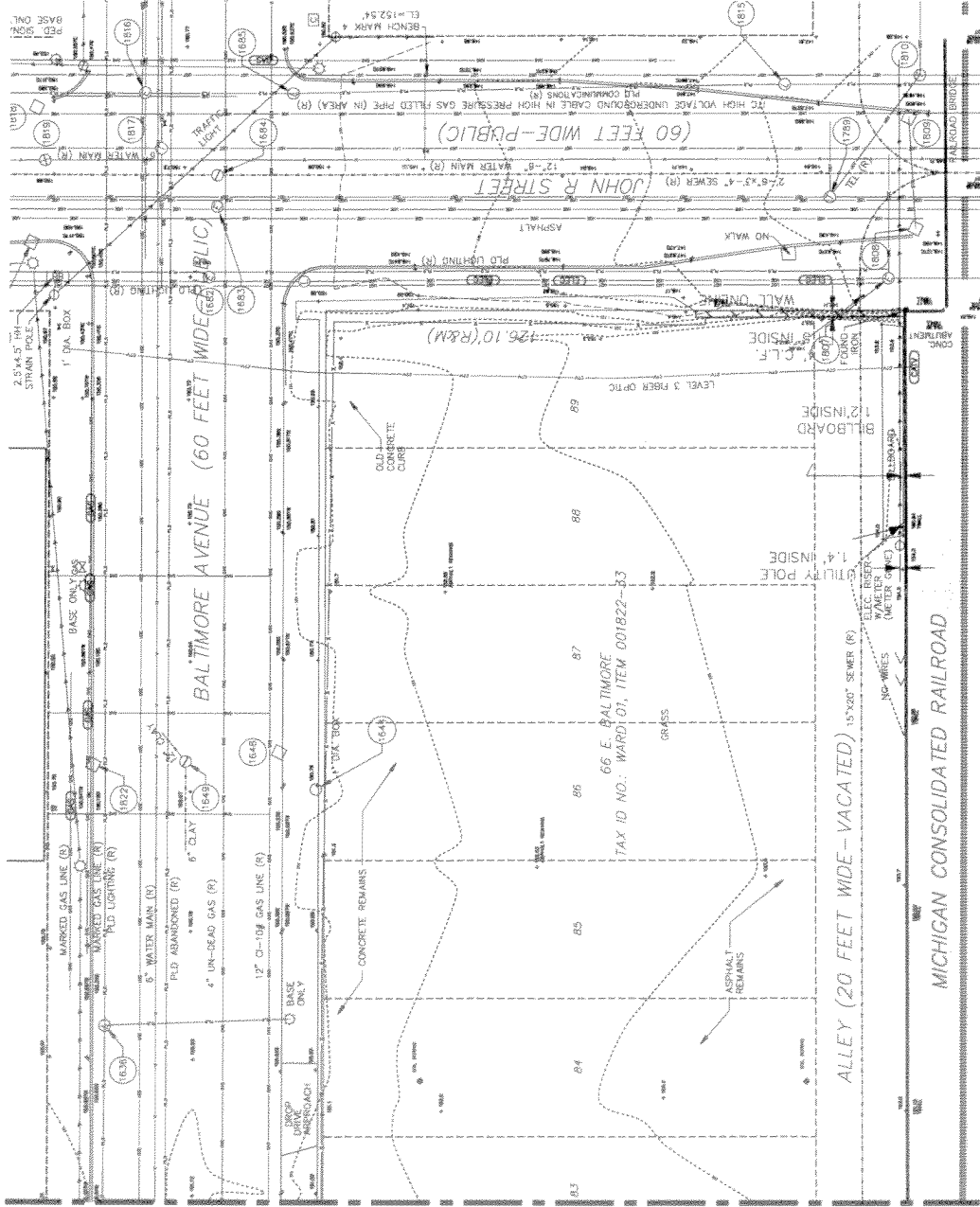

**APPROVED**  
 OF AN  
**SITE PLAN**  
**REVIEW**

PROJECT: 15123  
 DATE: 10/15/11  
 SLU #: 15123/001

AUTHORIZED REP: [Name]  
 PROJECT: 15123  
 DATE: 10/15/11  
 SLU #: 15123/001

ARCHITECTS  
 408 West...  
 Los Angeles, CA 90018  
 310.887.4343  
 www.giffelswebster.com

66 EAST  
 BALTIMORE



giffels  
 webster

NO.	DATE	DESCRIPTION

NOT FOR  
 CONSTRUCTION

SHEET	DATE

Existing Conditions  
 East

C1.11

AUTHORIZED REP: [Signature]  
 PROJECT: [Text]  
 DATE: [Text]  
 S.U.O. SUBJECTS: [Text]

LOCATION MAP  
 (SEE P. 140)

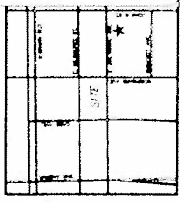

	CONCRETE PAVING
	ASPHALT PAVING
	BRICK PAVING
	GRANITE PAVING
	COBBLESTONE PAVING
	GRANITE CURBS
	BRICK CURBS
	GRANITE CURBS
	CONCRETE CURBS

NOTES

- SEE THE PLAN FOR ALL DIMENSIONS AND NOTATIONS.
- ALL DIMENSIONS ARE TO FACE UNLESS OTHERWISE NOTED.
- SEE THE PLAN FOR ALL DIMENSIONS AND NOTATIONS.
- SEE THE PLAN FOR ALL DIMENSIONS AND NOTATIONS.
- SEE THE PLAN FOR ALL DIMENSIONS AND NOTATIONS.

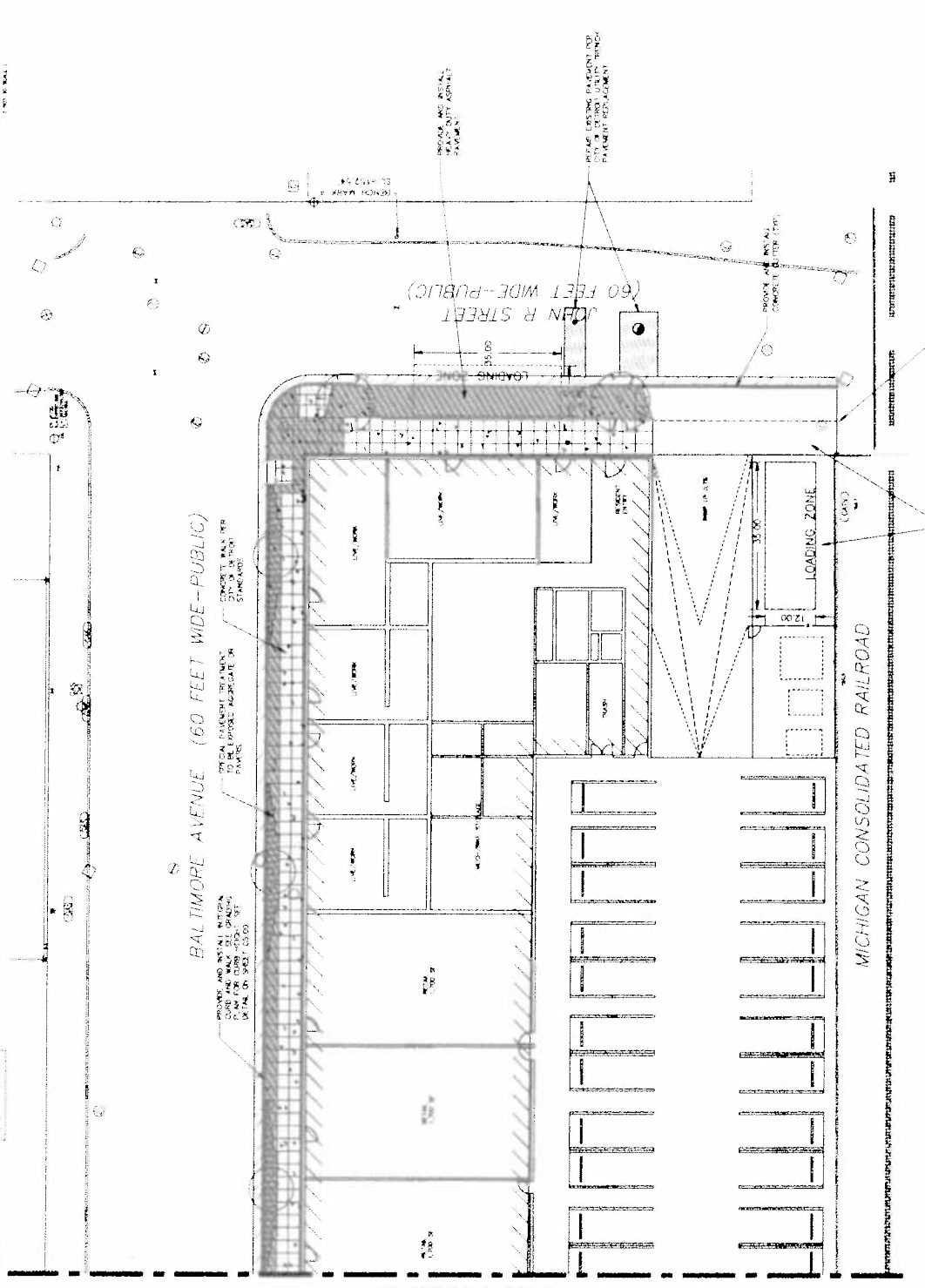

MATCHLINE SEE SHEET 140

NOT FOR  
 CONSTRUCTION

giffels & webster

86 EAST  
 BALTIMORE





PROJECT: PR-126  
DATE: 05/07  
NO. 9 AUGUST 2007



UNIT PAVERS ON 6" AGGREGATE WITH CURB



UNIT PAVERS ON 6" CONCRETE BASE

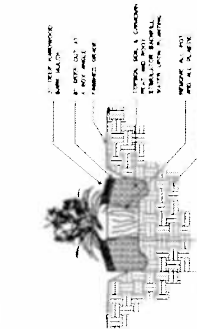

PERENNIAL PLANTING DETAIL

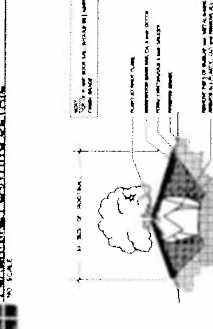

SHRUB PLANTING DETAIL

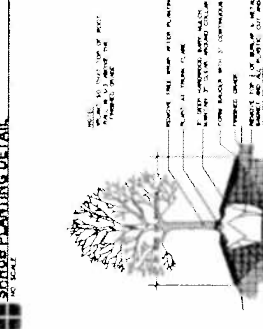

DECIDUOUS TREE PLANTING DETAIL

THE PLATFORM

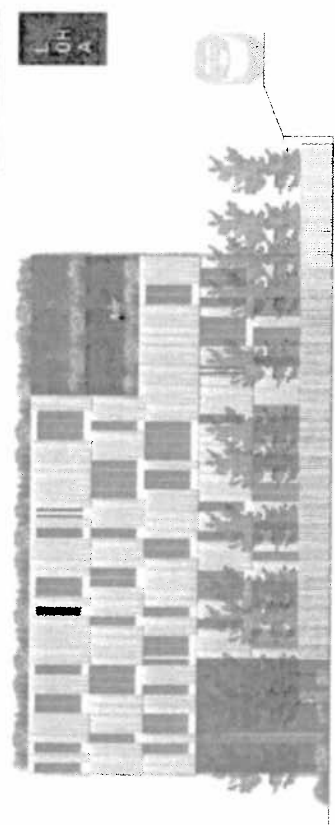

SLAT SCREEN FENCE WEST ELEVATION

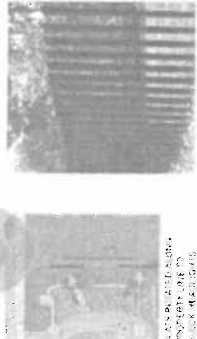
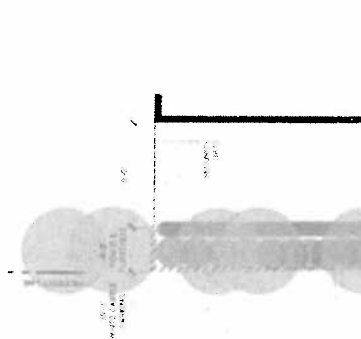

SLAT SCREEN FENCE - 6 FT

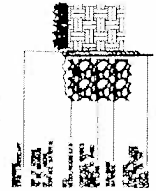
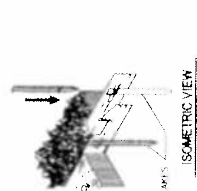

STEEL EDGING

66 EAST BALTIMORE



giffels webster

Landscape Details