

**City of Detroit
City Engineering Division, Department of Public Works
Survey Bureau**

NOTICE OF PROPOSED CHANGE IN PROPERTY

Date: 08/31/2018

Petition: x113

- | | |
|---|---|
| <input type="checkbox"/> AT&T Telecommunication | <input type="checkbox"/> Berm Use |
| <input type="checkbox"/> Comcast Television (CATV) | <input type="checkbox"/> Conversion to Easement |
| <input type="checkbox"/> Detroit Edison (DTE) | <input type="checkbox"/> Dedication |
| <input type="checkbox"/> Fire Department | <input type="checkbox"/> Encroachment |
| <input type="checkbox"/> Great Lakes Water Authority | <input type="checkbox"/> Encroachment |
| <input type="checkbox"/> Land Bank Authority | <input type="checkbox"/> Encroachment |
| <input type="checkbox"/> Michcon (DTE) | <input type="checkbox"/> Encroachment |
| <input checked="" type="checkbox"/> Planning & Development Department | <input type="checkbox"/> Encroachment |
| <input type="checkbox"/> Public Lighting Authority | <input checked="" type="checkbox"/> Outright Vacation |
| <input type="checkbox"/> Public Lighting Department | <input type="checkbox"/> Temporary Closing |
| <input type="checkbox"/> Police Department | |
| <input type="checkbox"/> Solid Waste Division, DPW | |
| <input type="checkbox"/> Street Design Bureau, DPW | |
| <input type="checkbox"/> Street Maintenance Division, DPW | |
| <input type="checkbox"/> Traffic Engineering Division, DPW | |
| <input type="checkbox"/> Water and Sewerage Department | |
| <input type="checkbox"/> _____ | |

A petition drawing is attached. Property shown on the attached print is proposed to be changed as indicated. Kindly report (using the back of this sheet) the nature of your services, if any affected by the proposed change and the estimated costs of removing and rerouting such services (if necessary).

Please return one copy to City Engineering Division, DPW within two weeks of the submittal date. Retain one copy and print for you file.

Ron Brundidge, Director, Department of Public Works

By: Richard Doherty, CED DPW
City Engineer

TO: City Engineering Division, DPW
2 Woodward Ave., Suite 642
Detroit, Michigan 48226-3462
Survey Bureau: 313-224-3970

Petition: x113

The proposed change in property (referred to on the other side of this sheet) would affect our services as follows:

- Not Involved
- Involved; but asking you to hold action on this petition until further notice.
- Involved; but no objections to the property change.
The traffic circle and the impact of the vacation on the entrance to Mt. Elliott park should be clearly noted on the map.
- Involved; objection to the property change.
- Involved; but no objections to the property change...provided as easement of the full width of the public right-of-way (street, alley or other public place) is reserved.
- Involved; the nature of our services and the estimated costs of removing and/or rerouting such services are:

Planning & Development Department
(Utility or City Department)

By

Greg Moots-Lead Planner-Office of Zoning Innovation
Title

Oct 9, '18
Date

313-224-1358
Area code – Telephone number

PETITION NO. 113
 BB&E INC.
 C/O U.S. COAST GUARD
 235 E. MAIN ST. SUITE 107
 NORTHVILLE, MICHIGAN 48167
 C/O SEAN P. MCNALLY
 PHONE NO. 248 359-7317



E. JEFFERSON AVE. 120 FT. WD.

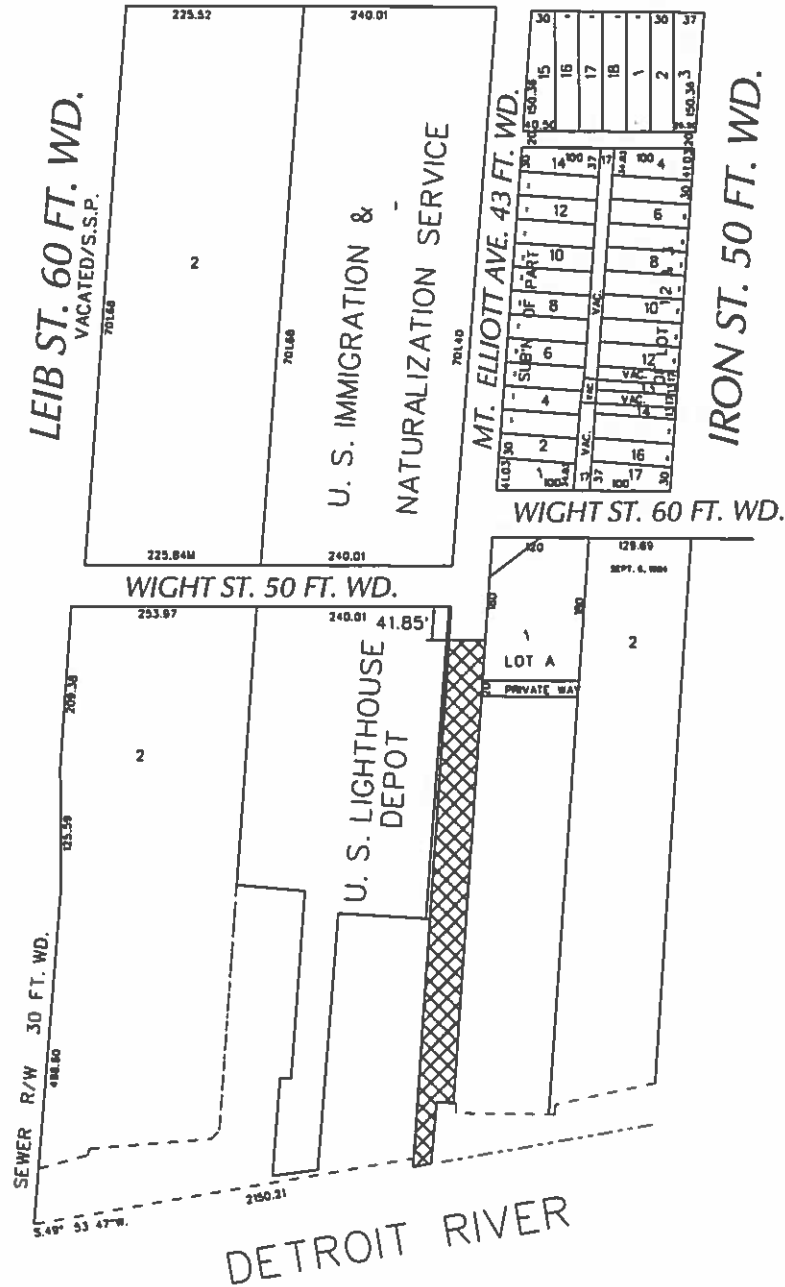

- OUTRIGHT VACATION

(FOR OFFICE USE ONLY)

CARTO 38 F & 46 D

B					
A					
DESCRIPTION		DRWN	CHEK	APPD	DATE
REVISIONS					
DRAWN BY	WLW	CHECKED	KSM		
DATE	08-31-18	APPROVED			

REQUEST TO OUTRIGHT VACATE
 A PORTION OF MT. ELLIOTT AVE., 46 FT. WD.
 IN THE AREA BOUND BY
 IRON, LEIB ST., E. JEFFERSON AVE.
 AND DETROIT RIVER

CITY OF DETROIT CITY ENGINEERING DEPARTMENT SURVEY BUREAU	
JOB NO.	01-01
DRWG. NO.	X 113

