

**City of Detroit**  
**City Engineering Division, Department of Public Works**  
**Survey Bureau**

**NOTICE OF PROPOSED CHANGE IN PROPERTY**

Date: 03/02/2018

Petition: x1850

- |   |  |
|---|--|
| <input type="checkbox"/> AT&T Telecommunication               |  |
| <input type="checkbox"/> Comcast Television (CATV)            | <input type="checkbox"/> Berm Use                          |
| <input type="checkbox"/> Detroit Edison (DTE)                 |  |
| <input type="checkbox"/> Fire Department                      | <input checked="" type="checkbox"/> Conversion to Easement |
| <input type="checkbox"/> Great Lakes Water Authority          |  |
| <input type="checkbox"/> Land Bank Authority                  | <input type="checkbox"/> Dedication                        |
| <input type="checkbox"/> Michcon (DTE)                        |  |
| <input type="checkbox"/> Planning & Development Department    | <input type="checkbox"/> Encroachment                      |
| <input checked="" type="checkbox"/> Public Lighting Authority |  |
| <input type="checkbox"/> Public Lighting Department           | <input type="checkbox"/> Outright Vacation                 |
| <input type="checkbox"/> Police Department                    |  |
| <input type="checkbox"/> Solid Waste Division, DPW            | <input type="checkbox"/> Temporary Closing                 |
| <input type="checkbox"/> Street Design Bureau, DPW            |  |
| <input type="checkbox"/> Street Maintenance Division, DPW     |  |
| <input type="checkbox"/> Traffic Engineering Division, DPW    |  |
| <input type="checkbox"/> Water and Sewerage Department        |  |
| <input type="checkbox"/> _____                                |  |

A petition drawing is attached. Property shown on the attached print is proposed to be changed as indicated. Kindly report (using the back of this sheet) the nature of your services, if any affected by the proposed change and the estimated costs of removing and rerouting such services (if necessary).

Please return one copy to City Engineering Division, DPW within two weeks of the submittal date. Retain one copy and print for you file.

Ron Brundidge, Director, Department of Public Works

By: Richard Doherty, CED DPW  
City Engineer

TO: City Engineering Division, DPW  
2 Woodward Ave., Suite 642  
Detroit, Michigan 48226-3462  
Survey Bureau: 313-224-3970

Petition: x1850

The proposed change in property (referred to on the other side of this sheet) would affect our services as follows:

- Not Involved
- Involved; but asking you to hold action on this petition until further notice.
- Involved; but no objections to the property change.
- Involved; objection to the property change.
- Involved; but no objections to the property change...provided as easement of the full width of the public right-of-way (street, alley or other public place) is reserved.
- Involved; the nature of our services and the estimated costs of removing and/or rerouting such services are:

Public Lighting Authority  
(Utility or City Department)

Mukesh Patel  
By

Engineer  
Title

3/5/18  
Date

313-324-8291  
Area code - Telephone number

PETITION NO. 1850  
 TWYONNA ADAMS  
 19914 PELKEY AVE.  
 DETROIT, MICHIGAN 48205  
 PHONE NO. 313 434-9808



**FAIRMOUNT AVE. 60 FT. WD.**

**PELKEY AVE. 60 FT. WD.**

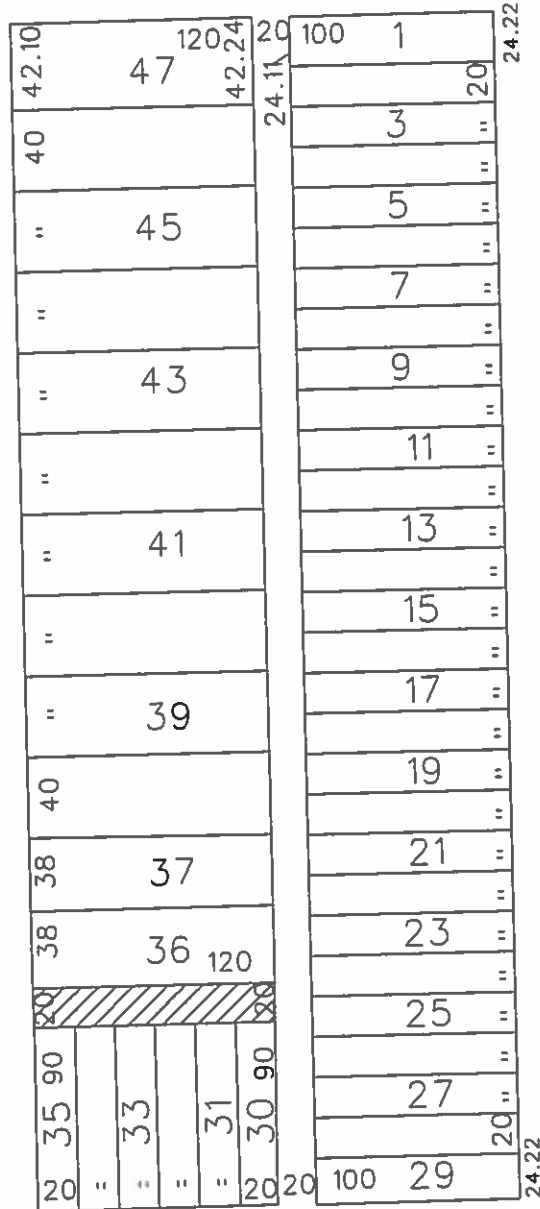

**SCHOENHERR RD. 120 FT. WD.**

**STATE FAIR AVE. 76 FT. WD.**

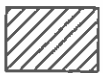

- CONVERSION TO EASEMENT

(FOR OFFICE USE ONLY)

CARTO 94 C

|             |  |          |          |  |     |
|-------------|--|----------|----------|--|-----|
| B           |  |          |          |  |     |
| A           |  |          |          |  |     |
| DESCRIPTION |  |          |          |  |     |
| DRAWN BY    |  | WLW      | CHECKED  |  | KSM |
| DATE        |  | 03-02-18 | APPROVED |  |     |

**CONVERSION TO EASEMENT  
 THE EAST/WEST PUBLIC ALLEY, 20 FT. WD.  
 IN THE BLOCK BOUND BY  
 STATE FAIR, PELKEY, FAIRMOUNT AVE.  
 AND SCHOENHERR RD.**

|                             |        |
|-----------------------------|--------|
| <b>CITY OF DETROIT</b>      |        |
| CITY ENGINEERING DEPARTMENT |        |
| SURVEY BUREAU               |        |
| JOB NO.                     | 01-01  |
| DRWG. NO.                   | X 1850 |