

City of Detroit
City Engineering Division, Department of Public Works
Survey Bureau

GLWA GPET 18-08

NOTICE OF PROPOSED CHANGE IN PROPERTY

Date: 01/31/2018

Petition: x1846

- | | |
|---|--|
| <input type="checkbox"/> AT&T Telecommunication | <input type="checkbox"/> Berm Use |
| <input type="checkbox"/> Comcast Television (CATV) | <input type="checkbox"/> Conversion to Easement |
| <input type="checkbox"/> Detroit Edison (DTE) | <input type="checkbox"/> Dedication |
| <input type="checkbox"/> Fire Department | <input checked="" type="checkbox"/> Encroachment |
| <input checked="" type="checkbox"/> Great Lakes Water Authority | <input type="checkbox"/> Outright Vacation |
| <input type="checkbox"/> Land Bank Authority | <input type="checkbox"/> Temporary Closing |
| <input type="checkbox"/> Michcon (DTE) | |
| <input type="checkbox"/> Planning & Development Department | |
| <input type="checkbox"/> Public Lighting Authority | |
| <input type="checkbox"/> Public Lighting Department | |
| <input type="checkbox"/> Police Department | |
| <input type="checkbox"/> Solid Waste Division, DPW | |
| <input type="checkbox"/> Street Design Bureau, DPW | |
| <input type="checkbox"/> Street Maintenance Division, DPW | |
| <input type="checkbox"/> Traffic Engineering Division, DPW | |
| <input type="checkbox"/> Water and Sewerage Department | |
| <input type="checkbox"/> _____ | |

A petition drawing is attached. Property shown on the attached print is proposed to be changed as indicated. Kindly report (using the back of this sheet) the nature of your services, if any affected by the proposed change and the estimated costs of removing and rerouting such services (if necessary).

Please return one copy to City Engineering Division, DPW within two weeks of the submittal date. Retain one copy and print for you file.

Ron Brundidge, Director, Department of Public Works

By: Richard Doherty, CED DPW
City Engineer

TO: City Engineering Division, DPW
2 Woodward Ave., Suite 642
Detroit, Michigan 48226-3462
Survey Bureau: 313-224-3970

Petition: x1846

The proposed change in property (referred to on the other side of this sheet) would affect our services as follows:

- Not Involved
- Involved; but asking you to hold action on this petition until further notice.
- Involved; but no objections to the property change.
- Involved; objection to the property change.
- Involved; but no objections to the property change...provided as easement of the full width of the public right-of-way (street, alley or other public place) is reserved. **24" WM**
- Involved; the nature of our services and the estimated costs of removing and/or rerouting such services are:

CILWA

(Utility or City Department)

DALE ECHOLS

By

ET

Title

02-01-2018

Date

(313) 267-4857

Area code - Telephone number

PETITION NO. 1846
 HENRY FORD HEALTH SYSTEM.
 1 FORD PLACE, 4A
 DETROIT, MICHIGAN 48202
 C/O WILLIAM E. MAZZARA, AIA
 PHONE NO. 313 874-4569



HENRY FORD
 HOSPITAL

W. GRAND BLVD.
 150 FT. WD.

STERLING AVE.
 60 FT. WD.

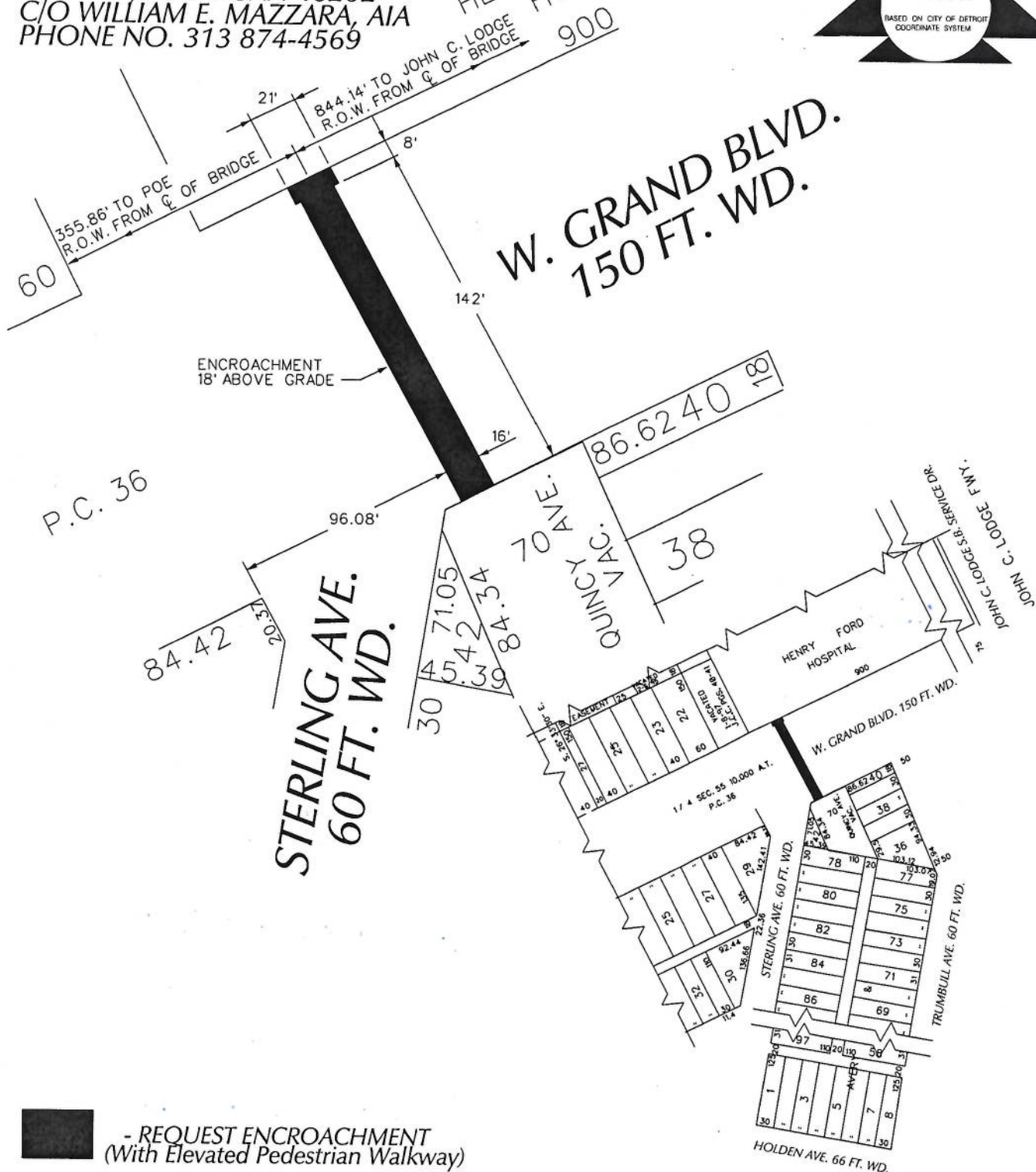

 - REQUEST ENCROACHMENT
 (With Elevated Pedestrian Walkway)

(FOR OFFICE USE ONLY)

CARTO 31 C & D

B					
A					
	DESCRIPTION	DRWN	CHKD	APPD	DATE
REVISIONS					
DRAWN BY	WLW	CHECKED			
DATE	01-31-18	APPROVED			

REQUEST ENCROACHMENT
 INTO W. GRAND BLVD.
 AT 2746 W. GRAND BLVD.
 (With Elevated Pedestrian Walkway)

CITY OF DETROIT
 CITY ENGINEERING DEPARTMENT
 SURVEY BUREAU

JOB NO. 01-01
 DRWG. NO. X 1846

S-32-D

S-31-C

S-21-A

S-31-B



S-31-D

SEWER MAP

CITY OF DETROIT

SCALE: 1" = 200'

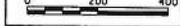

DWSD SEC. MAP NUMBER:

S-31-C

NOTES:

DATE	03-08-98
DESIGNED BY: CEA, INC.	
CHECKED BY: CWS	03-08-98
REVISIONS THRU:	03-31-03
PRINT DATE:	03-23-99



STATE PLANE

19-M

19-L

18-K

20-M



19-K



WATER MAP		CITY OF DETROIT	
SCALE: 1" = 300'	DWSD SEC. MAP NUMBER:	NOTES:	
0 300 600	19-L	DATE: 12-1-14 BY: J. L. B. / S. J. M. CHECKED BY: J. L. B. / S. J. M. DRAWN BY: J. L. B. / S. J. M. APP. DATE: 12-1-14	

