

City of Detroit
City Engineering Division, Department of Public Works
Survey Bureau

CILWA CPET 18-40

NOTICE OF PROPOSED CHANGE IN PROPERTY

Date: 06/07/2018

Petition: x1822

- | | |
|-----------------------------------------------------------------|--------------------------------------------------|
| <input type="checkbox"/> AT&T Telecommunication | <input type="checkbox"/> Berm Use |
| <input type="checkbox"/> Comcast Television (CATV) | <input type="checkbox"/> Conversion to Easement |
| <input type="checkbox"/> Detroit Edison (DTE) | <input type="checkbox"/> Dedication |
| <input type="checkbox"/> Fire Department | <input checked="" type="checkbox"/> Encroachment |
| <input checked="" type="checkbox"/> Great Lakes Water Authority | <input type="checkbox"/> Outright Vacation |
| <input type="checkbox"/> Land Bank Authority | <input type="checkbox"/> Temporary Closing |
| <input type="checkbox"/> Michcon (DTE) | |
| <input type="checkbox"/> Planning & Development Department | |
| <input type="checkbox"/> Public Lighting Authority | |
| <input type="checkbox"/> Public Lighting Department | |
| <input type="checkbox"/> Police Department | |
| <input type="checkbox"/> Solid Waste Division, DPW | |
| <input type="checkbox"/> Street Design Bureau, DPW | |
| <input type="checkbox"/> Street Maintenance Division, DPW | |
| <input type="checkbox"/> Traffic Engineering Division, DPW | |
| <input type="checkbox"/> Water and Sewerage Department | |
| <input type="checkbox"/> _____ | |

A petition drawing is attached. Property shown on the attached print is proposed to be changed as indicated. Kindly report (using the back of this sheet) the nature of your services, if any affected by the proposed change and the estimated costs of removing and rerouting such services (if necessary).

Please return one copy to City Engineering Division, DPW within two weeks of the submittal date. Retain one copy and print for you file.

Ron Brundidge, Director, Department of Public Works

By: Richard Doherty, CED DPW
City Engineer

TO: City Engineering Division, DPW
2 Woodward Ave., Suite 642
Detroit, Michigan 48226-3462
Survey Bureau: 313-224-3970

Petition: x1822

The proposed change in property (referred to on the other side of this sheet) would affect our services as follows:

- Not Involved
- Involved; but asking you to hold action on this petition until further notice.
- Involved; but no objections to the property change.
- Involved; objection to the property change.
- Involved; but no objections to the property change...provided as easement of the full width of the public right-of-way (street, alley or other public place) is reserved.
- Involved; the nature of our services and the estimated costs of removing and/or rerouting such services are:

GLWA

(Utility or City Department)

Catherine Kirkland

By

Management Professional

Title

6/11/18

Date

313.378.9967

Area code – Telephone number



November 1, 2017

HAND DELIVER

Honorable Detroit City Council
C/o Detroit City Clerk
2 Woodward Avenue
200 Coleman A. Young Municipal Center
Detroit, Michigan 48226

RE: Giffels Webster, Neighborhood Development Corporation, and Economic Development Corporation of the City of Detroit, request to encroach public rights-of-way with private storm water management system in the Jefferson Village neighborhood.

Jefferson Village is located in the City of Detroit and is bounded by Jefferson Avenue to the north, St. Jean Avenue to the east, Freud Street to the south, and the Harding Canal to the west. This area consists of a shopping plaza known as the "Shops at Jefferson Village" and single family homes and is serviced by a combined sewer system. The Jefferson Village project aims to separate the storm flow from the combined system and divert it to an underground stormwater detention system. Giffels Webster respectfully requests sub-surface encroachments for the following public right-of-ways:

- Harding Avenue (50 feet wide), between Edlie Street and Freud Avenue; beginning 365 feet south of south Edlie ROW and extending 20 feet south, full ROW in width
- Intersection of Lisette Avenue and Meadowbrook Avenue; 55 feet easterly from west Meadowbrook ROW and 48 feet northerly from south Lisette ROW
- Montclair Avenue (50 feet wide) at Lisette; beginning at south ROW of Lisette and extending south 20 feet, full ROW in width
- Lemay Avenue (50 feet wide) at Lisette; beginning at south ROW of Lisette and extending south 20 feet, full ROW in width
- Fairview Avenue (66 feet wide) at Lisette; beginning at south ROW of Lisette and extending south 20 feet, full ROW in width
- Lillibridge Avenue (50 feet wide) at Lisette; beginning at south ROW of Lisette and extending south 20 feet, full ROW in width
- Lisette Avenue (80 feet wide) at St. Jean Avenue; beginning at west ROW of St. Jean and extending west 20 feet, full ROW in width
- St. Jean Avenue between Lisette Avenue and Edlie Avenue; beginning 10 feet north of north Lisette ROW and extending 690 feet north, and 17 feet easterly from west St. Jean ROW
- St. Jean Avenue at Edlie Street; beginning at south ROW of Edlie and extending south 31 feet, and 10 feet easterly from west St. Jean ROW
- Intersection of Edlie Street and St. Jean Avenue; 50 feet southerly from north Edlie ROW, and 10 feet west and 10 feet east from west St. Jean ROW
- St. Jean Avenue between Jefferson Avenue and Edlie Street; beginning 258 feet from south Jefferson ROW and extending south 465 feet, and 10 feet easterly from west St. Jean ROW

28 W. Adams, Suite 1200 | Detroit, Michigan 48226 | Phone (313) 962-4442 | Fax (313) 962-5068

- Lillibridge Avenue (50 feet wide) between Jefferson Avenue and Edlie Street; beginning 199 feet from south Jefferson ROW and extending 160 feet south, full ROW in width

All work outlined above will be performed per Michigan Plumbing Code, City of Detroit, CED, and DWSD Standards. Limits of the requested encroachments can be found in the attachment, enclosed herein. If you should have any questions, please do not hesitate to contact Michael Marks at 313.980.1469 or mmarks@giffelswebster.com.

Respectfully,

Giffels Webster

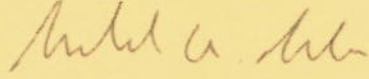

Michael Marks, PE
Partner

PETITION NO. 1822
 GIFFELS WEBSTER
 28 W. ADAMS, SUITE 1200
 DETROIT, MICHIGAN 48226
 C/O MICHAEL MARKS P.E.
 PHONE NO. 313 962-4442

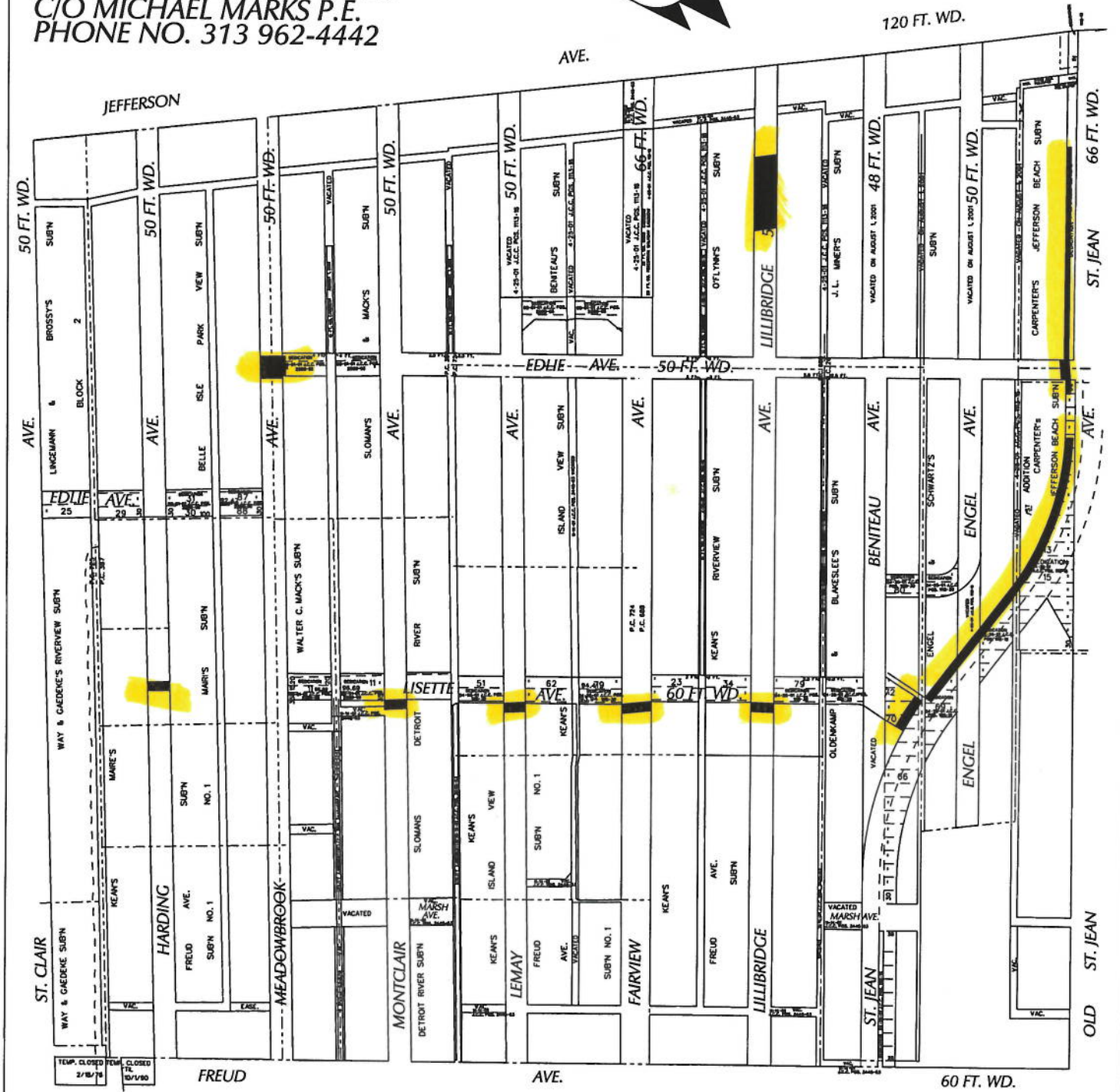

 - REQUEST ENCROACHMENT
 (With Sub-Surfacing Management System)

(FOR OFFICE USE ONLY)

CARTO 54 A & B

B					
A					
DESCRIPTION					
REVISIONS					
DRAWN BY	WLW	CHECKED	KSM		
DATE	06-07-18	APPROVED			

REQUEST ENCROACHMENT
 INTO VARIOUS LOCATIONS
 IN THE AREA BOUND BY
 ST. JEAN, FREUD, ST. CLAIR
 AND E. JEFFERSON AVE.
 (With Sub-Surfacing Management System)

CITY OF DETROIT	
CITY ENGINEERING DEPARTMENT	
SURVEY BUREAU	
JOB NO.	01-01
DRWG. NO.	X 1822

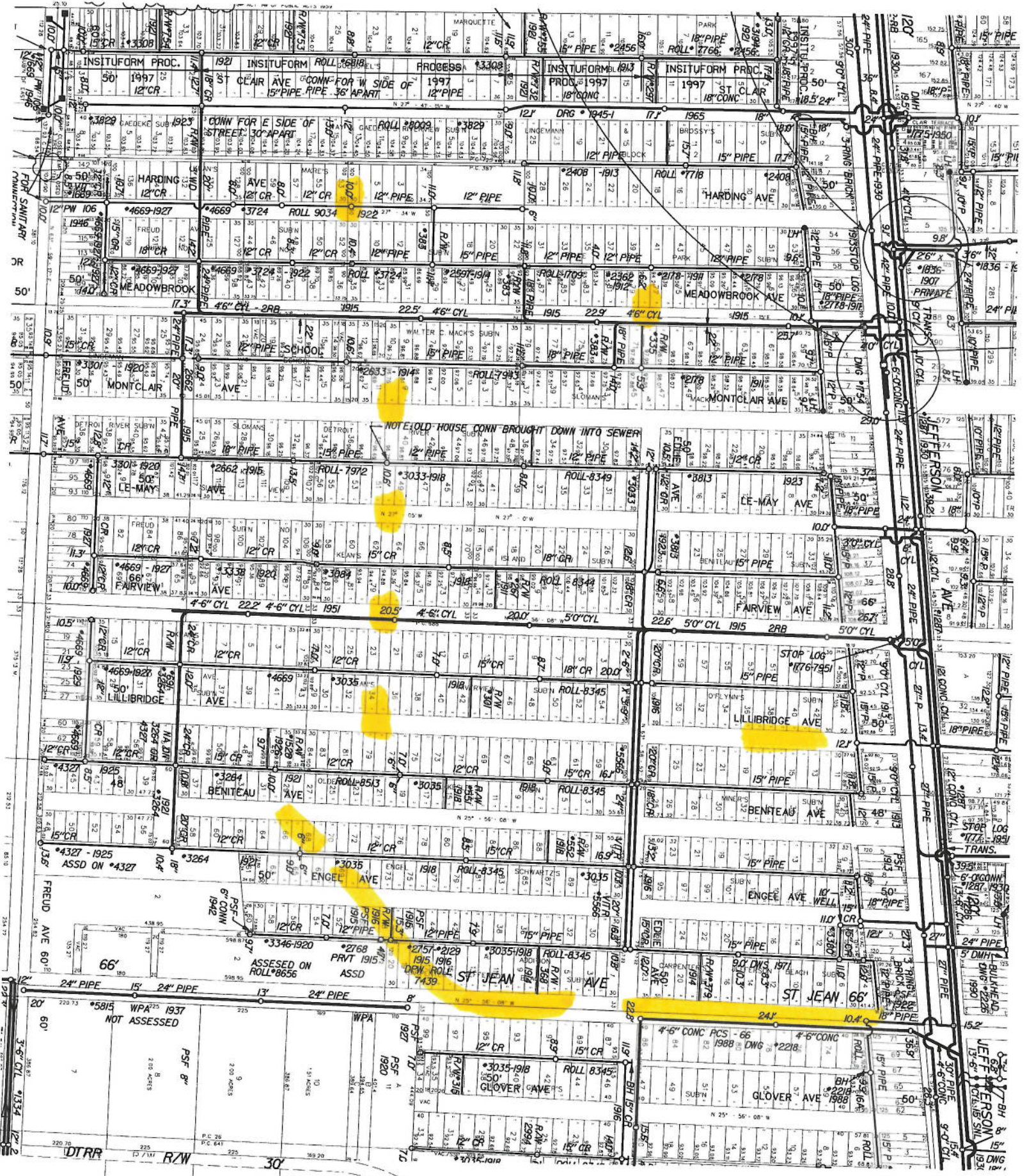

5A-B

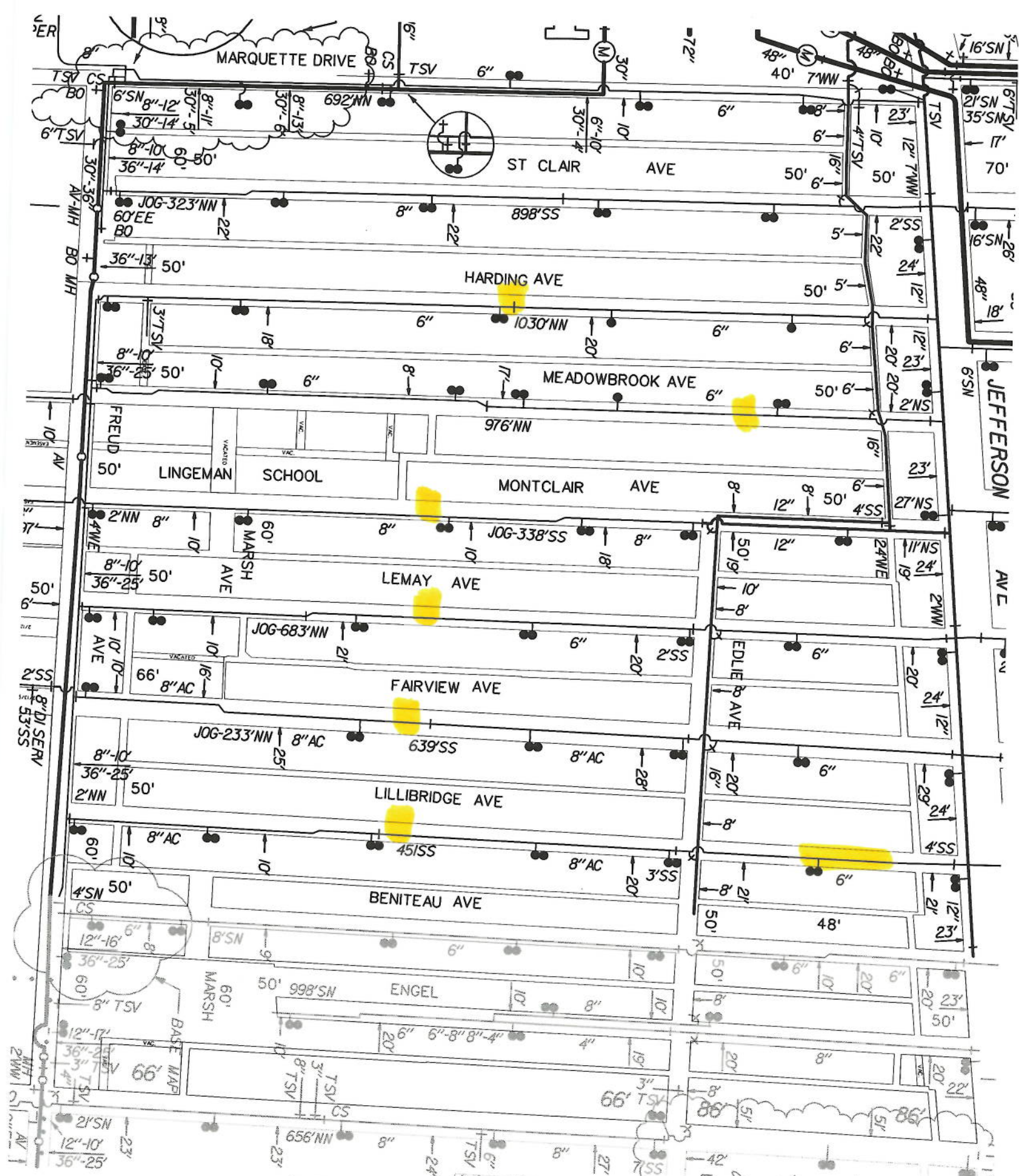

25-K

PRIVATE STORMWATER MANAGEMENT SYSTEM ENCROACHMENT

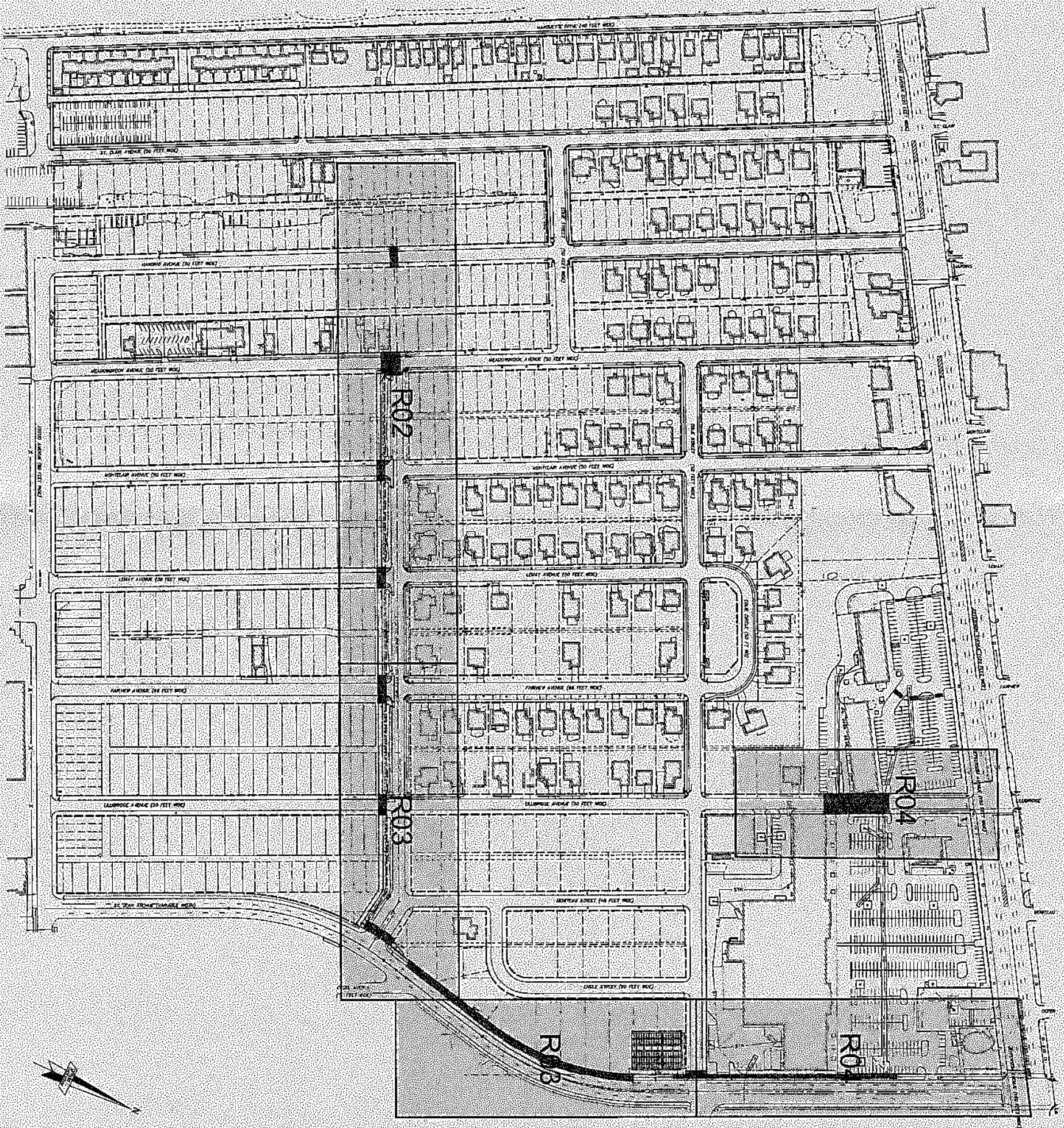
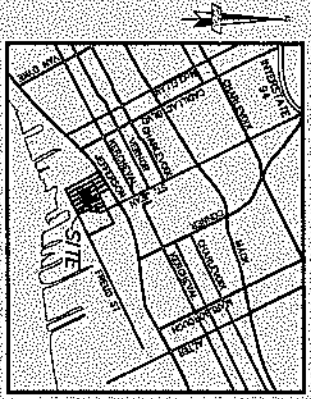

GIFFELS WEBSTER
28 W. ADAMS STE. 1200
DETROIT, MICH. 48226
ATTN: MICHAEL MARKS
P. 313.980.1469 F. 313.962.5068
E. MMARKS@GIFFELSWEBSTER.COM

PRIVATE STORMWATER MANAGEMENT SYSTEM ENCROACHMENT

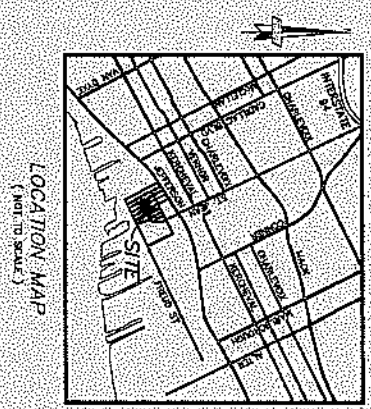
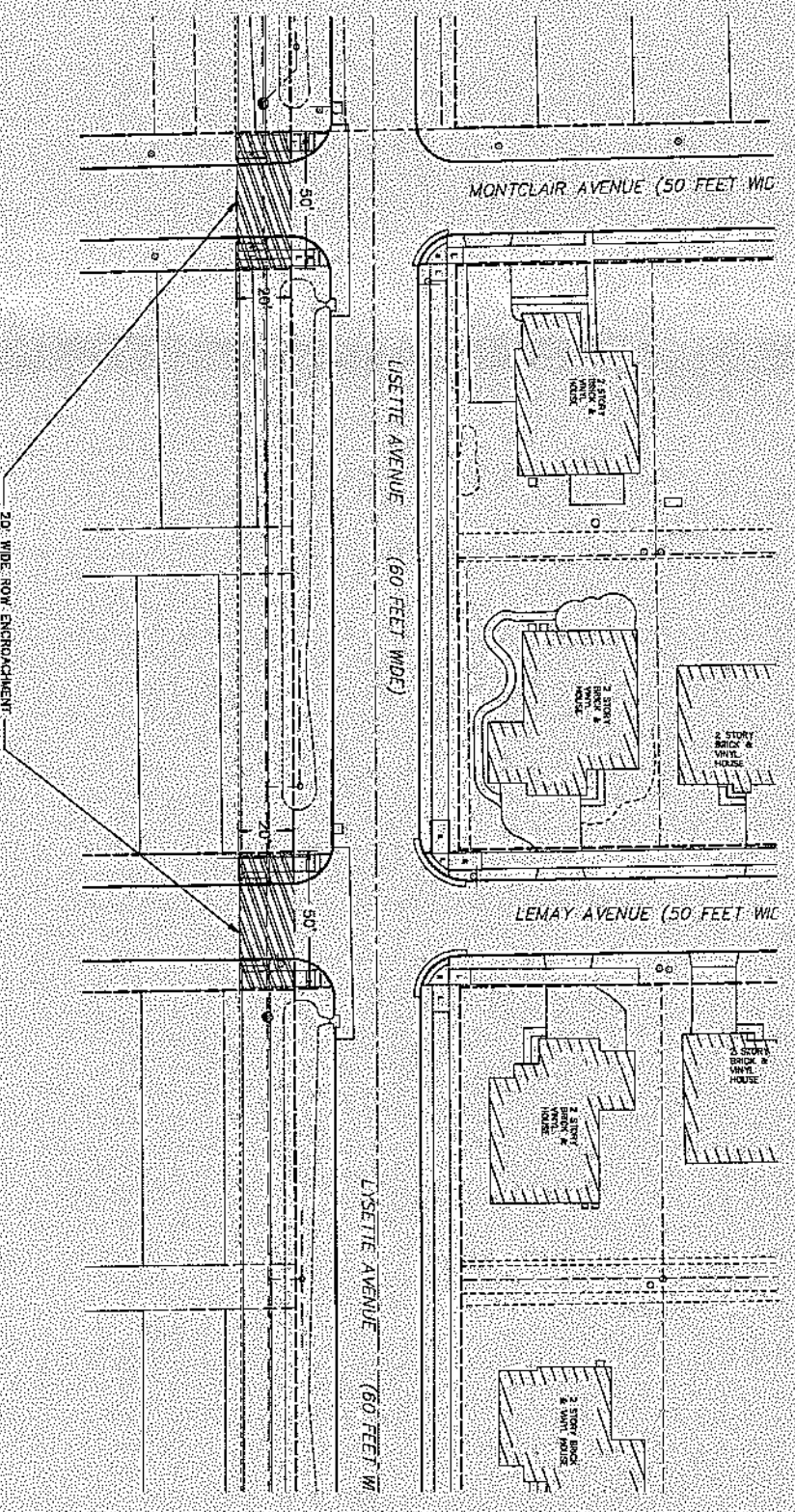
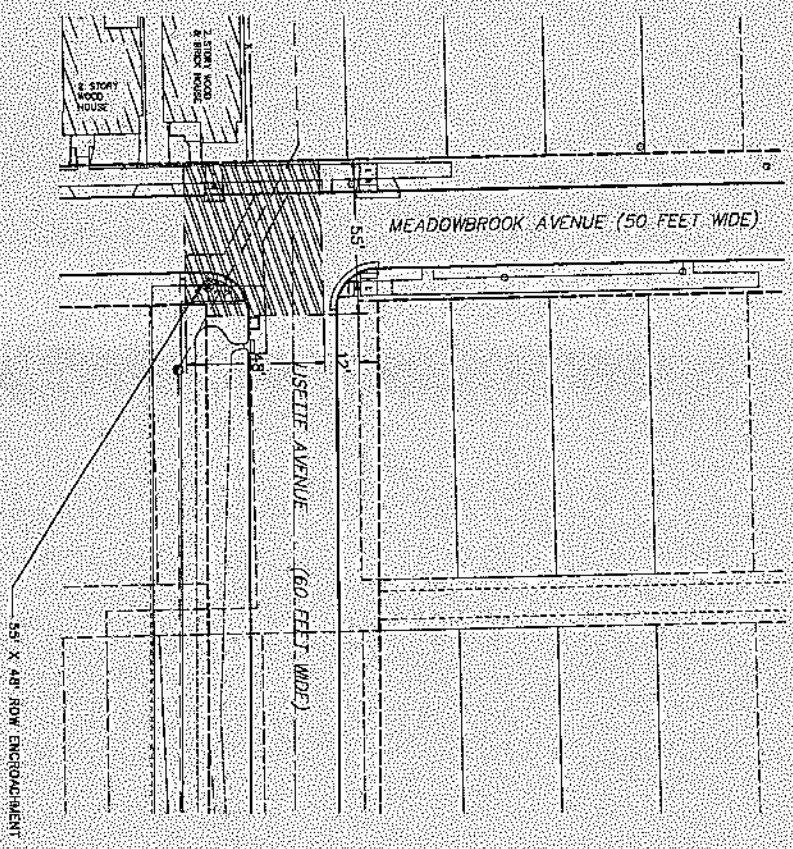
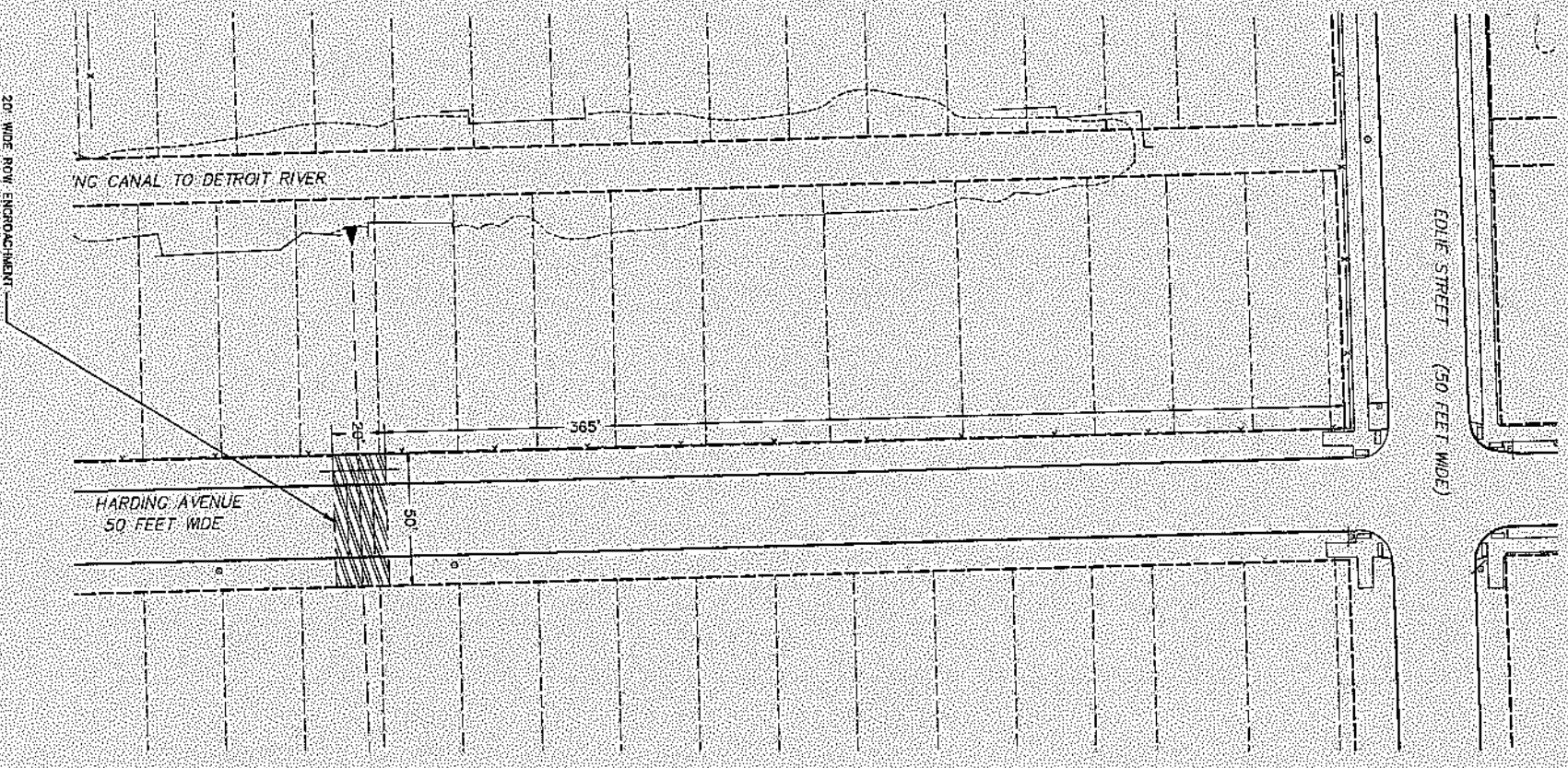

- LEGEND:
- ROW LINE
 - ROW ENCROACHMENT
 - PROPOSED SEWER
 - PROPOSED MANHOLE

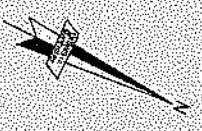

PRIVATE STORMWATER MANAGEMENT SYSTEM ENCROACHMENT

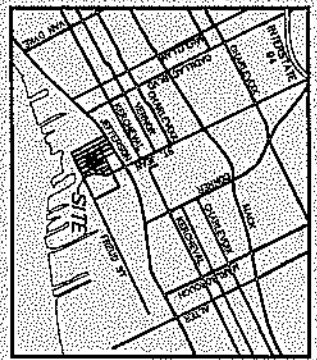
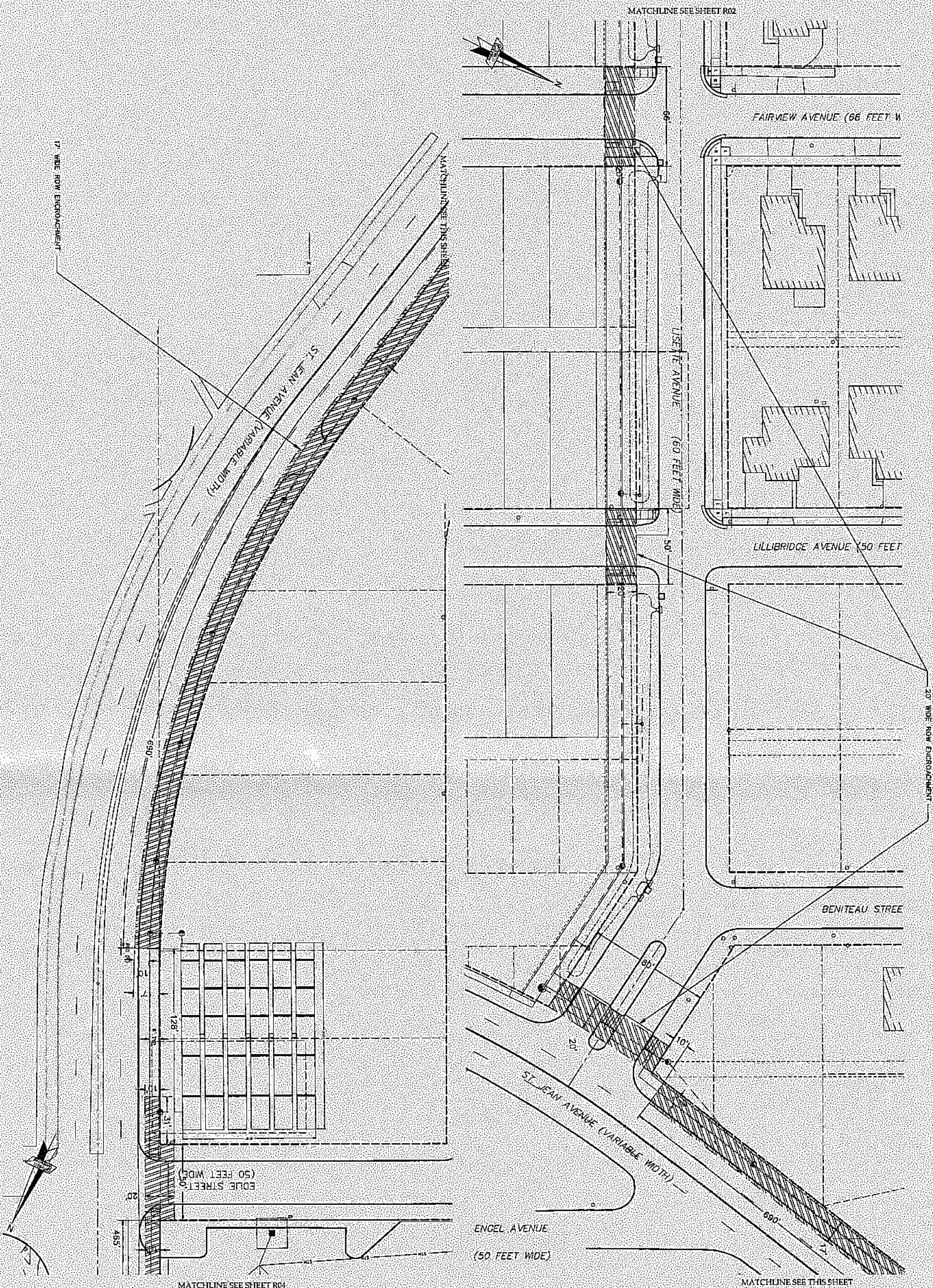

- LEGEND:**
- ROW LINE
 - ROW ENCROACHMENT
 - PROPOSED SEWER
 - PROPOSED MANHOLE

PRIVATE STORMWATER MANAGEMENT SYSTEM ENCROACHMENT

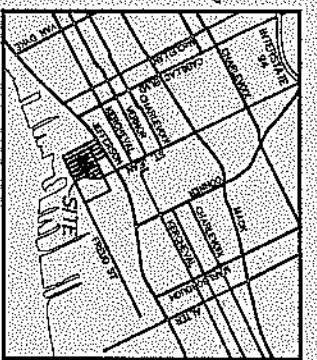
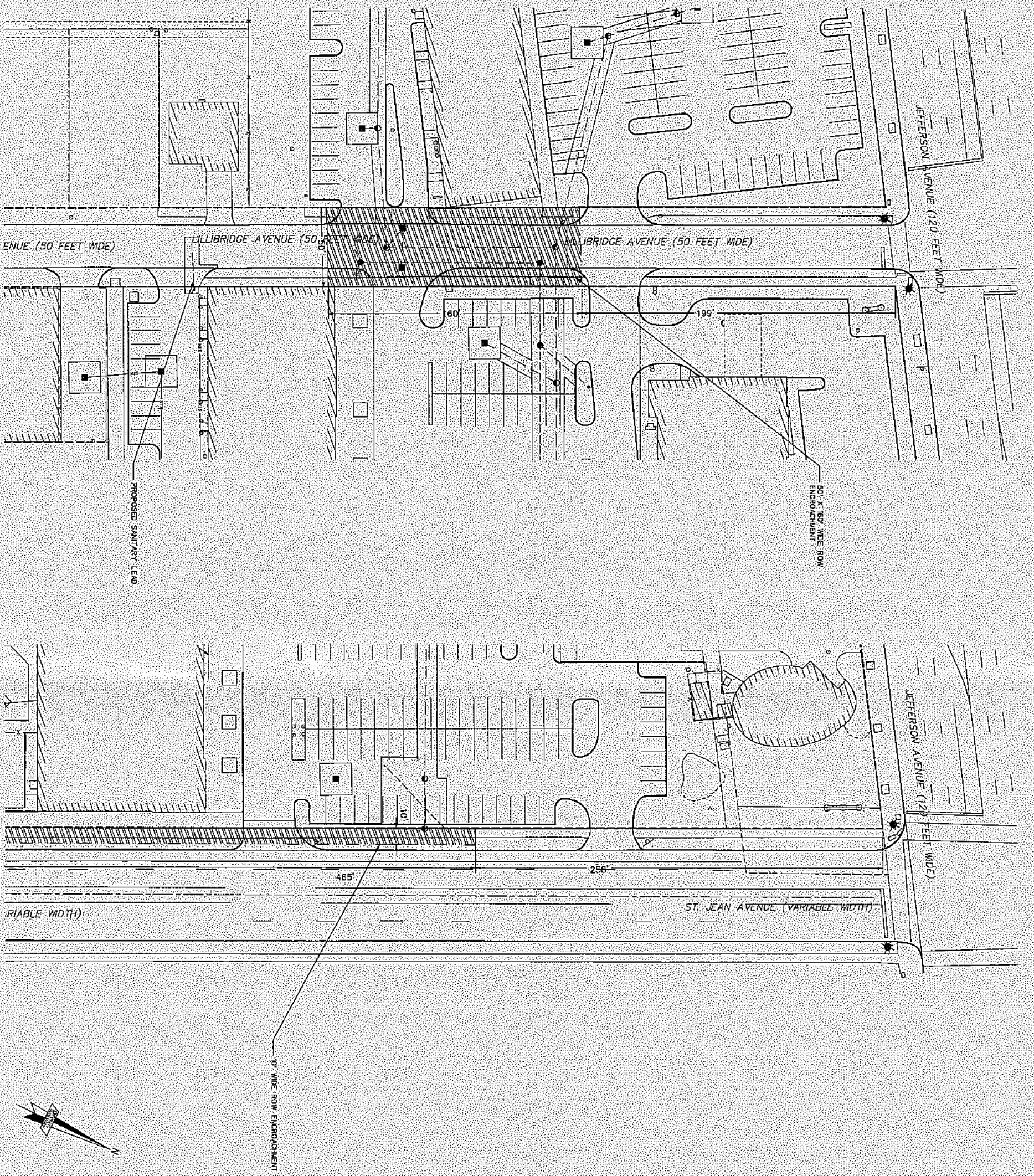

- LEGEND:
- ROW LINE
 - ROW ENCROACHMENT
 - PROPOSED SEWER
 - PROPOSED MANHOLE

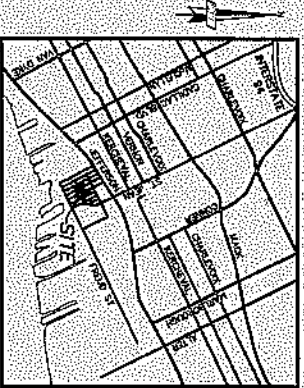

GENERAL NOTES

- A. IN COMPLIANCE WITH PUBLIC ACT 93 OF THE STATE OF MICHIGAN (EFFECTIVE AUGUST 1, 1974, THE CONTRACTOR SHALL NOTIFY IN ADVANCE OF CONSTRUCTION (72 HOURS/3 WORKING DAYS) ALL PUBLIC AND PRIVATE UTILITY OWNERS HAVING EXISTING FACILITIES IN OR NEAR THE IMMEDIATE WORKING AREA FOR CONFORMANCE. THE KNOWN UTILITY OWNERS ARE LISTED BELOW. THIS LISTING DOES NOT, HOWEVER, RELIEVE THE CONTRACTOR OF THE RESPONSIBILITY OF VERIFYING UTILITY LOCATIONS AND NOTING ALL UTILITY OWNERS AND LOSS DIB (PHONE: 1-800-482-7171).
- AGENTS:
 - CONDUIT CABLE COMPANY (313) 221-2121 (313) 534-1808
 - DETROIT EDISON COMPANY (313) 232-9000 (313) 224-0500
 - DETROIT WATER & SEWERAGE MICHIGAN CONSOLIDATED GAS COMPANY (313) 833-8649 (313) 895-0433
- B. VERIFY EXISTING INVERT ELEVATIONS PRIOR TO START OF CONSTRUCTION.
- C. ALL SEWER WORK ON THESE DRAWINGS SHALL BE CONSTRUCTED IN ACCORDANCE WITH THE DETROIT WATER AND SEWERAGE DEPARTMENT'S LATERAL CONSTRUCTION SPECIFICATIONS, PERMIT AND INSPECTION.
- D. ALL MANHOLE AND CATCH BASIN COVERS SHALL BE BOLTED DOWN.
- E. ALL SEWER PIPE SHALL BE REINFORCED CONCRETE ASTM C76, CLASS N.
- F. ALL WATER MAIN TO BE DUCTILE IRON CLASS 50 WITH A POLYETHYLENE WRAP IN ACCORDANCE WITH DWSO STANDARDS.
- G. ALL WATER MAINS TO BE INSTALLED WITH A MINIMUM OF 5'-0" OF COVER.
- H. CONCRETE THROST BLOCKS SHALL BE PLACED ON ALL FITTINGS.
- I. ALL WATER MAIN WORK IS TO BE DONE IN ACCORDANCE WITH DETROIT WATER AND SEWERAGE DEPARTMENT'S STANDARDS AND SPECIFICATIONS.
- J. ALL SEWER MANHOLES ARE TO HAVE ECCENTRIC CONES.
- K. EXISTING OUTLET SEWER INVERTS ELEVATIONS ARE TO BE FIELD VERIFIED.
- L. CONSTRUCT 4" THICK CONCRETE WALLS.
- M. CONSTRUCT 8" THICK CONCRETE APPROACHES.
- N. PROVIDE HIGH POINT AT PROPERTY LINE ACROSS DRIVES.
- O. RESTORE WALK, CURB AND PAVEMENT TO MATCH EXISTING AFTER UTILITY CUTS.
- P. CONTRACTOR TO COORDINATE WITH P.L.D. DTE, DETROIT THERMAL, AND ALL OTHER UTILITY COMPANIES AFFECTED BY THE SEWER RELOCATION WORK. ALL MANHOLES, CABLES, DUCT BAYS, PIPES OR ANY ADDITIONAL ITEMS THAT NEED TO BE REPLACED SHOULD BE COMPLETED PER THE UTILITY COMPANY'S STANDARDS AND SPECIFICATIONS. F. REQUIRED.

ALTERNATIVE ENGINEERING DESIGN, SEPARATE PLUMBING PERMIT REQUIRED

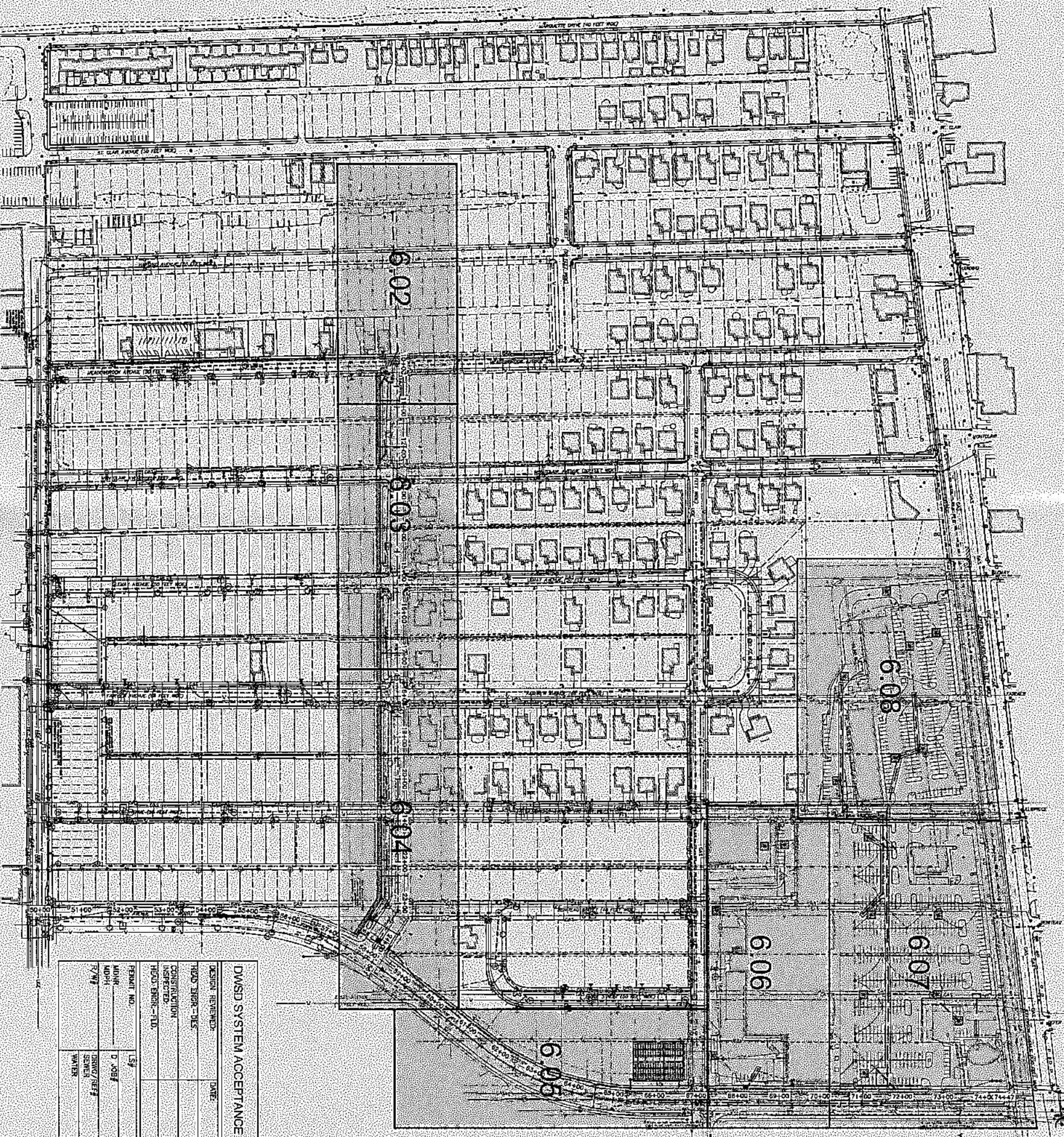

DESIGN REVIEWERS		DATE
THOUGHTS - DKS		
CONSTRUCTION INSPECTED		
THOUGHTS - TLD		

PERMIT NO.	LS#
MOHR 40041	D JBF
7/21/07	DRING/BEF
	SEWER
	WATER

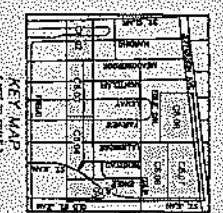
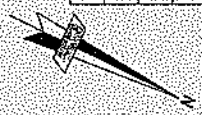

giffels webster

Engineers
Surveyors
Planners
Landscape Architects
Environmental Specialists

23 W. Adams Street
Suite 1200
Detroit, MI 48226
P (313) 562-4142
F (313) 863-8608
www.giffelswebster.com

Executive: STC
Manager: MWA
Designer: SLP
Quality Control: TEI

Project No. _____
Revision No. _____

Approved by: Neighborhood Development Corporation

500 Oakland, Suite 2200
Detroit, MI 48226

Overall Utility Plan

Jefferson Village Stormwater Separator Phase I

City of Detroit
Water Utility
MICHIGAN

DATE: 09.23.06
SCALE: NTS
SHEET: CS.01
PAGES: 16027.210

NOTE
 WATER TABLE ELEVATION VARIES BETWEEN 12' DEEP
 AND GREATER THAN 15.5' PER SOIL BORINGS DATED
 1-1-12-2002.

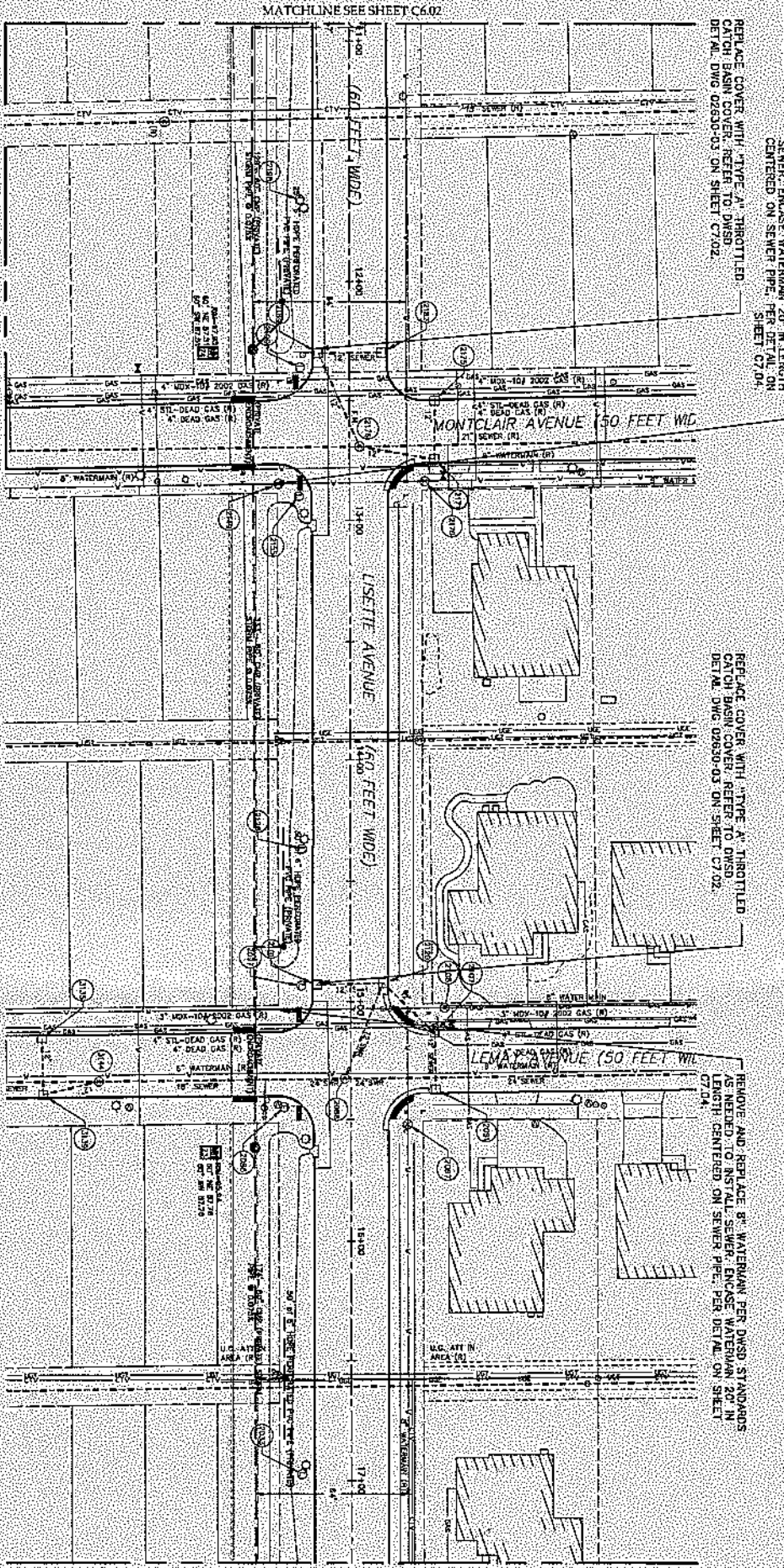

REMOVE AND REPLACE 8" WATERMAIN PER DWSD STANDARDS AS NEEDED TO INSTAL
 CATCH BASIN COVER REFER TO DWSD
 DETAIL DWS 02550-03 ON SHEET C7.02.

REMOVE AND REPLACE 8" WATERMAIN PER DWSD STANDARDS
 AS NEEDED TO INSTAL CATCH BASIN COVER REFER TO DWSD
 DETAIL DWS 02550-03 ON SHEET C7.02.

REMOVE AND REPLACE 8" WATERMAIN PER DWSD STANDARDS
 AS NEEDED TO INSTAL CATCH BASIN COVER REFER TO DWSD
 DETAIL DWS 02550-03 ON SHEET C7.02.

STRUCTURE	RIM	INVERT	LENGTH
106	106	106	129' - 60" CMP STORM PIPE Ø 0.075%
104	104	104	333' - 60" CMP STORM PIPE Ø 0.075%
102	102	102	174' - 60" CMP STORM PIPE Ø 0.075%
100	100	100	
98	98	98	
96	96	96	
94	94	94	
92	92	92	
90	90	90	
88	88	88	
86	86	86	
84	84	84	
82	82	82	
80	80	80	

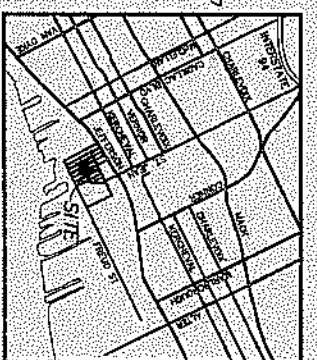
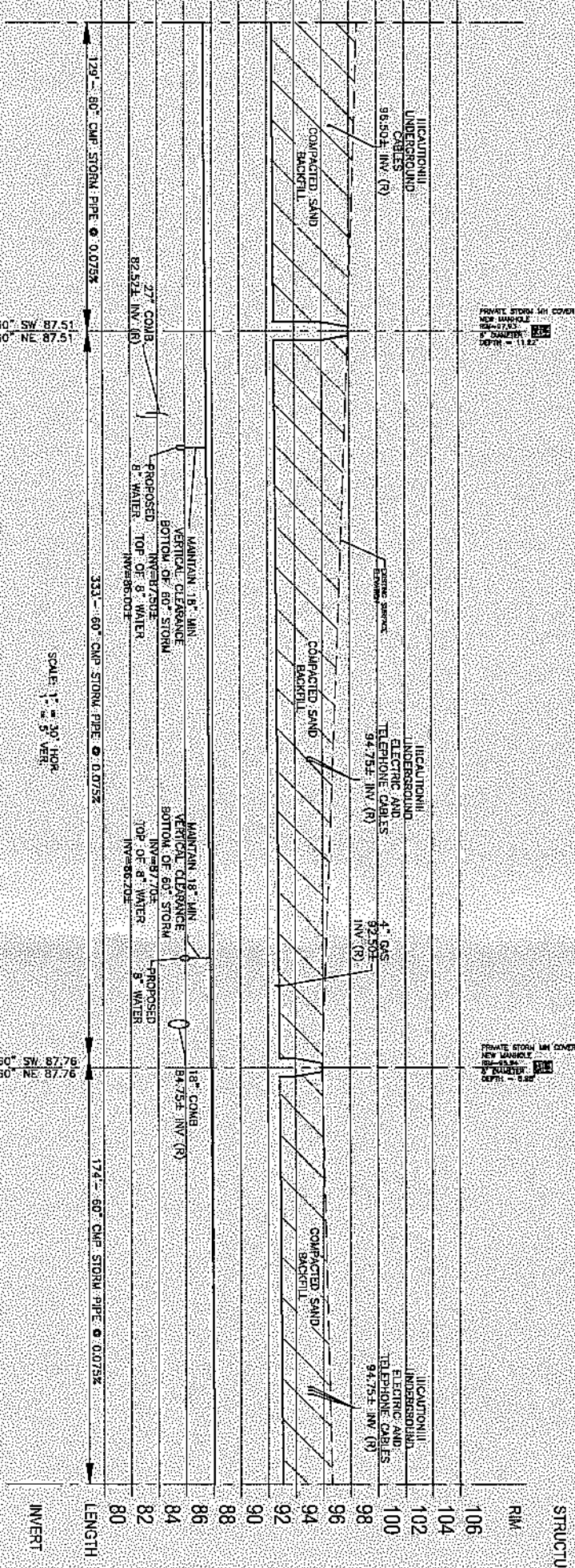

ALTERNATIVE ENGINEERING DESIGN, SEPARATE
 FLOODING PERMIT REQUIRED.

giffels webster

Engineers
 Surveyors
 Planners
 Landscape Architects
 Environmental Scientists

25 W. Adams Street
 Suite 1000
 Detroit, MI 48226
 P (313) 964-4442
 F (313) 964-8888
www.giffelswebster.com



DATE	DESCRIPTION
2013.03.07	PRELIMINARY DESIGN REVIEW
2013.05.15	DESIGN REVIEW
2013.05.15	DESIGN REVIEW
2013.05.15	DESIGN REVIEW
2013.05.15	DESIGN REVIEW
2013.05.15	DESIGN REVIEW
2013.05.15	DESIGN REVIEW
2013.05.15	DESIGN REVIEW
2013.05.15	DESIGN REVIEW
2013.05.15	DESIGN REVIEW

DESIGN REVIEWED	DATE
HEAD ENGR - DES	
CONSTRUCTION	
INSPECTOR	
HEAD ENGR - FLD	

Prepared by:
 Neighborhood Development
 Corporation

500 Griswold, Suite 2200
 Detroit, MI 48226

Utility Plan &
 Profiles

Johnson Village Stormwater
 Separation Phase I

City of Detroit
 Wayne County
 MICHIGAN

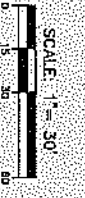

DATE	09.23.15
SCALE	1" = 30'
SHEET	C6.03
PROJECT	1807.410

NOTE: WATER TABLE ELEVATION VARIES BETWEEN 17' DEEP AND GREATER THAN 15'6" PER SOIL BORINGS DATED 11-12-2002.

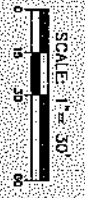

SCALE: 1" = 30'

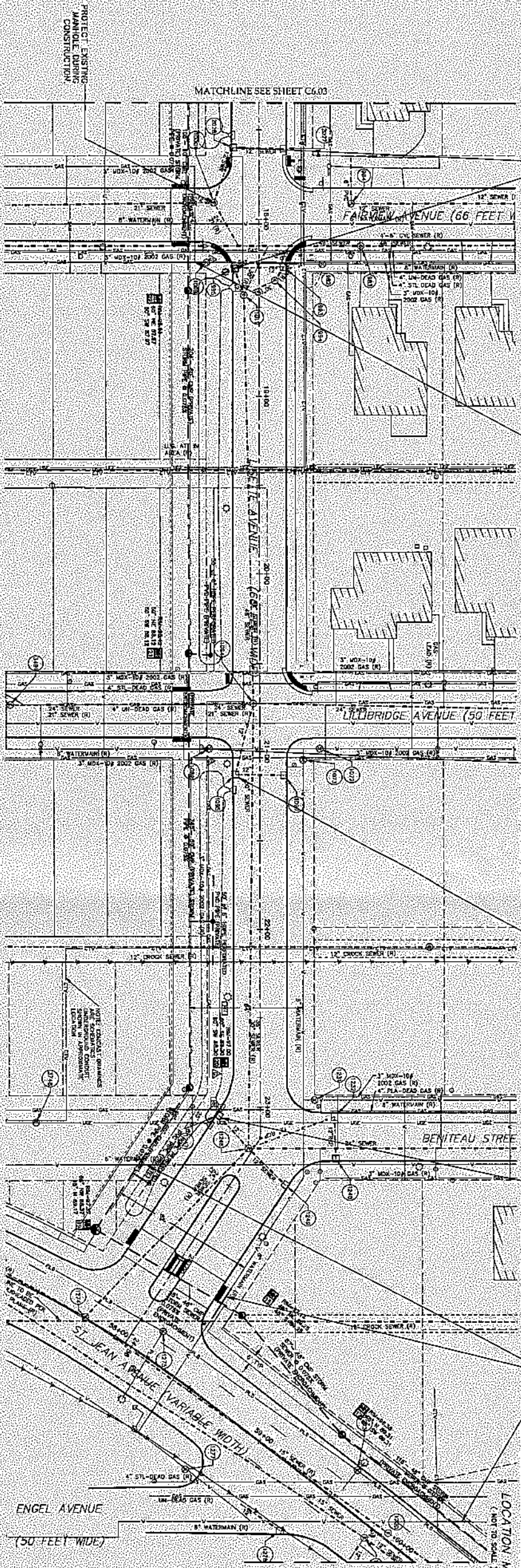

REPLACE COVER WITH "TYPE A" THROTTLED CATCH BASIN COVER. REFER TO DWG 02830-03 ON SHEET C7.02.

REMOVE AND REPLACE 9" WATERMAIN PER DWG STANDARD AS NEEDED TO INSTALL SEWER. ENCASE WATERMAIN 20" IN LENGTH CENTERED ON SEWER PIPE. PER DETAIL ON SHEET C7.04.

REMOVE AND REPLACE 8" WATERMAIN PER DWG STANDARD AS NEEDED TO INSTALL SEWER. ENCASE WATERMAIN 20" IN LENGTH CENTERED ON SEWER PIPE. PER DETAIL ON SHEET C7.04.

REPLACE COVER WITH "TYPE A" THROTTLED CATCH BASIN COVER. REFER TO DWG 02830-03 ON SHEET C7.02.

REMOVE AND REPLACE 8" AND 8" WATERMAIN PER DWG STANDARD AS NEEDED TO INSTALL SEWER. ENCASE WATERMAIN 20" IN LENGTH CENTERED ON SEWER PIPE. PER DETAIL ON SHEET C7.04.

ALTERNATIVE ENGINEERING DESIGN: SEPARATE PUBLIC: PERMIT REQUIRED.

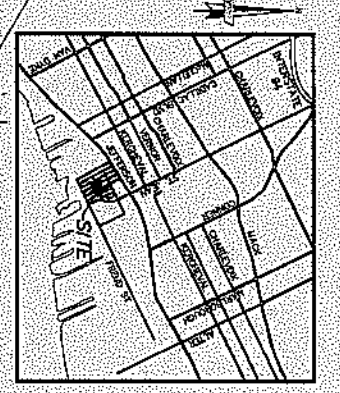

STRUCTURE	RIM	INVERT	LENGTH	DESCRIPTION
106	106.00	82.00	24'-0"	4" GAS UNDERGROUND UNDERGAGES 84.75' INV. (R)
104	104.00	84.00	20'-0"	4" GAS UNDERGROUND UNDERGAGES 84.75' INV. (R)
102	102.00	86.00	24'-0"	4" GAS UNDERGROUND UNDERGAGES 84.75' INV. (R)
100	100.00	88.00	24'-0"	4" GAS UNDERGROUND UNDERGAGES 84.75' INV. (R)
98	98.00	90.00	24'-0"	4" GAS UNDERGROUND UNDERGAGES 84.75' INV. (R)
96	96.00	92.00	24'-0"	4" GAS UNDERGROUND UNDERGAGES 84.75' INV. (R)
94	94.00	94.00	24'-0"	4" GAS UNDERGROUND UNDERGAGES 84.75' INV. (R)
92	92.00	96.00	24'-0"	4" GAS UNDERGROUND UNDERGAGES 84.75' INV. (R)
90	90.00	98.00	24'-0"	4" GAS UNDERGROUND UNDERGAGES 84.75' INV. (R)
88	88.00	100.00	24'-0"	4" GAS UNDERGROUND UNDERGAGES 84.75' INV. (R)
86	86.00	102.00	24'-0"	4" GAS UNDERGROUND UNDERGAGES 84.75' INV. (R)
84	84.00	104.00	24'-0"	4" GAS UNDERGROUND UNDERGAGES 84.75' INV. (R)
82	82.00	106.00	24'-0"	4" GAS UNDERGROUND UNDERGAGES 84.75' INV. (R)
80	80.00	108.00	24'-0"	4" GAS UNDERGROUND UNDERGAGES 84.75' INV. (R)

STRUCTURE	RIM	INVERT	LENGTH	DESCRIPTION
106	106.00	82.00	24'-0"	4" GAS UNDERGROUND UNDERGAGES 84.75' INV. (R)
104	104.00	84.00	20'-0"	4" GAS UNDERGROUND UNDERGAGES 84.75' INV. (R)
102	102.00	86.00	24'-0"	4" GAS UNDERGROUND UNDERGAGES 84.75' INV. (R)
100	100.00	88.00	24'-0"	4" GAS UNDERGROUND UNDERGAGES 84.75' INV. (R)
98	98.00	90.00	24'-0"	4" GAS UNDERGROUND UNDERGAGES 84.75' INV. (R)
96	96.00	92.00	24'-0"	4" GAS UNDERGROUND UNDERGAGES 84.75' INV. (R)
94	94.00	94.00	24'-0"	4" GAS UNDERGROUND UNDERGAGES 84.75' INV. (R)
92	92.00	96.00	24'-0"	4" GAS UNDERGROUND UNDERGAGES 84.75' INV. (R)
90	90.00	98.00	24'-0"	4" GAS UNDERGROUND UNDERGAGES 84.75' INV. (R)
88	88.00	100.00	24'-0"	4" GAS UNDERGROUND UNDERGAGES 84.75' INV. (R)
86	86.00	102.00	24'-0"	4" GAS UNDERGROUND UNDERGAGES 84.75' INV. (R)
84	84.00	104.00	24'-0"	4" GAS UNDERGROUND UNDERGAGES 84.75' INV. (R)
82	82.00	106.00	24'-0"	4" GAS UNDERGROUND UNDERGAGES 84.75' INV. (R)
80	80.00	108.00	24'-0"	4" GAS UNDERGROUND UNDERGAGES 84.75' INV. (R)

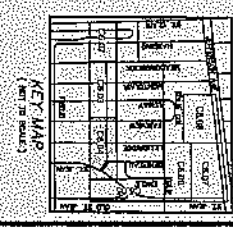

Prepared by:
 Neighborhood Development Corporation
 300 Grandview, Suite 2200
 Detroit, MI 48225

Date: 09.21.16
 Scale: 1" = 30'
 Sheet: C6.04
 Project: 16037 A10

Jefferson Village Stormwater Separation Phase 1
 City of Detroit
 Water Department
 Michigan

giffels webster
 Signature
 Stamp
 Planner
 Landscape Architect
 Environmental Specialist
 28 W. Adams Street
 Suite 1000
 Detroit, MI 48226
 P: (313) 962-4444
 F: (313) 962-8888
 www.giffelswebster.com

NOTE:
WATER TABLE ELEVATION VARIES BETWEEN 1' DEEP
AND GREATER THAN 15.5' PER SOIL BORINGS DATED
11-12-2002

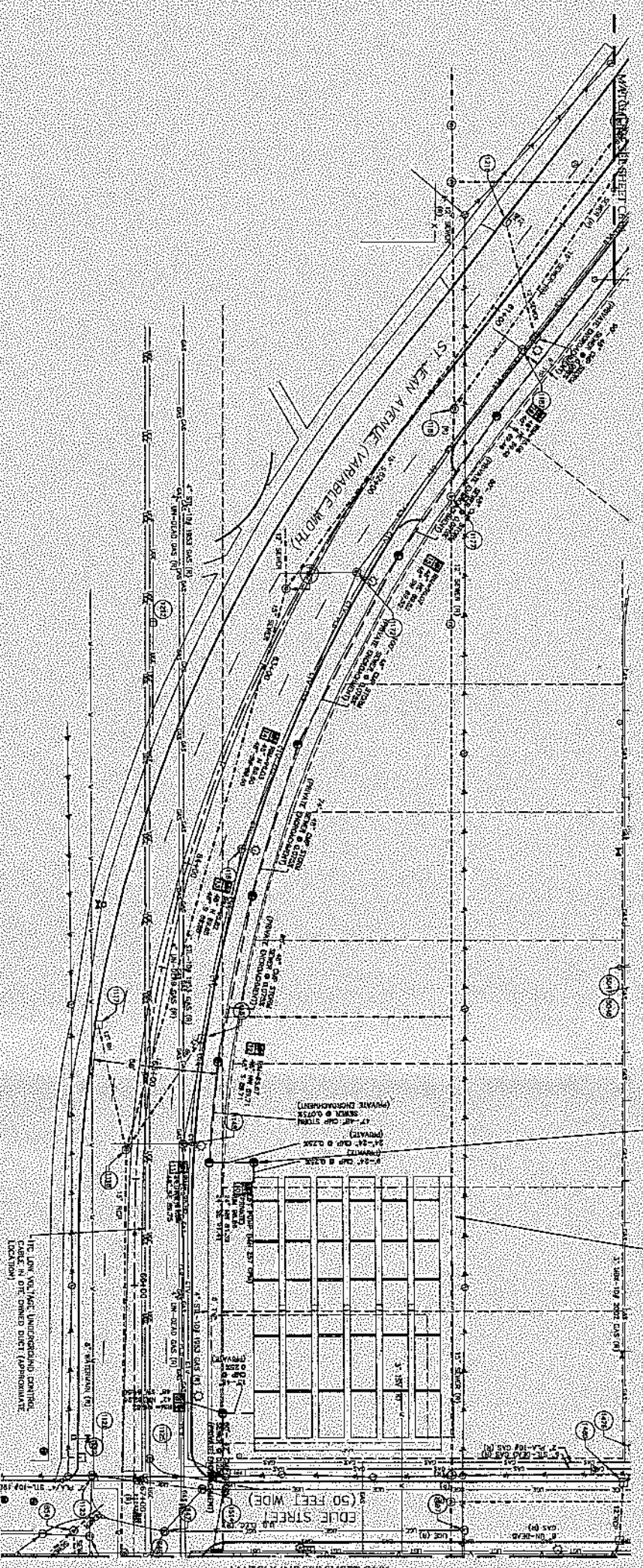

10' Pumps at Underground Detention at St. Lean and Edge

What we need to pump (2' dia. x 10' h):	Notes
40' dia. x 10' h	Signed on Wayne County Standards, maximum release of captured runoff must be gradually over a period of 48 hours.
2.051' dia. x 10' h	Flow per 40' dia. x 10' h (based on 7.84 ft/s).
15.415' dia. x 10' h	Flow per 15.415' dia. x 10' h (based on 7.84 ft/s).
126.61' dia. x 10' h	Flow per 126.61' dia. x 10' h (based on 7.84 ft/s).

PLUM STATION TO BE
DESIGN-BUILD BY CONTRACTOR.
SEE THIS SHEET FOR PUMP
CALCULATIONS.

SEE SHEET C7.03 FOR
BRIDGE DETAILS.

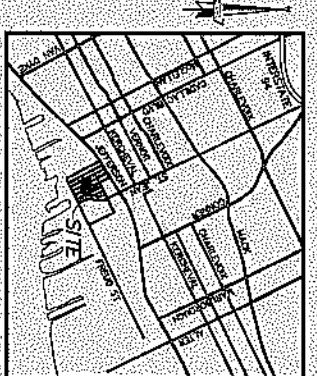

ALTERNATIVE ENGINEERING DESIGN, SEPARATE
PLUMBING PERMIT REQUIRED.

giffels webster

Engineers
Planners
Landscape Architects
Environmental Scientists

28 W. Adams Street
Suite 1200
Detroit, MI 48226
P (313) 962-4442
F (313) 962-9388
www.giffelswebster.com

Estimate:	STC
Language:	AMN
Layer:	SLP
Drawn/Checked:	TEF
Scale:	

Production Scale:

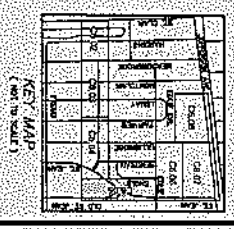

DATE	BY	REVISION
2011.03.17	RESUBMITTAL	RESUBMITTAL
2011.03.17	REVISION	REVISION
2011.03.17	REVISION	REVISION
2011.03.17	REVISION	REVISION
2011.03.17	REVISION	REVISION

Submitted to:
Neighborhood Development
Corporation

500 Griswold, Suite 2200
Detroit, MI 48226

UTILITY PLAN &
PROFILES

Juddeson Village Stormwater
Separation Phase 1

City of Detroit
Wayne County
MICHIGAN

Date:	02.21.16
Scale:	1" = 30'
Sheet:	CS.05
Project:	1607.410

STRUCTURE

STRUCTURE	RIM	INVERT	LENGTH
PRIVATE STORM IN COVER NEW MANHOLE 2'-0" DIA. X 2'-0" DIA. DEPTH = 8.22'	48' S 89.46	46' NF 89.46	
PRIVATE STORM IN COVER NEW MANHOLE 2'-0" DIA. X 2'-0" DIA. DEPTH = 8.50'	48' SW 88.52	49' NF 89.52	
PRIVATE STORM IN COVER NEW MANHOLE 2'-0" DIA. X 2'-0" DIA. DEPTH = 8.42'	48' SW 89.60	48' N 89.60	
PRIVATE STORM IN COVER NEW MANHOLE 2'-0" DIA. X 2'-0" DIA. DEPTH = 8.17'	48' S 89.65	48' N 89.65	
PRIVATE STORM IN COVER NEW MANHOLE 2'-0" DIA. X 2'-0" DIA. DEPTH = 8.25'	48' S 89.71	48' NW 89.71	
PRIVATE STORM IN COVER NEW MANHOLE 2'-0" DIA. X 2'-0" DIA. DEPTH = 8.22'	48' SE 89.75	24' NW 91.35	
PRIVATE STORM IN COVER NEW MANHOLE 2'-0" DIA. X 2'-0" DIA. DEPTH = 8.22'	24' SE 91.41	24' NW 91.39	
PRIVATE STORM IN COVER NEW MANHOLE 2'-0" DIA. X 2'-0" DIA. DEPTH = 11.44'	48' SW 81.56	42' NW 82.96	

STRUCTURE	RIM	INVERT	LENGTH
90'-48" CMP STORM SEWER @ 0.075%	48' S 89.46	46' NF 89.46	80
80'-48" CMP STORM SEWER @ 0.075%	48' SW 88.52	49' NF 89.52	82
100'-48" CMP STORM SEWER @ 0.075%	48' SW 89.60	48' N 89.60	90
74'-18" CMP STORM SEWER @ 0.075%	48' S 89.65	48' N 89.65	92
90'-48" CMP STORM SEWER @ 0.075%	48' S 89.71	48' NW 89.71	84
47'-18" CMP STORM SEWER @ 0.075%	48' SE 89.75	24' NW 91.35	86
24'-24" CMP SEWER @ 0.25%	24' SE 91.41	24' NW 91.39	88
93'-50" INV. (2) UNDERGROUND ELECTRIC WIRES	48' SW 81.56	42' NW 82.96	94

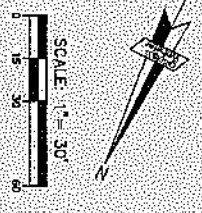

UNDERGROUND
STORMWATER STORAGE. SEE
DETAILS ON SHEET C7.03.

SCALE: 1" = 30' HORIZ
SCALE: 1" = 5' VERT.

NOTE: TABLE ELEVATION VALUES BETWEEN 12" DEEP AND GREATER THAN 15'6" PER SOIL BORINGS DATED 11-12-2002.

INTERCEPT EXISTING SANITARY LATERAL AND CONNECT TO EXISTING 18" COMBINED SEWER. SEE BELOW FOR PROFILE VIEW.

MATCHLINE SEE SHEET C647

MATCHLINE SEE SHEET C645

MATCHLINE SEE SHEET C645

MATCHLINE SEE SHEET C645

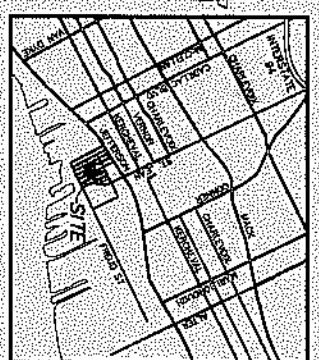
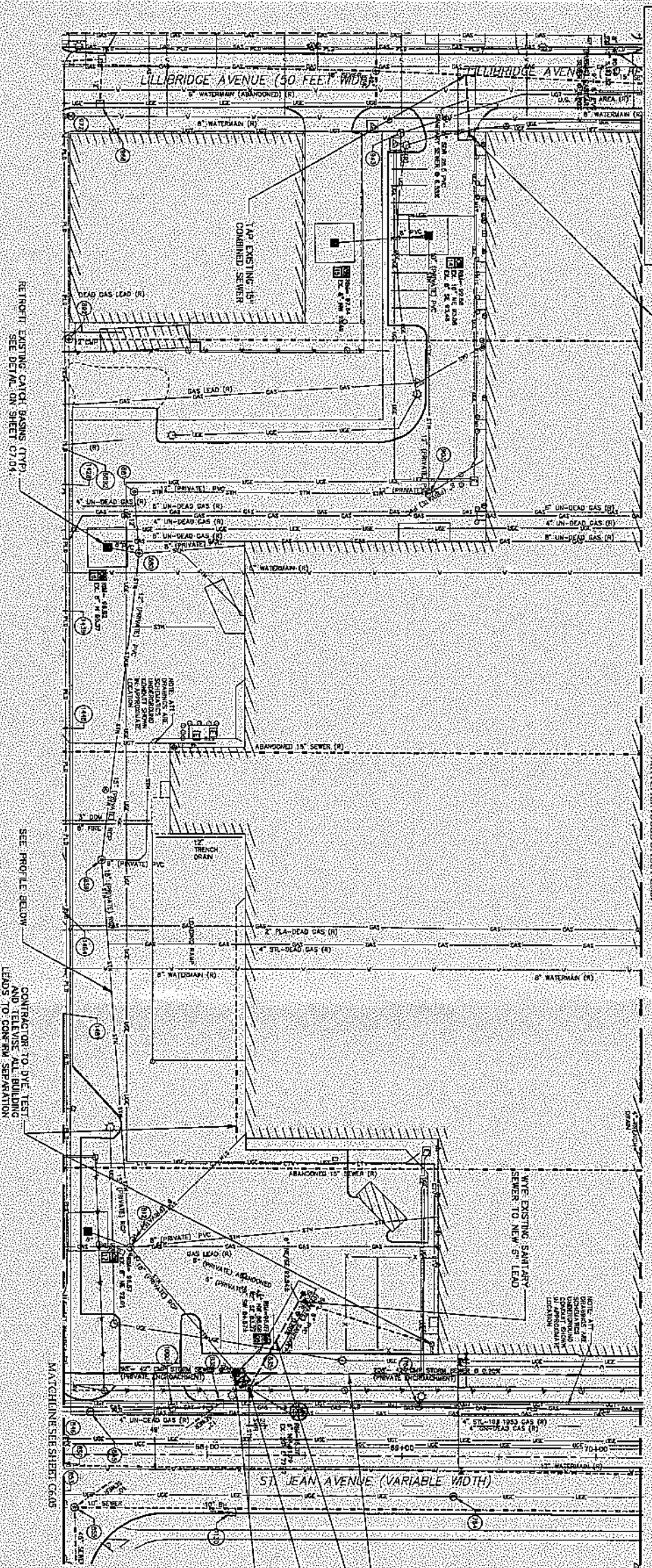

ALTERNATIVE ENGINEERING DESIGN, SEPARATE PLUMBING PERMIT REQUIRED.
 SEE SHEET C648 FOR PROFILE VIEW.
 SEE SHEET C647 FOR PROFILE VIEW.

PROTECT EXISTING MA. BLANKED 18" DIA. SEWER TO SOUTHWEST. TAP WITH NEW 8" SANITARY TO NORTHWEST. FLOWS ONLY TO ACCEPT SANITARY. CONSTRUCT NEW MANHOLE AND SEWER OVER EXISTING 18" SEWER.

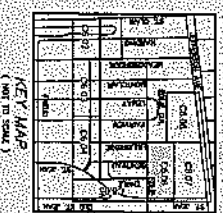

STRUCTURE

RIM	INVERT	LENGTH
102	EX 15° NW 86.80 EX 9° NE 87.50	12'
100	EX 8° SE 93.48 EX 10° NE 93.08 EX 8° NW 93.49	12'
98	EX 8° NW 95.40 EX 10° SW 92.20 EX 12° SE 91.95	12'
96	EX 12° NW 91.11 EX 12° NE 91.01	12'
94	EX 12° NE 91.08 EX 8° N 92.89 EX 12° S 90.99 EX 12° SW 90.39 EX 12° NE 90.39	12'
92	EX 6° NW 90.61 EX 12° SW 89.26 EX 15° NE 89.21	12'
90	EX 4° N 92.43	12'
88	EX 8° N 91.18 EX 8° W 88.98 EX 8° S 92.01 EX 15° SW 86.28 EX 18° NE 86.23	12'
86	EX 18° SW 84.67 EX 42° SE 83.27 EX 42° NW 86.17	12'
84		12'
82		12'
80		12'
78		12'
76		12'

SCALE: 1" = 30' HOR.
1" = 5' VERT.

STRUCTURE

RIM	INVERT	LENGTH
102		12'
100		12'
98		12'
96		12'
94		12'
92		12'
90		12'
88		12'
86		12'
84		12'
82		12'
80		12'
78		12'
76		12'

SCALE: 1" = 30'

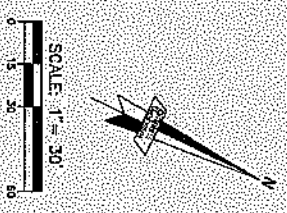

Engineers
Surveyors
Planners
Landscape Architects
Environmental Scientists
28 W. Adams Street
Suite 1700
Detroit, MI 48226
P (313) 962-4444
F (313) 962-9888
www.giffelswebster.com

Engineer	STC
Manager	MMW
Designer	SLP
Draftsman	TEI
Checker	

DATE	ISSUE
09/23/16	PRELIMINARY DESIGN
10/15/16	FINAL DESIGN
11/15/16	CONSTRUCTION

Neighborhood Development
 Corporation
 540 Grandville, Suite 2700
 Detroit, MI 48226

UTILITY PLAN & PROFILES
 Jefferson Village Stormwater Separation Phase I
 City of Detroit
 Wayne County
 MICHIGAN

DATE	09/23/16
SCALE	1" = 30'
SHEET	C645
PROJECT	18007/410

NOTE:
 WATER TABLE ELEVATION VARIES BETWEEN 12' DEEP
 AND GREATER THAN 15'± PER SOIL BORINGS DATED
 11-12-2002

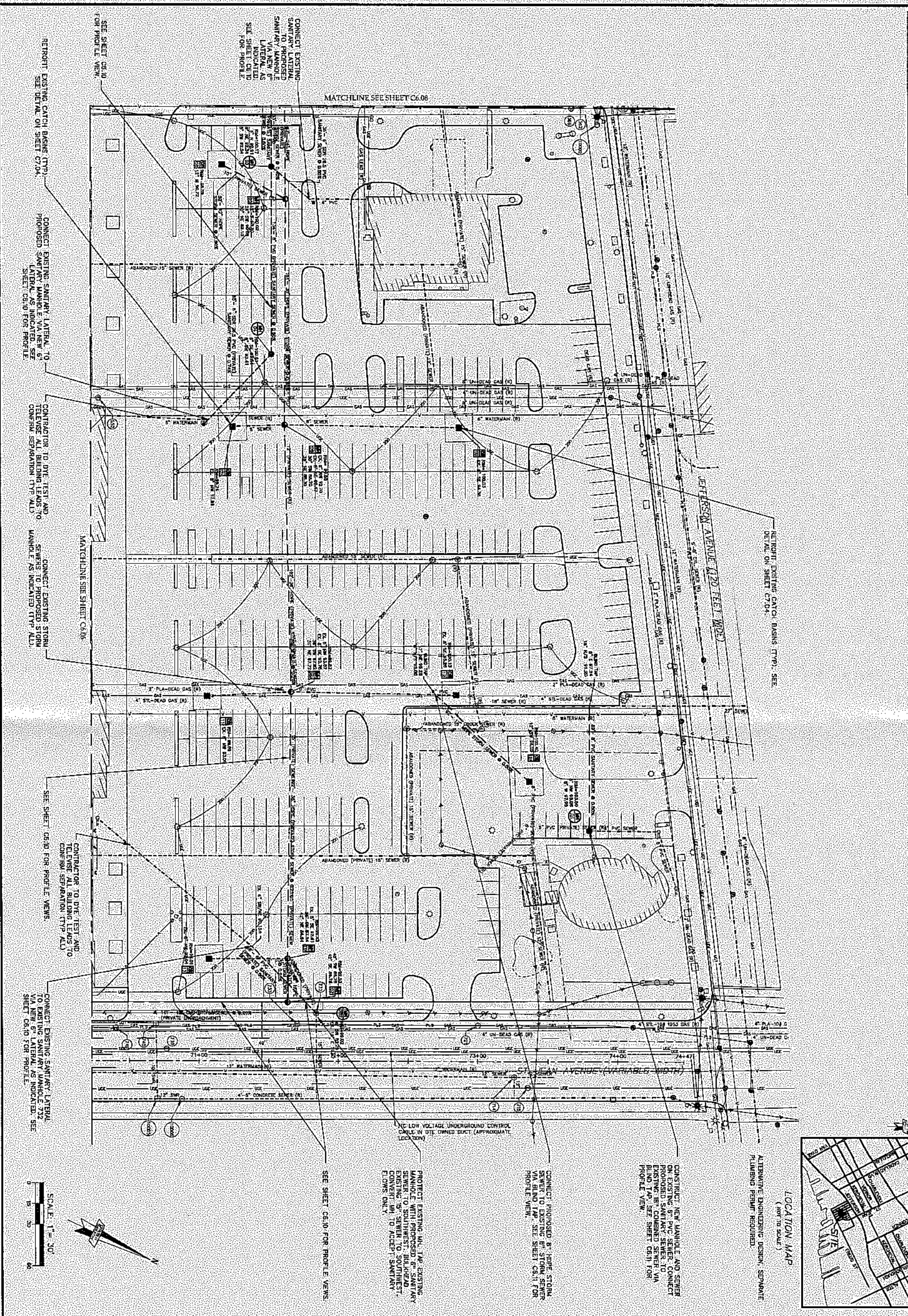

CONNECT EXISTING SANITARY LATERAL TO PROPOSED SANITARY MANHOLE VIA NEW 6" LATERAL AS INDICATED SIZE SEE SHEET C6.10 FOR PROFILE.

RETROFIT EXISTING CATCH BASINS (TYP.) SEE DETAIL ON SHEET C7.04.

CONNECT EXISTING SANITARY LATERAL TO PROPOSED SANITARY MANHOLE VIA NEW 6" LATERAL AS INDICATED SIZE SEE SHEET C6.10 FOR PROFILE.

CONTRACTOR TO DIE TEST AND TELEVIEW ALL BUILDING LEADS TO CONFIRM SEPARATION (TYP. ALL).

CONNECT EXISTING STORM SEWERS TO PROPOSED STORM SEWERS AS INDICATED (TYP. ALL).

CONNECT EXISTING SANITARY LATERAL TO EXISTING SANITARY MANHOLE VIA NEW 6" LATERAL AS INDICATED. SEE SHEET C6.10 FOR PROFILE.

CONTRACTOR TO DIE TEST AND TELEVIEW ALL BUILDING LEADS TO CONFIRM SEPARATION (TYP. ALL).

CONNECT EXISTING SANITARY LATERAL TO EXISTING SANITARY MANHOLE VIA NEW 6" LATERAL AS INDICATED. SEE SHEET C6.10 FOR PROFILE.

PROTECT EXISTING 44kV TAP EXISTING MANHOLE WITH PROPOSED 6" SANITARY SEWER TO SOUTHWEST. BACKFILL EXISTING 18" CONCRETE SEWER VIA BLIND TAP. SEE SHEET C6.11 FOR PROFILE VIEW.

CONSTRUCT NEW MANHOLE AND SEWER ON EXISTING 8" PVC SEWER. CONNECT EXISTING 18" CONCRETE SEWER VIA BLIND TAP. SEE SHEET C6.11 FOR PROFILE VIEW.

ALTERNATIVE ENGINEERING DESIGN. SEPARATE PLUMBING PERMIT REQUIRED.

SCALE: 1" = 30'

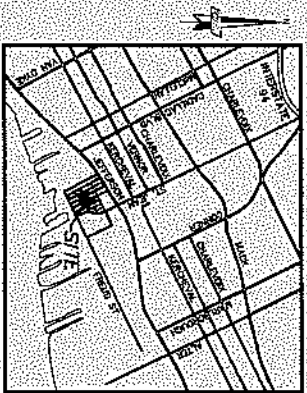

LOCATION MAP
 (NOT TO SCALE)

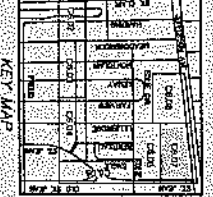

KEY MAP
 (NOT TO SCALE)

DATE	DESCRIPTION
08/23/16	PRELIMINARY DESIGN
09/07	DESIGN DEVELOPMENT
10/07	FINAL DESIGN
10/27	PERMIT REVIEW SUBMITTAL
11/19	PERMIT REVIEW SUBMITTAL

Developed by:
 Neighborhood Development
 Corporation
 500 Ontario, Suite 2200
 Detroit, MI 48226

UTILITY PLAN & PROFILES

Jackson Village Stormwater Separation Phase I

City of Detroit
 Wayne County
 Michigan

DATE: 08.23.16
 SCALE: 1" = 30'
 SHEET: C6.10
 PROJECT: 18027.410

giffels webster

Engineers
 Surveyors
 Planners
 Landscape Architects
 Environmental Specialists

28 W. Adams Street
 Suite 1200
 Detroit, MI 48226
 (313) 552-4442
 (313) 552-5555

www.giffelswebster.com

NOTE:
WATER TABLE ELEVATION VARIES BETWEEN 12' DEEP
AND GREATER THAN 15.6' PER SOIL BORINGS DATED
11-12-2002.

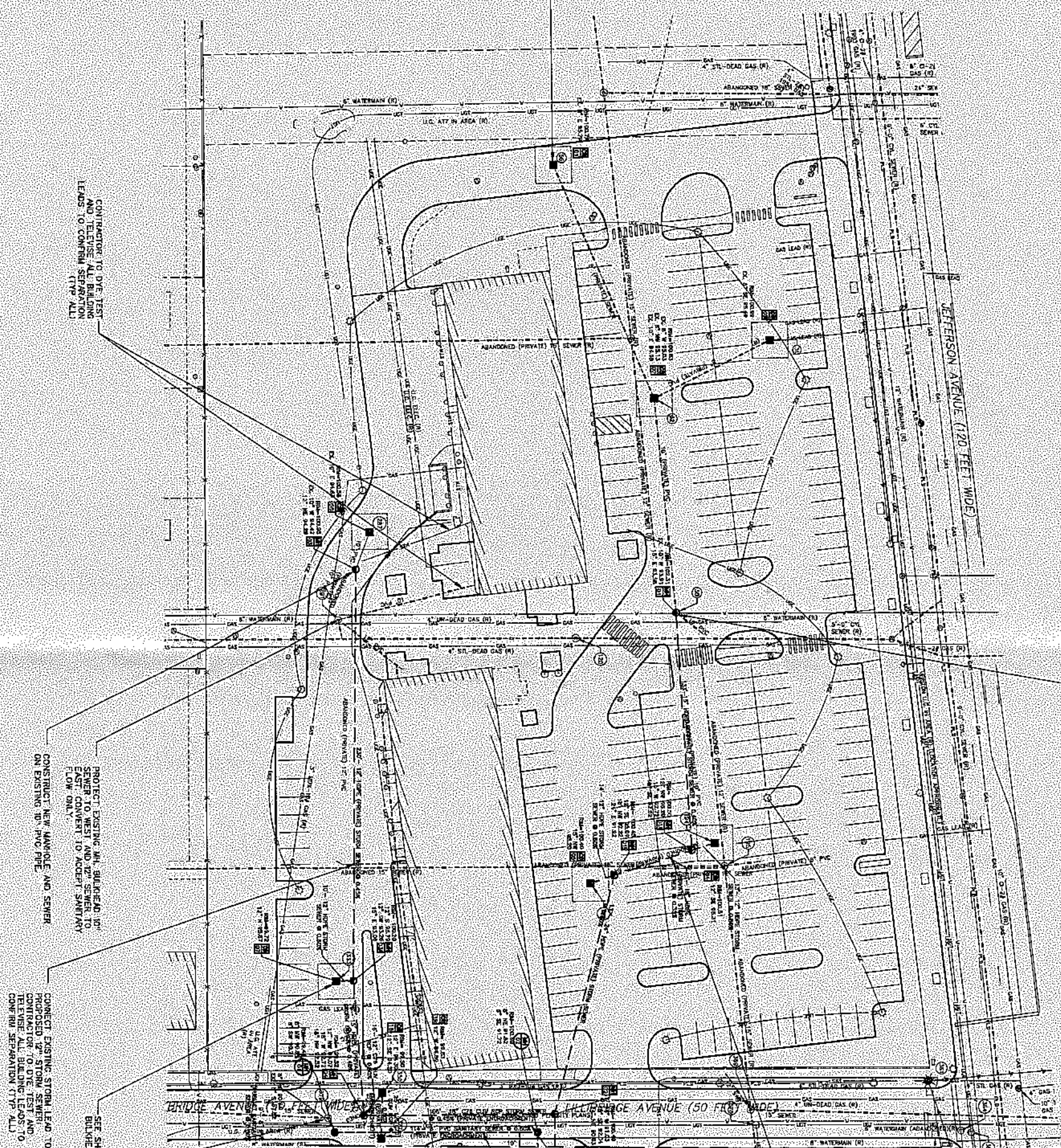

RECONFIGURE MANHOLE, BUILD HEAD TO
PVC OUTLET TO 8\"/>

CONVERT TO PVC TEST
AND REUSE ALL BUILDING
LEADS TO CONFIN SEPARATION
(TYP ALL)

PROJECT EXISTING MH, BUILDHEAD FOR
SEWER TO WEST AND 12\"/>

CONNECT EXISTING STORM LEAD TO
PROPOSED 12\"/>

TOP EXISTING MANHOLE WITH
PROPOSED 8\"/>

SEE SHEET C6.09 FOR PROFILE VIEWS.

SEE SHEET C6.09 FOR PROFILE VIEWS.

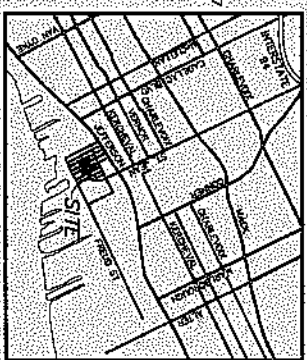

ALTERNATIVE ENGINEERING DESIGN, SEPARATE
PLUMBING PERMIT REQUIRED.

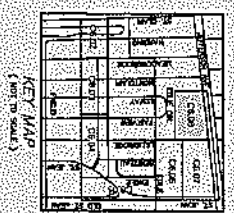
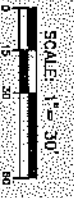

DATE	REVISION
2013.10.03	PRELIMINARY PERMIT REVIEW CHECK & REVISION
2013.05.25	DESIGN CHECK CHECK & REVISION
2013.01.15	PERMIT REVIEW
2012.06.27	PERMIT REVIEW REVISIONS
2012.01.18	PERMIT REVIEW REVISIONS
2011.03.03	PERMIT REVIEW REVISIONS

Prepared for:
Neighborhood Development
Corporation
900 Grand, Suite 200
Dorset, MA 01925

**UTILITY PLAN &
PROFILES**

Jefferson Village Steamhead
Separation Phase 1
City of Dorset
Vernon County
MJC/GAM

TITLE	08-23-16
SCALE	1"=30'
SHEET	06.08
PROJECT	1807 A1D

giffels webster

Engineers
Surveyors
Planners
Landscape Architects
Environmental Specialists

28 W. Adams Street
Suite 100
Dorset, MA 01928
508-913-5524
1019-952-2868
www.giffelswebster.com

SEE SHEET C6.08
FOR PLAN VIEW

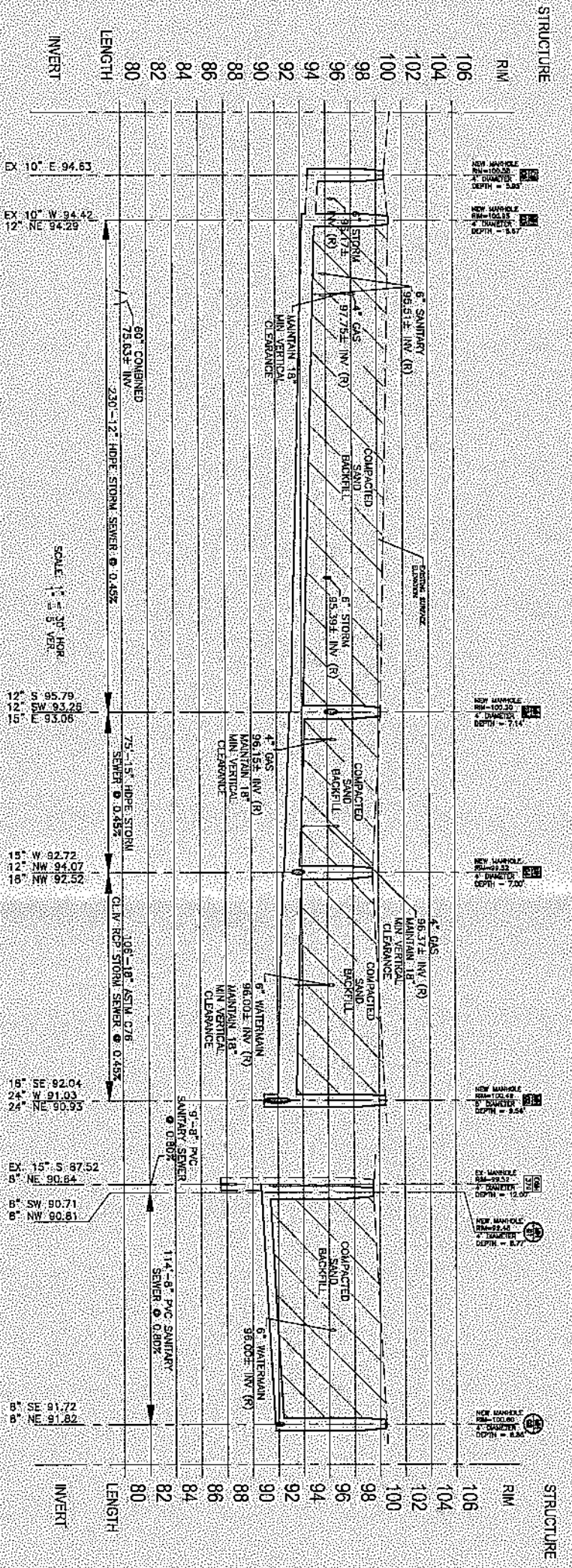

SEE SHEET C6.08
FOR PLAN VIEW

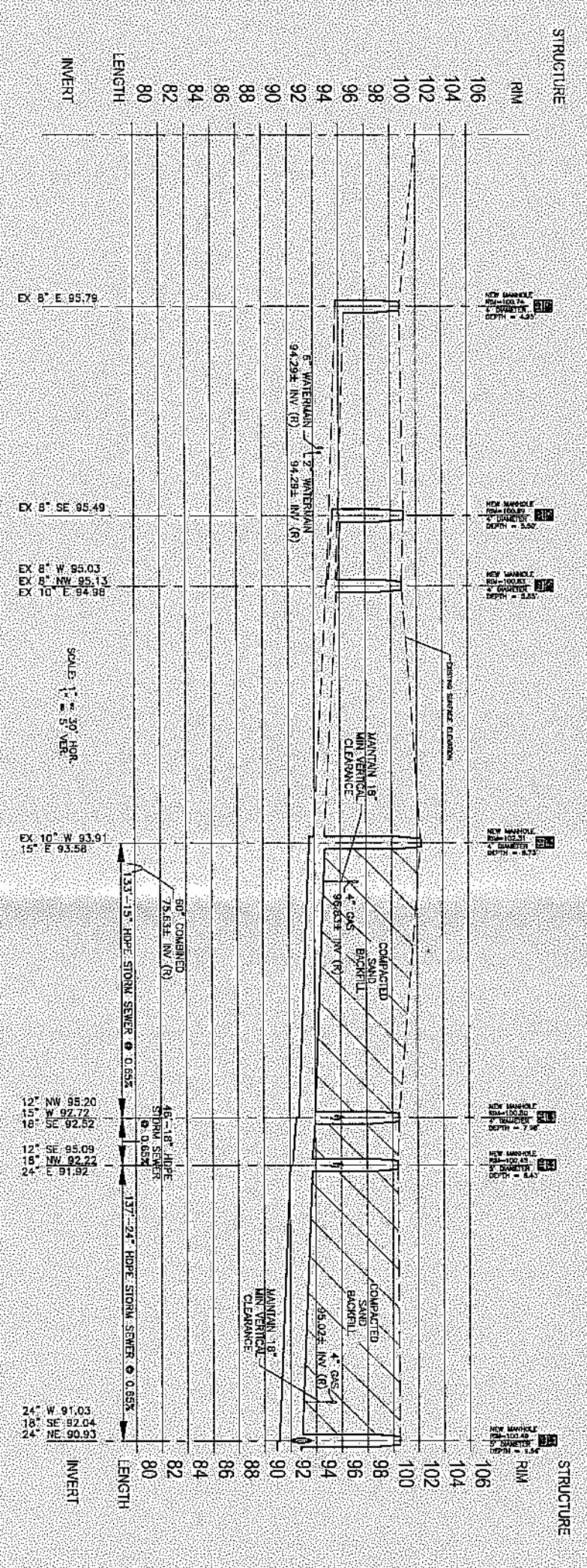

ALTERNATIVE ENGINEERING DESIGN, SEPARATE
PLUMBING PERMIT REQUIRED.



Engineers
Surveyors
Landscape Architects
Environmental Scientists
23 W. Adams Street
Suite 100
Detroit, MI 48226
P (313) 962-4442
F (313) 962-6088
www.giffelswebster.com

Encoder	STC
Author	MMN
Designer	SLP
Quality Control	TEJ
Checker	

DATE	DESCRIPTION
2015.11.19	PRELIMINARY PERMIT WATER
2015.05.05	DESIGN & PERMITTING
2015.01.11	DESIGN & PERMITTING
2014.12.02	DESIGN & PERMITTING
2014.11.20	DESIGN & PERMITTING

Prepared by
Neighborhood Development
Corporation
901 Grandville, Suite 2300
Detroit, MI 48226

UTILITY PLAN &
PROFILES
Jubilation Village Stormwater
Separation Phase 1
City of Detroit
Wayne County
MICHIGAN

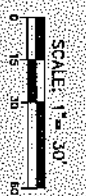

DATE	DESCRIPTION
2015.11.19	PRELIMINARY PERMIT WATER
2015.05.05	DESIGN & PERMITTING
2015.01.11	DESIGN & PERMITTING
2014.12.02	DESIGN & PERMITTING
2014.11.20	DESIGN & PERMITTING

Executive	STC
Manager	AMM
Designer	SLP
Utility Control	TET
Checker	

Professional Seal

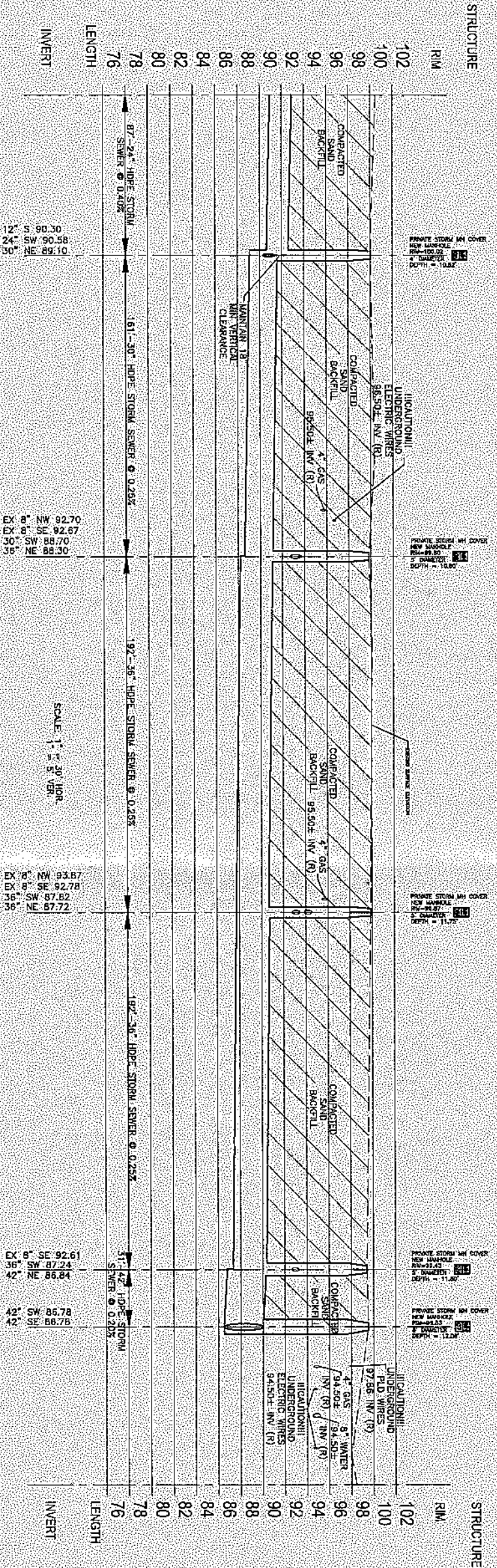

SEE SHEET C6.07
FOR PLAN VIEW

SEE SHEET C6.06
FOR PLAN VIEW

SEE SHEET C6.07
FOR PLAN VIEW

SEE SHEET C6.07
FOR PLAN VIEW

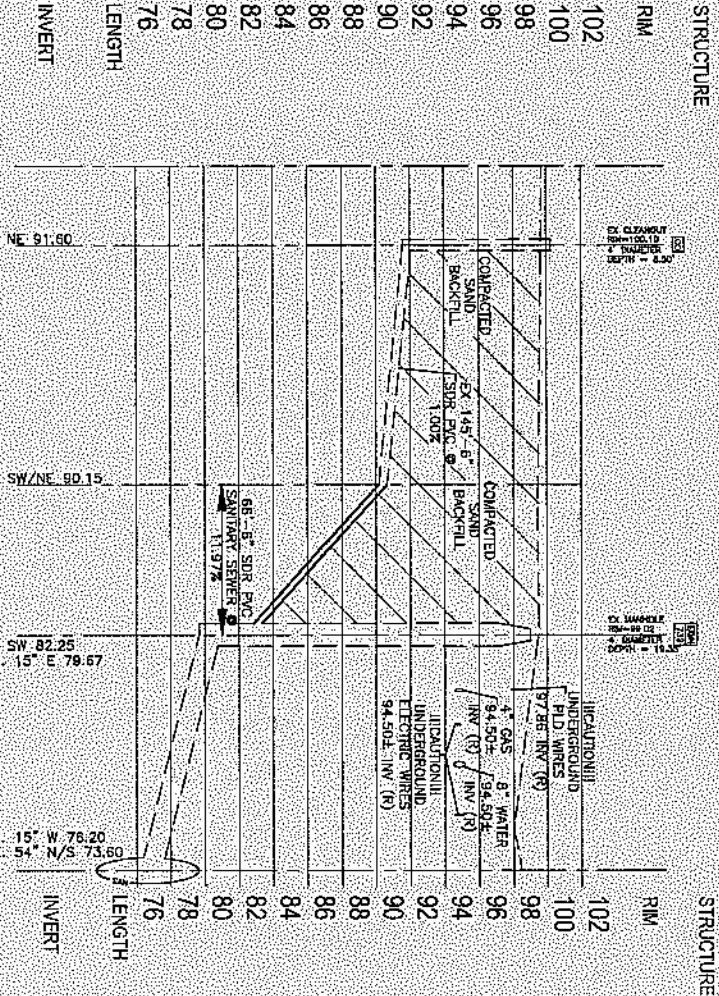
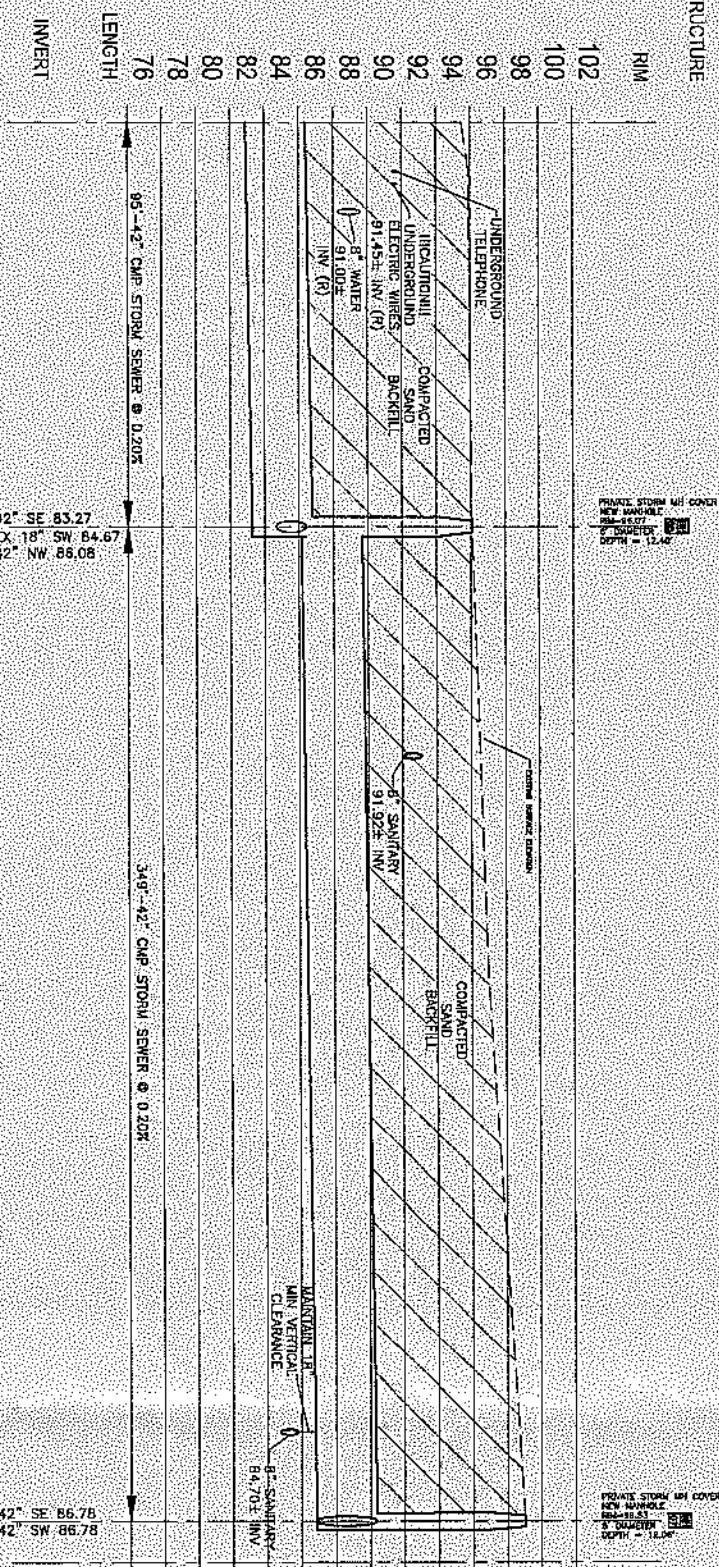

DATE	DESCRIPTION
2015.01.13	PRELIMINARY DESIGN
2015.02.10	FINAL DESIGN
2015.03.10	CONSTRUCTION PERMITS
2015.04.10	CONSTRUCTION

300 Cleveland, Suite 2200
Detroit, MI 48226

UTILITY PLAN & PROFILES

Jefferson Village Stormwater Separation Phase 1

City of Detroit
Wayne County
MICHIGAN

Date:	03.23.16
Scale:	1" = 30'
Sheet:	C6.10
Typed:	1807.7410

ALTERNATIVE ENGINEERING DESIGN. SEPARATE PLUMBING PERMITS REQUIRED.



SEE SHEET C6.08
FOR PLAN VIEW

SEE SHEET C6.07
FOR PLAN VIEW

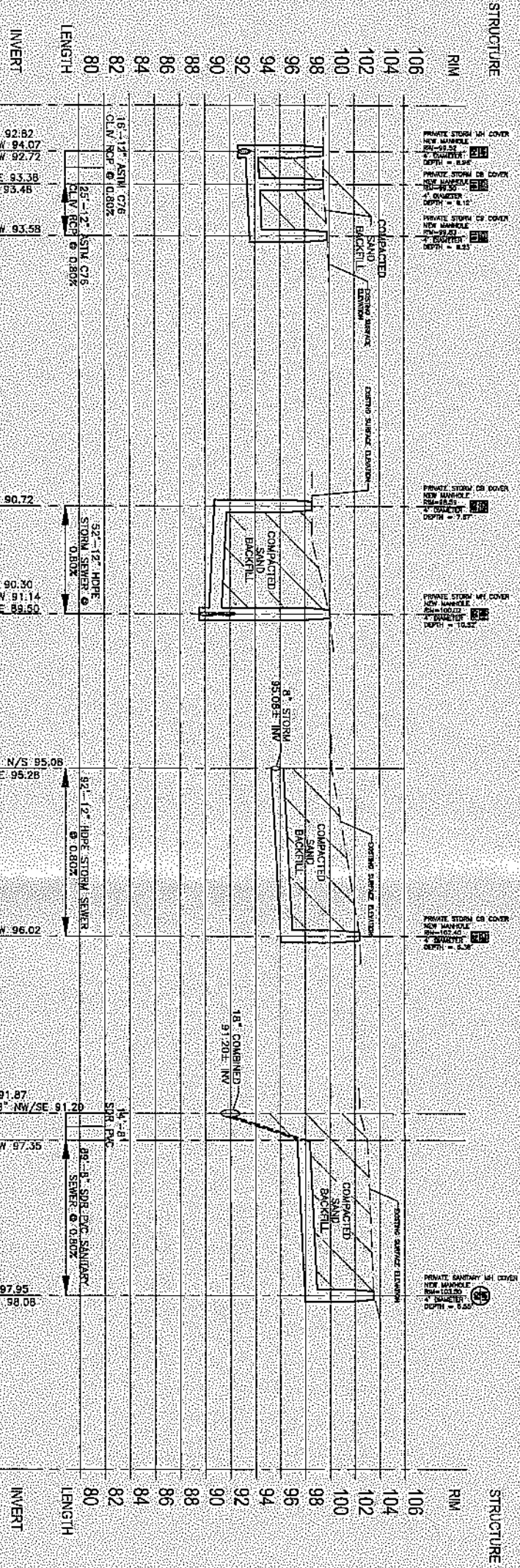

STRUCTURE	RIM	INVERT	LENGTH
106	106	106	
104	104	104	
102	102	102	
100	100	100	
98	98	98	
96	96	96	
94	94	94	
92	92	92	
90	90	90	
88	88	88	
86	86	86	
84	84	84	
82	82	82	
80	80	80	

SEE SHEET C6.06
FOR PLAN VIEW

SEE SHEET C6.07
FOR PLAN VIEW

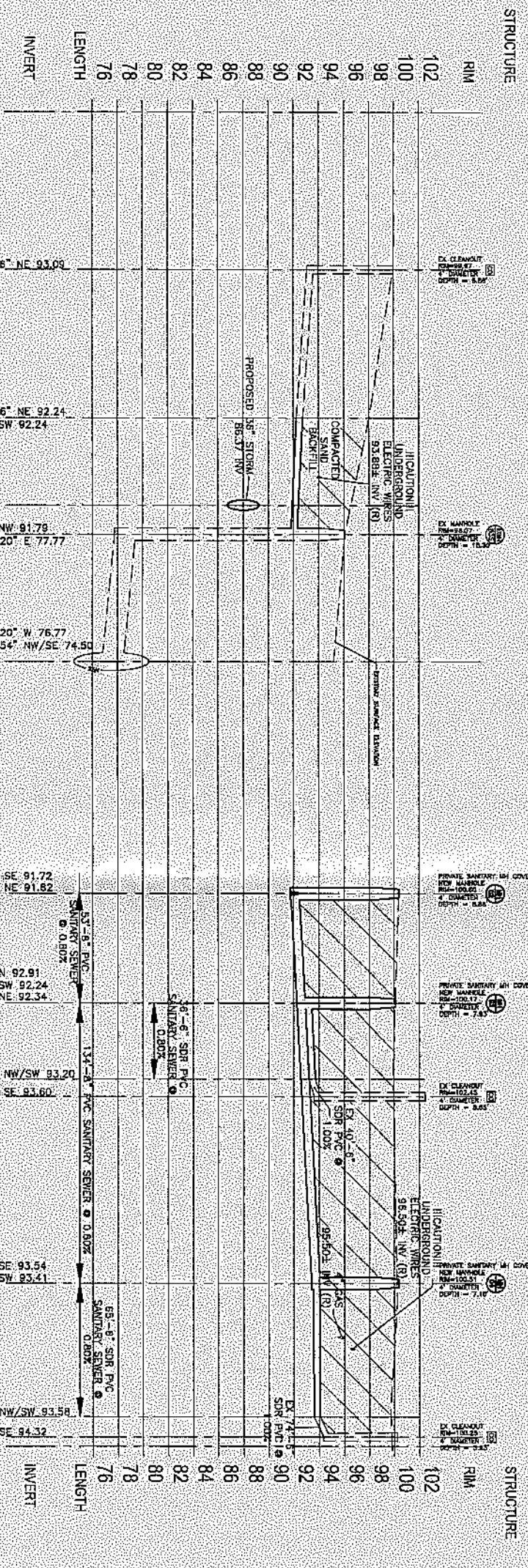

STRUCTURE	RIM	INVERT	LENGTH
102	102	102	
100	100	100	
98	98	98	
96	96	96	
94	94	94	
92	92	92	
90	90	90	
88	88	88	
86	86	86	
84	84	84	
82	82	82	
80	80	80	
78	78	78	
76	76	76	

ALTERNATIVE ENGINEERING DESIGN, SEPARATE
PLUMBING PERMIT REQUIRED.

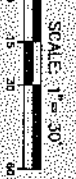

DATE:	02/21/18
SCALE:	1" = 30'
SHEET:	CE111
PROJECT:	18027/110

UTILITY PLAN & PROFILES

Jefferson Village Stormwater
Separation Phase I

City of Okemos
Washtenaw County
MICHIGAN

Prepared by:
Vidgihoff/Good Development
Corporation

500 Chiswood, Suite 2000
Dowagiac, MI 48225

NO.	DATE	DESCRIPTION
2015-01-01		PRELIMINARY DESIGN
2015-01-01		FINAL DESIGN
2015-01-01		CONSTRUCTION