

City of Detroit
**City Engineering Division, Department of Public Works
Survey Bureau**

NOTICE OF PROPOSED CHANGE IN PROPERTY

Date: 06/07/2018

Petition: x1822

- | | |
|--|--|
| <input type="checkbox"/> AT&T Telecommunication | <input type="checkbox"/> Berm Use |
| <input type="checkbox"/> Comcast Television (CATV) | <input type="checkbox"/> Conversion to Easement |
| <input type="checkbox"/> Detroit Edison (DTE) | <input type="checkbox"/> Dedication |
| <input type="checkbox"/> Fire Department | <input checked="" type="checkbox"/> Encroachment |
| <input type="checkbox"/> Great Lakes Water Authority | <input type="checkbox"/> Outright Vacation |
| <input type="checkbox"/> Land Bank Authority | <input type="checkbox"/> Temporary Closing |
| <input type="checkbox"/> Michcon (DTE) | |
| <input type="checkbox"/> Planning & Development Department | |
| <input type="checkbox"/> Public Lighting Authority | |
| <input type="checkbox"/> Public Lighting Department | |
| <input type="checkbox"/> Police Department | |
| <input type="checkbox"/> Solid Waste Division, DPW | |
| <input type="checkbox"/> Street Design Bureau, DPW | |
| <input type="checkbox"/> Street Maintenance Division, DPW | |
| <input type="checkbox"/> Traffic Engineering Division, DPW | |
| <input type="checkbox"/> Water and Sewerage Department | |
| <input type="checkbox"/> _____ | |

A petition drawing is attached. Property shown on the attached print is proposed to be changed as indicated. Kindly report (using the back of this sheet) the nature of your services, if any affected by the proposed change and the estimated costs of removing and rerouting such services (if necessary).

Please return one copy to City Engineering Division, DPW within two weeks of the submittal date. Retain one copy and print for you file.

Ron Brundidge, Director, Department of Public Works

By: Richard Doherty, CED DPW
City Engineer

TO: City Engineering Division, DPW
2 Woodward Ave., Suite 642
Detroit, Michigan 48226-3462
Survey Bureau: 313-224-3970

Petition: x1822

The proposed change in property (referred to on the other side of this sheet) would affect our services as follows:

- Not Involved
- Involved; but asking you to hold action on this petition until further notice.
- Involved; but no objections to the property change.
- Involved; objection to the property change.
- Involved; but no objections to the property change...provided as easement of the full width of the public right-of-way (street, alley or other public place) is reserved.
- Involved; the nature of our services and the estimated costs of removing and/or rerouting such services are:

Police FIFTH PRECINCT
(Utility or City Department)

Michael Paul
By

Sergeant
Title

6-21-18
Date

313-596-5570
Area code - Telephone number

APPROVED
JUN 22 2018
SOMMANDER

PETITION NO. 1822
 GIFFELS WEBSTER
 28 W. ADAMS, SUITE 1200
 DETROIT, MICHIGAN 48226
 C/O MICHAEL MARKS P.E.
 PHONE NO. 313 962-4442

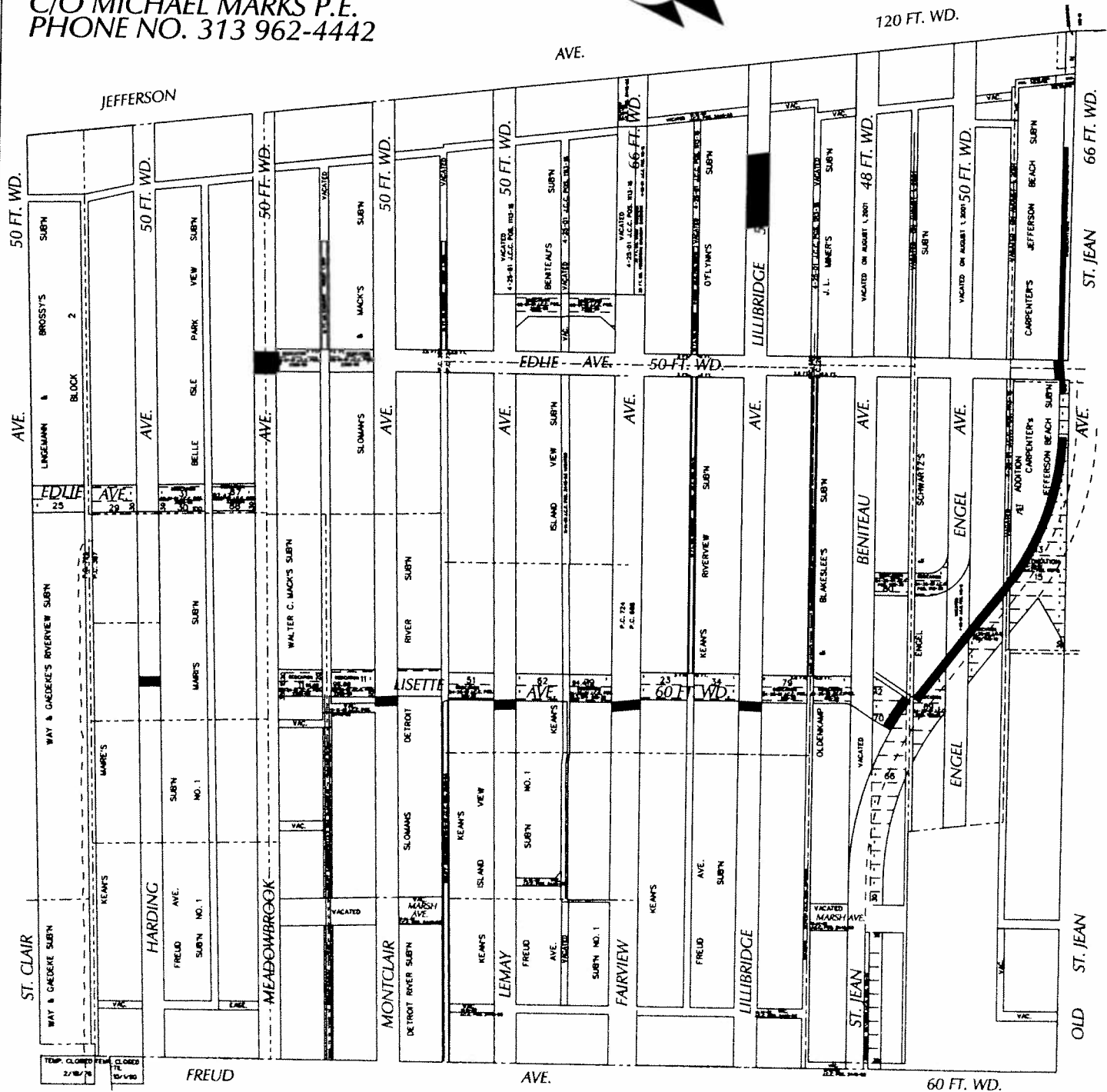

 - REQUEST ENCROACHMENT
 (With Sub-Surfacing Management System)

(FOR OFFICE USE ONLY)

CARTO 54 A & B

B					
A					
DESCRIPTION		DRWN	CHKD	APPD	DATE
REVISIONS					
DRAWN BY	WLW	CHECKED		KSM	
DATE	06-07-18	APPROVED			

REQUEST ENCROACHMENT
 INTO VARIOUS LOCATIONS
 IN THE AREA BOUND BY
 ST. JEAN, FREUD, ST. CLAIR
 AND E. JEFFERSON AVE.
 (With Sub-Surfacing Management System)

CITY OF DETROIT
 CITY ENGINEERING DEPARTMENT
 SURVEY BUREAU
 JOB NO. 01-01
 DRWG. NO. X 1822



November 1, 2017

HAND DELIVER

**Honorable Detroit City Council
C/o Detroit City Clerk
2 Woodward Avenue
200 Coleman A. Young Municipal Center
Detroit, Michigan 48226**

RE: Giffels Webster, Neighborhood Development Corporation, and Economic Development Corporation of the City of Detroit, request to encroach public rights-of-way with private storm water management system in the Jefferson Village neighborhood.

Jefferson Village is located in the City of Detroit and is bounded by Jefferson Avenue to the north, St. Jean Avenue to the east, Freud Street to the south, and the Harding Canal to the west. This area consists of a shopping plaza known as the "Shops at Jefferson Village" and single family homes and is serviced by a combined sewer system. The Jefferson Village project aims to separate the storm flow from the combined system and divert it to an underground stormwater detention system. Giffels Webster respectfully requests sub-surface encroachments for the following public right-of-ways:

- Harding Avenue (50 feet wide), between Edlie Street and Freud Avenue; beginning 365 feet south of south Edlie ROW and extending 20 feet south, full ROW in width
- Intersection of Lisette Avenue and Meadowbrook Avenue; 55 feet easterly from west Meadowbrook ROW and 48 feet northerly from south Lisette ROW
- Montclair Avenue (50 feet wide) at Lisette; beginning at south ROW of Lisette and extending south 20 feet, full ROW in width
- Lemay Avenue (50 feet wide) at Lisette; beginning at south ROW of Lisette and extending south 20 feet, full ROW in width
- Fairview Avenue (66 feet wide) at Lisette; beginning at south ROW of Lisette and extending south 20 feet, full ROW in width
- Lillibridge Avenue (50 feet wide) at Lisette; beginning at south ROW of Lisette and extending south 20 feet, full ROW in width
- Lisette Avenue (80 feet wide) at St. Jean Avenue; beginning at west ROW of St. Jean and extending west 20 feet, full ROW in width
- St. Jean Avenue between Lisette Avenue and Edlie Avenue; beginning 10 feet north of north Lisette ROW and extending 690 feet north, and 17 feet easterly from west St. Jean ROW
- St. Jean Avenue at Edlie Street; beginning at south ROW of Edlie and extending south 31 feet, and 10 feet easterly from west St. Jean ROW
- Intersection of Edlie Street and St. Jean Avenue; 50 feet southerly from north Edlie ROW, and 10 feet west and 10 feet east from west St. Jean ROW
- St. Jean Avenue between Jefferson Avenue and Edlie Street; beginning 258 feet from south Jefferson ROW and extending south 465 feet, and 10 feet easterly from west St. Jean ROW

- Lillibridge Avenue (50 feet wide) between Jefferson Avenue and Edlie Street; beginning 199 feet from south Jefferson ROW and extending 160 feet south, full ROW in width

All work outlined above will be performed per Michigan Plumbing Code, City of Detroit, CED, and DWSD Standards. Limits of the requested encroachments can be found in the attachment, enclosed herein. If you should have any questions, please do not hesitate to contact Michael Marks at 313.980.1469 or mmarks@giffelswebster.com.

Respectfully,

Giffels Webster

A handwritten signature in cursive script, appearing to read "Michael Marks".

Michael Marks, PE
Partner

PRIVATE STORMWATER MANAGEMENT SYSTEM ENCROACHMENT

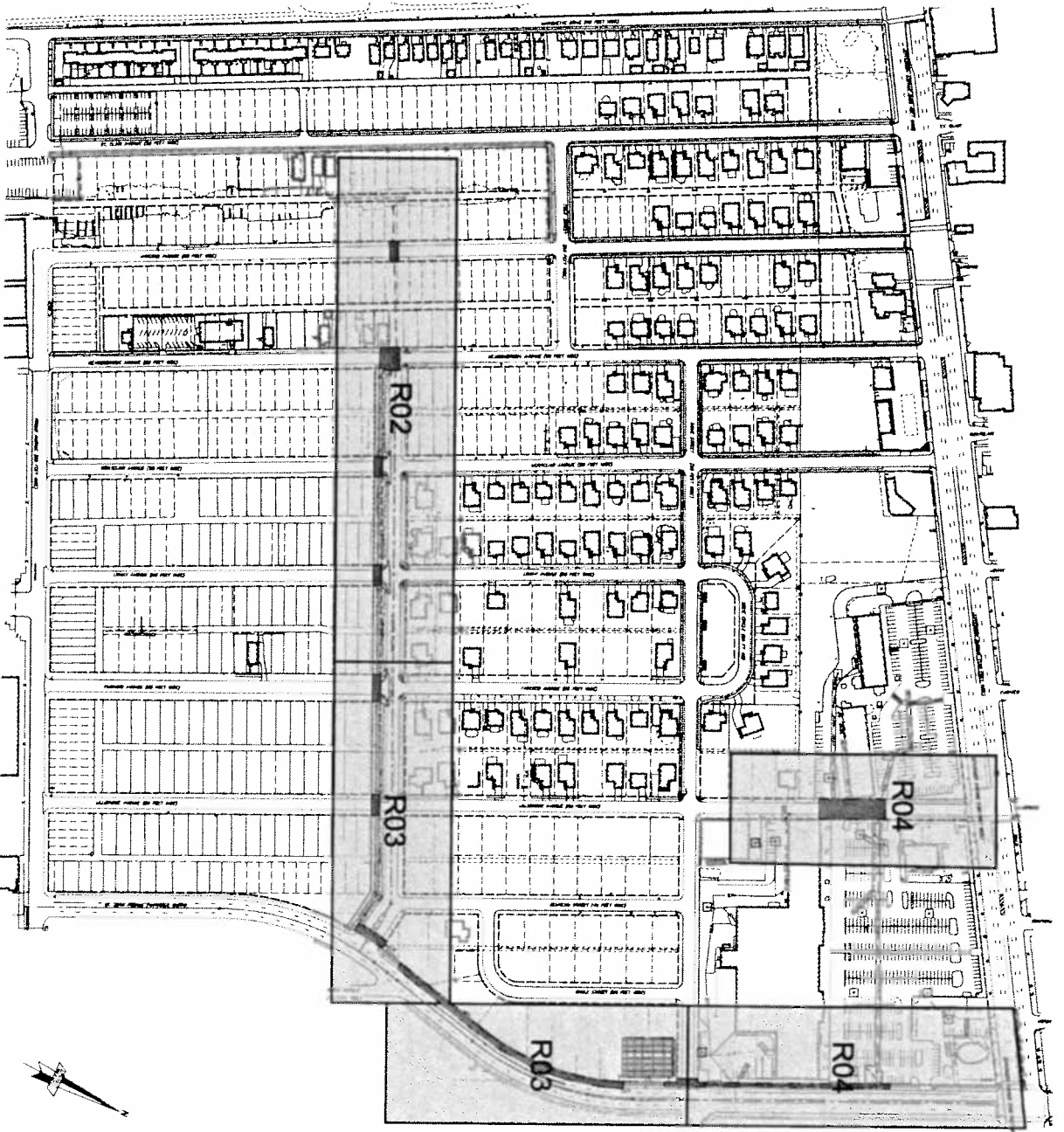
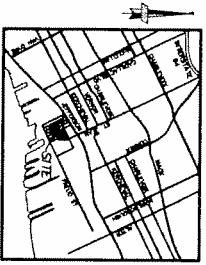

GIFFELS WEBSTER
28 W. ADAMS STE 1200
DETROIT, MICH. 48226
ATT: MICHAEL MARKS
P. 313.980.1469 F.313.962.5068
E. MMARKS@GIFFELSWEBSTER.COM

PRIVATE STORMWATER MANAGEMENT SYSTEM ENCROACHMENT

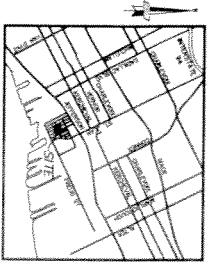
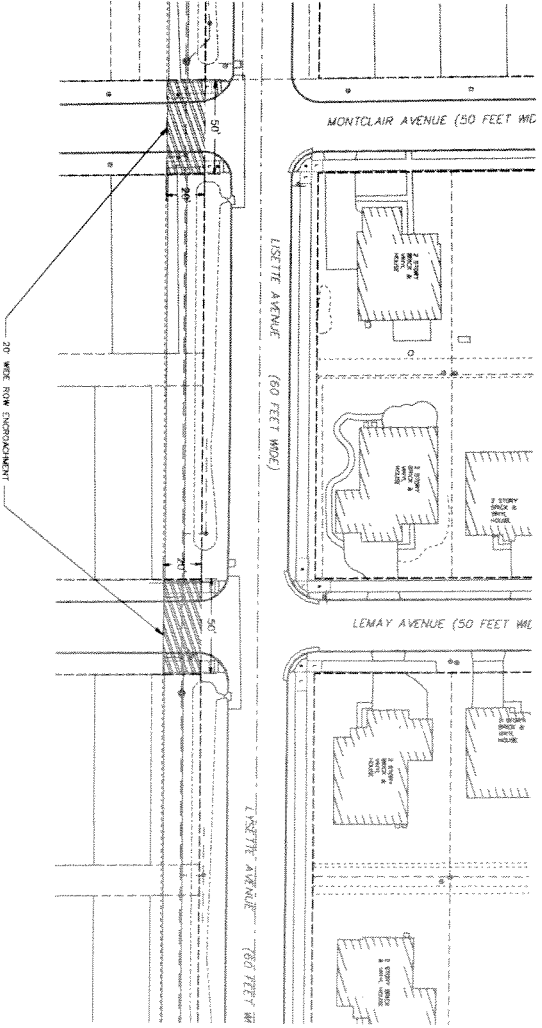
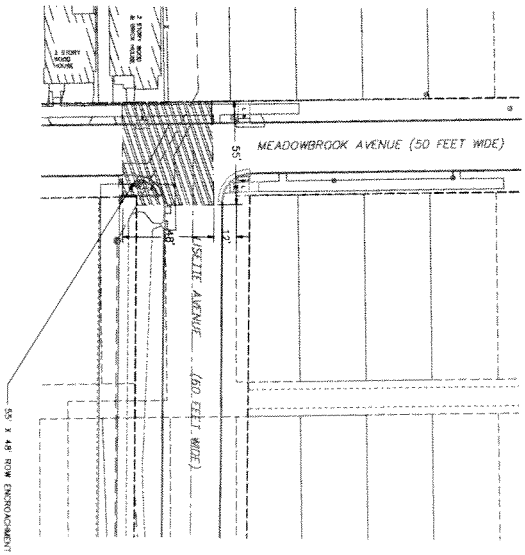
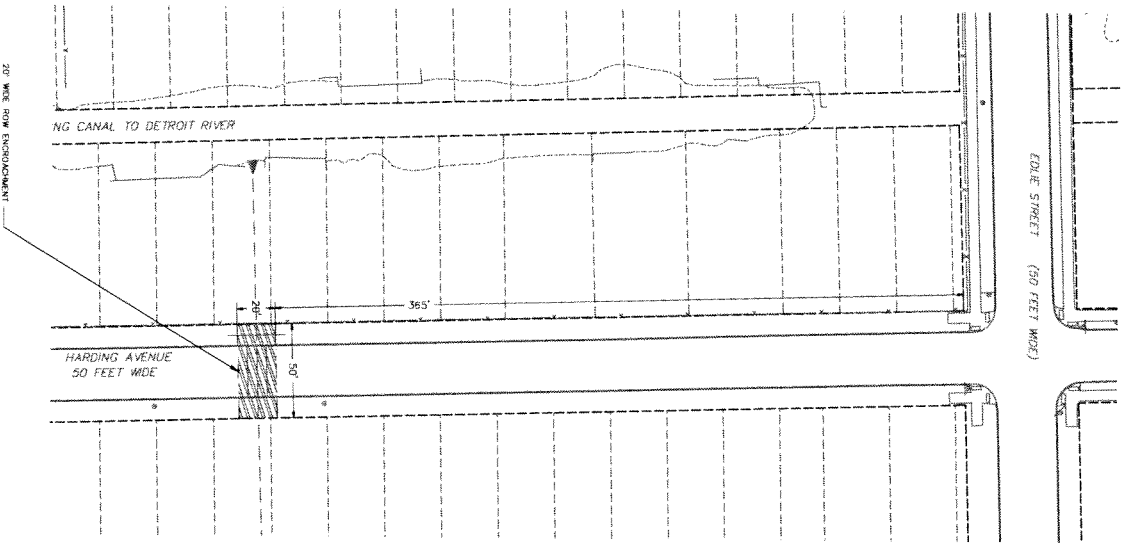

- LEGEND:
- ROW LINE
 - ROW ENCROACHMENT
 - PROPOSED SEWER
 - PROPOSED MANHOLE

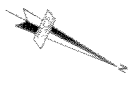

PRIVATE STORMWATER MANAGEMENT SYSTEM ENCROACHMENT

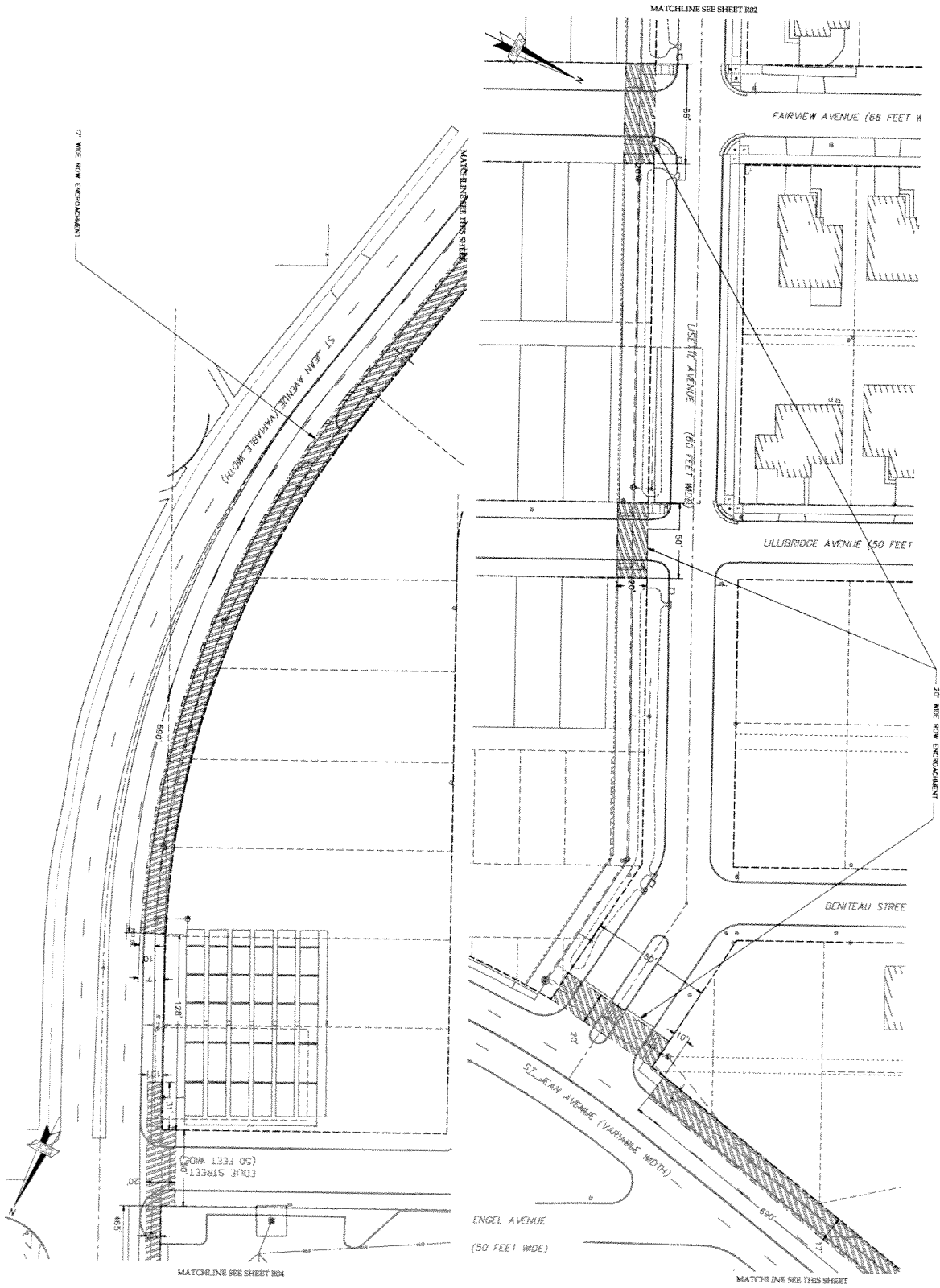

- LEGEND:
- ROW LINE
 - ROW ENCROACHMENT
 - PROPOSED SEWER
 - PROPOSED MANHOLE

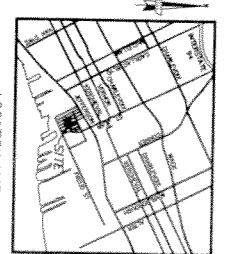

17' WIDE ROW ENCROACHMENT

20' WIDE ROW ENCROACHMENT

ENGEL AVENUE
(50 FEET WIDE)

MATCHLINE SEE SHEET R04

MATCHLINE SEE THIS SHEET

PRIVATE STORMWATER MANAGEMENT SYSTEM ENCROACHMENT

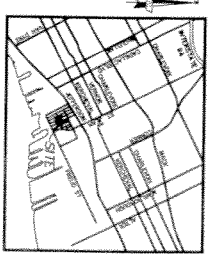
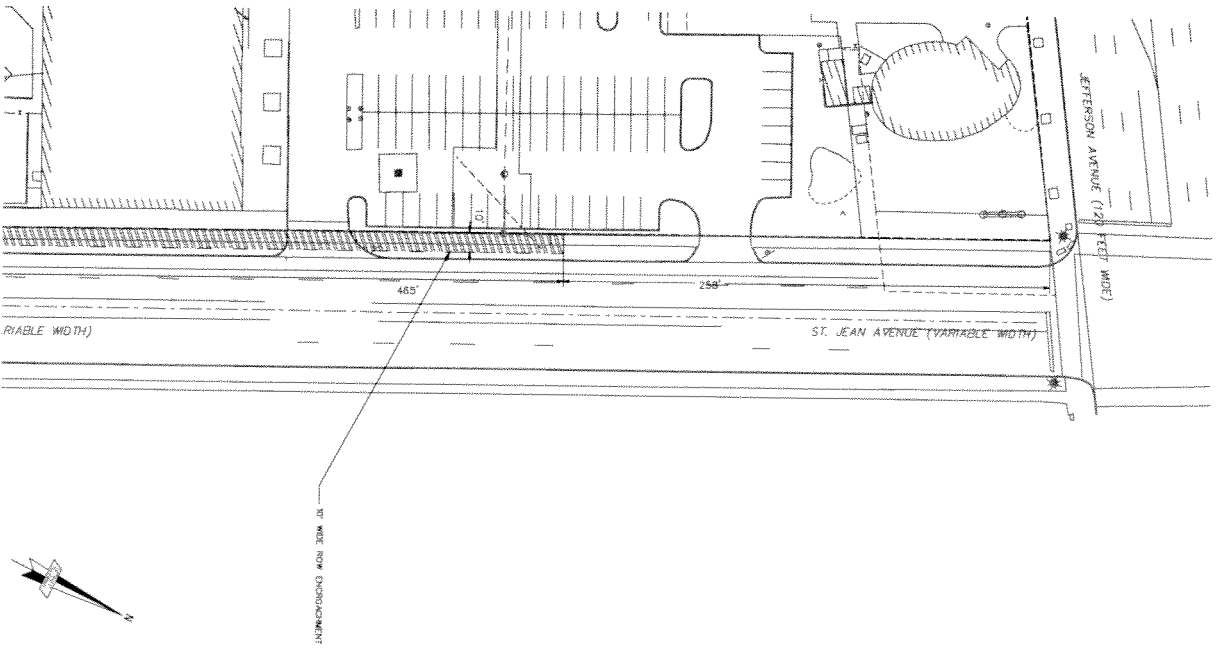
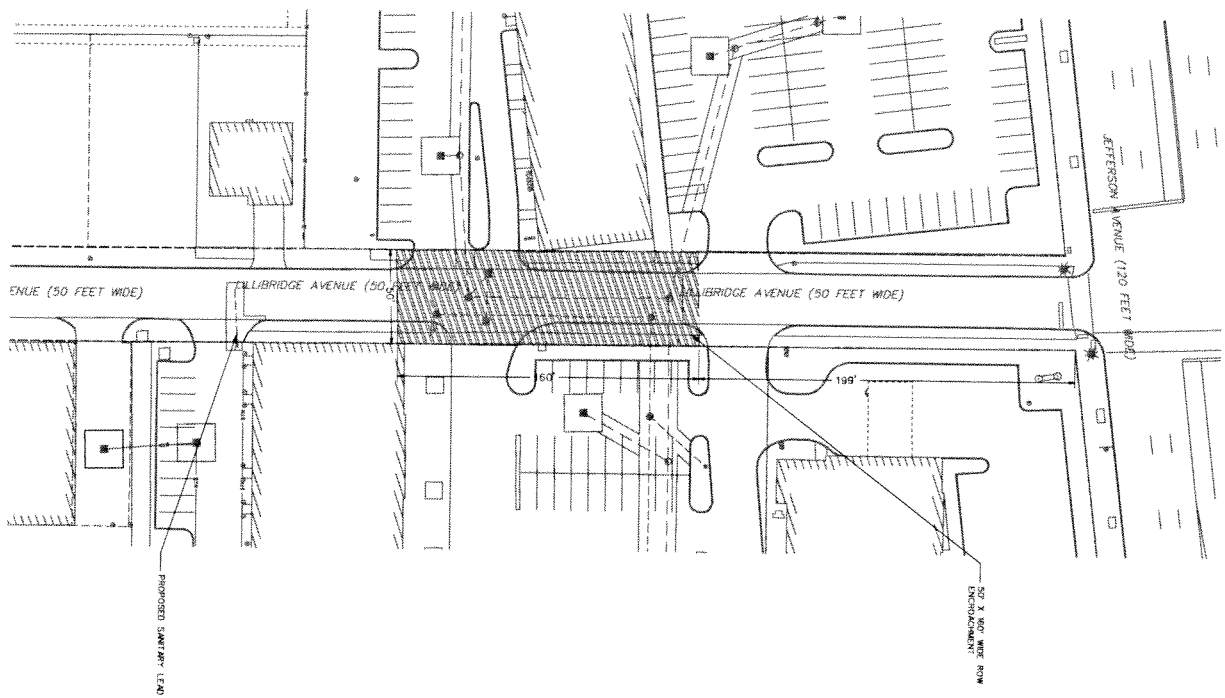

- LEGEND:
- ROW LINE
 - ROW ENCROACHMENT
 - PROPOSED SEWER
 - PROPOSED MANHOLE

NOTE:
 MINUTE SCALE ELEVATION MARKS BETWEEN 12' DEPTH
 AND 50' DEPTH FROM 13.5' TO 5' PER 50% BODINGS DATED
 11.1.2008

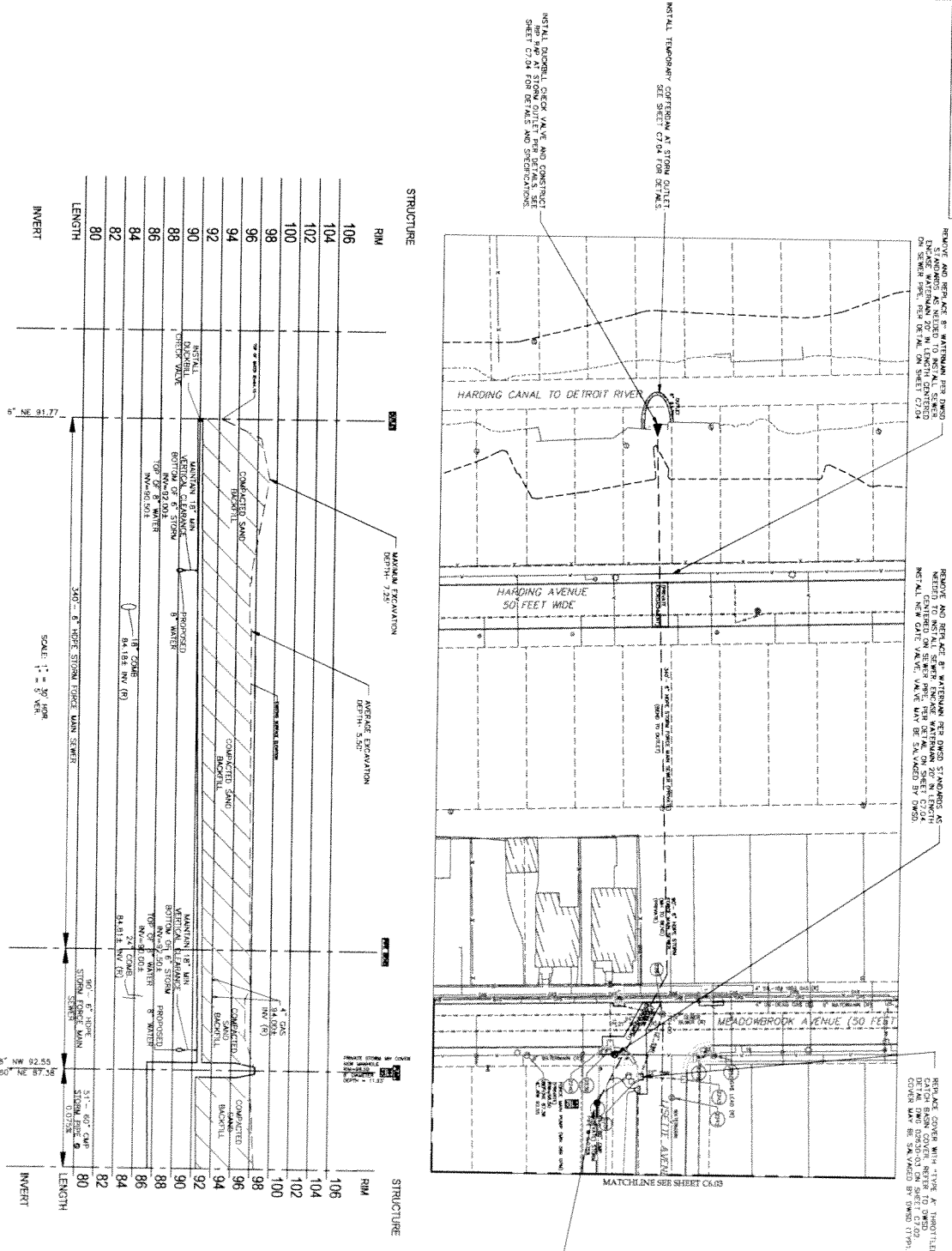

STRUCTURE	RIM	LENGTH	INVERT
106	106.0	1.00	80.0
104	104.0	1.00	84.0
102	102.0	1.00	88.0
100	100.0	1.00	86.0
98	98.0	1.00	84.0
96	96.0	1.00	82.0
94	94.0	1.00	80.0
92	92.0	1.00	78.0
90	90.0	1.00	76.0
88	88.0	1.00	74.0
86	86.0	1.00	72.0
84	84.0	1.00	70.0
82	82.0	1.00	68.0
80	80.0	1.00	66.0

5' NE 91.77

SCALE: 1" = 30' HOR
 1" = 5' VERT

DATE	DESCRIPTION	BY	CHKD BY
11/1/08	ISSUED FOR PERMITS
10/1/08	REVISED
8/1/08	REVISED
7/1/08	ISSUED

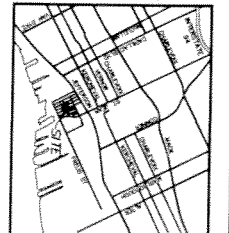

giffels 3030
webster 3030
 201 W. Adams Street
 Suite 200
 11701 W. Webster
 15118 Webster
 www.giffelswebster.com

ALTERNATIVE ENGINEERING DESIGN, SEPARATE
 CHANNEL FLOW REQUIREMENTS.

MANHOLE TOP TO BE DETERMINED BY
 CONTRACTOR TO BE RESPONSIBLE FOR
 CALCULATIONS.



NO.	DATE	DESCRIPTION
1	11/1/08	ISSUED FOR PERMITS
2	10/1/08	REVISED
3	8/1/08	REVISED
4	7/1/08	ISSUED

UTILITY PLAN #
PROFILES

Jefferson Village Sewerage
 Separation Project
 Day of Donal
 Utility Center

Neighborhood Development
 Corporation
 520 General Sarge
 Detroit, MI 48226

SCALE: 1" = 20' (VERTICAL)
 1" = 100' (HORIZONTAL)
 DATE: 11/19/2024

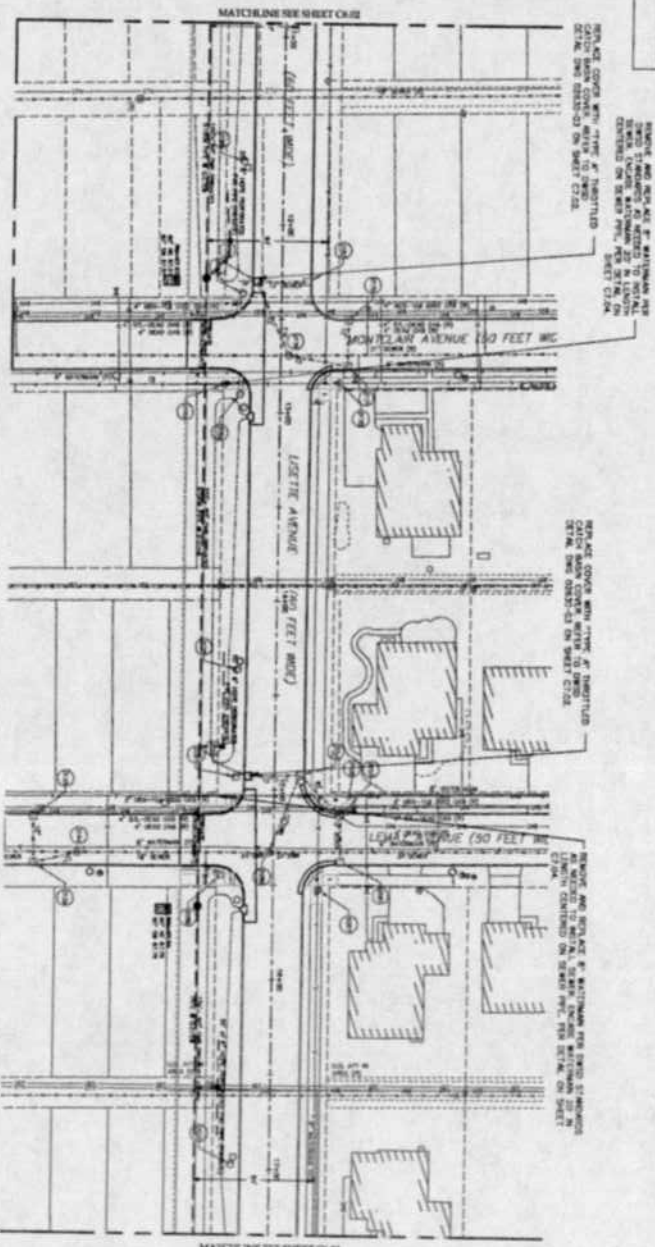

NO.	DESCRIPTION	LENGTH
106	CONCRETE MANHOLE	10.0
104	CONCRETE MANHOLE	10.0
102	CONCRETE MANHOLE	10.0
100	CONCRETE MANHOLE	10.0
98	CONCRETE MANHOLE	10.0
96	CONCRETE MANHOLE	10.0
94	CONCRETE MANHOLE	10.0
92	CONCRETE MANHOLE	10.0
90	CONCRETE MANHOLE	10.0
88	CONCRETE MANHOLE	10.0
86	CONCRETE MANHOLE	10.0
84	CONCRETE MANHOLE	10.0
82	CONCRETE MANHOLE	10.0
80	CONCRETE MANHOLE	10.0

OWNED SYSTEM ACCEPTANCE

DATE	11/19/2024
BY	[Signature]
TITLE	UTILITY PLAN & PROFILES

UTILITY PLAN & PROFILES

City of [Name]
 [Address]
 [Phone]



LOCAL MAP
 (SEE SHEET C-101)

giffels webster

Professional Engineer
 License No. [Number]
 State of [State]

NO.	DATE	DESCRIPTION
1	11/19/2024	ISSUED FOR PERMIT

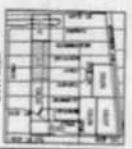

City of [Name]
 [Address]
 [Phone]

SHEET 3A-6
 EASTON JAMES BETWEEN 17TH STREET
 AND CENTER LANE
 11-12-2022

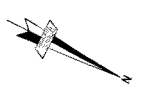

SCALE: 1" = 30'

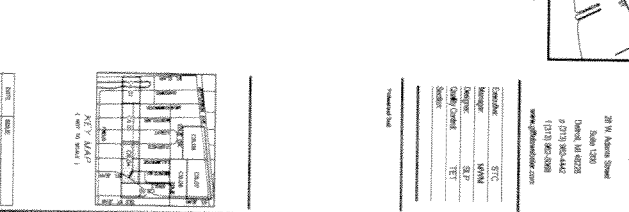
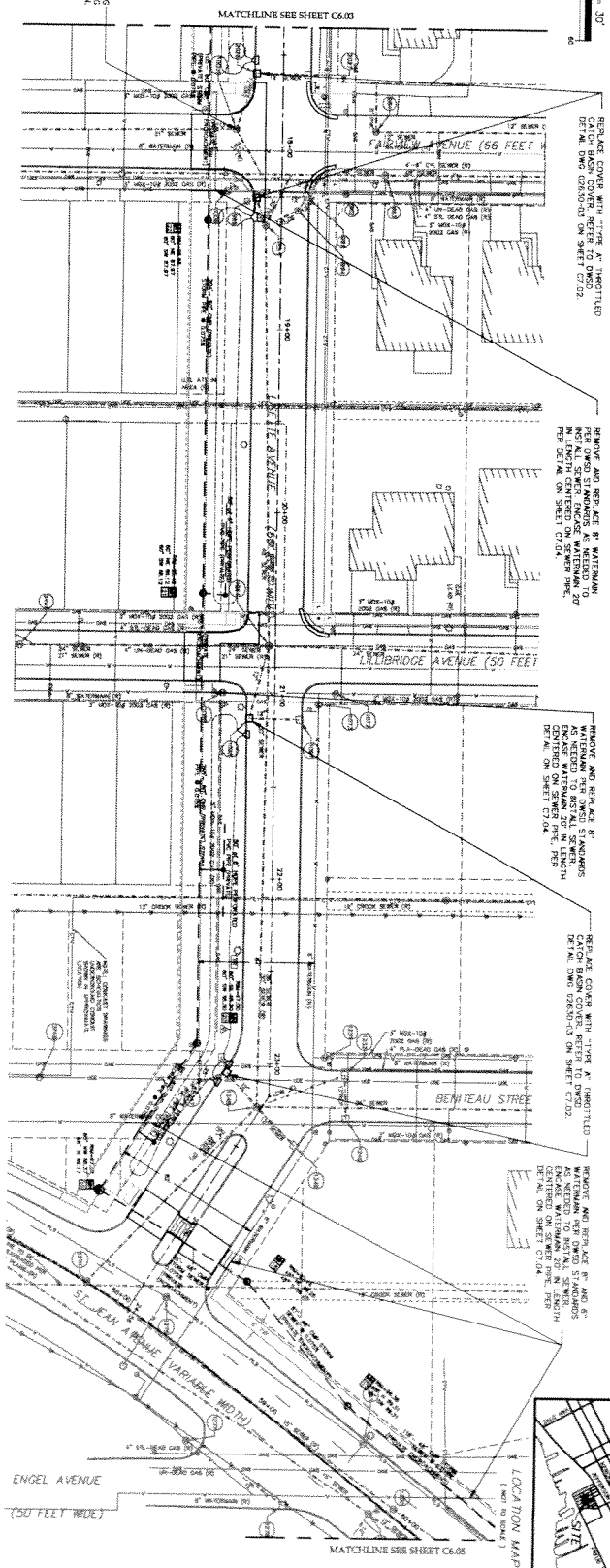

STRUCTURE	RIM	INVERT	LENGTH
106	88.12	87.82	80
104	88.12	87.82	80
102	88.12	87.82	80
100	88.12	87.82	80
98	88.12	87.82	80
96	88.12	87.82	80
94	88.12	87.82	80
92	88.12	87.82	80
90	88.12	87.82	80
88	88.12	87.82	80
86	88.12	87.82	80
84	88.12	87.82	80
82	88.12	87.82	80

giffels
webster

Engineering
 Planning
 Construction Services

201 W. Adams Street
 Suite 1000
 Detroit, MI 48226
 P 313.963.6442
 F 313.963.3800
 www.giffelswebster.com

ALTERNATIVE DESIGNING DESIGN SERVICE
 PLUMBING PERMIT REQUIRED

UTILITY PLAN & PROFILES

Jefferson Village Sewerworks
 Sycamore Street #1

City of Detroit
 Water
 WETWORK

McGraw-Hill Construction
 Corporation

500 Corporate Center
 Detroit, MI 48226

DATE: 02.21.23
 SCALE: 1" = 30'
 SHEET: 3A-6
 PROJECT: 1567/FID

NOTE: PANEL STATION MARKS BETWEEN 1.2 ZERO AND GREATER THAN 19.8, PER S&L DRAWING DATED 11-10-2002.

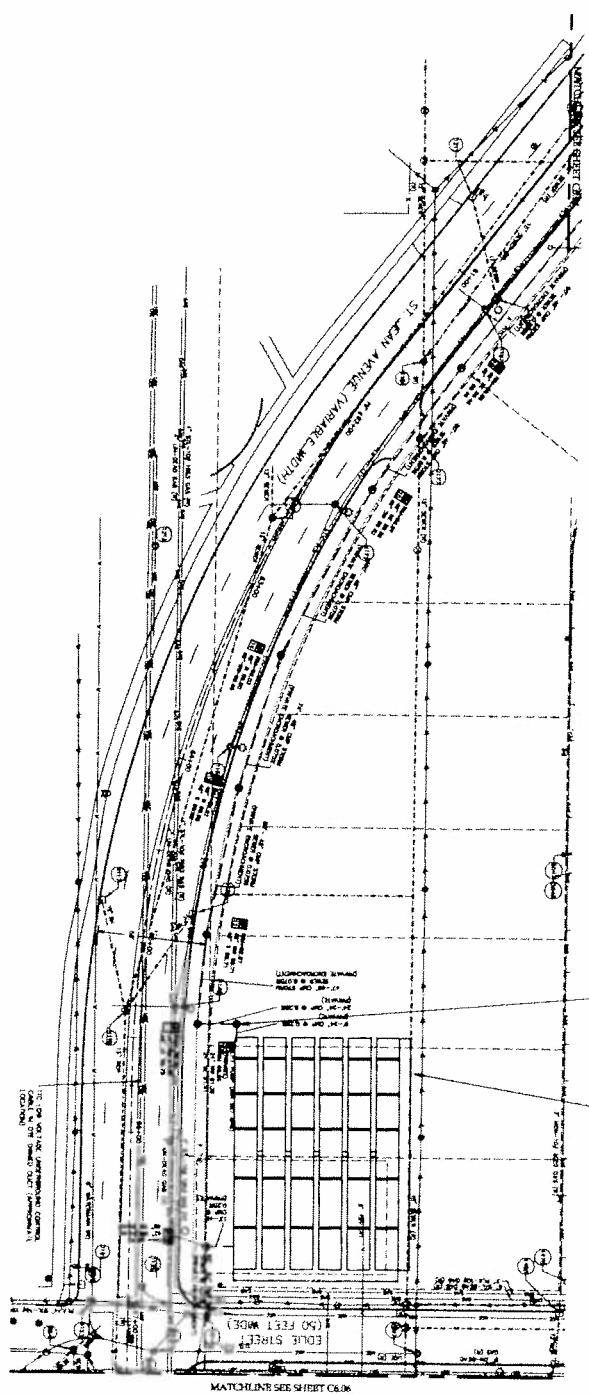

PROJECT INFORMATION	
PROJECT NO.	10-0000000000
DATE	10/15/03
SCALE	AS SHOWN
DESIGNED BY	SEE SHEET CIVIL 129
CHECKED BY	SEE SHEET CIVIL 129
APPROVED BY	SEE SHEET CIVIL 129

THIS STATION TO BE RESPONSIBLE BY CONTRACTOR SEE THE S&L DRAWING

SEE SHEET CIVIL 129 FOR PROPOSED STORMWATER STORAGE DESIGN

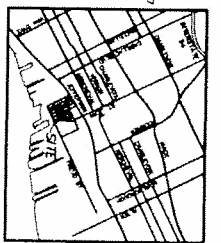

ALTERNATIVE ENGINEERING DESIGN, STORMWATER STORAGE

STRUCTURE	RIM	INVERT	LENGTH
90" DIA. CAP STORM SEWER @ 0.075%	80	80	1.4
90" DIA. CAP STORM SEWER @ 0.075%	82	82	1.4
90" DIA. CAP STORM SEWER @ 0.075%	84	84	1.4
90" DIA. CAP STORM SEWER @ 0.075%	86	86	1.4
90" DIA. CAP STORM SEWER @ 0.075%	88	88	1.4
90" DIA. CAP STORM SEWER @ 0.075%	90	90	1.4
90" DIA. CAP STORM SEWER @ 0.075%	92	92	1.4
90" DIA. CAP STORM SEWER @ 0.075%	94	94	1.4
90" DIA. CAP STORM SEWER @ 0.075%	96	96	1.4
90" DIA. CAP STORM SEWER @ 0.075%	98	98	1.4
90" DIA. CAP STORM SEWER @ 0.075%	100	100	1.4
90" DIA. CAP STORM SEWER @ 0.075%	102	102	1.4
90" DIA. CAP STORM SEWER @ 0.075%	104	104	1.4
90" DIA. CAP STORM SEWER @ 0.075%	106	106	1.4

STRUCTURE	RIM	INVERT	LENGTH
90" DIA. CAP STORM SEWER @ 0.075%	80	80	1.4
90" DIA. CAP STORM SEWER @ 0.075%	82	82	1.4
90" DIA. CAP STORM SEWER @ 0.075%	84	84	1.4
90" DIA. CAP STORM SEWER @ 0.075%	86	86	1.4
90" DIA. CAP STORM SEWER @ 0.075%	88	88	1.4
90" DIA. CAP STORM SEWER @ 0.075%	90	90	1.4
90" DIA. CAP STORM SEWER @ 0.075%	92	92	1.4
90" DIA. CAP STORM SEWER @ 0.075%	94	94	1.4
90" DIA. CAP STORM SEWER @ 0.075%	96	96	1.4
90" DIA. CAP STORM SEWER @ 0.075%	98	98	1.4
90" DIA. CAP STORM SEWER @ 0.075%	100	100	1.4
90" DIA. CAP STORM SEWER @ 0.075%	102	102	1.4
90" DIA. CAP STORM SEWER @ 0.075%	104	104	1.4
90" DIA. CAP STORM SEWER @ 0.075%	106	106	1.4

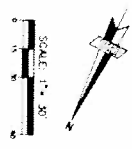

UTILITY PLAN & PROFILES
 Prepared by: [Name]
 Checked by: [Name]
 Date: [Date]

Hydrological Development Corporation
 500 Central Blvd. 2000
 Grand Prairie, TX 75050

NO.	DATE	DESCRIPTION
1	10/15/03	ISSUED FOR PERMITS
2	10/15/03	ISSUED FOR PERMITS
3	10/15/03	ISSUED FOR PERMITS

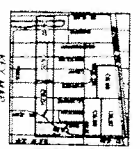

giffels webbster

10101 GOLF COURSE
 SUITE 100
 DALLAS, TX 75241
 (214) 343-1234

NOTE:
 WATER TABLE ELEVATION VARIES BETWEEN 12' DEPTH
 AND GREATER THAN 13.5' FROM SOIL BORINGS DATED
 11-12-2008.

RETROFIT EXISTING SANITARY LATERAL
 AND CONNECT TO EXISTING 15"
 COMBINED SEWER SEE BELOW FOR
 PROFILE VIEW.

MATCHLINE SEE SHEET C04

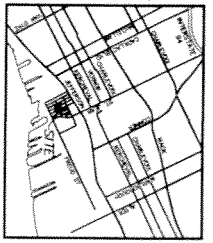
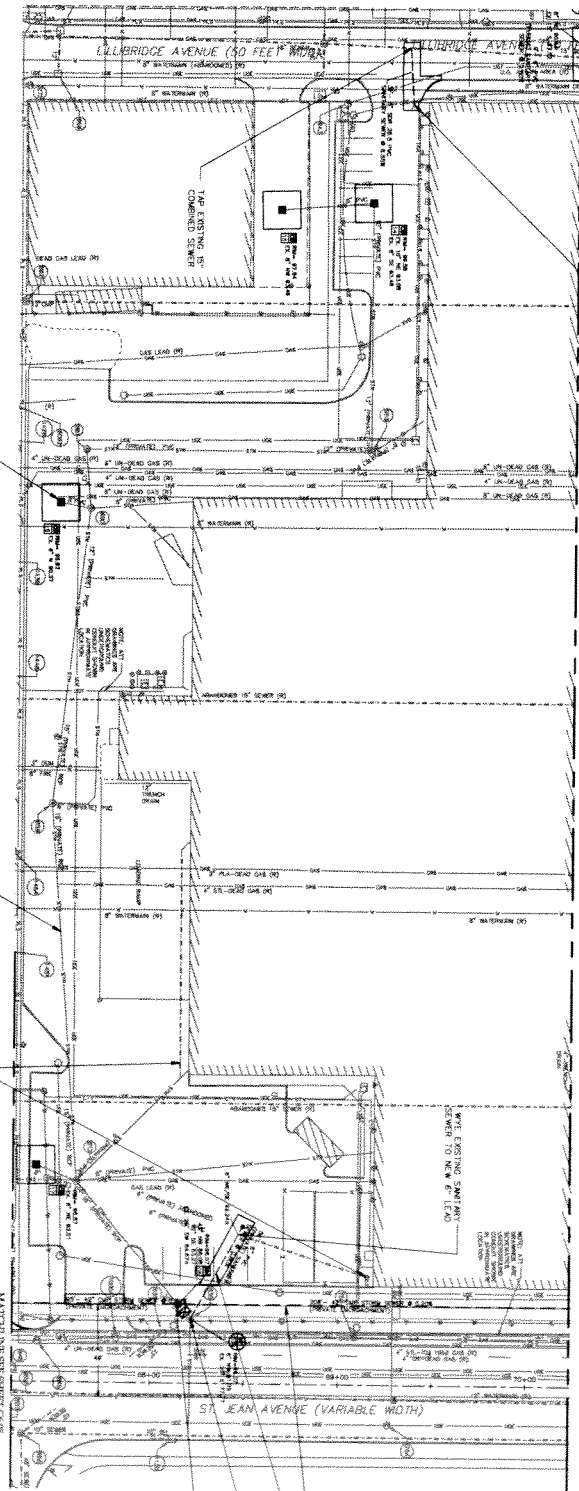

PROTECT EXISTING 14" R.I. 40' TO
 87+25' SEWER TO SOUTHWEST. 14"
 COMBINED SEWER TO EXISTING 15"
 COMBINED SEWER TO EXISTING 15"
 OVER EXISTING 8" SEWER.

SEE SHEET C04 FOR PROFILE VIEW
 SEE SHEET C04 FOR PROFILE VIEW

ALTERNATIVE ENGINEERING DESIGN, SQUARE
 FLOODING DEMO REQUIRED

RETROFIT EXISTING CATCH BASIN (179)
 SEE PROFILE ON SHEET C704.

SEE PROFILE BELOW
 CONTRACTOR TO DIG TEST
 AND TELEVIEW ALL BUILDING
 LEADS TO CONFIRM CITY MAIN

STRUCTURE

STRUCTURE	RIM	INVERT	LENGTH
102	93.48	87.50	12'
100	93.48	87.50	12'
98	93.48	87.50	12'
96	93.48	87.50	12'
94	93.48	87.50	12'
92	93.48	87.50	12'
90	93.48	87.50	12'
88	93.48	87.50	12'
84	93.48	87.50	12'
82	93.48	87.50	12'
80	93.48	87.50	12'
78	93.48	87.50	12'
76	93.48	87.50	12'

STRUCTURE

STRUCTURE	RIM	INVERT	LENGTH
102	90.61	84.63	12'
100	90.61	84.63	12'
98	90.61	84.63	12'
96	90.61	84.63	12'
94	90.61	84.63	12'
92	90.61	84.63	12'
90	90.61	84.63	12'
88	90.61	84.63	12'
84	90.61	84.63	12'
82	90.61	84.63	12'
80	90.61	84.63	12'
78	90.61	84.63	12'
76	90.61	84.63	12'

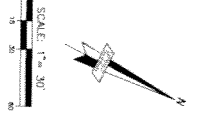

Jefferson Village Sewerwater
 Separation Phase I
 City of Aurora
 Water Center
 MICHELAN

DATE: 08.23.10
 DRAWN: J. J. J.
 CHECK: C. J. J.
 PROJECT: J. J. J.

UTILITY PLAN &
 PROFILES

Highland Development
 Corporation
 520 Central Street 2ND
 Des Moines, IA 50319

NO.	DATE	DESCRIPTION
1	08/23/10	ISSUED FOR PERMITTING
2	08/23/10	ISSUED FOR PERMITTING
3	08/23/10	ISSUED FOR PERMITTING
4	08/23/10	ISSUED FOR PERMITTING
5	08/23/10	ISSUED FOR PERMITTING

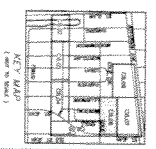

giffels
 webster

Systems
 Design
 Engineering
 201 W. Adams Street
 Suite 1001
 Des Moines, IA 50319
 P: 515.281.4422
 F: 515.281.5888
 www.giffelswebster.com

NOTE: PANEL EXPLANATION WARMS BETWEEN 1/2" DEPTH AND GREATER THAN 1/2" x 1/2" FOR CONNECTIONS UNITED 11-1-2-2002

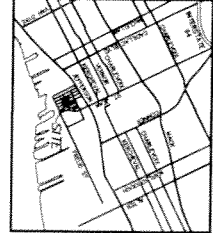
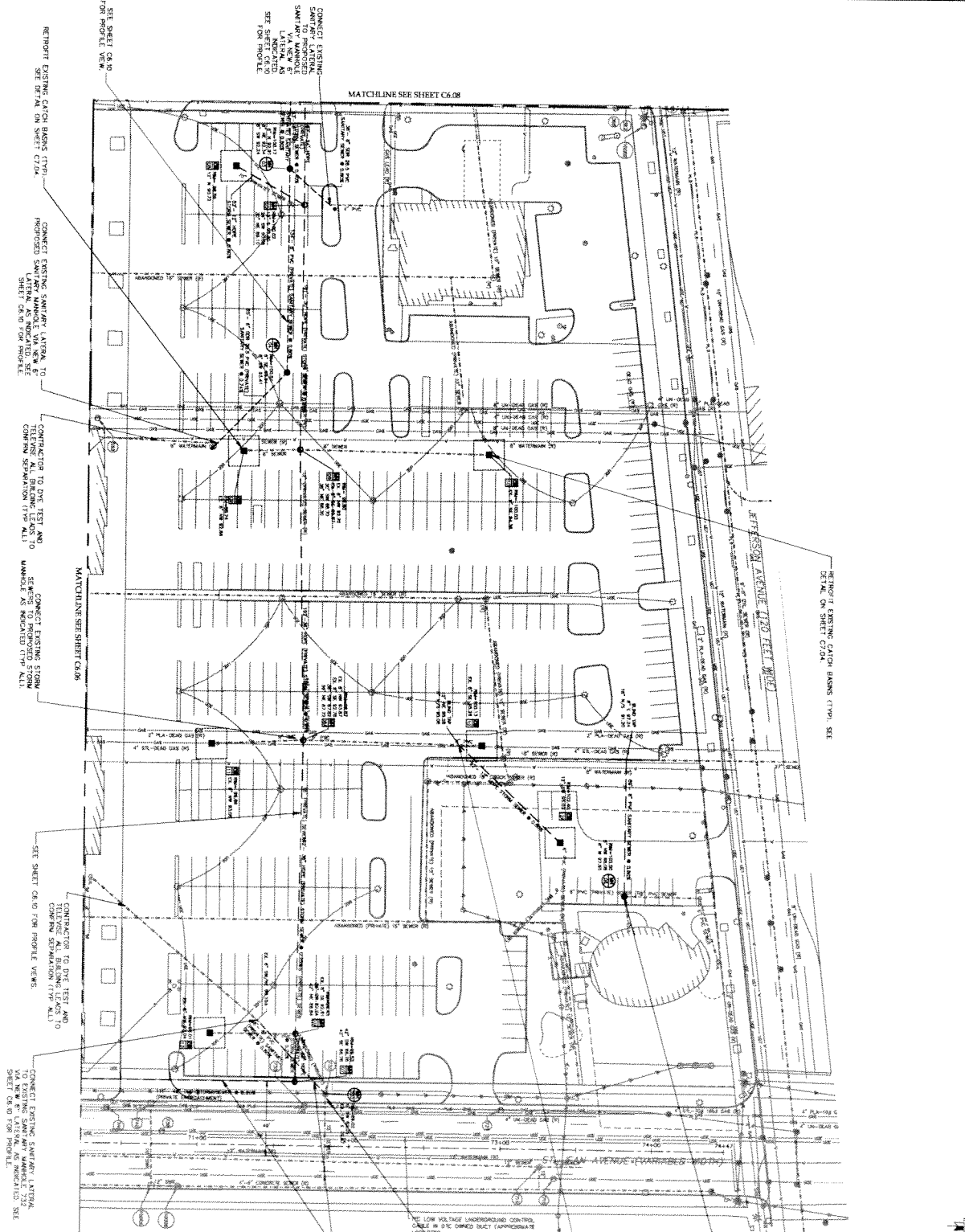

LOCATION MAP
(1" = 100') (NOT TO SCALE)

giffels webster

Engineering
Surveying
Planning
Construction Administration

281 W. Adams Street
St. Paul, MN 55102
Phone: 612.333.4442
Fax: 612.333.5088
www.giffelswebster.com

Project No: 2008-10-10000000-0001

Contractor	STC
Designer	JKM
Checker	SJP
Date/Drawn	03/07
Scale	1"=30'

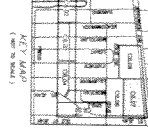

DATE: 03/07/10

DRAWN BY: JKM

CHECKED BY: SJP

DATE: 03/07/10

SCALE: 1"=30'

Jefferson Village Separation Corporation

520 Central Sault Ste. Marie Ave.
Sault Ste. Marie, MI 49783

Project: Jefferson Village Separation

Sheet: 03/10

UTILITY PLAN & PROFILES

Jefferson Village Separation Corporation
Separation Phase I

City of Sault Ste. Marie
Water Control
Michigan

DATE: 03/07/10

SCALE: 1"=30'

SHEET: 03/10

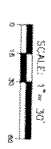

DATE: 11-12-2002
 DRAWN BY: J. B. BROWN
 CHECKED BY: J. B. BROWN
 PROJECT NO.: 02-001

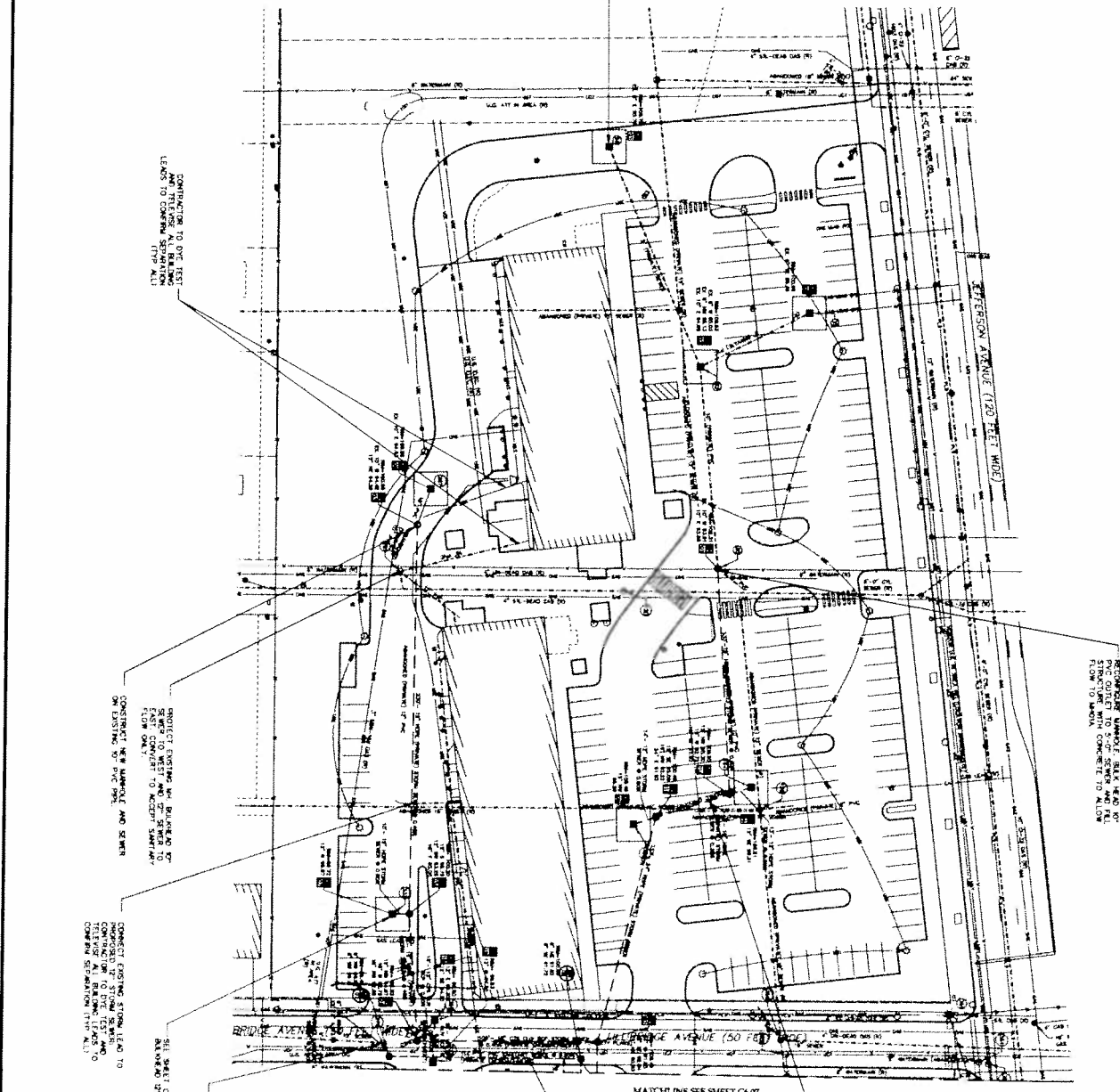

RECONSTRUCT WHOLEHOLE SINK AND 60" DIAMETER MANHOLE WITH CONCRETE AND FILL FLOW TO MANHOLE

CONNECTION TO OVER THE TOP CONNECTION LEADS TO CONCRETE SEPARATION (TYP. ALL)

PROJECT EXISTING AND PROPOSED SEWER TO WEST AND 30" SEWER TO EAST CONNECT TO EXISTING SANITARY

CONNECT EXISTING STORM LEAD TO CONCRETE SEPARATION TO OVER THE TOP AND CONCRETE SEPARATION LEAD TO CONCRETE SEPARATION (TYP. ALL)

EXISTING MANHOLE WITH PROPOSED 30" SANITARY SEWER

MATCHLINE SEE SHEET C6.07

SEE SHEET C6.08 FOR PROFILE VIEWS

SEE SHEET C6.09 FOR PROFILE VIEWS

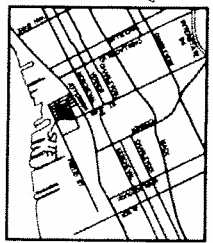

UTILITY PLAN & PROFILES

Hydrological Development Corporation
 590 Central Ave. 200
 Lowell, MA 01826

City of Lowell
 Water Control
 WASHINGTON

Industrial Village Sewerage
 Separation Project

giffels webster

Professional Engineers
 20 W. Adams Street
 Lowell, MA 01826
 1/271 881-4242
 1018192000

DATE: 11-12-2002
 DRAWN BY: J. B. BROWN
 CHECKED BY: J. B. BROWN
 PROJECT NO.: 02-001

SEE SHEET C6.08
FOR PLAN VIEW

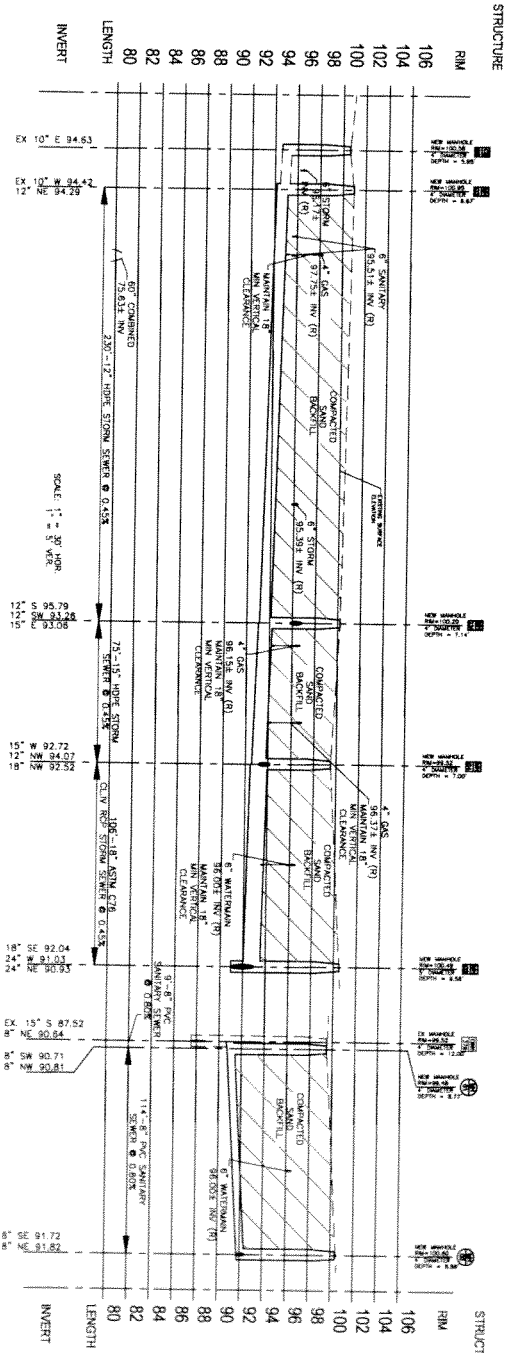

SEE SHEET C6.08
FOR PLAN VIEW

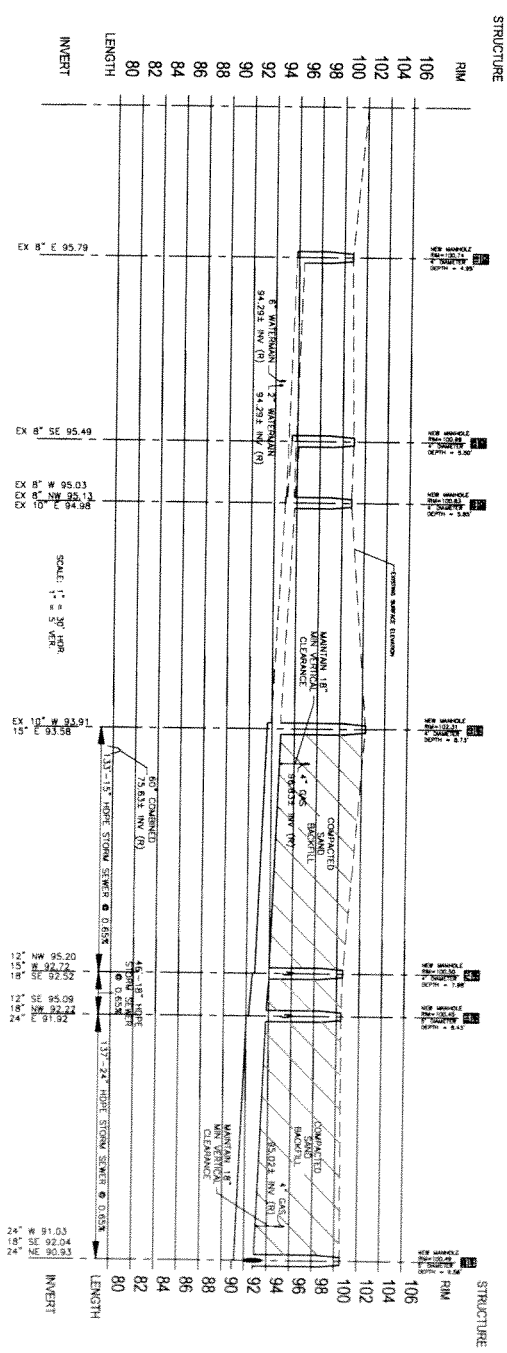

ALTERNATIVE ENGINEERING DESIGN SERVICES
FLUORINE POWER RECONSTRUCTION

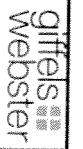

Engineers
Surveyors
Professional Architects
Environmental Scientists
201 N. Adams Street
Chicago, Illinois 60606
312.329.4444
312.329.4444
www.giffelswebster.com

DATE	08.23.19
DRAWN BY	W.A.B.
CHECKED BY	W.A.B.
PROJECT	REDEVELOPMENT

NO.	DATE	DESCRIPTION
1	08.23.19	ISSUED FOR PERMIT
2	08.23.19	ISSUED FOR PERMIT
3	08.23.19	ISSUED FOR PERMIT
4	08.23.19	ISSUED FOR PERMIT
5	08.23.19	ISSUED FOR PERMIT
6	08.23.19	ISSUED FOR PERMIT
7	08.23.19	ISSUED FOR PERMIT
8	08.23.19	ISSUED FOR PERMIT
9	08.23.19	ISSUED FOR PERMIT
10	08.23.19	ISSUED FOR PERMIT

Utility Plan & Profiles
Neighborhood Development Corporation
430 Grand Street 200E
Chicago, IL 60632

Jedrejka Wilson Sacramento
Sustainable Planning
Utility Plan
Water Utility
Chicago, IL
08.23.19

SEE SHEET C6.08
FOR PLAN VIEW

SEE SHEET C6.07
FOR PLAN VIEW

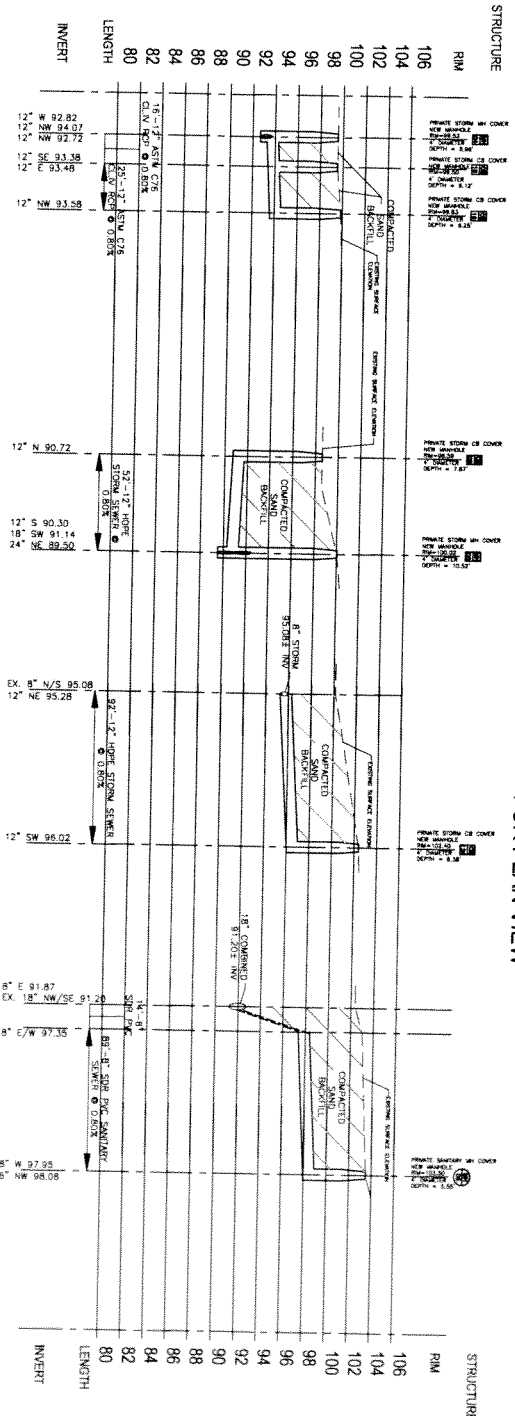

STRUCTURE

RIM	LENGTH	INVERT
106	80	82.82
104	80	82.82
102	80	82.82
100	80	82.82
98	80	82.82
96	80	82.82
94	80	82.82
92	80	82.82
90	80	82.82
88	80	82.82
86	80	82.82
84	80	82.82
82	80	82.82
80	80	82.82

SEE SHEET C6.06
FOR PLAN VIEW

SEE SHEET C6.07
FOR PLAN VIEW

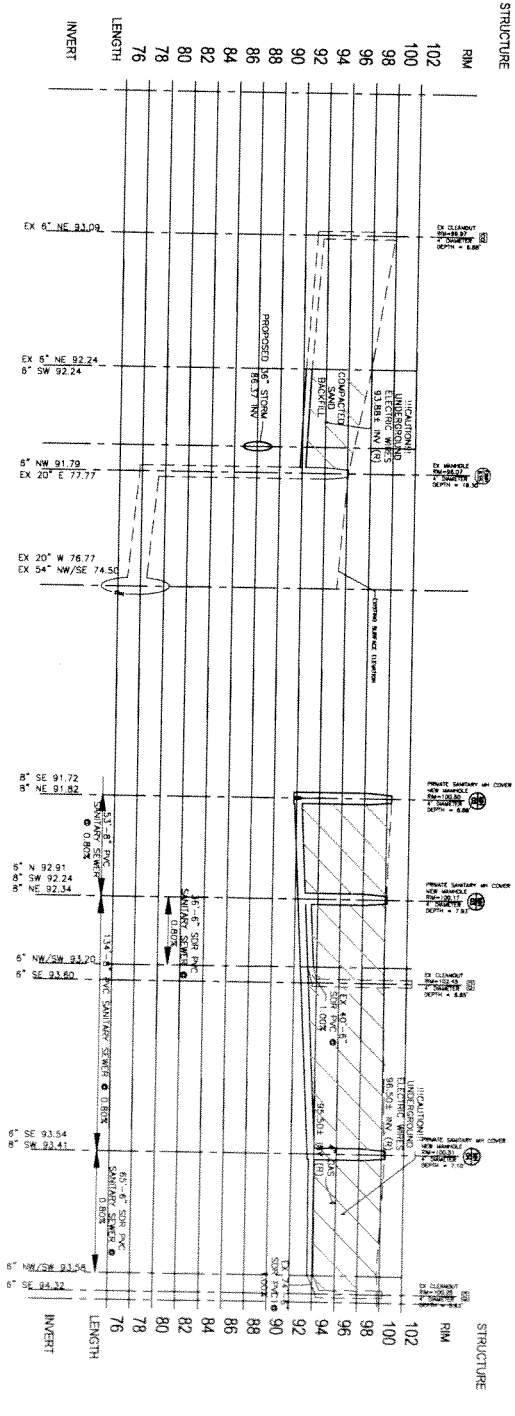

STRUCTURE

RIM	LENGTH	INVERT
106	80	82.82
104	80	82.82
102	80	82.82
100	80	82.82
98	80	82.82
96	80	82.82
94	80	82.82
92	80	82.82
90	80	82.82
88	80	82.82
86	80	82.82
84	80	82.82
82	80	82.82
80	80	82.82
78	80	82.82
76	80	82.82

SCALE: 1" = 30'

ALTERNATE PROPOSING DESIGN, SEPARATE PLUMBING PERMIT REQUIRED

giffels webster

Engineers
28 1/4 Adams Street
Dover, NH 03828
603.338.4422
1370 1/2 Main Street
Dover, NH 03828

Utility Plan & Profiles

Reference Village Documents
Separation Order 1
City of Dover
Water Utility
Merrillan

Neighborhood Development
Commission
500 Central State Road
Dover, NH 03828

DATE: 02.23.18
SCALE: 1" = 30'
DRAWN: CJA/11
CHECKED: MJA/11
PROJECT NO: 2017-010