



8109 East Jefferson Avenue, #1B  
Detroit, MI 48214  
Phone: 313-486-2900  
Fax: 313-331-1500  
E-Mail: [mac@thevillagesofdetroit.com](mailto:mac@thevillagesofdetroit.com)  
Web: [www.thevillagesofdetroit.com](http://www.thevillagesofdetroit.com)

October 30, 2017

The Honorable City Council  
Attn: Office of the City Clerk  
200 CAYMC  
Detroit MI 48226

**Re: Petition of encroachment**

To Whom It May Concern:

I am writing in order to apply for a petition to encroach on the right of way for the purposes of installing bicycle racks in the locations indicated in the attached site plans (refer to Exhibit A for site plans). The Department of Public Works has approved the site plans (refer to Exhibit B for site plan approval). It is our intention to proceed with installation with an 'at risk permit.'

Should you have any other questions, feel free to reach out to me at your convenience.

Sincerely,

Mac Farr  
Executive Director  
Villages CDC

cc: Janice Rutledge, Department of Public Works

CITY CLERK: 31 OCT 2017 AM 10:51

# VILLAGES BIKE RACK INSTALLATION

VARIOUS LOCATIONS, DETROIT, MI 48214

PROJECT No. 1702

**CLIENT:**

THE VILLAGES CDC  
200 RIVERPLACE  
SUITE 2800  
DETROIT, MICHIGAN 48207

**ARCHITECT:**

ALLAN MACHIELSE, AIA  
7963 SAINT PAUL AVENUE  
DETROIT, MICHIGAN 48214  
(810) 252-4197

**DRAWING LIST**

- A1 COVER SHEET & AREA PLAN
- A2 BELLE ISLE PIZZA
- A3 DETROIT SAVINGS BANK
- A4 GARLAND BUILDING
- A5 LA BOHEME
- A6 HEAVY WEIGHT CUTS
- A7 TYP. BIKE RACK & GEN. NOTES



Allan Machielse, AIA Architect  
7963 Saint Paul Avenue  
Detroit, MI 48214  
(p) 810.252.4197  
(w) www.allanmachielse.com  
(e) allan@allanmachielse.com

**COVER SHEET & SITE PLAN**

SCALE: NTS  
DRAWN: AMM CHECKED: AMM  
DATE: 7-12-17

**A1**

SHEET 1 OF 7



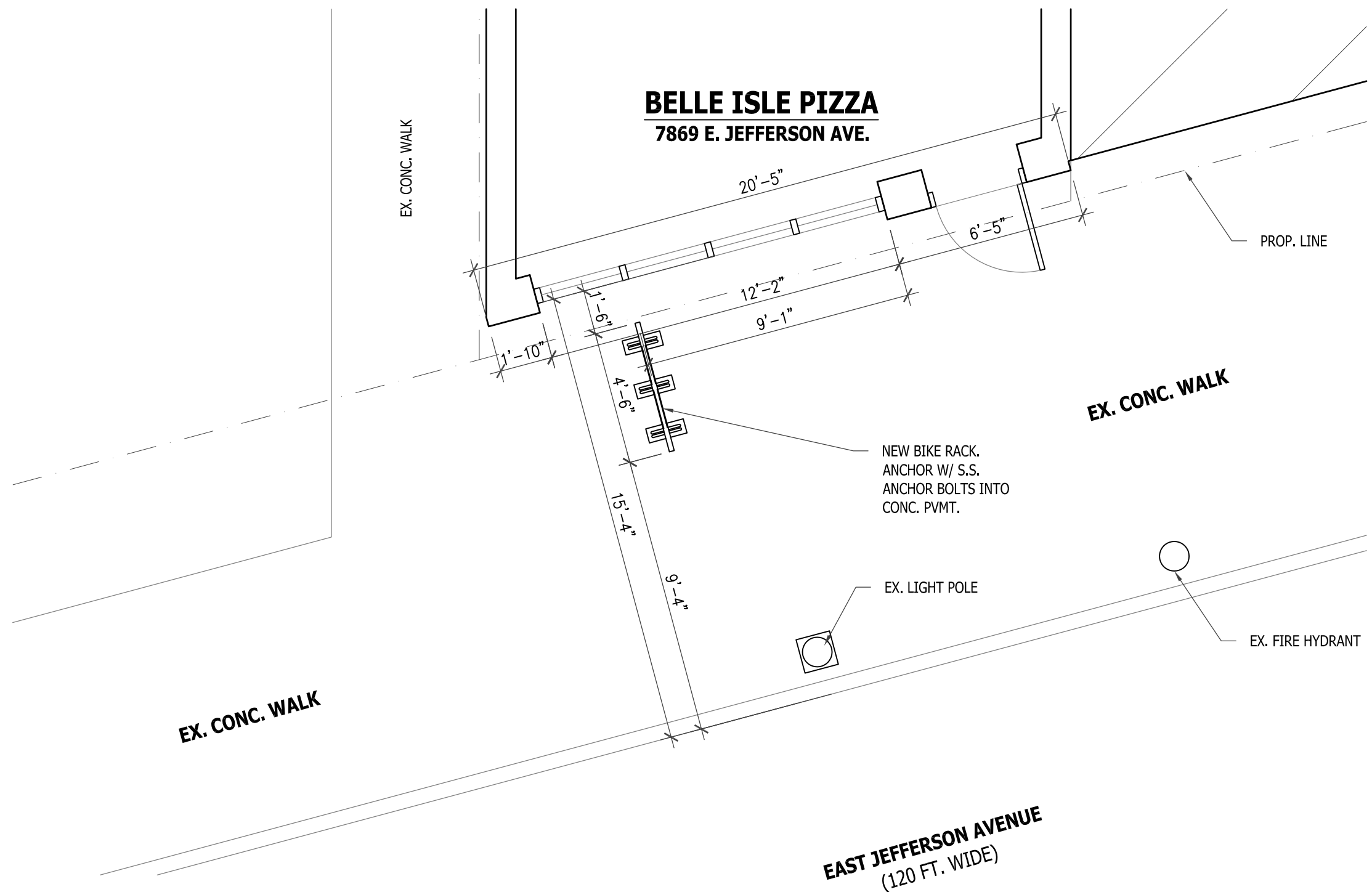

Allan Machielse, AIA Architect  
7963 Saint Paul Avenue  
Detroit, MI 48214  
(p) 810.252.4197  
(w) www.allanmachielse.com  
(e) allan@allanmachielse.com

**BELLE ISLE  
PIZZA**

SCALE: 1/4" = 1'-0"  
DRAWN: AMM CHECKED: AMM  
DATE: 10-16-17

**A2**

SHEET 2 OF 7

1 ENLARGED SITE PLAN @ BELLE ISLE PIZZA  
A1/A2 SCALE: 1/4"=1'-0"

**KERCHEVAL AVENUE**  
(80 FT. WIDE)

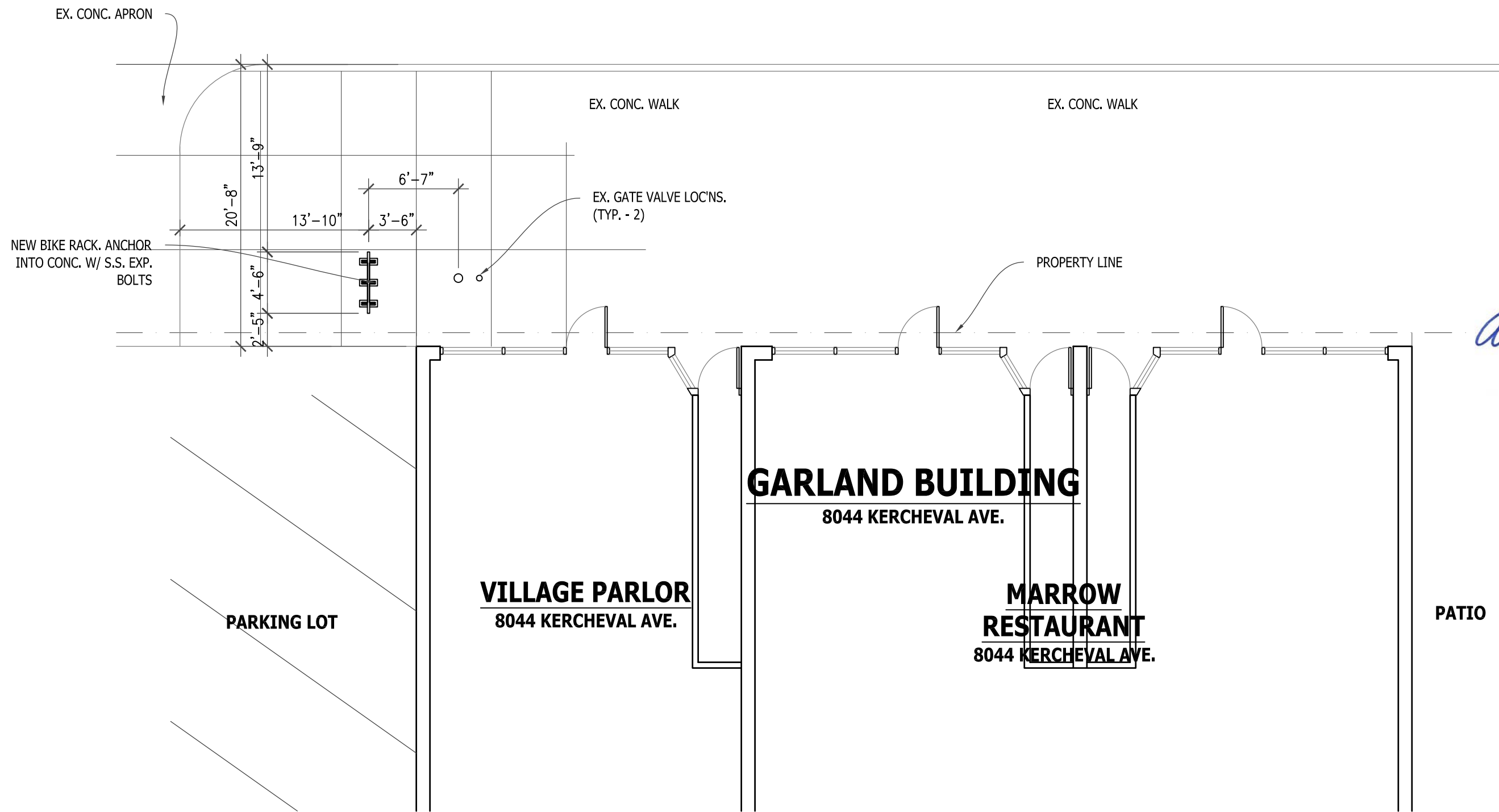

Allan Machielse, AIA Architect  
7963 Saint Paul Avenue  
Detroit, MI 48214  
(p) 810.252.4197  
(w) www.allanmachielse.com  
(e) allan@allanmachielse.com

**GARLAND BUILDING**

SCALE: 1/8" = 1'-0"  
DRAWN: AMM CHECKED: AMM  
DATE: 11-19-17

3 SITE PLAN @ GARLAND BUILDING  
A1/A4 SCALE: 1"=10'-0"

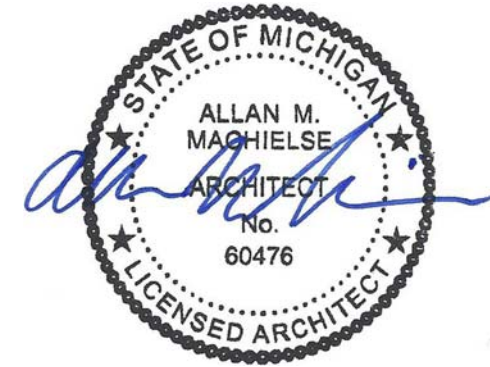
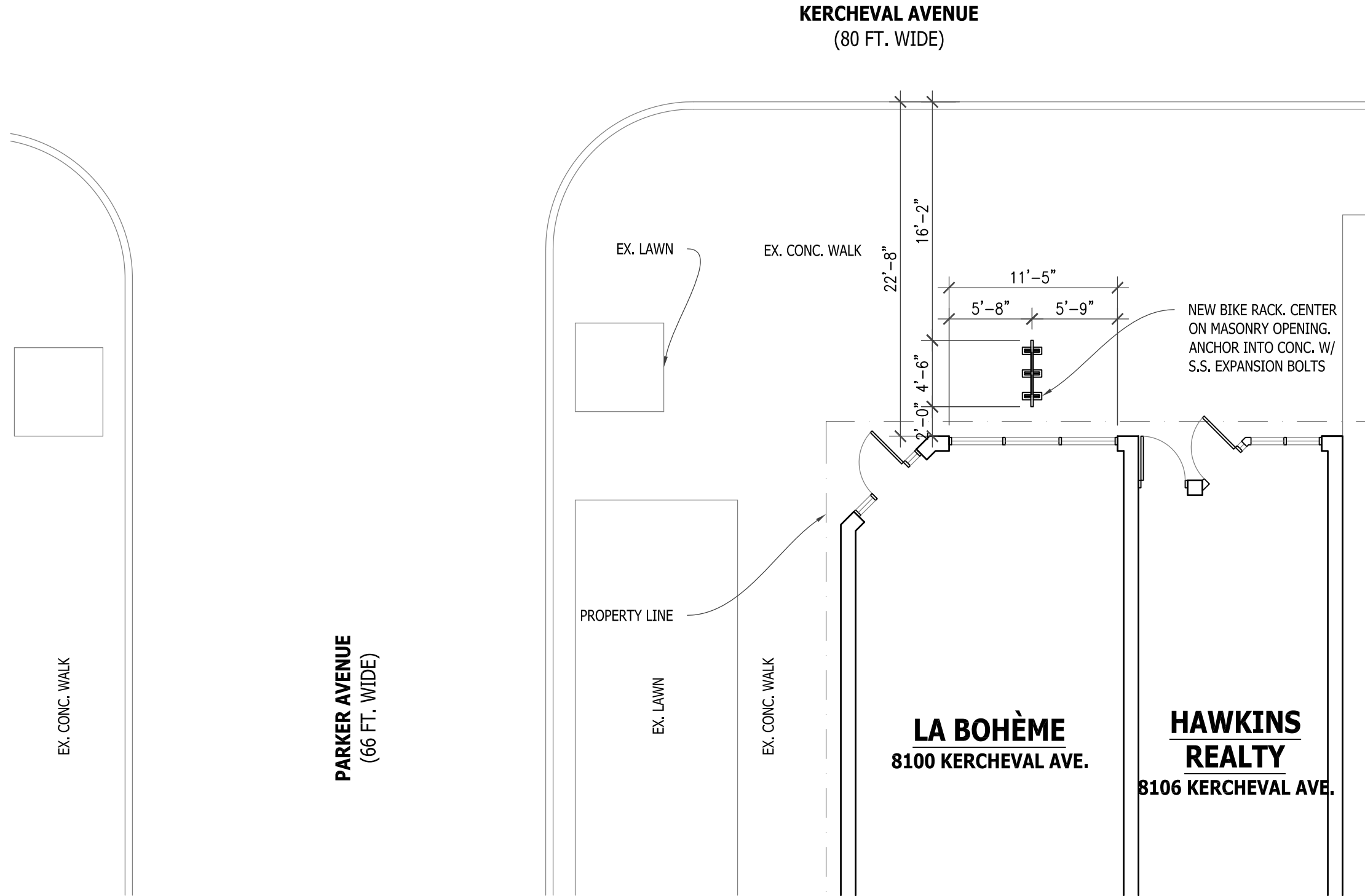

Allan Machielse, AIA Architect  
 7963 Saint Paul Avenue  
 Detroit, MI 48214  
 (p) 810.252.4197  
 (w) www.allanmachielse.com  
 (e) allan@allanmachielse.com

**LA BOHÈME**

SCALE: 1/8" = 1'-0"  
 DRAWN: AMM CHECKED: AMM  
 DATE: 7-1-17

**A5**

SHEET 5 OF 7

**KERCHEVAL AVENUE**  
 (80 FT. WIDE)

**PARKER AVENUE**  
 (66 FT. WIDE)

EX. LAWN

EX. CONC. WALK

PROPERTY LINE

EX. LAWN

EX. CONC. WALK

NEW BIKE RACK. CENTER  
 ON MASONRY OPENING.  
 ANCHOR INTO CONC. W/  
 S.S. EXPANSION BOLTS

**LA BOHÈME**  
 8100 KERCHEVAL AVE.

**HAWKINS  
 REALTY**  
 8106 KERCHEVAL AVE.

4 SITE PLAN @ LA BOHEM  
 A1/A5 SCALE: 1/8"=1'-0"

**KERCHEVAL AVENUE**  
(80 FT. WIDE)

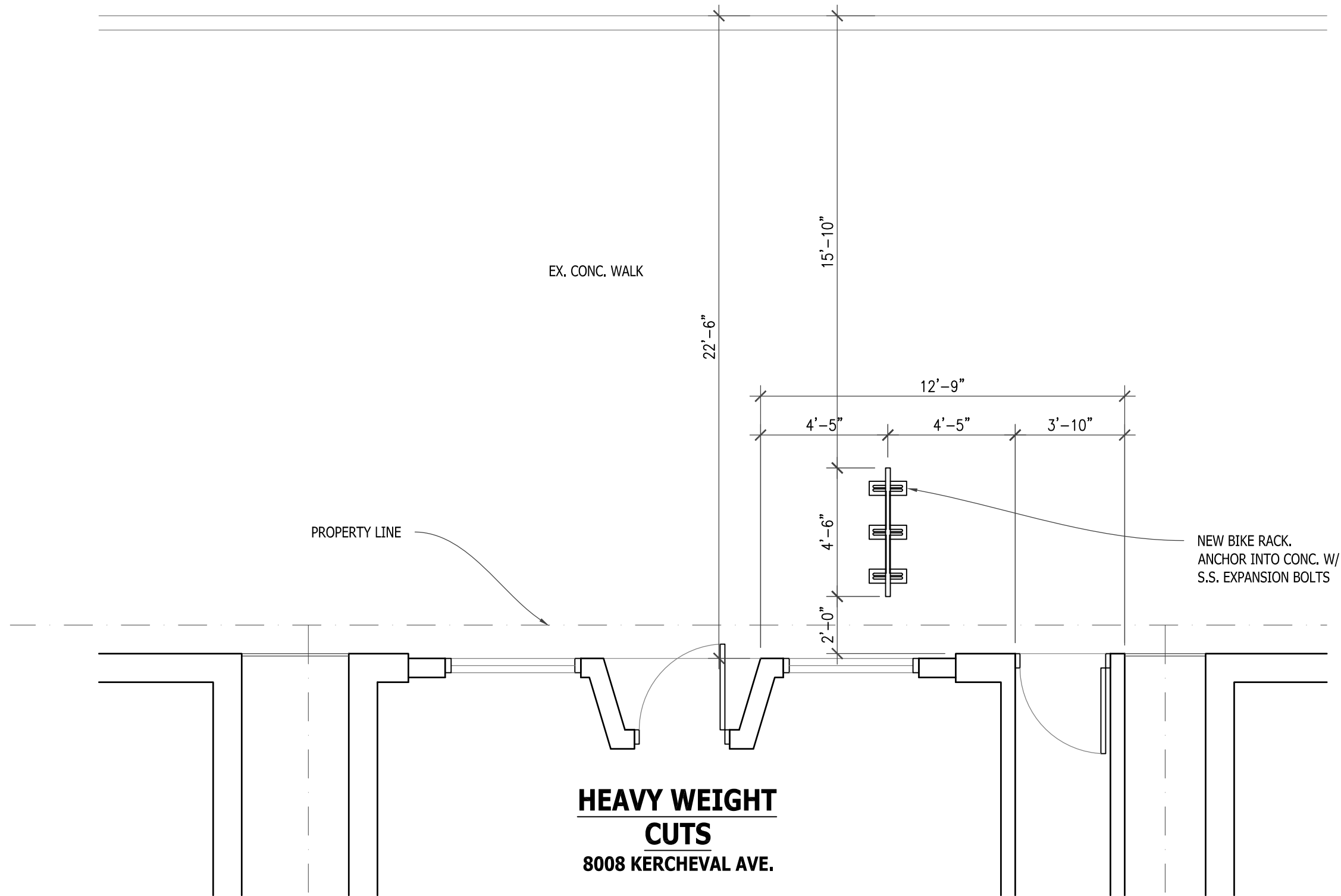

Allan Machielse, AIA Architect  
7963 Saint Paul Avenue  
Detroit, MI 48214  
(p) 810.252.4197  
(w) www.allanmachielse.com  
(e) allan@allanmachielse.com

**HEAVY WEIGHT CUTS**

SCALE: 1/4" = 1'-0"  
DRAWN: AMM CHECKED: AMM  
DATE: 7-12-17

5 SITE PLAN @ HEAVY WEIGHT CUTS  
A1/A6 SCALE: 1/4"=1'-0"

**A6**

SHEET 6 OF 7

## GENERAL NOTES

- A. CONTRACTOR/INSTALLER SHALL OBTAIN ALL NECESSARY APPROVALS AND PERMITS PRIOR TO INSTALLING BIKE RACKS.
- B. DO NOT SCALE DRAWINGS. USE PRINTED DIMENSIONS ONLY. IF ANY DISCREPANCY OCCURS, NOTIFY THE ARCHITECT FOR DIRECTION.
- C. CONTRACTOR/INSTALLER SHALL FIELD VERIFY ALL DIMENSIONS PRIOR TO PROCEEDING WITH INSTALLATION. IF ANY DISCREPANCY IN THE DRAWINGS IS NOTED, NOTIFY THE ARCHITECT FOR DIRECTION.
- D. INSTALL BIKE RACKS WITH STAINLESS STEEL FASTENERS AND PER FABRICATOR'S INSTRUCTIONS.
- E. AT ALL BIKE RACK LOCATIONS, A MINIMUM OF 6'-0" CLEAR SIDEWALK IS REQUIRED EXCLUSIVE OF BIKE RACK, UTILITY POLES, AND OTHER STREET FIXTURES AND OBSTRUCTIONS TO ALLOW FOR PASSAGE OF PEDESTRIANS.

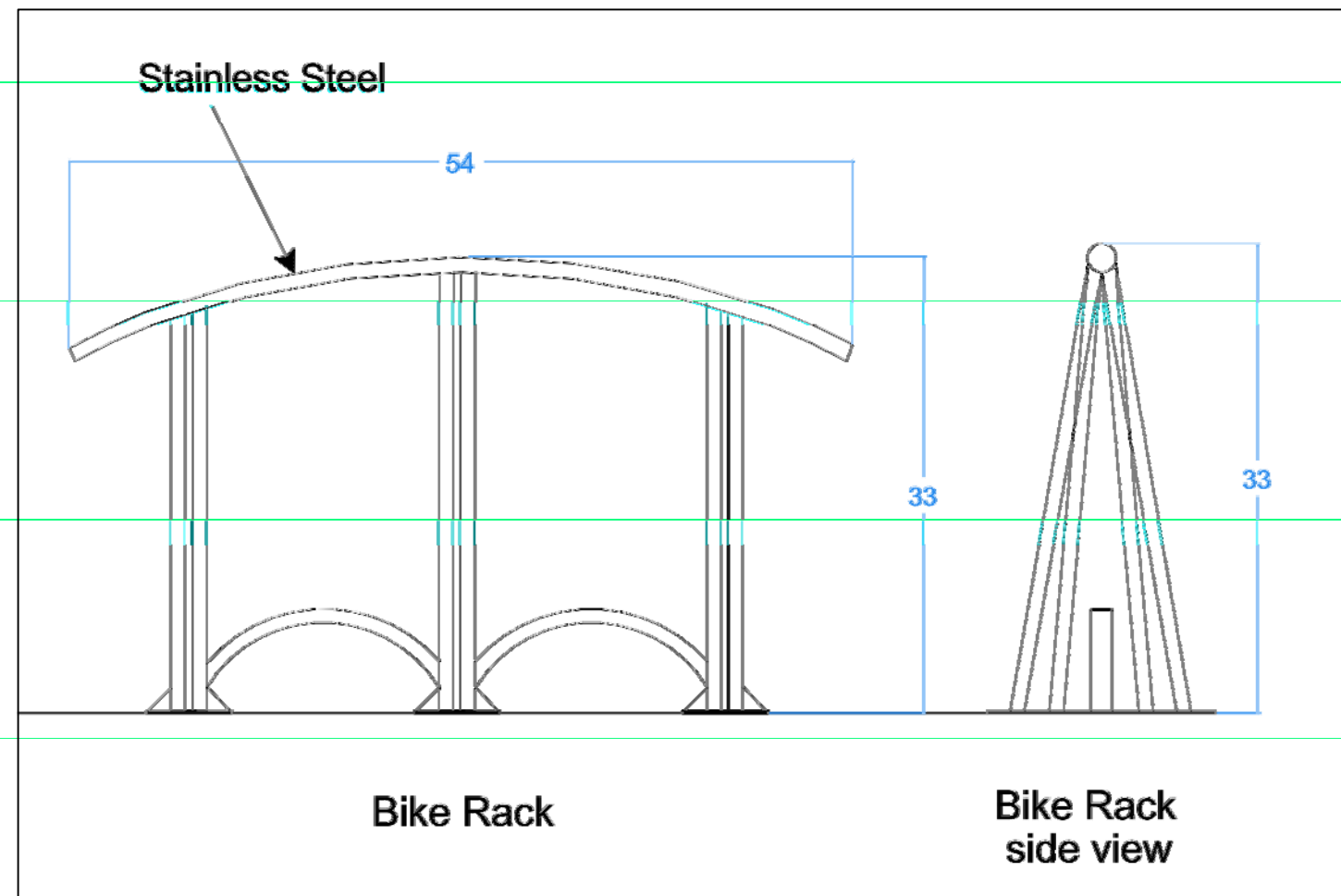

Allan Machielse, AIA Architect  
7963 Saint Paul Avenue  
Detroit, MI 48214  
(p) 810.252.4197  
(w) [www.allanmachielse.com](http://www.allanmachielse.com)  
(e) [allan@allanmachielse.com](mailto:allan@allanmachielse.com)

## TYPICAL BIKE RACK

SCALE: NTS  
DRAWN: AMM CHECKED: AMM  
DATE: 7-12-17

# A7

SHEET 7 OF 7