



8109 East Jefferson Avenue, #1B
Detroit, MI 48214
Phone: 313-486-2900
Fax: 313-331-1500
E-Mail: mac@thevillagesofdetroit.com
Web: www.thevillagesofdetroit.com

October 30, 2017

The Honorable City Council
Attn: Office of the City Clerk
200 CAYMC
Detroit MI 48226

Re: Petition of encroachment

To Whom It May Concern:

I am writing in order to apply for a petition to encroach on the right of way for the purposes of installing bicycle racks in the locations indicated in the attached site plans (refer to Exhibit A for site plans). The Department of Public Works has approved the site plans (refer to Exhibit B for site plan approval). It is our intention to proceed with installation with an 'at risk permit.'

Should you have any other questions, feel free to reach out to me at your convenience.

Sincerely,

Mac Farr
Executive Director
Villages CDC

cc: Janice Rutledge, Department of Public Works

CITY CLERK: 31 OCT 2017 AM 10:51

VILLAGES BIKE RACK INSTALLATION

VARIOUS LOCATIONS, DETROIT, MI 48214

PROJECT No. 1702

CLIENT:

THE VILLAGES CDC
200 RIVERPLACE
SUITE 2800
DETROIT, MICHIGAN 48207

ARCHITECT:

ALLAN MACHIELSE, AIA
7963 SAINT PAUL AVENUE
DETROIT, MICHIGAN 48214
(810) 252-4197

DRAWING LIST

- A1 COVER SHEET & AREA PLAN
- A2 BELLE ISLE PIZZA
- A3 DETROIT SAVINGS BANK
- A4 GARLAND BUILDING
- A5 LA BOHEME
- A6 HEAVY WEIGHT CUTS
- A7 TYP. BIKE RACK & GEN. NOTES



Allan Machielse, AIA Architect
7963 Saint Paul Avenue
Detroit, MI 48214
(p) 810.252.4197
(w) www.allanmachielse.com
(e) allan@allanmachielse.com

COVER SHEET & SITE PLAN

SCALE: NTS
DRAWN: AMM CHECKED: AMM
DATE: 7-12-17

A1

SHEET 1 OF 7



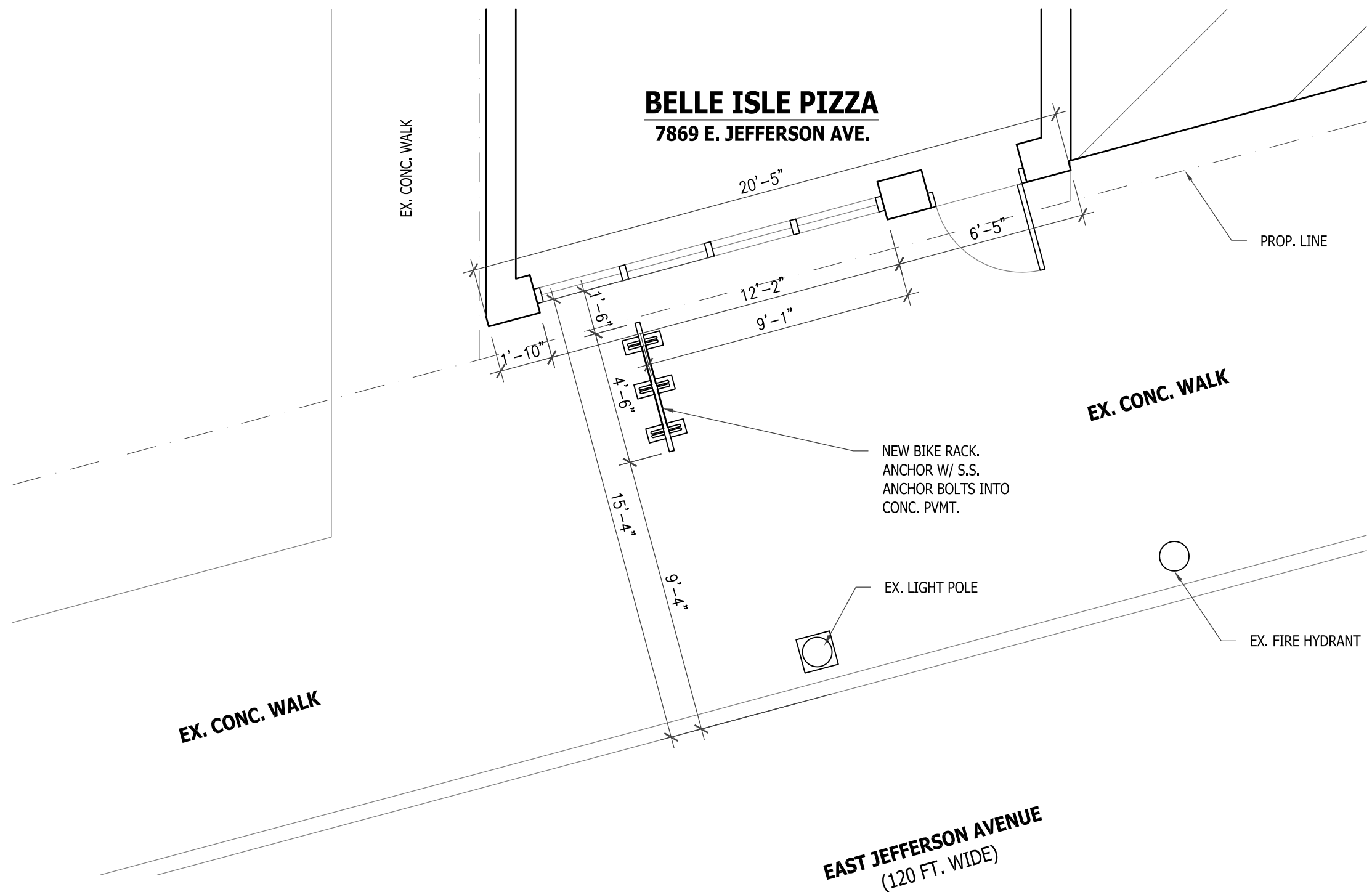

Allan Machielse, AIA Architect
7963 Saint Paul Avenue
Detroit, MI 48214
(p) 810.252.4197
(w) www.allanmachielse.com
(e) allan@allanmachielse.com

**BELLE ISLE
PIZZA**

SCALE: 1/4" = 1'-0"
DRAWN: AMM CHECKED: AMM
DATE: 10-16-17

A2

SHEET 2 OF 7

1
A1/A2 ENLARGED SITE PLAN @ BELLE ISLE PIZZA
SCALE: 1/4"=1'-0"

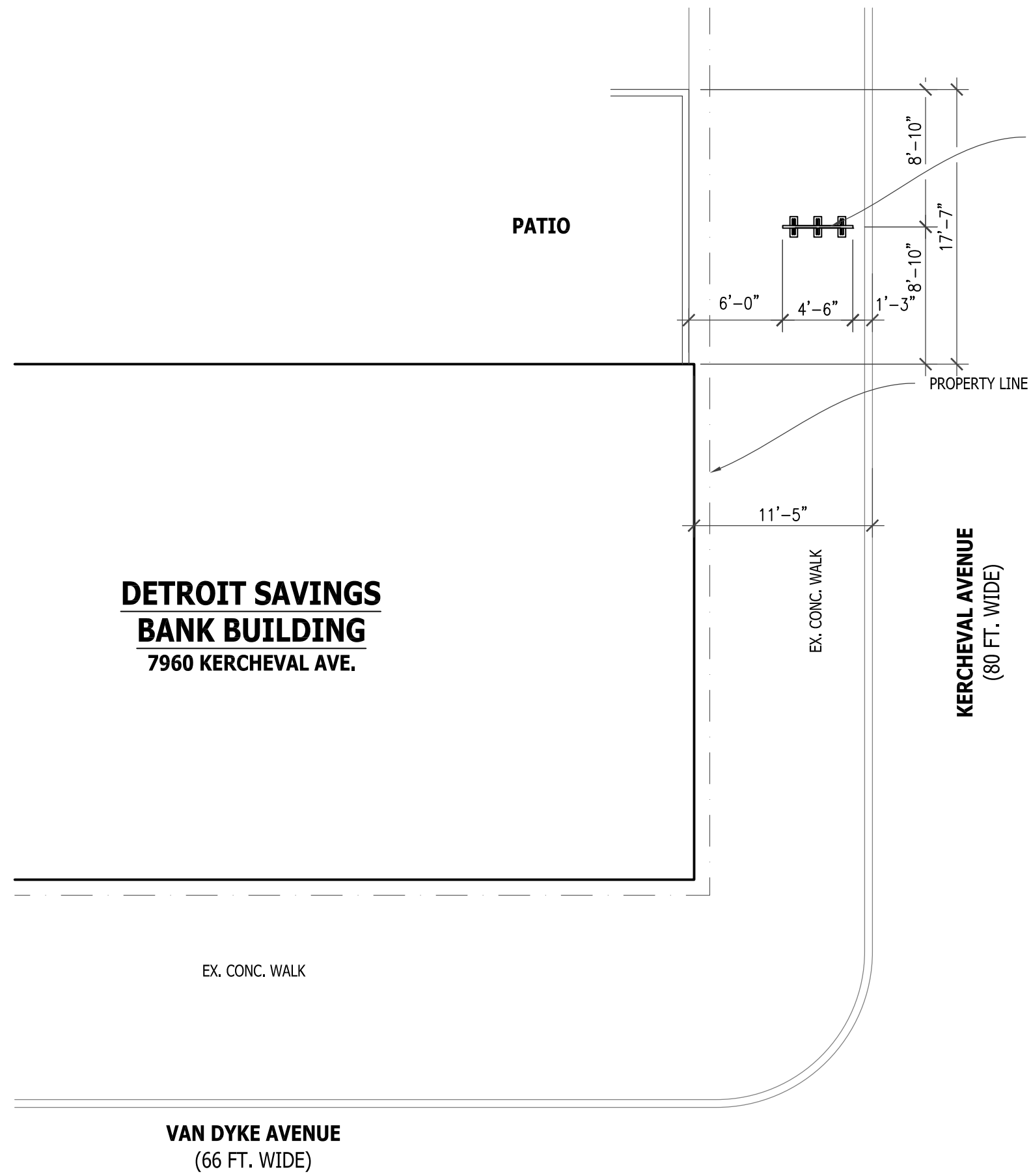

NEW BIKE RACK. CENTER ON EX. PATIO/WOOD FENCING. ANCHOR INTO CONC. W/ S.S. EXP. BOLTS

DETROIT SAVINGS BANK BUILDING
7960 KERCHEVAL AVE.



Allan Machielse, AIA Architect
7963 Saint Paul Avenue
Detroit, MI 48214
(p) 810.252.4197
(w) www.allanmachielse.com
(e) allan@allanmachielse.com

DETROIT SAVINGS BANK BLDG.

SCALE: 1/8" = 1'-0"
DRAWN: AMM CHECKED: AMM
DATE: 10-16-17

A3

SHEET 3 OF 7

2 SITE PLAN @ DETROIT SAVINGS BANK
A1 | A3 SCALE: 1/8"=1'-0"

KERCHEVAL AVENUE
(80 FT. WIDE)

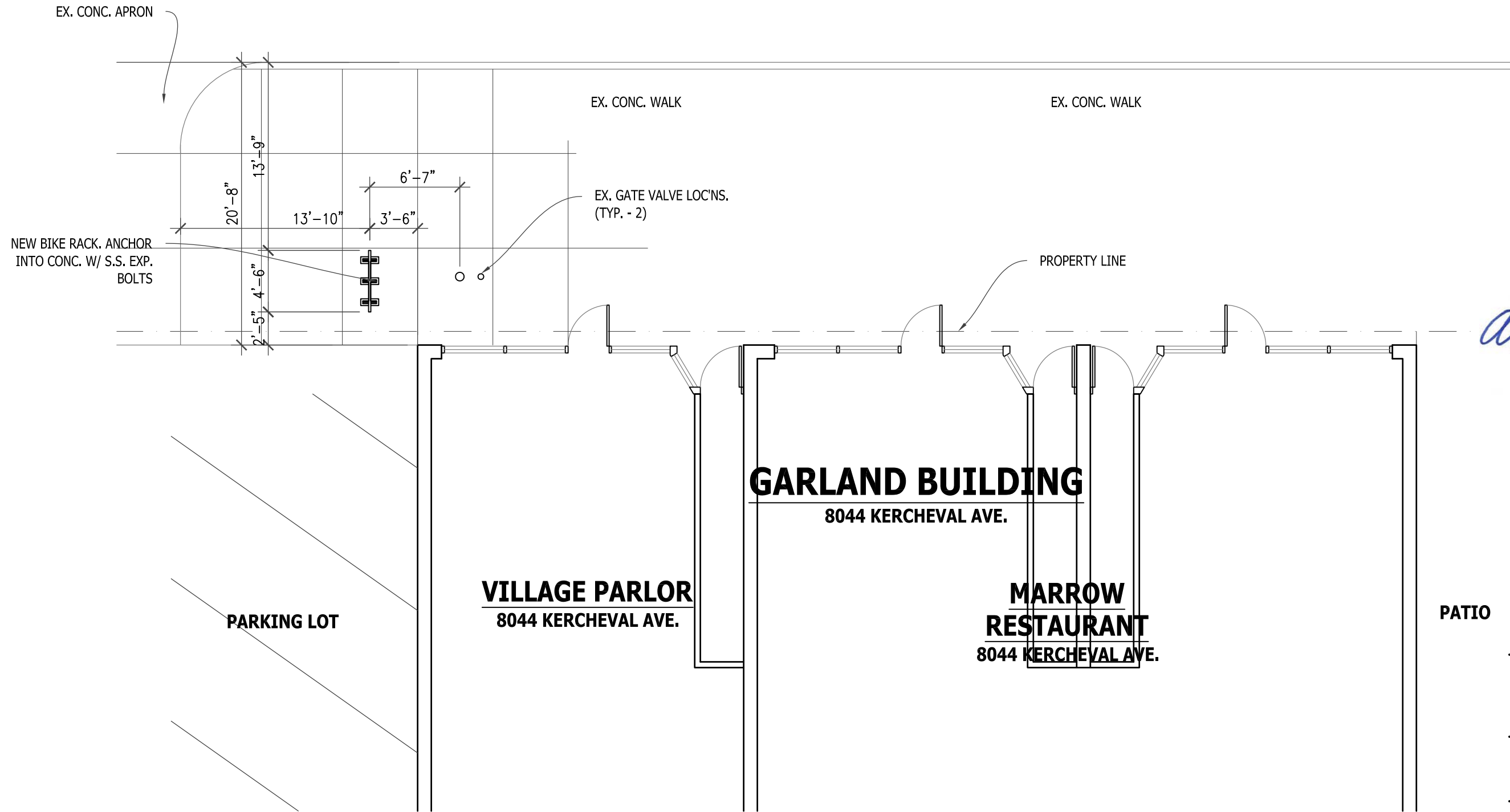

Allan Machielse, AIA Architect
7963 Saint Paul Avenue
Detroit, MI 48214
(p) 810.252.4197
(w) www.allanmachielse.com
(e) allan@allanmachielse.com

GARLAND BUILDING

SCALE: 1/8" = 1'-0"
DRAWN: AMM CHECKED: AMM
DATE: 11-19-17

A4

SHEET 4 OF 7

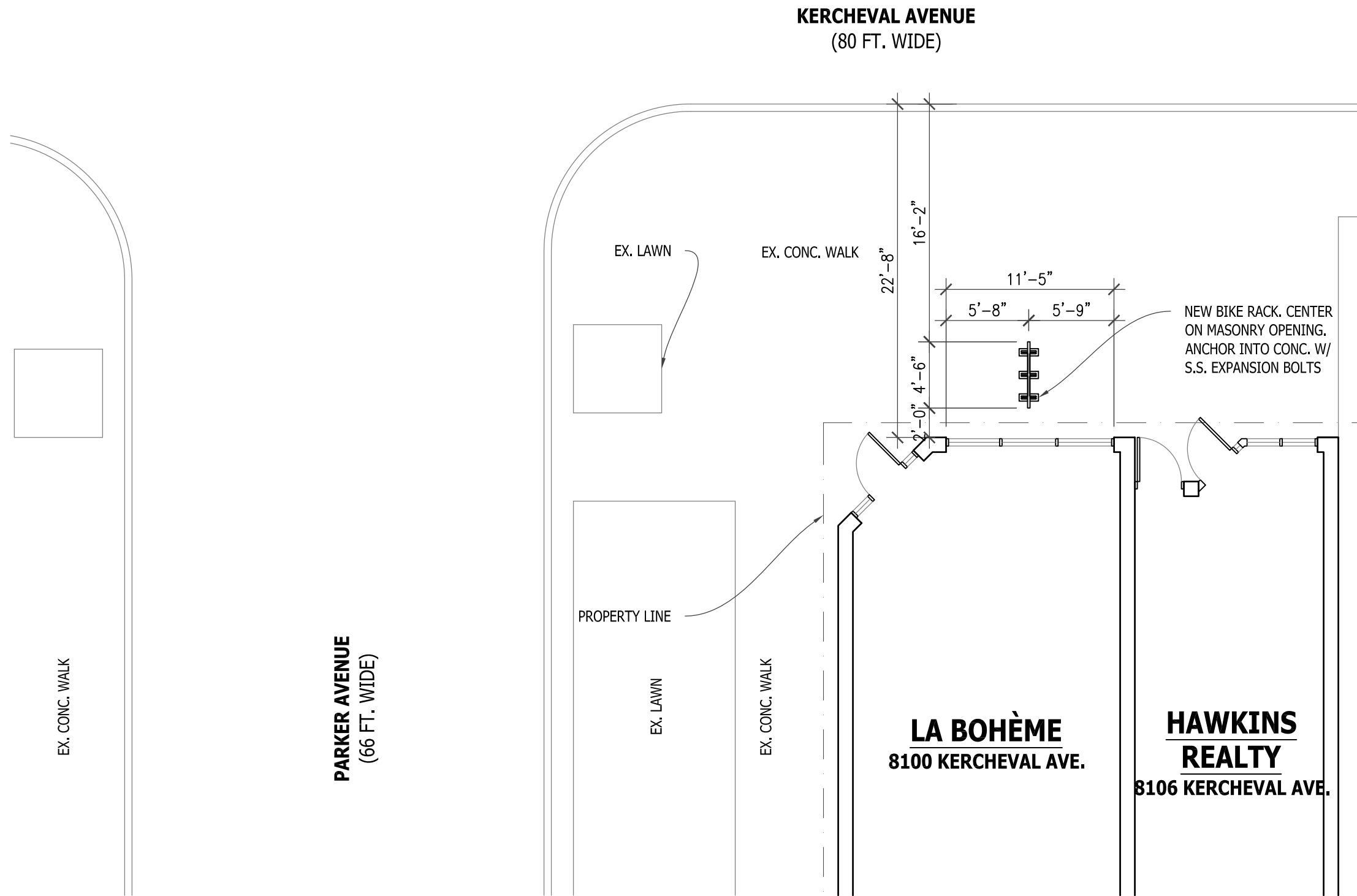

Allan Machielse, AIA Architect
 7963 Saint Paul Avenue
 Detroit, MI 48214
 (p) 810.252.4197
 (w) www.allanmachielse.com
 (e) allan@allanmachielse.com

LA BOHÈME

SCALE: 1/8" = 1'-0"
 DRAWN: AMM CHECKED: AMM
 DATE: 7-1-17

A5

SHEET 5 OF 7

4 SITE PLAN @ LA BOHEM
 A1/A5 SCALE: 1/8"=1'-0"

KERCHEVAL AVENUE
(80 FT. WIDE)

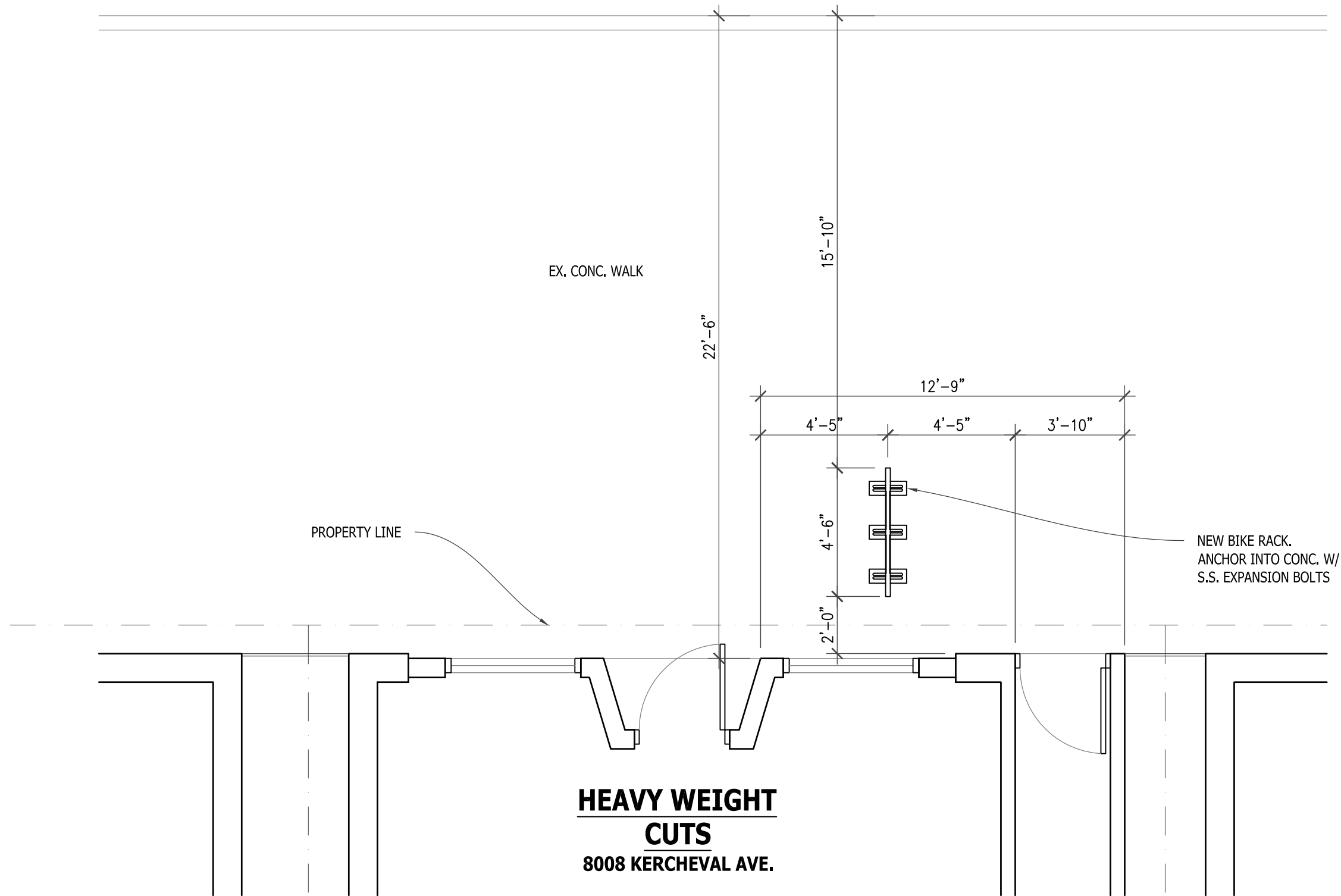

Allan Machielse, AIA Architect
7963 Saint Paul Avenue
Detroit, MI 48214
(p) 810.252.4197
(w) www.allanmachielse.com
(e) allan@allanmachielse.com

HEAVY WEIGHT CUTS

SCALE: 1/4" = 1'-0"
DRAWN: AMM CHECKED: AMM
DATE: 7-12-17

5 SITE PLAN @ HEAVY WEIGHT CUTS
A1/A6 SCALE: 1/4"=1'-0"

A6

SHEET 6 OF 7

GENERAL NOTES

- A. CONTRACTOR/INSTALLER SHALL OBTAIN ALL NECESSARY APPROVALS AND PERMITS PRIOR TO INSTALLING BIKE RACKS.
- B. DO NOT SCALE DRAWINGS. USE PRINTED DIMENSIONS ONLY. IF ANY DISCREPANCY OCCURS, NOTIFY THE ARCHITECT FOR DIRECTION.
- C. CONTRACTOR/INSTALLER SHALL FIELD VERIFY ALL DIMENSIONS PRIOR TO PROCEEDING WITH INSTALLATION. IF ANY DISCREPANCY IN THE DRAWINGS IS NOTED, NOTIFY THE ARCHITECT FOR DIRECTION.
- D. INSTALL BIKE RACKS WITH STAINLESS STEEL FASTENERS AND PER FABRICATOR'S INSTRUCTIONS.
- E. AT ALL BIKE RACK LOCATIONS, A MINIMUM OF 6'-0" CLEAR SIDEWALK IS REQUIRED EXCLUSIVE OF BIKE RACK, UTILITY POLES, AND OTHER STREET FIXTURES AND OBSTRUCTIONS TO ALLOW FOR PASSAGE OF PEDESTRIANS.

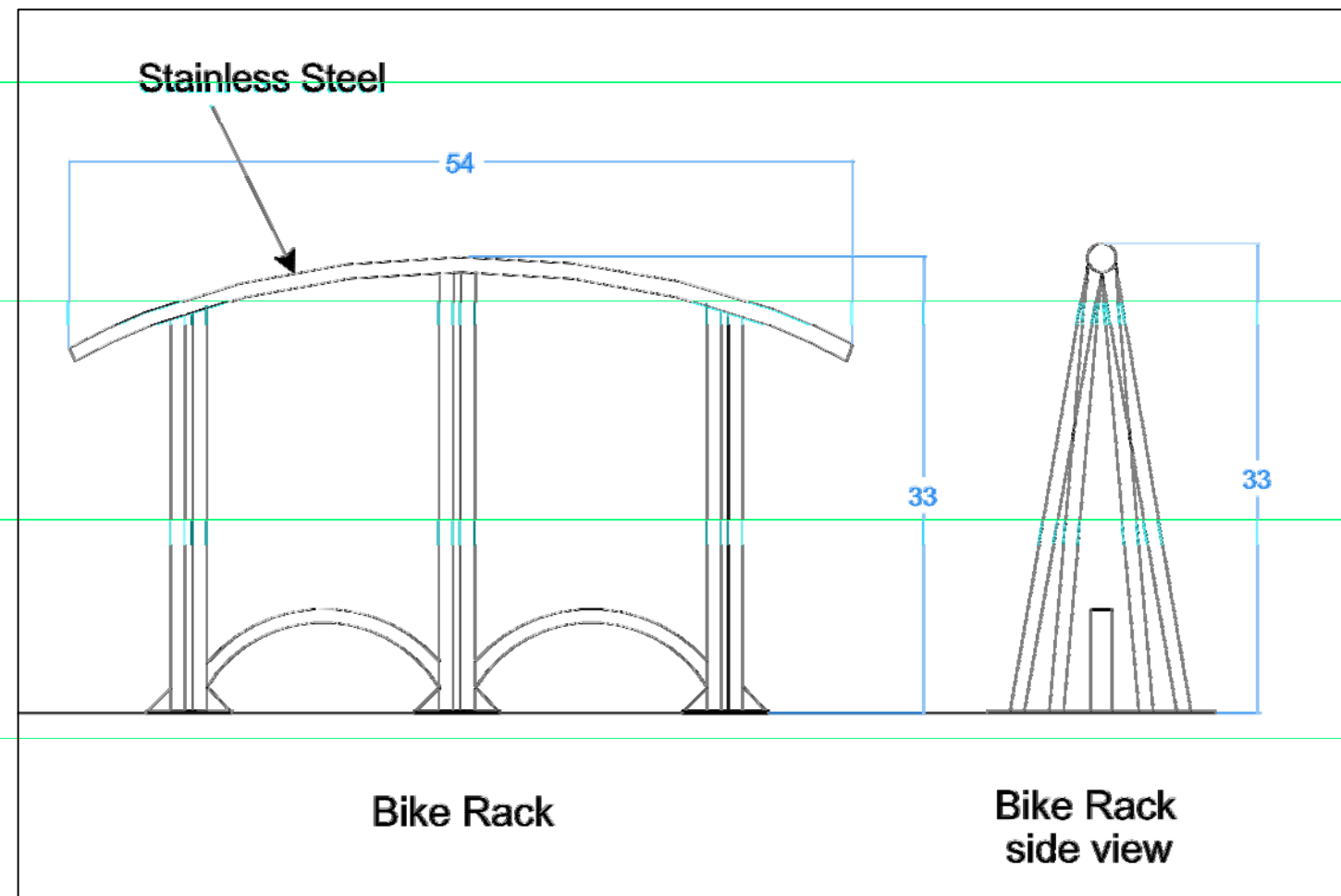

Allan Machielse, AIA Architect
7963 Saint Paul Avenue
Detroit, MI 48214
(p) 810.252.4197
(w) www.allanmachielse.com
(e) allan@allanmachielse.com

TYPICAL BIKE RACK

SCALE: NTS
DRAWN: AMM CHECKED: AMM
DATE: 7-12-17

A7

SHEET 7 OF 7