



April 13, 2018

**HAND DELIVER**

**Honorable Detroit City Council  
C/o Detroit City Clerk  
2 Woodward Avenue  
200 Coleman A. Young Municipal Center  
Detroit, Michigan 48226**

RE: Revision - Request to vacate a portion of the Trumbull Avenue public right-of-way.

Giffels Webster, 28 W. Adams, Suite 1200, Detroit, Michigan 48226 on behalf of Larson Reality, 91 E. Long Lake Rd., Bloomfield Hills, MI, respectfully request the City of Detroit to revise petition no. 1812 to include:

- Outright vacation of a 50' wide utility easement (Kaline Dr. E-W) and the 15" x 20" sewer located in the N-S alley as shown in Exhibit 1. Utilities in the Kaline Drive easement and vacated N-S alley will be removed.
- Outright vacate a portion of Trumbull Avenue's public Right-of-Way adjacent 1620 Michigan Ave, commonly known as the Old Tiger Stadium Site. The requested vacation is located adjacent to the block bounded by Trumbull Ave, Michigan Ave, Cochrane St. and the W. Fisher Service Dr. It is requested to vacate the western 13 feet of the Trumbull Ave right of way, extending 537'± from the southern border of the Fisher Freeway Service Drive. The vacation includes a chamfer at the northeast corner of the proposed vacation. Approximate limits of the vacation can be found in Exhibit 1, enclosed herein.

Giffels Webster has been asked to facilitate the requested vacation. We will be working with the City of Detroit's Department of Public Works –City Engineering Division, and all stakeholders to achieve vacations that are satisfactory to all interested parties.

The requested vacation will neither impede pedestrian and vehicular traffic, nor will it interfere with the maintenance of the public rights-of-way, including utility company and Fire and Police Departments access.

If you should have any questions, please do not hesitate to contact Matt Wojciechowski by phone, at 313.962.4442, or by email, at [mwojciechowski@giffelswebster.com](mailto:mwojciechowski@giffelswebster.com).

Respectfully,

Matt Wojciechowski, Staff Planner  
Giffels Webster

# EXHIBIT 1

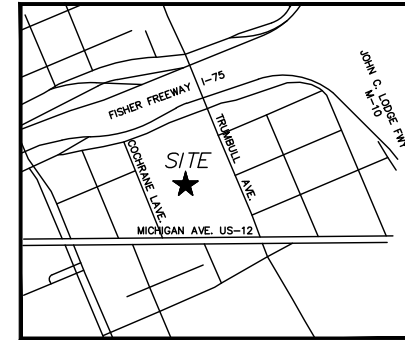

LOCATION MAP  
(NOT TO SCALE)

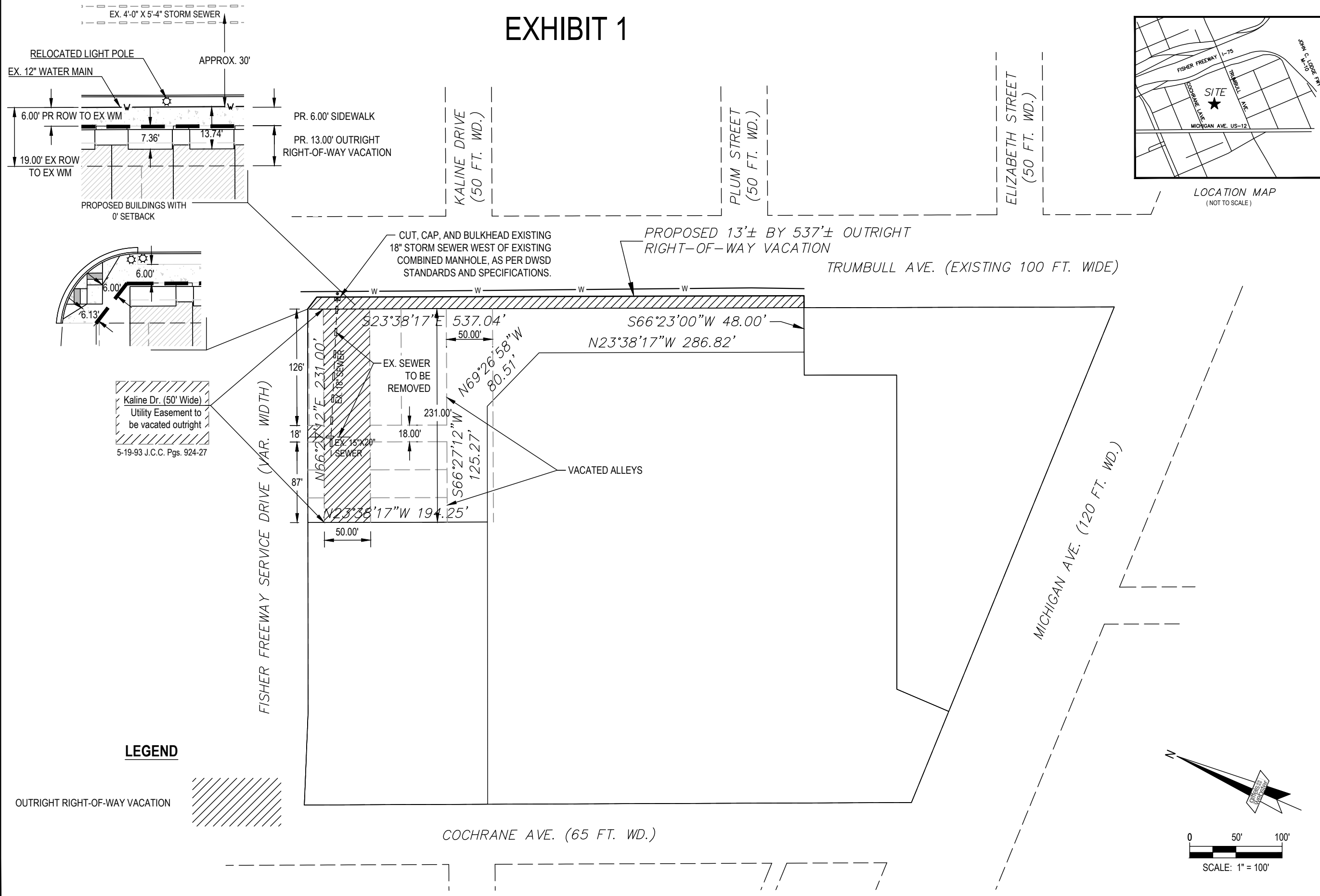

## LEGEND

OUTRIGHT RIGHT-OF-WAY VACATION



**giffels webster**

Engineers  
Surveyors  
Planners  
Landscape Architects

28 West Adams Road  
Suite 1200  
Detroit, MI 48226  
p (313) 962-4442  
f (313) 962-5068  
www.giffelswebster.com

Executive:	MGD
Manager:	VJA
Designer:	RMJ/SF
Quality Control:	MGD
Section:	26
T-02-S R-12-E	

DATE:	ISSUE:
04.13.2018	R.O.W. PETITION APPLICATION

Developed For:  
Larson Realty Group

91 West Long Lake Road  
Bloomfield Hills, MI 48304

P 248.593.8010  
F 248.593.8011

## R.O.W. Vacation Exhibit 1

Tiger Towns @ The Corner  
Detroit  
Wayne County  
Michigan

Date:	04.13.2018
Scale:	1"=100'
Sheet:	EX001
Project:	19384-00D

Copyright © 2017 Giffels Webster.  
No reproduction shall be made without the prior written consent of Giffels Webster.

