

SR 8234348  
NOW  
MADSN 105

City of Detroit  
City Engineering Division, Department of Public Works  
Survey Bureau

NOTICE OF PROPOSED CHANGE IN PROPERTY

Date: 01/30/2018

Petition: x1772

- |  |  |
|--|--|
| <input type="checkbox"/> AT&T Telecommunication            | <input type="checkbox"/> Berm Use                |
| <input type="checkbox"/> Comcast Television (CATV)         | <input type="checkbox"/> Conversion to Easement  |
| <input checked="" type="checkbox"/> Detroit Edison (DTE)   | <input type="checkbox"/> Dedication              |
| <input type="checkbox"/> Fire Department                   | <input checked="" type="checkbox"/> Encroachment |
| <input type="checkbox"/> Great Lakes Water Authority       | <input type="checkbox"/> Outright Vacation       |
| <input type="checkbox"/> Land Bank Authority               | <input type="checkbox"/> Temporary Closing       |
| <input type="checkbox"/> Michcon (DTE)                     |  |
| <input type="checkbox"/> Planning & Development Department |  |
| <input type="checkbox"/> Public Lighting Authority         |  |
| <input type="checkbox"/> Public Lighting Department        |  |
| <input type="checkbox"/> Police Department                 |  |
| <input type="checkbox"/> Solid Waste Division, DPW         |  |
| <input type="checkbox"/> Street Design Bureau, DPW         |  |
| <input type="checkbox"/> Street Maintenance Division, DPW  |  |
| <input type="checkbox"/> Traffic Engineering Division, DPW |  |
| <input type="checkbox"/> Water and Sewerage Department     |  |
| <input type="checkbox"/> _____                             |  |

A petition drawing is attached. Property shown on the attached print is proposed to be changed as indicated. Kindly report (using the back of this sheet) the nature of your services, if any affected by the proposed change and the estimated costs of removing and rerouting such services (if necessary).

Please return one copy to City Engineering Division, DPW within two weeks of the submittal date. Retain one copy and print for you file.

Ron Brundidge, Director, Department of Public Works

By: Richard Doherty, CED DPW  
City Engineer

TO: City Engineering Division, DPW  
2 Woodward Ave., Suite 642  
Detroit, Michigan 48226-3462  
Survey Bureau: 313-224-3970

Petition: x1772

The proposed change in property (referred to on the other side of this sheet) would affect our services as follows:

- Not Involved
- Involved; but asking you to hold action on this petition until further notice.
- Involved; but no objections to the property change.
- Involved; objection to the property change.
- Involved; but no objections to the property change...provided as easement of the full width of the public right-of-way (street, alley or other public place) is reserved.
- Involved; the nature of our services and the estimated costs of removing and/or rerouting such services are:

DTE Energy  
(Utility or City Department)

Non LOR  
By

Staff Engineer  
Title

2/13/18  
Date

313.235.1884  
Area code – Telephone number



September 7, 2017

**HAND DELIVER**

**Honorable Detroit City Council  
C/o Detroit City Clerk  
2 Woodward Avenue  
200 Coleman A. Young Municipal Center  
Detroit, Michigan 48226**

RE: Request for encroachment into Shelby Street.

Giffels Webster, 28 W. Adams, Suite 1200, Detroit, Michigan 48226, on behalf of Capitol Park Partnership, 1234 Washington Boulevard, Suite 700, Detroit, MI 48226, respectfully requests to encroach into the Shelby Street right-of-way within the block identified as Capitol Park, described as following:

- A 40 foot wide café encroachment into the Shelby Street right-of-way, beginning 60.77 feet from the southwest corner of Grand River Avenue and Shelby Street and extending south 121.54 feet in length, adjacent to 1249 Griswold Street (Commonly known as the Farwell building).

Limits of the requested easement can be found in the attachment, enclosed herein.

Giffels Webster has been asked to facilitate this encroachment petition. We have been in coordination with the Downtown Detroit Partnership and plan to work with the City of Detroit's Department of Public Works – City Engineering Division, utility providers, and other stakeholders to achieve an encroachment that is satisfactory to all interested parties.

Capitol Park Partnership is working with the City of Detroit and Downtown Detroit Partnership's (DDP) chosen design team on the redesign of Capitol Park, adjacent to this requested encroachment. They are the significant stakeholder in the Park's redesign efforts and this encroachment request is consistent with the reimagined vision and configuration of the park.

If you should have any questions, please do not hesitate to contact Matt Wojciechowski, Giffels Webster, by phone, at 313.962.4442, or by email, at [mwojciechowski@giffelswebster.com](mailto:mwojciechowski@giffelswebster.com)

Respectfully,

A handwritten signature in black ink, appearing to read "Michael W. Marks".

Michael Marks, PE, Partner  
Giffels Webster

INSTALL 6" MIN. THICK CONCRETE  
FINISH AS NOTED TO MATCH  
ADJACENT PAVED SURFACE  
MATCH ADJACENT  
PAVED SURFACE SECTION (TYP)

CONCRETE TO MATCH OR EXISTING  
CONCRETE TO MATCH OR EXISTING  
CONCRETE TO MATCH OR EXISTING  
CONCRETE TO MATCH OR EXISTING  
CONCRETE TO MATCH OR EXISTING  
CONCRETE TO MATCH OR EXISTING

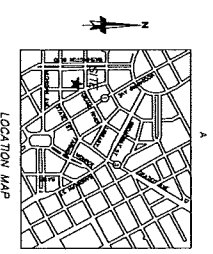

**PAVING AND GRADING HATCH LEGEND**

- REINFORCED CONCRETE
- CONCRETE
- ASPHALT
- GRAVEL
- GRAVEL WITH CURB
- GRAVEL WITH CURB AND GUTTER
- GRAVEL WITH CURB AND GUTTER AND SIDEWALK
- GRAVEL WITH CURB AND GUTTER AND SIDEWALK AND BIKEWAY
- GRAVEL WITH CURB AND GUTTER AND SIDEWALK AND BIKEWAY AND TRAIL
- GRAVEL WITH CURB AND GUTTER AND SIDEWALK AND BIKEWAY AND TRAIL AND BIKEWAY
- GRAVEL WITH CURB AND GUTTER AND SIDEWALK AND BIKEWAY AND TRAIL AND BIKEWAY AND TRAIL AND BIKEWAY

STRUCTURE	VE (60' WIDE)
130	
125	
120	
115	
110	
105	
100	

INVERT  
SCALE: 1" = 20' HORIZ.  
1" = 5' VERT.

104.00± N/S  
105.87 (STORM)  
105.67 (SANITARY)

PROPOSED 6" MIN. THICK CONCRETE  
FINISH AS NOTED TO MATCH  
ADJACENT PAVED SURFACE  
MATCH ADJACENT  
PAVED SURFACE SECTION (TYP)

PROPOSED 6" MIN. THICK CONCRETE  
FINISH AS NOTED TO MATCH  
ADJACENT PAVED SURFACE  
MATCH ADJACENT  
PAVED SURFACE SECTION (TYP)

GENERAL NOTES  
1. ALL WORK SHALL BE IN ACCORDANCE WITH THE LATEST EDITIONS OF THE MICHIGAN DEPARTMENT OF TRANSPORTATION STANDARD SPECIFICATIONS FOR HIGHWAYS, BRIDGES AND STRUCTURES, 2013 EDITION, AND THE MICHIGAN DEPARTMENT OF TRANSPORTATION STANDARD SPECIFICATIONS FOR WATERWAYS AND MARINE STRUCTURES, 2013 EDITION.  
2. ALL WORK SHALL BE IN ACCORDANCE WITH THE LATEST EDITIONS OF THE MICHIGAN DEPARTMENT OF TRANSPORTATION STANDARD SPECIFICATIONS FOR AIRPORTS AND AIRPORT RELATED WORK, 2013 EDITION.  
3. ALL WORK SHALL BE IN ACCORDANCE WITH THE LATEST EDITIONS OF THE MICHIGAN DEPARTMENT OF TRANSPORTATION STANDARD SPECIFICATIONS FOR RAILROADS AND RAILROAD RELATED WORK, 2013 EDITION.  
4. ALL WORK SHALL BE IN ACCORDANCE WITH THE LATEST EDITIONS OF THE MICHIGAN DEPARTMENT OF TRANSPORTATION STANDARD SPECIFICATIONS FOR PORTS AND PORT RELATED WORK, 2013 EDITION.  
5. ALL WORK SHALL BE IN ACCORDANCE WITH THE LATEST EDITIONS OF THE MICHIGAN DEPARTMENT OF TRANSPORTATION STANDARD SPECIFICATIONS FOR TOWNSHIP AND TOWNSHIP RELATED WORK, 2013 EDITION.  
6. ALL WORK SHALL BE IN ACCORDANCE WITH THE LATEST EDITIONS OF THE MICHIGAN DEPARTMENT OF TRANSPORTATION STANDARD SPECIFICATIONS FOR COUNTY AND COUNTY RELATED WORK, 2013 EDITION.  
7. ALL WORK SHALL BE IN ACCORDANCE WITH THE LATEST EDITIONS OF THE MICHIGAN DEPARTMENT OF TRANSPORTATION STANDARD SPECIFICATIONS FOR STATE AND STATE RELATED WORK, 2013 EDITION.  
8. ALL WORK SHALL BE IN ACCORDANCE WITH THE LATEST EDITIONS OF THE MICHIGAN DEPARTMENT OF TRANSPORTATION STANDARD SPECIFICATIONS FOR FEDERAL AND FEDERAL RELATED WORK, 2013 EDITION.  
9. ALL WORK SHALL BE IN ACCORDANCE WITH THE LATEST EDITIONS OF THE MICHIGAN DEPARTMENT OF TRANSPORTATION STANDARD SPECIFICATIONS FOR INTERNATIONAL AND INTERNATIONAL RELATED WORK, 2013 EDITION.  
10. ALL WORK SHALL BE IN ACCORDANCE WITH THE LATEST EDITIONS OF THE MICHIGAN DEPARTMENT OF TRANSPORTATION STANDARD SPECIFICATIONS FOR OTHER AND OTHER RELATED WORK, 2013 EDITION.

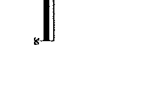

DATE	2013-08-01
PROJECT NUMBER	2013-0003
PROJECT TITLE	IMPROVEMENT PLAN
SHEET NUMBER	C103

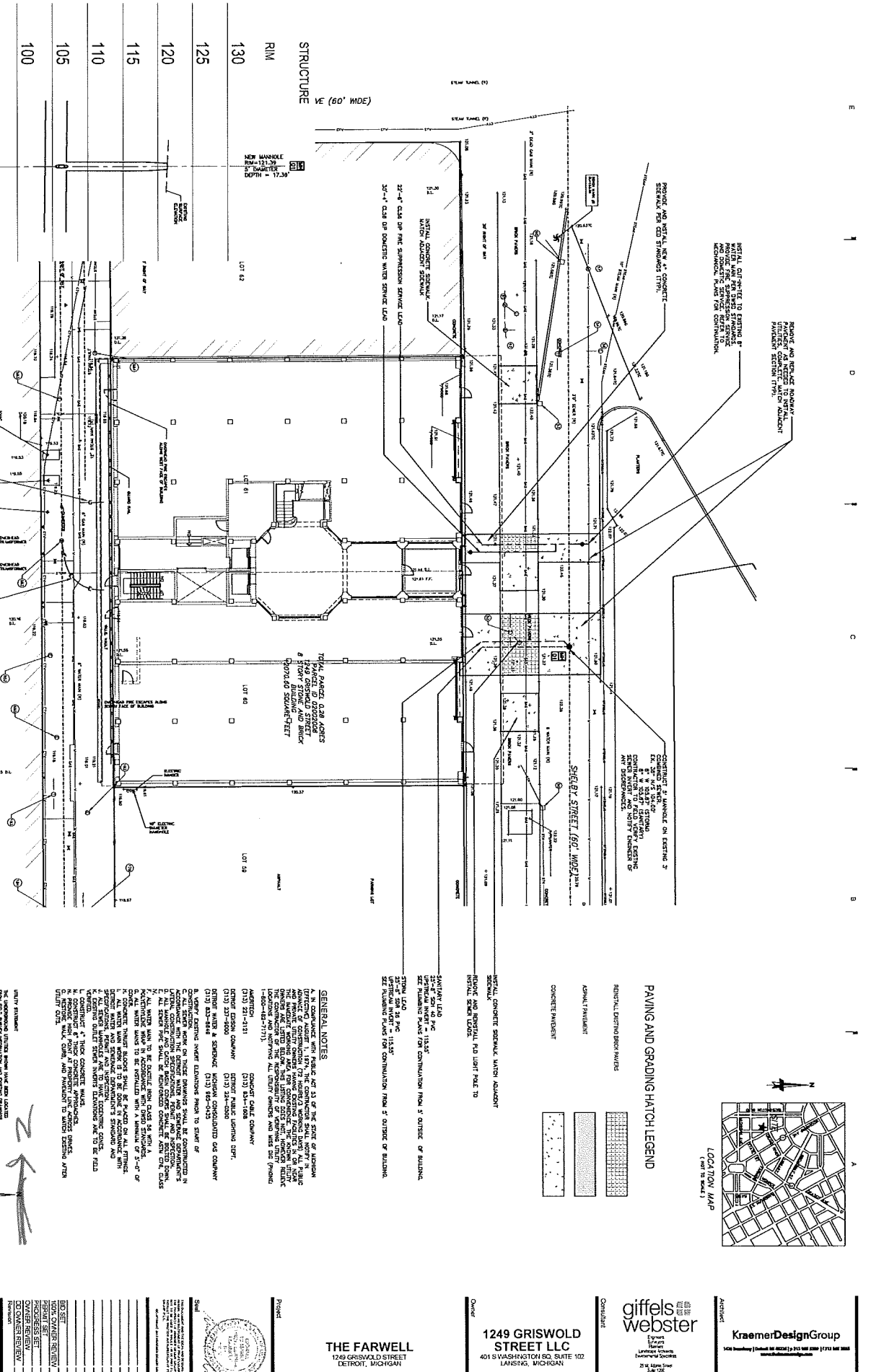

**THE FARWELL**  
1242 GRISWOLD STREET  
DETROIT, MICHIGAN

**1249 GRISWOLD STREET LLC**  
401 S WASHINGTON BLVD SUITE 102  
LANSING, MICHIGAN

**giffels webster**

2500 WOODRIDGE AVENUE  
ANN ARBOR, MI 48106  
734-769-1100  
www.giffelswebster.com

**KraemerDesignGroup**

1000 WOODRIDGE AVENUE  
ANN ARBOR, MI 48106  
734-769-1100  
www.kraemerdsg.com

GRAND RIVER AVE (60' WIDE)

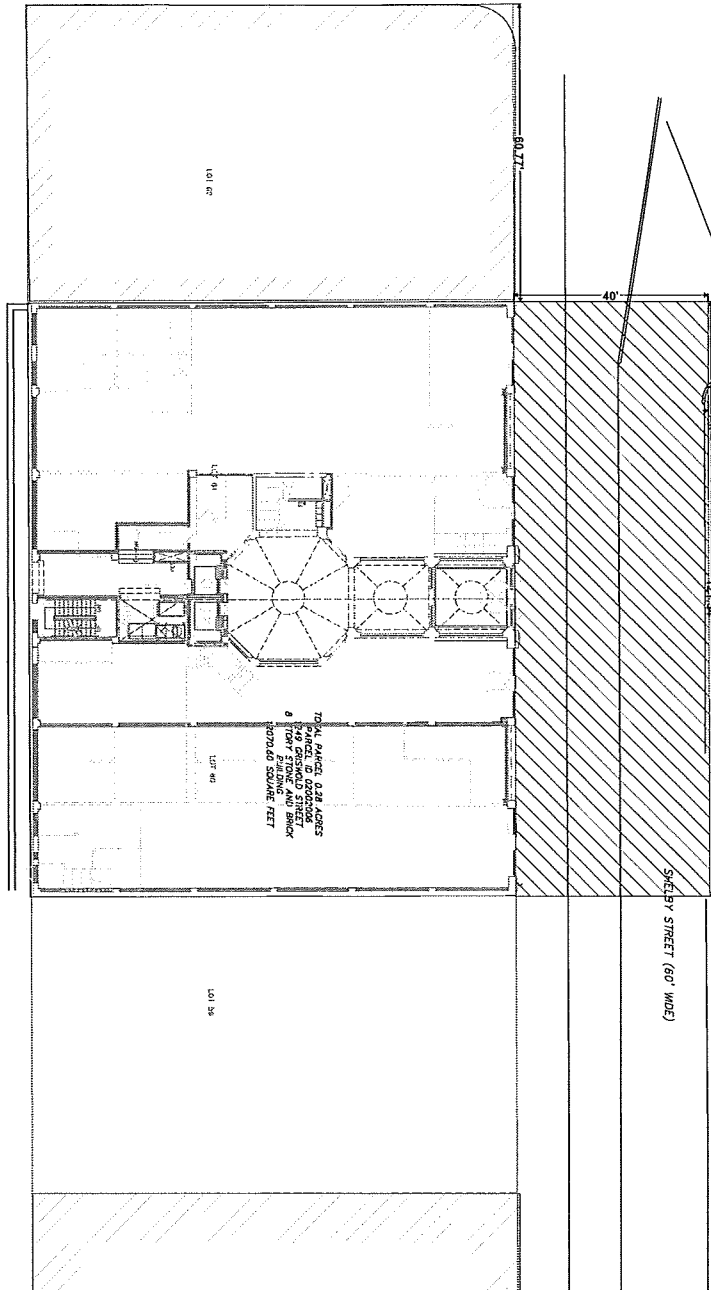
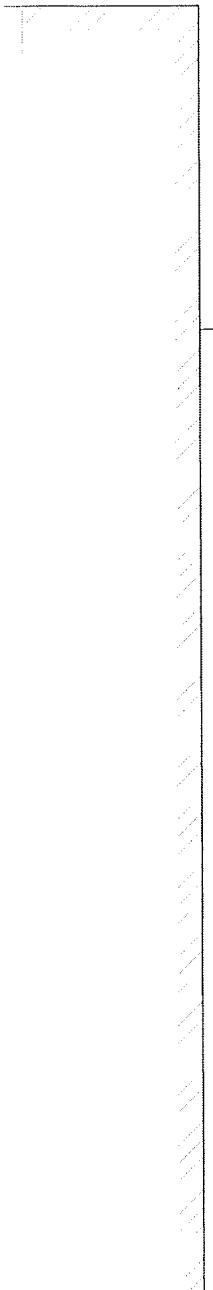

LOT 62

80.77'

40'

121.54'

EXISTING WALL

THIS OFFICE IS A CORNER  
PARCEL OF 0.000000  
ACRES ON GRAND STREET  
& 10th AVENUE, SEVEN  
MORNING SQUARE FERT

LOT 58

20'

SHELBY STREET (60' WIDE)

PROPOSED ENCROACHMENT

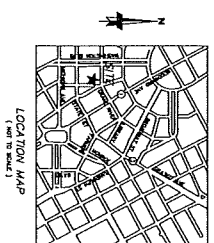

LOCATION MAP  
(NOT TO SCALE)

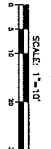

PETITION NO. 1772  
 CAPITAL PARK PARTNERSHIP  
 C/O GIFFELS WEBSTER  
 28 W. ADAMS, SUITE 1200  
 DETROIT, MICHIGAN 48226  
 C/O MATT WOJCIECHOWSKI  
 PHONE NO. 313 962-4442

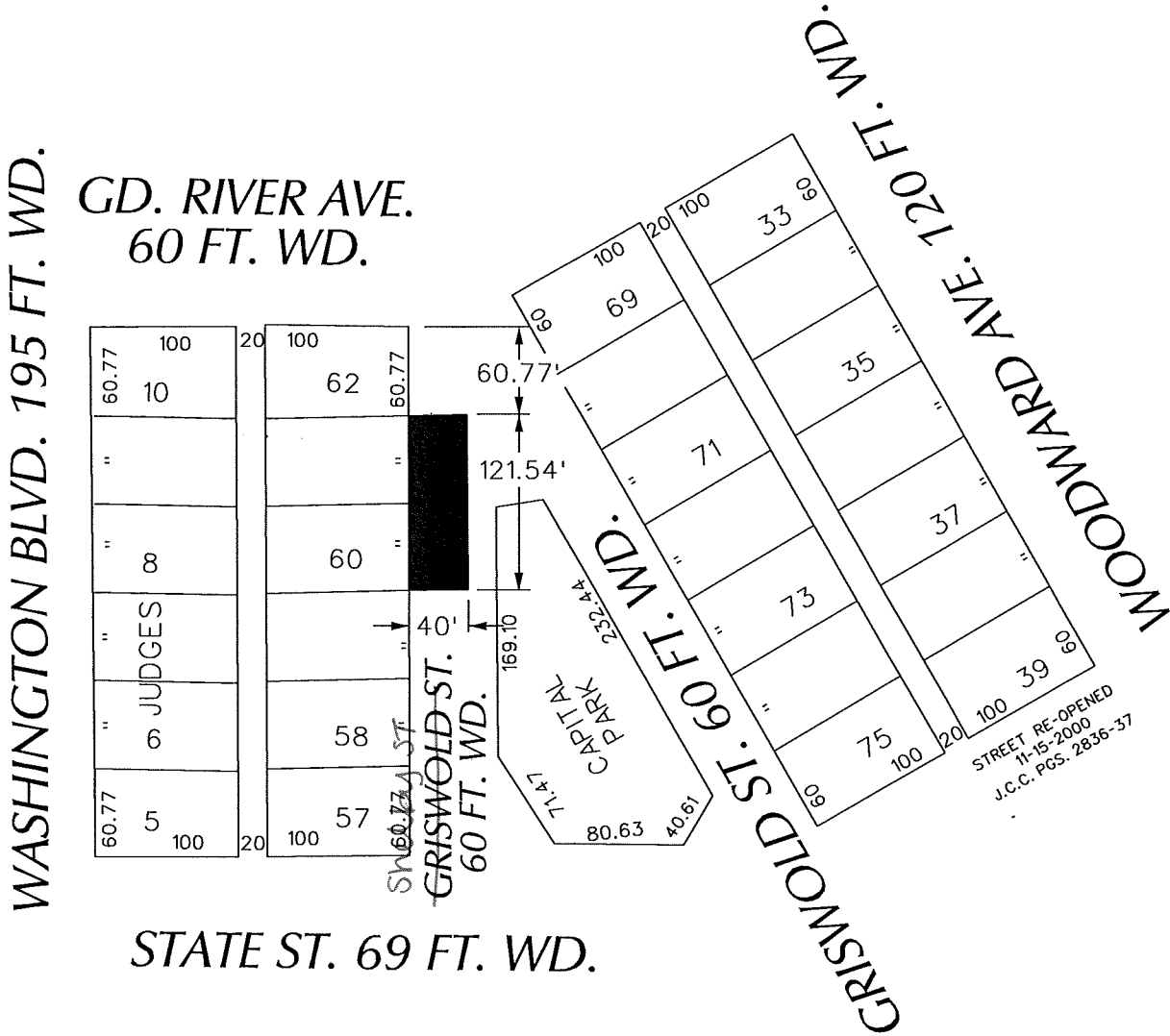

- REQUEST ENCROACHMENT

(FOR OFFICE USE ONLY)

CARTO 28 B

<b>B</b>					
<b>A</b>					
<b>DESCRIPTION</b>	<b>DRWN</b>	<b>CHKD</b>	<b>APPD</b>	<b>DATE</b>	
<b>REVISIONS</b>					
<b>DRAWN BY</b>	<b>CHECKED</b>				
WLW					
<b>DATE</b>	<b>APPROVED</b>				
01-30-18					

REQUEST ENCROACHMENT  
 INTO GRISWOLD  
 AT 1249 GRISWOLD

<b>CITY OF DETROIT</b>	
CITY ENGINEERING DEPARTMENT	
SURVEY BUREAU	
<b>JOB NO.</b>	01-01
<b>DRWG. NO.</b>	X 1772

STREET RE-OPENED  
 11-15-2000  
 J.C.C. PGS. 2836-37