

**City of Detroit**  
**City Engineering Division, Department of Public Works**  
**Survey Bureau**

**NOTICE OF PROPOSED CHANGE IN PROPERTY**

Date: 04/09/2018

Petition: x1771

- |  |  |
|--|--|
| <input type="checkbox"/> AT&T Telecommunication            |  |
| <input type="checkbox"/> Comcast Television (CATV)         | <input type="checkbox"/> Berm Use                |
| <input checked="" type="checkbox"/> Detroit Edison (DTE)   |  |
| <input type="checkbox"/> Fire Department                   | <input type="checkbox"/> Conversion to Easement  |
| <input type="checkbox"/> Great Lakes Water Authority       |  |
| <input type="checkbox"/> Land Bank Authority               | <input type="checkbox"/> Dedication              |
| <input type="checkbox"/> Michcon (DTE)                     |  |
| <input type="checkbox"/> Planning & Development Department | <input checked="" type="checkbox"/> Encroachment |
| <input type="checkbox"/> Public Lighting Authority         |  |
| <input type="checkbox"/> Public Lighting Department        | <input type="checkbox"/> Outright Vacation       |
| <input type="checkbox"/> Police Department                 |  |
| <input type="checkbox"/> Solid Waste Division, DPW         | <input type="checkbox"/> Temporary Closing       |
| <input type="checkbox"/> Street Design Bureau, DPW         |  |
| <input type="checkbox"/> Street Maintenance Division, DPW  |  |
| <input type="checkbox"/> Traffic Engineering Division, DPW |  |
| <input type="checkbox"/> Water and Sewerage Department     |  |
| <input type="checkbox"/> _____                             |  |

A petition drawing is attached. Property shown on the attached print is proposed to be changed as indicated. Kindly report (using the back of this sheet) the nature of your services, if any affected by the proposed change and the estimated costs of removing and rerouting such services (if necessary).

Please return one copy to City Engineering Division, DPW within two weeks of the submittal date. Retain one copy and print for you file.

Ron Brundidge, Director, Department of Public Works

By: Richard Doherty, CED DPW  
City Engineer

TO: City Engineering Division, DPW  
2 Woodward Ave., Suite 642  
Detroit, Michigan 48226-3462  
Survey Bureau: 313-224-3970

Petition: x1771

The proposed change in property (referred to on the other side of this sheet) would affect our services as follows:

- Not Involved
- Involved; but asking you to hold action on this petition until further notice.
- Involved; but no objections to the property change.
- Involved; objection to the property change.  
Please see attached sketch for details
- Involved; but no objections to the property change...provided as easement of the full width of the public right-of-way (street, alley or other public place) is reserved.
- Involved; the nature of our services and the estimated costs of removing and/or rerouting such services are:

DTE Energy  
(Utility or City Department)

Chanele Jones  
By

Associate Engineer, Southeast Engineering  
Title

5/29/2018  
Date

313.235.1549  
Area code – Telephone number

PETITION NO. 1771  
 FIREFOX ENTERPRISE, LLC  
 C/O GIFFELS WEBSTER  
 28 W. ADAMS, SUITE 1200  
 DETROIT, MICHIGAN 48226  
 C/O MICHAEL MARKS P.E.  
 PHONE NO. 313 962-4442

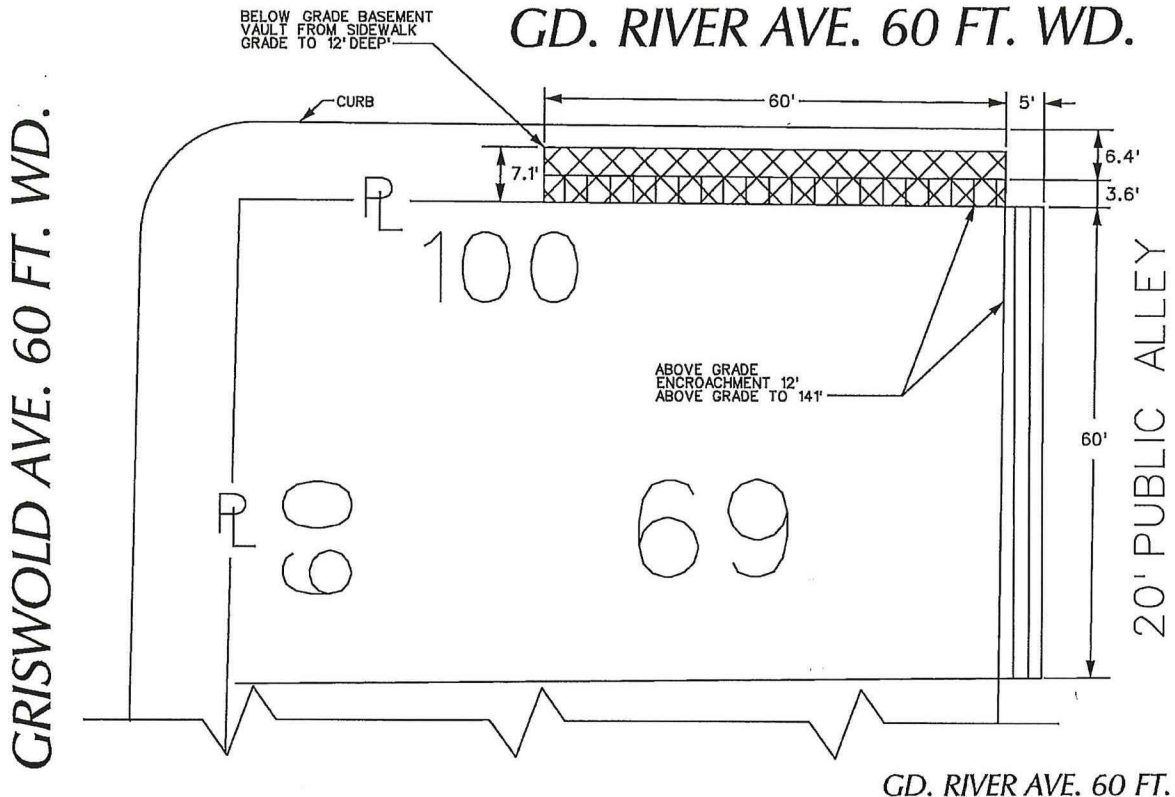

GD. RIVER AVE. 60 FT. WD.

DTE Energy objects to the requested outright vacation of a portion of Grand River across the front of the building (35 Grand River) due to the underground electrical infrastructure adjacent to the area.

DTE Energy has no objection to the requested encroachment into a portion of Grand River across the front of the building and a portion of the alley west of Woodward, south of Grand River provided owner assumes full responsibility of removal/installation of any architectural elements, signs, lighting, or canopies attached to the building in conflict with excavating equipment. In the event of any refusal, DTE Energy will not be responsible for any damages (Hold Harmless Clause)

 - **OUTRIGHT VACATION**  
 (With Underground Vault / Areaway)

 - **REQUEST ENCROACHMENT**  
 (With Architectural Elements, Signs, Lighting, Canopies)

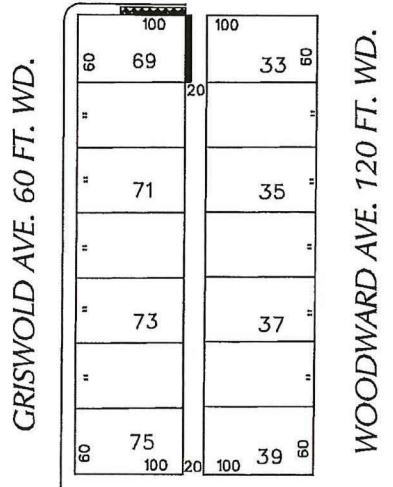

STATE ST. 60 FT. WD.  
 CARTO 28 B

(FOR OFFICE USE ONLY)

B				
A				
DESCRIPTION	DRWN	CHKD	APPD	DATE
REVISIONS				
DRAWN BY	WLW	CHECKED	KSM	
DATE	04-09-18	APPROVED		

OUTRIGHT VACATION  
 A PORTION OF GRAND RIVER AVE.  
 (With Underground Vault / Areaway)  
 REQUEST ENCROACHMENT  
 INTO GRAND RIVER AND A PORTION  
 OF THE NORTH/SOUTH PUBLIC ALLEY  
 AT 35 GRAND RIVER AVE.  
 (With Architectural Elements, Signs, Lighting and Canopies)

<b>CITY OF DETROIT</b>	
CITY ENGINEERING DEPARTMENT	
SURVEY BUREAU	
JOB NO.	01-01
DRWG. NO.	X 1771