

8

City of Detroit
City Engineering Division, Department of Public Works
Survey Bureau

NOTICE OF PROPOSED CHANGE IN PROPERTY

Date: 02/06/2018

Petition: x1770

- | | |
|--|--|
| <input type="checkbox"/> AT&T Telecommunication | <input type="checkbox"/> Berm Use |
| <input type="checkbox"/> Comcast Television (CATV) | <input type="checkbox"/> Conversion to Easement |
| <input type="checkbox"/> Detroit Edison (DTE) | <input type="checkbox"/> Dedication |
| <input type="checkbox"/> Fire Department | <input checked="" type="checkbox"/> Encroachment |
| <input type="checkbox"/> Great Lakes Water Authority | <input type="checkbox"/> Outright Vacation |
| <input type="checkbox"/> Land Bank Authority | <input type="checkbox"/> Temporary Closing |
| <input type="checkbox"/> Michcon (DTE) | |
| <input type="checkbox"/> Planning & Development Department | |
| <input type="checkbox"/> Public Lighting Authority | |
| <input type="checkbox"/> Public Lighting Department | |
| <input type="checkbox"/> Police Department | |
| <input type="checkbox"/> Solid Waste Division, DPW | |
| <input type="checkbox"/> Street Design Bureau, DPW | |
| <input checked="" type="checkbox"/> Street Maintenance Division, DPW | |
| <input type="checkbox"/> Traffic Engineering Division, DPW | |
| <input type="checkbox"/> Water and Sewerage Department | |
| <input type="checkbox"/> _____ | |

A petition drawing is attached. Property shown on the attached print is proposed to be changed as indicated. Kindly report (using the back of this sheet) the nature of your services, if any affected by the proposed change and the estimated costs of removing and rerouting such services (if necessary).

Please return one copy to City Engineering Division, DPW within two weeks of the submittal date. Retain one copy and print for you file.

Ron Brundidge, Director, Department of Public Works

By: Richard Doherty, CED DPW
City Engineer

TO: City Engineering Division, DPW
2 Woodward Ave., Suite 642
Detroit, Michigan 48226-3462
Survey Bureau: 313-224-3970

Petition: x1770

The proposed change in property (referred to on the other side of this sheet) would affect our services as follows:

- Not Involved
- Involved; but asking you to hold action on this petition until further notice.
- Involved; but no objections to the property change.
- Involved; objection to the property change.
- Involved; but no objections to the property change...provided as easement of the full width of the public right-of-way (street, alley or other public place) is reserved.
- Involved; the nature of our services and the estimated costs of removing and/or rerouting such services are:

DPW/SMD
(Utility or City Department)

Mr. Gessler R. Walker
By

Supervisor
Title

March 7, 2018
Date

313.224.0018
Area code – Telephone number

PETITION NO. 1770
 GRAND RIVER LLC
 C/O GIFFELS WEBSTER
 28 W. ADAMS, SUITE 1200
 DETROIT, MICHIGAN 48226
 C/O MICHAEL MARKS P.E.
 PHONE NO. 313 980-1469



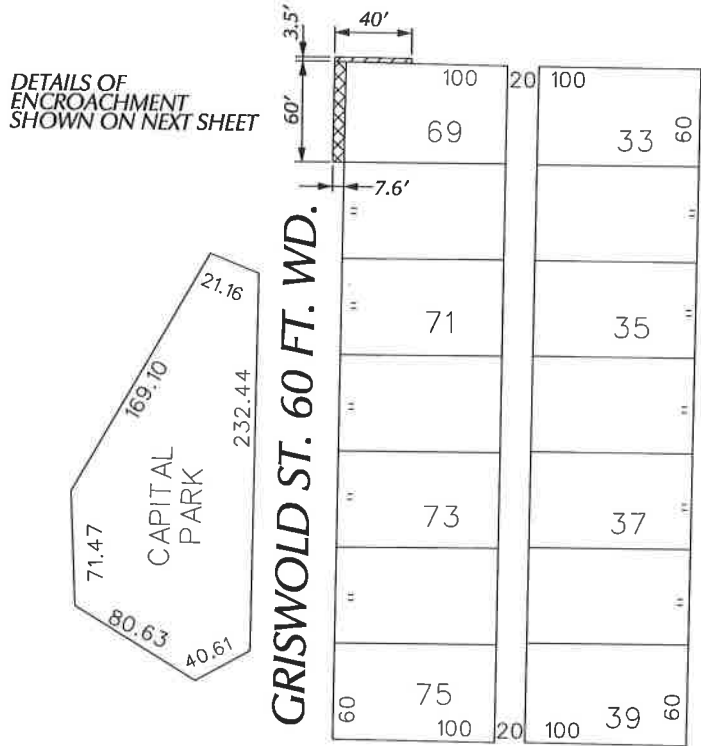

W. GRAND RIVER AVE. 60 FT. WD.



WOODWARD AVE. 120 FT. WD.

STATE ST. 60 FT. WD.

-  - REQUEST ENCROACHMENT
 (With Sidewalk Cafe at Grade and With Exterior Architectural Elements from 8 Feet Above Grade to 78 Feet Above Grade)
-  - REQUEST ENCROACHMENT
 (With Exterior Architectural Elements from 8 Feet Above Grade to 78 Feet Above Grade)

(FOR OFFICE USE ONLY)

CARTO 28 B

B						REQUEST ENCROACHMENT ON GRISWOLD ST. AND W. GRAND RIVER AVE. (For Sidewalk Cafe and Various Architectural Elements)	CITY OF DETROIT CITY ENGINEERING DEPARTMENT SURVEY BUREAU		
A									
DESCRIPTION		DRWN	CHKD	APPD	DATE			JOB NO.	01-01
REVISIONS								DRWG. NO.	X 1770
DRAWN BY		CHECKED							
DATE		APPROVED							
JK									
02-06-18									