

"REVISED"

City of Detroit

**City Engineering Division, Department of Public Works
Survey Bureau**

NOTICE OF PROPOSED CHANGE IN PROPERTY

Date: 10/02/2018

Petition: x1768

- | | |
|---|--|
| <input type="checkbox"/> AT&T Telecommunication | <input type="checkbox"/> Berm Use |
| <input type="checkbox"/> Comcast Television (CATV) | <input type="checkbox"/> Conversion to Easement |
| <input type="checkbox"/> Detroit Edison (DTE) | <input type="checkbox"/> Dedication |
| <input type="checkbox"/> Fire Department | <input checked="" type="checkbox"/> Encroachment |
| <input type="checkbox"/> Great Lakes Water Authority | <input type="checkbox"/> Outright Vacation |
| <input type="checkbox"/> Land Bank Authority | <input type="checkbox"/> Temporary Closing |
| <input type="checkbox"/> Michcon (DTE) | |
| <input checked="" type="checkbox"/> Planning & Development Department | |
| <input type="checkbox"/> Public Lighting Authority | |
| <input type="checkbox"/> Public Lighting Department | |
| <input type="checkbox"/> Police Department | |
| <input type="checkbox"/> Solid Waste Division, DPW | |
| <input type="checkbox"/> Street Design Bureau, DPW | |
| <input type="checkbox"/> Street Maintenance Division, DPW | |
| <input type="checkbox"/> Traffic Engineering Division, DPW | |
| <input type="checkbox"/> Water and Sewerage Department | |
| <input type="checkbox"/> _____ | |

A petition drawing is attached. Property shown on the attached print is proposed to be changed as indicated. Kindly report (using the back of this sheet) the nature of your services, if any affected by the proposed change and the estimated costs of removing and rerouting such services (if necessary).

Please return one copy to City Engineering Division, DPW within two weeks of the submittal date. Retain one copy and print for you file.

Ron Brundidge, Director, Department of Public Works

By: Richard Doherty, CED DPW
City Engineer

TO: City Engineering Division, DPW
2 Woodward Ave., Suite 642
Detroit, Michigan 48226-3462
Survey Bureau: 313-224-3970

Petition: x1768
"REVISED"

The proposed change in property (referred to on the other side of this sheet) would affect our services as follows:

- Not Involved
- Involved; but asking you to hold action on this petition until further notice.
- Involved; but no objections to the property change.
Revision makes the encroachment width 5' along Farmer between John R and E. Grand River. Previously, P&DD approved this petition 5/11/2018, before departmental policy on encroachments was to make them temporary (3-5 years).
- Involved; objection to the property change.
- Involved; but no objections to the property change...provided as easement of the full width of the public right-of-way (street, alley or other public place) is reserved.
- Involved; the nature of our services and the estimated costs of removing and/or rerouting such services are:

City of Detroit-Planning & Development Department

(Utility or City Department)



By

Greg Moot-Lead Planner-Office of Zoning Innovation

Title

Dec 21, '18

Date

313-224-1358

Area code – Telephone number

PETITION NO. 1768
 BEDROCK DETROIT
 C/O MANNIK SMITH GROUP
 65 CADILLAC SQUARE SUITE 3311
 DETROIT, MICHIGAN 48226
 C/O DAVID RZYI
 PHONE NO. 313 961-9500

"REVISED"



JOHN R. ST. 60 FT. WD.

WOODWARD AVE. 120 FT. WD.

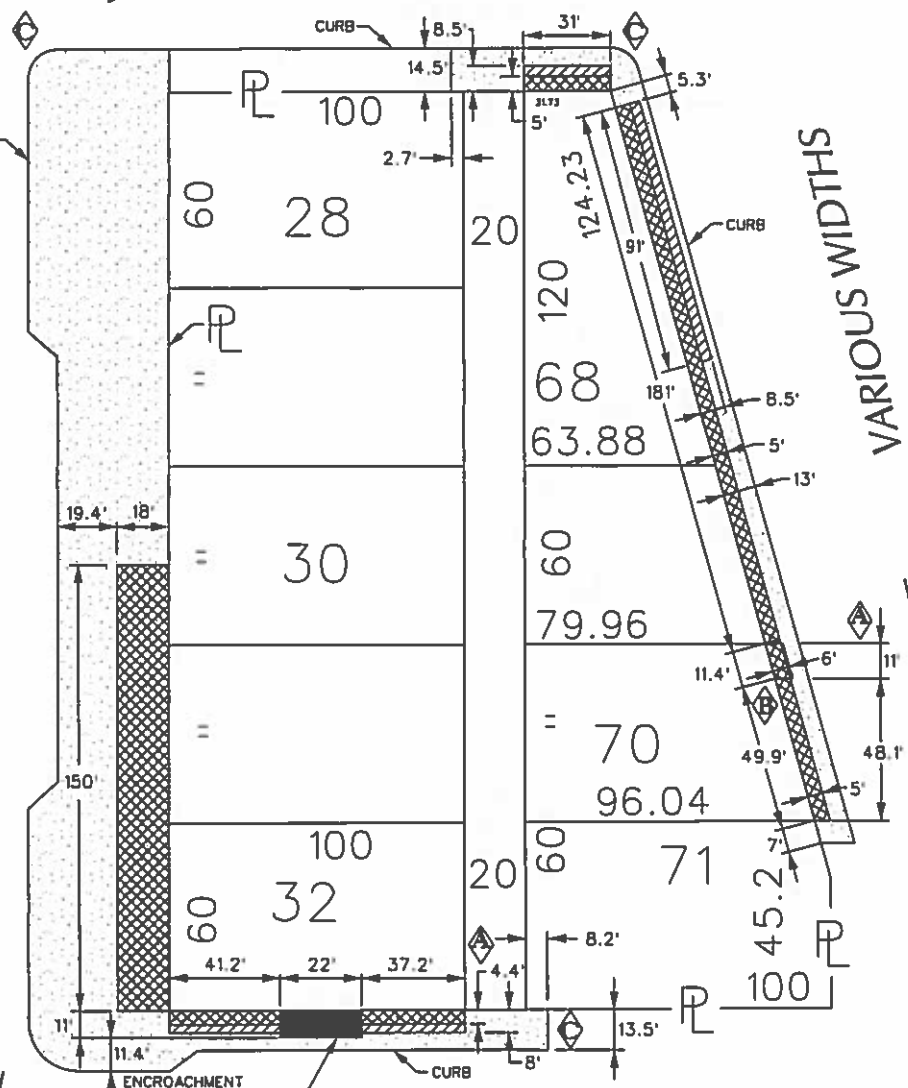

VARIOUS WIDTHS

FARMER ST.

E. GRAND RIVER AVE. 60 FT. WD.

- REQUEST ENCROACHMENT (With Tree, Tree Grates At and Below Grade)
- REQUEST ENCROACHMENT (With Hotel Entrance Awnings - 10' Above Grade)
- REQUEST ENCROACHMENT (With Exterior Lighting and Awnings - 8' Above Grade)
- REQUEST ENCROACHMENT (With Outdoor Seating, Planters, Exterior Lighting and Awnings - at Grade)

DESCRIPTION	DRWN	CHKD	APPD	DATE
REVISIONS				
C ADDING ENCROACHMENT AREA	WLW	KSM	KSM	10/2/18
B PULLING BACK THE AWNING ON FARMER	WLW	KSM	KSM	10/2/18
A MAINTAINING A 6' WALKWAY ALL AROUND	WLW	KSM	KSM	5/9/18
DRAWN BY	WLW	CHECKED	KSM	
DATE	04-05-18	APPROVED		

(FOR OFFICE USE ONLY)

CARTO 28 A

**REQUEST ENCROACHMENT
 VARIOUS LOCATIONS
 AT 1400 WOODWARD**
 (With Outdoor Seating, Planters, Exterior Lighting
 Hotel Entrance Awnings, Other Awnings
 and Encroachments)

CITY OF DETROIT	
CITY ENGINEERING DEPARTMENT	
SURVEY BUREAU	
JOB NO.	01-01
DRWG. NO.	X 1768

