



Monday, March 5, 2018

The Honorable City Council of the City of Detroit
Attn: Office of City Clerk
200 Coleman A. Young Municipal Center,
Detroit, MI 48226

Re: Revised Petition to Vacate Streets and Alleys / Detroit Mt. Elliott Real Estate LLC,

Ladies and Gentlemen:

Detroit Mt. Elliott Real Estate LLC ["Petitioner"], had submitted a petition to vacate on August 24, 2017 and was assigned #1761 to this request. Due to the complexity of the nature of this petition, DMERE (Petitioner) has revised this petition, reducing the scope of work under this request. A new petition will be submitted under separate cover to address streets and alleys south of the main building located at 8650 Mt. Elliott Street. This revised petition seeks only to vacate streets, alleys and related rights of way in the demised area as described below:

1. Newhall Street, from Mt. Elliott Street to the Conrail railroad easement [to the East];
2. Related public alleys between Newhall Street and Georgia Street and between Mt. Elliott Street and the Conrail railroad easement;

I have attached a drawing to more accurately describe these streets and alleys. All of the parcels adjoining the streets and alleys listed above are owned either by the Petitioner, or the City of Detroit.

This petition is to support a larger project to renovate the 313,000 square foot building located at 8650 Mt. Elliott Street for the benefit of ArcelorMittal Tailored Blanks Americas Corporation ["ArcelorMittal"], our tenant. This renovation is well under way, with occupancy scheduled next month. When completed, ArcelorMittal will operate a state-of-the-art manufacturing facility, serving all major automakers and tier one suppliers, and creating at least 120 jobs.

It should also be mentioned that the Petitioner and the City of Detroit are moving forward with a land swap in which the remaining parcels East of the railroad tracks owned by the City will be purchased by the Petitioner. Once completed, Petitioner will own all the property bounded by the Conrail Railroad tracks, Georgia Street, Miller Street, and Mt. Elliott Street.

Detroit • Cerritos, CA • New Orleans • Mobile • St. Louis • Chicago • Toledo

Detroit Mt. Elliott Real Estate LLC

Corporate Offices

2500 Enterprise Drive • Allen Park, MI 48101
tel: [734] 721-3334 • fax: [734] 721-3963

www.metroftz.com



The Petitioner requests the vacation of these streets and alleyways, to allow Petitioner's tenant, ArcelorMittal to provide more parking space for their employees, permit a separation of car and truck traffic [for safety], and permit expansion of the facility at a later date.

The Petitioner respectfully requests formal approval of these requests as soon as possible, to allow ArcelorMittal full use of the facility, and insure the safety of its employees.

It is my understanding that this issue should go to the City Council hearing for approval. Please forward this Petition to the appropriate city offices for review and approval by the City Council.

Please contact me with any questions, and provide me a copy of any notices regarding this petition. Thank you for your assistance.

Kind regards,

A handwritten signature in black ink, appearing to read 'Curt Felch', written over a horizontal line.

Curt Felch,
President,
Detroit Mt. Elliott Real Estate LLC

Cc: Will Tamminga, DEGC
Damon Jordan, DEGC
Orza Robertson, DEGC
Basil Cherian, City of Detroit, Mayor's Office

Detroit • Cerritos, CA • New Orleans • Mobile • St. Louis • Chicago • Toledo

Detroit Mt. Elliott Real Estate LLC

Corporate Offices

2500 Enterprise Drive • Allen Park, MI 48101
tel: [734] 721-3334 • fax: [734] 721-3963

www.metroftz.com

Detroit Mt Elliott Real Estate LLC (DMERE)
PETITION TO VACATE NEWHALL STREET, HEINTZ STREET
AND PUBLIC ALLEY WAYS



NF ENGINEERS
 CIVIL ENGINEERS
 LAND SURVEYORS
 LAND PLANNERS

17700 W. 46th Avenue
 Detroit, MI 48219
 Phone: (313) 487-1111
 Fax: (313) 487-1112

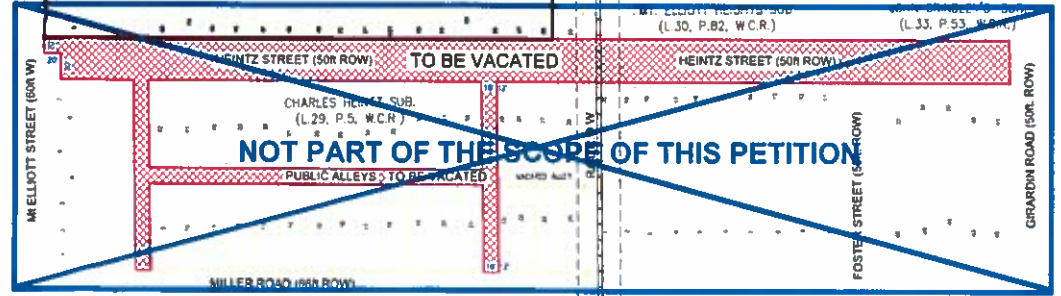
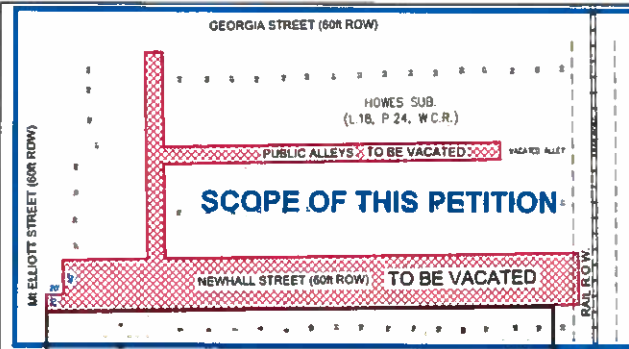

PROJECT
 Detroit Mt Elliott Site
 8650 Mt Elliott Avenue
 Detroit, Michigan

CLIENT
 Metro Information and Property Holdings
 2400 Encrypted Drive
 Allow Park, MI 48301

CONTACT:
 Mr. Charles Poon
 Phone: (734) 721-2134
 E-mail: cpoon@metroinfo.com

PROJECT LOCATION:
 Part of the Northwest 1/4 of Section 21, Town 8 South, Range 13 East, City of Detroit, Wayne County, Michigan

DATE:
 PREPARED VACATION AND ROAD B.C.W. SKETCH PLAN



DRAWN BY:
 J. Blumhagen

PROJECT APPROVED BY:
 J. Blumhagen

DATE:
 07/20/17

SCALE:
 1" = 50'