

Janice M. Winfrey  
City Clerk

City of Detroit  
OFFICE OF THE CITY CLERK

Vivian A. Hudson  
Deputy City Clerk

**AMENDED**

**DEPARTMENTAL REFERENCE COMMUNICATION**

*Monday, August 28, 2017*

**To:** *The Department or Commission Listed Below*

**From:** *Janice M. Winfrey, Detroit City Clerk*

---

The following petition is herewith referred to you for report and recommendation to the City Council.

In accordance with that body's directive, kindly return the same with your report in duplicate within four (4) weeks.

---

PLANNING AND DEVELOPMENT DEPARTMENT    DPW - CITY ENGINEERING DIVISION

**1761**    *Detroit Mt. Elliott Real Estate LLC, request to vacate various streets, alleys and right-of-ways in order to support a large 313,000 square foot project.*



Monday, March 5, 2018

The Honorable City Council of the City of Detroit  
Attn: Office of City Clerk  
200 Coleman A. Young Municipal Center,  
Detroit, MI 48226

Re: Revised Petition to Vacate Streets and Alleys / Detroit Mt. Elliott Real Estate LLC,

Ladies and Gentlemen:

Detroit Mt. Elliott Real Estate LLC ["Petitioner"], had submitted a petition to vacate on August 24, 2017 and was assigned #1761 to this request. Due to the complexity of the nature of this petition, DMERE (Petitioner) has revised this petition, reducing the scope of work under this request. A new petition will be submitted under separate cover to address streets and alleys south of the main building located at 8650 Mt. Elliott Street. This revised petition seeks only to vacate streets, alleys and related rights of way in the demised area as described below:

1. Newhall Street, from Mt. Elliott Street to the Conrail railroad easement [to the East];
2. Related public alleys between Newhall Street and Georgia Street and between Mt. Elliott Street and the Conrail railroad easement;

I have attached a drawing to more accurately describe these streets and alleys. All of the parcels adjoining the streets and alleys listed above are owned either by the Petitioner, or the City of Detroit.

This petition is to support a larger project to renovate the 313,000 square foot building located at 8650 Mt. Elliott Street for the benefit of ArcelorMittal Tailored Blanks Americas Corporation ["ArcelorMittal"], our tenant. This renovation is well under way, with occupancy scheduled next month. When completed, ArcelorMittal will operate a state-of-the-art manufacturing facility, serving all major automakers and tier one suppliers, and creating at least 120 jobs.

It should also be mentioned that the Petitioner and the City of Detroit are moving forward with a land swap in which the remaining parcels East of the railroad tracks owned by the City will be purchased by the Petitioner. Once completed, Petitioner will own all the property bounded by the Conrail Railroad tracks, Georgia Street, Miller Street, and Mt. Elliott Street.

Detroit • Cerritos, CA • New Orleans • Mobile • St. Louis • Chicago • Toledo

Detroit Mt. Elliott Real Estate LLC

Corporate Offices

2500 Enterprise Drive • Allen Park, MI 48101

tel: [734] 721-3334 • fax: [734] 721-3983

[www.metroftz.com](http://www.metroftz.com)



The Petitioner requests the vacation of these streets and alleyways, to allow Petitioner's tenant, ArcelorMittal to provide more parking space for their employees, permit a separation of car and truck traffic [for safety], and permit expansion of the facility at a later date.

The Petitioner respectfully requests formal approval of these requests as soon as possible, to allow ArcelorMittal full use of the facility, and insure the safety of its employees.

It is my understanding that this issue should go to the City Council hearing for approval. Please forward this Petition to the appropriate city offices for review and approval by the City Council.

Please contact me with any questions, and provide me a copy of any notices regarding this petition. Thank you for your assistance.

Kind regards,

A handwritten signature in black ink, appearing to read 'Curt Felch', written over a horizontal line.

Curt Felch,  
President,  
Detroit Mt. Elliott Real Estate LLC

Cc: Will Tamminga, DEGC  
Damon Jordan, DEGC  
Orza Robertson, DEGC  
Basil Cherian, City of Detroit, Mayor's Office

Detroit • Cerritos, CA • New Orleans • Mobile • St. Louis • Chicago • Toledo

Detroit Mt. Elliott Real Estate LLC

Corporate Offices

2500 Enterprise Drive • Allen Park, MI 48101

tel: [734] 721-3334 • fax: [734] 721-3963

[www.metroftz.com](http://www.metroftz.com)

**Detroit Mt Elliott Real Estate LLC (DMERE)  
 PETITION TO VACATE NEWHALL STREET, HEINTZ STREET  
 AND PUBLIC ALLEY WAYS**



**NF ENGINEERS**  
 CIVIL ENGINEERS  
 LAND SURVEYORS  
 LAND PLANNERS

NOVAK & FRAZEE ENGINEERS  
 4677 WOODWARD AVE.  
 FARMING, MI 48342-3032  
 TEL: (248) 332-7714  
 FAX: (248) 332-8277

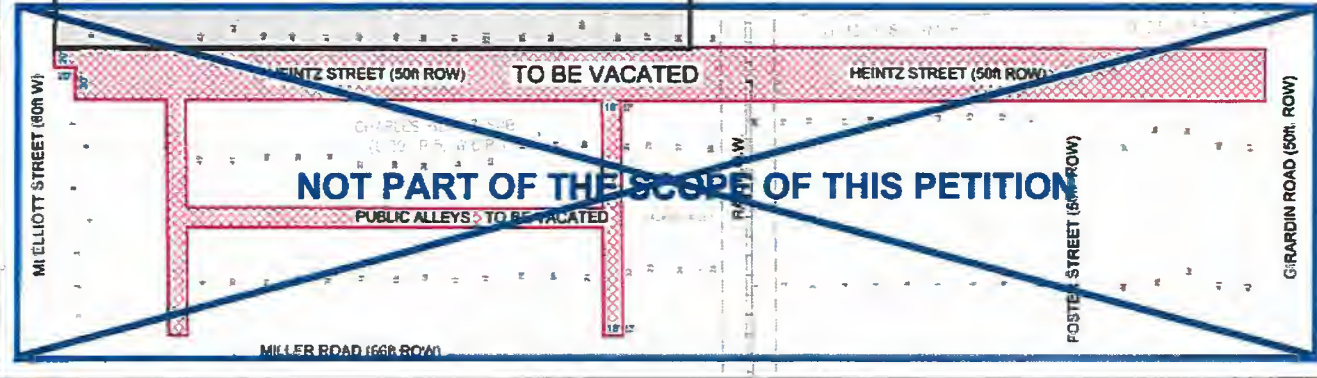
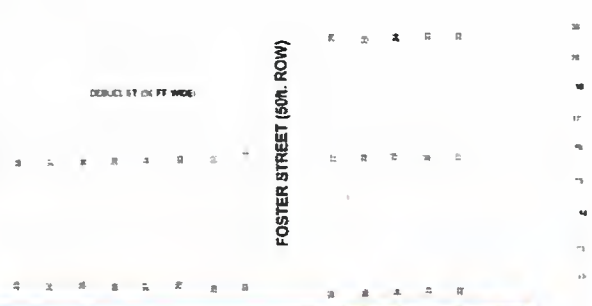
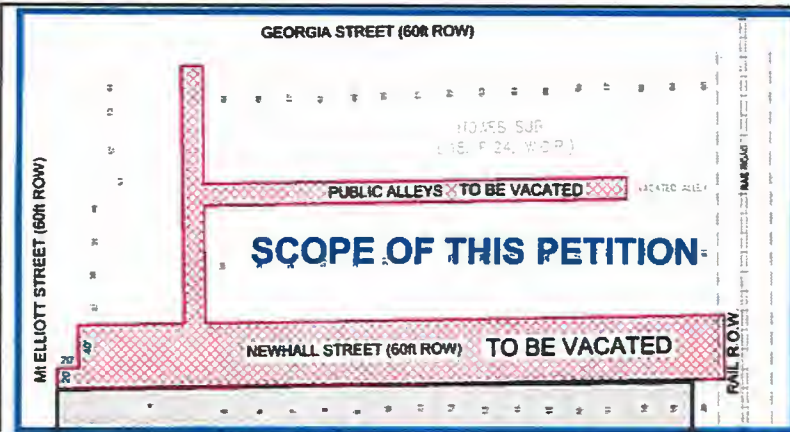

**PROJECT**  
 Detroit Mt. Elliott Site  
 860 Mt. Elliott Avenue  
 Detroit, Michigan

**CLIENT**  
 Metro International  
 Property Holdings  
 2500 East Green Drive  
 Allen Park, MI 48101

**Contact:**  
 Mr. Charles Pace  
 Phone: (313) 721-3334  
 Email: cpace@metrointl.com

**PROJECT LOCATION**  
 Part of the Northwest 1/4 of  
 Section 21, Town 1 South,  
 Range 12 East,  
 City of Detroit,  
 Wayne County, Michigan

**TITLE**  
 PROPOSED VACATION  
 OF ROAD P.L.S. BY  
 SKETCH PLAN



**DATE**  
 08/15/2017

**SCALE**  
 1" = 30'

**DRAWN BY**  
 J. Klammerberger

**DESIGNED BY**  
 J. Klammerberger

**PROJECT MANAGER**  
 J. Klammerberger

**DATE**  
 08/15/2017

**SHEET NO.**  
 1591

**SHEET TOTAL**  
 1 of 1



# AMENDED



Thursday, August 24, 2017

The Honorable City Council of the City of Detroit  
Attn: Office of City Clerk  
200 Coleman A. Young Municipal Center,  
Detroit, MI 48226

Re: Petition to Vacate Streets and Alleys / Detroit Mt. Elliott Real Estate LLC

Ladies and Gentlemen:

2017 AUG 25 A 11: 03  
OFFICE OF THE  
DETROIT CITY CLERK

Detroit Mt. Elliott Real Estate LLC ["Petitioner"], hereby requests the vacation of the following streets, alleys and related rights of way:

1. Newhall Street, from Mt. Elliott Street to the Conrail railroad easement [to the East];
2. Heintz Street, from Mt. Elliott Street to Girardin Road;
3. Related public alleys between Miller Road and Georgia Street and Newhall Street, and between Mt. Elliott Street and the Conrail railroad easement;

I have attached a drawing to more accurately describe these streets and alleys. All of the parcels adjoining the streets and alleys listed above are owned either by the Petitioner, or the City of Detroit.

This petition is to support a larger project to renovate the 313,000 square foot building located at 8650 Mt. Elliott Street for the benefit of ArcelorMittal Tailored Blanks Americas Corporation ["ArcelorMittal"], our tenant. This renovation is well under way, with occupancy scheduled next month. When completed, ArcelorMittal will operate a state-of-the-art manufacturing facility, serving all major automakers and tier one suppliers, and creating at least 120 jobs.

It should also be mentioned that the Petitioner and the City of Detroit are moving forward with a land swap in which the remaining parcels East of the railroad tracks owned by the City will be purchased by the Petitioner. Once completed, Petitioner will own all the property bounded by the Conrail Railroad tracks, Georgia Street, Miller Street, and Mt. Elliott Street.

Detroit • Cerritos, CA • New Orleans • Mobile • St. Louis • Chicago • Toledo

Detroit Mt. Elliott Real Estate LLC

Corporate Offices

2500 Enterprise Drive • Allen Park, MI 48101

tel: [734] 721-3334 • fax: [734] 721-3963

[www.metroftz.com](http://www.metroftz.com)



The Petitioner requests the vacation of these streets and alleyways, to allow Petitioner's tenant, ArcelorMittal to provide more parking space for their employees, permit a separation of car and truck traffic [for safety], and permit expansion of the facility at a later date.

The Petitioner respectfully requests formal approval of these requests as soon as possible, to allow ArcelorMittal full use of the facility, and insure the safety of its employees.

It is my understanding that this issue should go to the City Council hearing for approval. Please forward this Petition to the appropriate city offices for review and approval by the City Council.

Please contact me with any questions, and provide me a copy of any notices regarding this petition. Thank you for your assistance.

Kind regards,

A handwritten signature in black ink, appearing to read 'Curt Felch', written over a horizontal line.

Curt Felch,  
President,  
Detroit Mt. Elliott Real Estate LLC

Cc: Will Tamminga, DEGC  
Damon Jordan, DEGC  
Orza Robertson, DEGC  
Basil Cherian, City of Detroit, Mayor's Office

Detroit • Cerritos, CA • New Orleans • Mobile • St. Louis • Chicago • Toledo

Detroit Mt. Elliott Real Estate LLC

Corporate Offices

2500 Enterprise Drive • Allen Park, MI 48101

tel: [734] 721-3334 • fax: [734] 721-3963

[www.metroftz.com](http://www.metroftz.com)



Thursday, August 24, 2017

The Honorable City Council of the City of Detroit  
Attn: Office of City Clerk  
200 Coleman A. Young Municipal Center,  
Detroit, MI 48226

Re: Petition to Vacate Streets and Alleys / Detroit Mt. Elliott Real Estate LLC

Ladies and Gentlemen:

2017 AUG 25 A 11:04  
OFFICE OF THE  
DETROIT CITY CLERK

Detroit Mt. Elliott Real Estate LLC ["Petitioner"], hereby requests the vacation of the following streets, alleys and related rights of way:

1. Newhall Street, from Mt. Elliott Street to the Conrail railroad easement [to the East];
2. Heintz Street, from Mt. Elliott Street to Girardin Road;
3. Related public alleys between Miller Road and Georgia Street and Newhall Street, and between Mt. Elliott Street and the Conrail railroad easement;

I have attached a drawing to more accurately describe these streets and alleys. All of the parcels adjoining the streets and alleys listed above are owned either by the Petitioner, or the City of Detroit.

This petition is to support a larger project to renovate the 313,000 square foot building located at 8650 Mt. Elliott Street for the benefit of ArcelorMittal Tailored Blanks Americas Corporation ["ArcelorMittal"], our tenant. This renovation is well under way, with occupancy scheduled next month. When completed, ArcelorMittal will operate a state-of-the-art manufacturing facility, serving all major automakers and tier one suppliers, and creating at least 120 jobs.

It should also be mentioned that the Petitioner and the City of Detroit are moving forward with a land swap in which the remaining parcels East of the railroad tracks owned by the City will be purchased by the Petitioner. Once completed, Petitioner will own all the property bounded by the Conrail Railroad tracks, Georgia Street, Miller Street, and Mt. Elliott Street.

Detroit • Cerritos, CA • New Orleans • Mobile • St. Louis • Chicago • Toledo

Detroit Mt. Elliott Real Estate LLC

Corporate Offices

2500 Enterprise Drive • Allen Park, MI 48101  
tel: [734] 721•3334 • fax: [734] 721•3963

[www.metroftz.com](http://www.metroftz.com)



The Petitioner requests the vacation of these streets and alleyways, to allow Petitioner's tenant, ArcelorMittal to provide more parking space for their employees, permit a separation of car and truck traffic [for safety], and permit expansion of the facility at a later date.

The Petitioner respectfully requests formal approval of these requests as soon as possible, to allow ArcelorMittal full use of the facility, and insure the safety of its employees.

It is my understanding that this issue should go to the City Council hearing for approval. Please forward this Petition to the appropriate city offices for review and approval by the City Council.

Please contact me with any questions, and provide me a copy of any notices regarding this petition. Thank you for your assistance.

Kind regards,

A handwritten signature in black ink, appearing to read 'Curt Felch', written over a horizontal line.

Curt Felch,  
President,  
Detroit Mt. Elliott Real Estate LLC

Cc: Will Tamminga, DEGC  
Damon Jordan, DEGC  
Orza Robertson, DEGC  
Basil Cherian, City of Detroit, Mayor's Office

Detroit • Cerritos, CA • New Orleans • Mobile • St. Louis • Chicago • Toledo

Detroit Mt. Elliott Real Estate LLC

Corporate Offices

2500 Enterprise Drive • Allen Park, MI 48101

tel: [734] 721-3334 • fax: [734] 721-3963

[www.metroftz.com](http://www.metroftz.com)



**Detroit Mt Elliott Real Estate LLC (DMERE)  
PETITION TO VACATE NEWHALL STREET, HEINTZ STREET  
AND PUBLIC ALLEY WAYS**



**NF**  
**ENGINEERS**  
CIVIL ENGINEERS  
LAND SURVEYORS  
LAND PLANNERS

NEWMARK & BEATTI ENGINEERS  
4677 WOODWARD AVE  
PO BOX 11000, MI 48217-5012  
TEL: (313) 481-1200  
FAX: (313) 481-0237

1584

SUBJECT

Detroit Mt. Elliott Site  
6600 Mt. Elliott Avenue  
Detroit, Michigan

CLIENT

Metro International  
Property Holdings  
2500 Enterprise Drive  
Allen Park, MI 48101

CONTACT:

Mr. Charles Pace  
Phone: (734) 721-3334  
Email: [cpace@metrointl.com](mailto:cpace@metrointl.com)

PROPERTY LOCATION

Part of the Northwest 1/4 of  
Section 21, Town 1 South,  
Range 12 East,  
City of Detroit,  
Wayne County, Michigan

SHEET

PROPOSED VACATION  
OF ROAD R.O.W.  
SKETCH PLAN



DATE PLOTTED

DRAWN BY

J. Knaulberger  
CHECKED BY

PROJECT MANAGER

J. Knaulberger

DATE

07/10/2017

SCALE

1" = 40'

DATE PLOTTED

07/10/2017

SHEET NO.

3591

1 of 1

