

TO: City Engineering Division, DPW
2 Woodward Ave., Suite 642
Detroit, MI 48226-3462
Survey Bureau: 313-224-3970

Petition No. 1737REV

The proposed change in property (referred to above) would affect our services as follows:

- () Not Involved.
- () Involved; but asking you to hold action on this petition until further notice.
- () Involved; the nature of our services, and the estimated costs of removing and/or rerouting such services are:
- (X) Involved, have no objection to the requested encroachment a portion of the east/west public alley (With Emergency Blue Phone, Duckwork, Exhaust Fan and Bollards) and into E. Fort and Brush St. (With Architectural Elements, Signs, Lighting, Canopies, etc...8 1/2' above Grade to Top of Building) at 407 E. Fort St. as shown on drawing no. x1737 dated 10/03/2017 and revised on 1/17/2018 provided that 100% signatures of abutting property owners are secured.

Traffic Engineering Division - DPW
(Utility or City Department)

Ashok Patel
By

Sunny Jacob

City Traffic Engineer
Title

January 25, 2017
Date

313 224-1610
Area code-Telephone number

MA/ma

PETITION NO. 1737
 GIFFELS WEBSTER
 28 W. ADAMS, SUITE 1200
 DETROIT, MICHIGAN 48226
 C/O MICHAEL MARKS P.E.
 PHONE NO. 313 962-4442



E. LAFAYETTE AVE. 60 FT. WD.

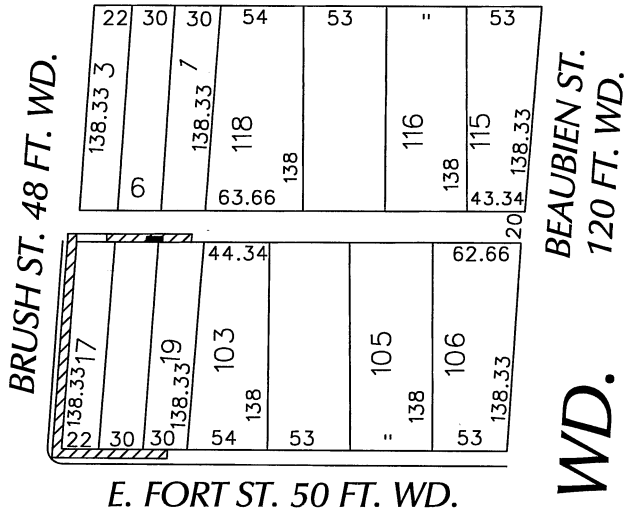

E. FORT ST. 50 FT. WD.

"REVISED"

BRUSH ST. 48 FT. WD.

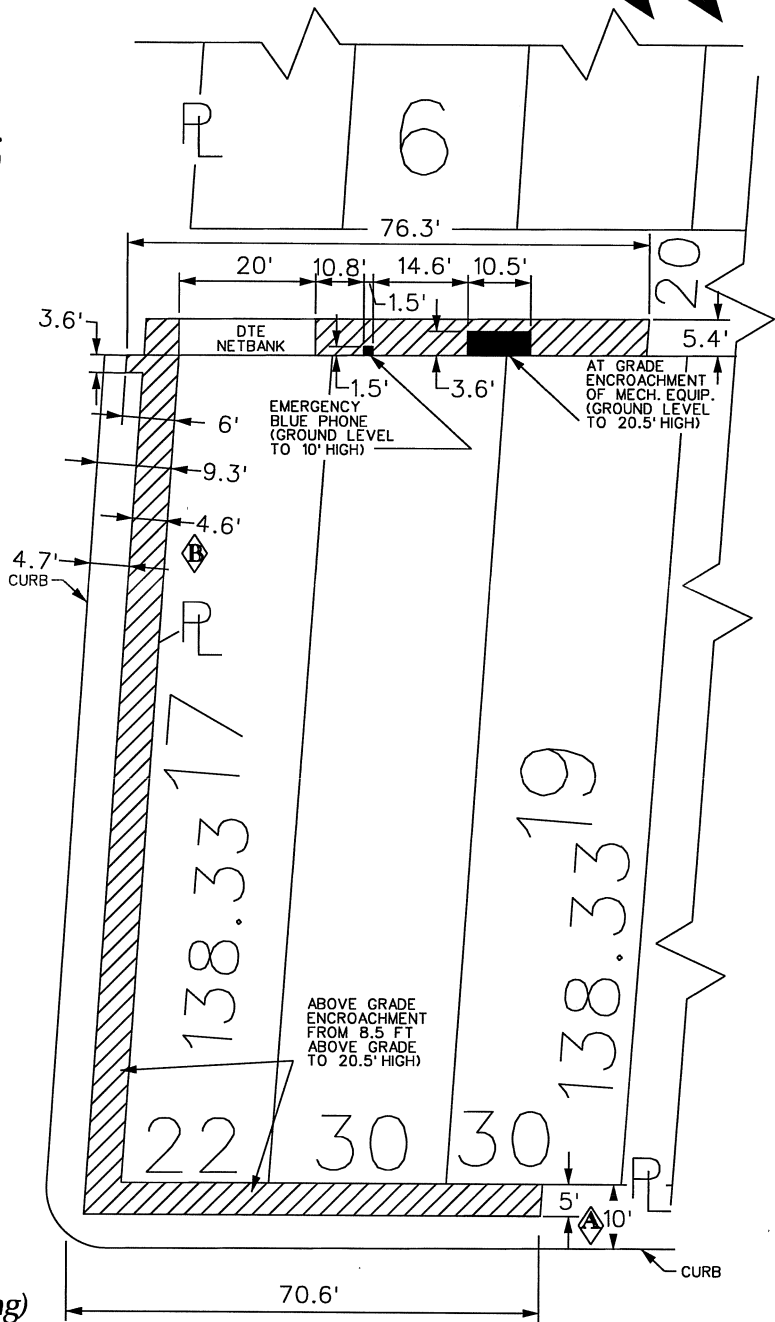

E. FORT ST. 50 FT. WD.

- REQUEST ENCROACHMENT (With Architectural Elements, Signs, Lighting, Canopies, etc... 8.5' Above Grade to Top of Building)
- REQUEST ENCROACHMENT (With Emergency Blue Phone, Duckwork, Exhaust Fan and Bollards)

(FOR OFFICE USE ONLY)

CARTO 28 F

B	REDUCING ENCROACHMENT ON BRUSH ST.	WLW	KSM	KSM	1/17/18
A	REDUCING ENCROACHMENT ON E. FORT ST.	WLW	KSM	KSM	1/17/18
DESCRIPTION		DRWN	CHKD	APPD	DATE
REVISIONS					
DRAWN BY		CHECKED			
DATE		APPROVED			
10-03-17					

REQUEST ENCROACHMENT
 A PORTION OF THE EAST/WEST PUBLIC ALLEY
 (With Emergency Blue Phone, Duckwork,
 Exhaust Fan and Bollards)
 AND INTO E. FORT AND BRUSH ST.
 (With Architectural Elements, Signs, Lighting,
 Canopies, etc... 8 1/2' Above Grade to Top of Building)
 AT 407 E. FORT ST.

CITY OF DETROIT	
CITY ENGINEERING DEPARTMENT	
SURVEY BUREAU	
JOB NO.	01-01
DRWG. NO.	X 1737