

City of Detroit  
**City Engineering Division, Department of Public Works**  
**Survey Bureau**

**NOTICE OF PROPOSED CHANGE IN PROPERTY**

Date: 01/03/2018

Petition: x1683

- |  |  |
|--|--|
| <input type="checkbox"/> AT&T Telecommunication            | <input type="checkbox"/> Berm Use                |
| <input type="checkbox"/> Comcast Television (CATV)         | <input type="checkbox"/> Conversion to Easement  |
| <input type="checkbox"/> Detroit Edison (DTE)              | <input type="checkbox"/> Dedication              |
| <input type="checkbox"/> Fire Department                   | <input checked="" type="checkbox"/> Encroachment |
| <input type="checkbox"/> Great Lakes Water Authority       | <input type="checkbox"/> Outright Vacation       |
| <input type="checkbox"/> Land Bank Authority               | <input type="checkbox"/> Temporary Closing       |
| <input checked="" type="checkbox"/> Michcon (DTE)          |  |
| <input type="checkbox"/> Planning & Development Department |  |
| <input type="checkbox"/> Public Lighting Authority         |  |
| <input type="checkbox"/> Public Lighting Department        |  |
| <input type="checkbox"/> Police Department                 |  |
| <input type="checkbox"/> Solid Waste Division, DPW         |  |
| <input type="checkbox"/> Street Design Bureau, DPW         |  |
| <input type="checkbox"/> Street Maintenance Division, DPW  |  |
| <input type="checkbox"/> Traffic Engineering Division, DPW |  |
| <input type="checkbox"/> Water and Sewerage Department     |  |
| <input type="checkbox"/> _____                             |  |

A petition drawing is attached. Property shown on the attached print is proposed to be changed as indicated. Kindly report (using the back of this sheet) the nature of your services, if any affected by the proposed change and the estimated costs of removing and rerouting such services (if necessary).

Please return one copy to City Engineering Division, DPW within two weeks of the submittal date. Retain one copy and print for you file.

Ron Brundidge, Director, Department of Public Works

By: Richard Doherty, CED DPW  
City Engineer

**TO: City Engineering Division, DPW  
2 Woodward Ave., Suite 642  
Detroit, Michigan 48226-3462  
Survey Bureau: 313-224-3970**

**Petition: x1683**

The proposed change in property (referred to on the other side of this sheet) would affect our services as follows:

- Not Involved
  
- Involved; but asking you to hold action on this petition until further notice.
  
- Involved; but no objections to the property change.
  
- Involved; objection to the property change.
  
- Involved; but no objections to the property change...~~provided as easement of the full width of the public right of way (street, alley or other public place) is reserved.~~  
provided the proposed use does not hinder or impede the operation,  
maintenance or replacement of DTE Gas Company facilities.
  
- Involved; the nature of our services and the estimated costs of removing and/or rerouting such services are:  
  
Gas service to 2771 Woodward Ave runs thru this area. Cost to reroute service, if required, has been determined. See attached map for approximate service location.

DTE Gas Company  
(Utility or City Department)

David L Gabrielse  
By

Drafter  
Title

1/4/2018  
Date

313-235-6823  
Area code – Telephone number

**TO: City Engineering Division, DPW  
2 Woodward Ave., Suite 642  
Detroit, Michigan 48226-3462  
Survey Bureau: 313-224-3970**

**Petition: x1683**

The proposed change in property (referred to on the other side of this sheet) would affect our services as follows:

- Not Involved
- Involved; but asking you to hold action on this petition until further notice.
- Involved; but no objections to the property change.
- Involved; objection to the property change.
- Involved; but no objections to the property change...~~provided as easement of the full width of the public right of way (street, alley or other public place) is reserved.~~  
provided the proposed use does not hinder or impede the operation, maintenance or replacement of DTE Gas Company facilities.
- Involved; the nature of our services and the estimated costs of removing and/or rerouting such services are:  
Gas service to 2771 Woodward Ave runs thru this area. Cost to reroute service, if required, has been determined. See attached map for approximate service location.

DTE Gas Company  
(Utility or City Department)

David L Gabrielse  
By

Drafter  
Title

1/4/2018  
Date

313-235-6823  
Area code – Telephone number



**STATE LAW ACT 174  
3 WORKING DAYS  
BEFORE YOU DIG  
DIAL TOLL FREE  
1-800-482-7171 OR 811**

**DTE Energy's  
Gas Leak Emergency  
Phone Number  
1-800-947-5000**

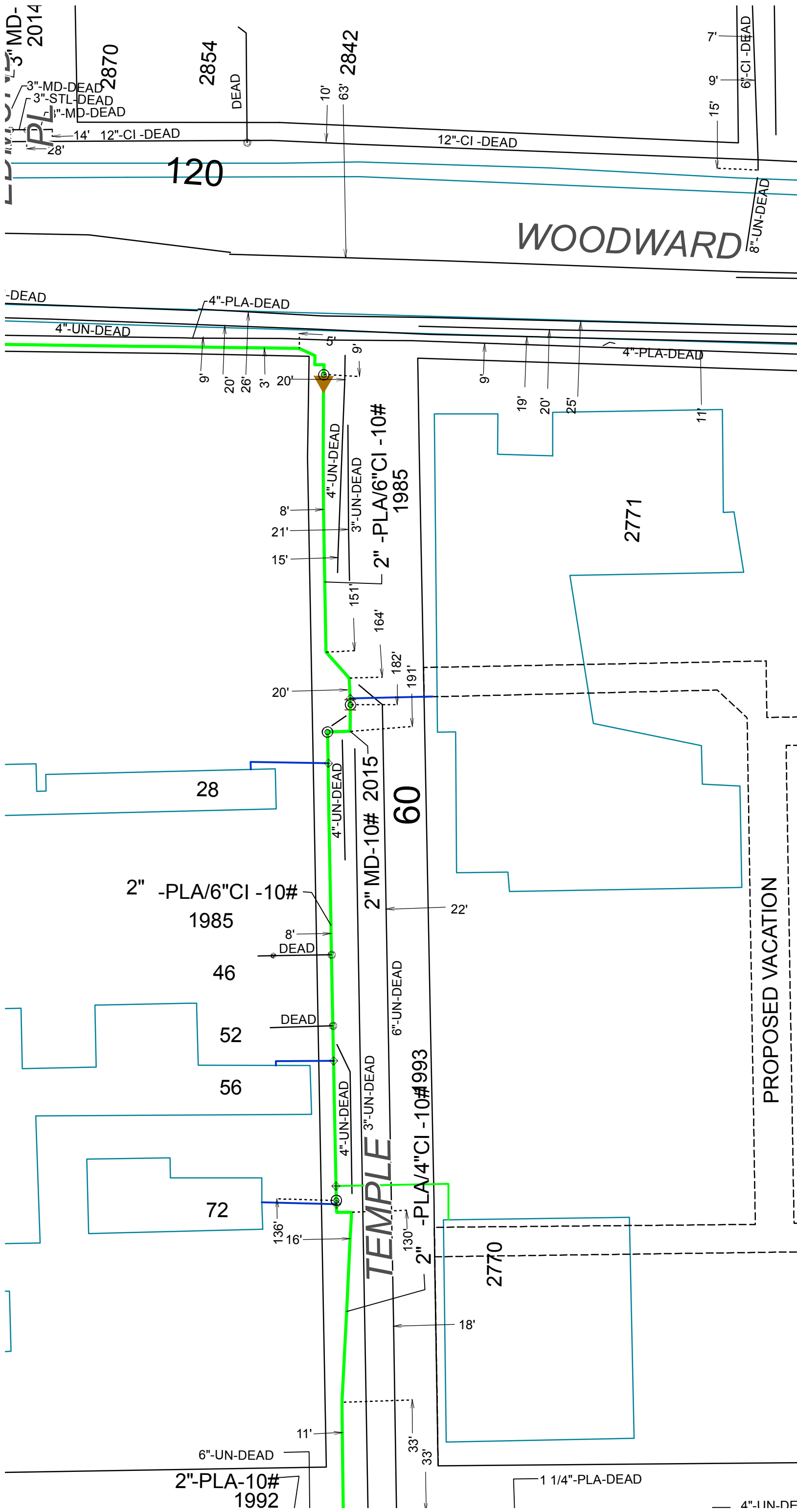

DTE ENERGY GAS COMPANY FACILITIES AS SHOWN  
 INDICATE APPROXIMATE LOCATIONS ONLY AS DISCLOSED BY THE  
 COMPANY'S RECORDS AND NO GUARANTEE IS MADE EITHER AS  
 TO COMPLETENESS OR ACCURACY.

DTE ENERGY GAS COMPANY  
 January 04, 2018  
 SIGNED: *David L. Gabrielle*

CONSTRUCTION PLANS MADE SUBSEQUENT TO THIS DATE SHOULD  
 BE CHECKED WITH THE DTE ENERGY GAS COMPANY

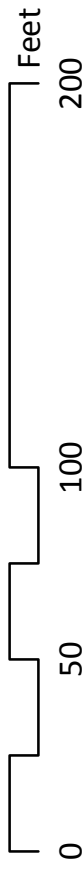
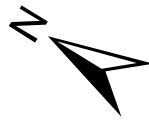

STATE LAW ACT 174  
 3 WORKING DAYS  
 BEFORE YOU DIG  
 DIAL TOLL FREE  
 1-800-482-7171 OR 811