

PETITION NO. 1683
 WAYNE STATE UNIVERSITY
 5454 CASS AVE.
 DETROIT, MICHIGAN 48202
 C/O HARRY E. WYATT JR.
 PHONE NO. 313 577-4301

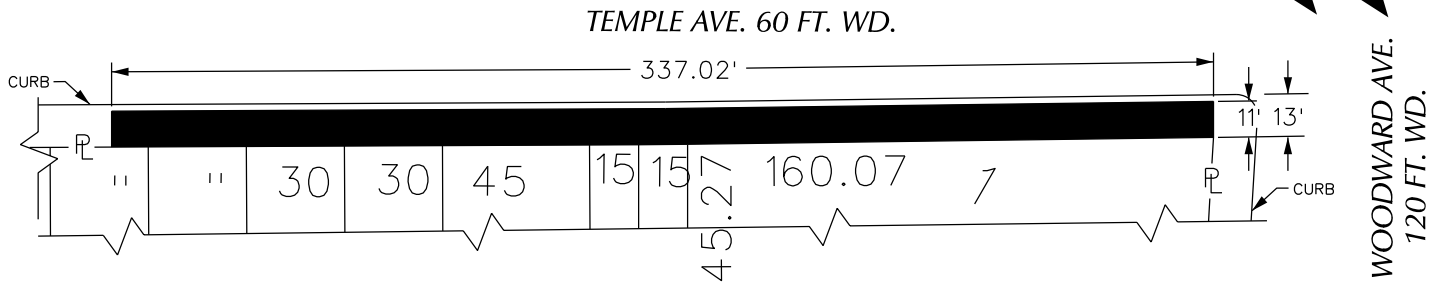

TEMPLE AVE. 60 FT. WD.

PARK AVE. 60 FT. WD.

30	13	105	15	30	=	=	=	=	30	30	45	15	15	45.27	160.07	7	
"	"	"	VAC														
"	15			12		10		8		6	5						
30	17						75										
31.1	18			171.10													
31.1	13				VAC												
31				176.10	20												
"	15					10		76									
"						9											
"	17						7										
"	17																
31	18	105	15														
				176.10	20												
						12											
							10										
							9										
								76									

SPROAT ST. 50 FT. WD.

EASEMENT

WOODWARD AVE. 120 FT. WD.



- REQUEST ENCROACHMENT
 (With Planters, Trees, Shrubs, Railings, Bike Racks,
 Street Lights, Removable Bollards, Pole w/Blue Light
 Security Phone, Cameras and Warning Strip)

(FOR OFFICE USE ONLY)

CARTO 29 E

B						REQUEST ENCROACHMENT INTO TEMPLE AT 2771 WOODWARD AVE.			CITY OF DETROIT CITY ENGINEERING DEPARTMENT SURVEY BUREAU	
A					(With Planters, Trees, Shrubs, Railings, Bike Racks, Street Lights, Removable Bollards, Pole w/Blue Light Security Phone, Cameras and Warning Strip)					
DESCRIPTION		DRWN	CHKD	APPD				DATE		
REVISIONS										
DRAWN BY		WLW				CHECKED				
DATE		01-03-18				APPROVED				