

GLWA GPET 1679

City of Detroit
City Engineering Division, Department of Public Works
Survey Bureau

NOTICE OF PROPOSED CHANGE IN PROPERTY

Date: 08/01/2017

Petition: x1664

- | | |
|---|--|
| <input type="checkbox"/> AT&T Telecommunication | <input type="checkbox"/> Berm Use |
| <input type="checkbox"/> Comcast Television (CATV) | <input type="checkbox"/> Dedication |
| <input type="checkbox"/> Detroit Edison (DTE) | <input type="checkbox"/> Encroachment |
| <input type="checkbox"/> Fire Department | <input type="checkbox"/> Outright Vacation |
| <input checked="" type="checkbox"/> Great Lakes Water Authority | <input type="checkbox"/> Temporary Closing |
| <input type="checkbox"/> Land Bank Authority | <input checked="" type="checkbox"/> Vacate to Easement |
| <input type="checkbox"/> Michcon (DTE) | |
| <input type="checkbox"/> Planning & Development Department | |
| <input type="checkbox"/> Public Lighting Authority | |
| <input type="checkbox"/> Public Lighting Department | |
| <input type="checkbox"/> Police Department | |
| <input type="checkbox"/> Solid Waste Division, DPW | |
| <input type="checkbox"/> Street Design Bureau, DPW | |
| <input type="checkbox"/> Street Maintenance Division, DPW | |
| <input type="checkbox"/> Traffic Engineering Division, DPW | |
| <input type="checkbox"/> Water and Sewerage Department | |
| <input type="checkbox"/> _____ | |

A petition drawing is attached. Property shown on the attached print is proposed to be changed as indicated. Kindly report (using the back of this sheet) the nature of your services, if any affected by the proposed change and the estimated costs of removing and rerouting such services (if necessary).

Please return one copy to City Engineering Division, DPW within two weeks of the submittal date. Retain one copy and print for you file.

Ron Brundidge, Director, Department of Public Works

By: Richard Doherty, CED DPW
City Engineer

**TO: City Engineering Division, DPW
2 Woodward Ave., Suite 642
Detroit, Michigan 48226-3462
Survey Bureau: 313-224-3970**

Petition: x1664

The proposed change in property (referred to on the other side of this sheet) would affect our services as follows:

- Not Involved
- Involved; but asking you to hold action on this petition until further notice.
- Involved; but no objections to the property change.
- Involved; objection to the property change.
- Involved; but no objections to the property change...provided as easement of the full width of the public right-of-way (street, alley or other public place) is reserved.
- Involved; the nature of our services and the estimated costs of removing and/or rerouting such services are:

CILWA
(Utility or City Department)

DAVE ECHOLS
By

ET II
Title

09-19-17
Date

(313) 267-4857
Area code – Telephone number

PETITION NO. 1664
 STEFANIE POLK
 15489 ALDEN AVE.
 DETROIT, MICHIGAN 48238
 PHONE NO. 313 461-5759



MIDLAND AVE. 50 FT. WD.

100M

PARKSIDE AVE. 50 FT. WD.

ALDEN AVE. 50 FT. WD.

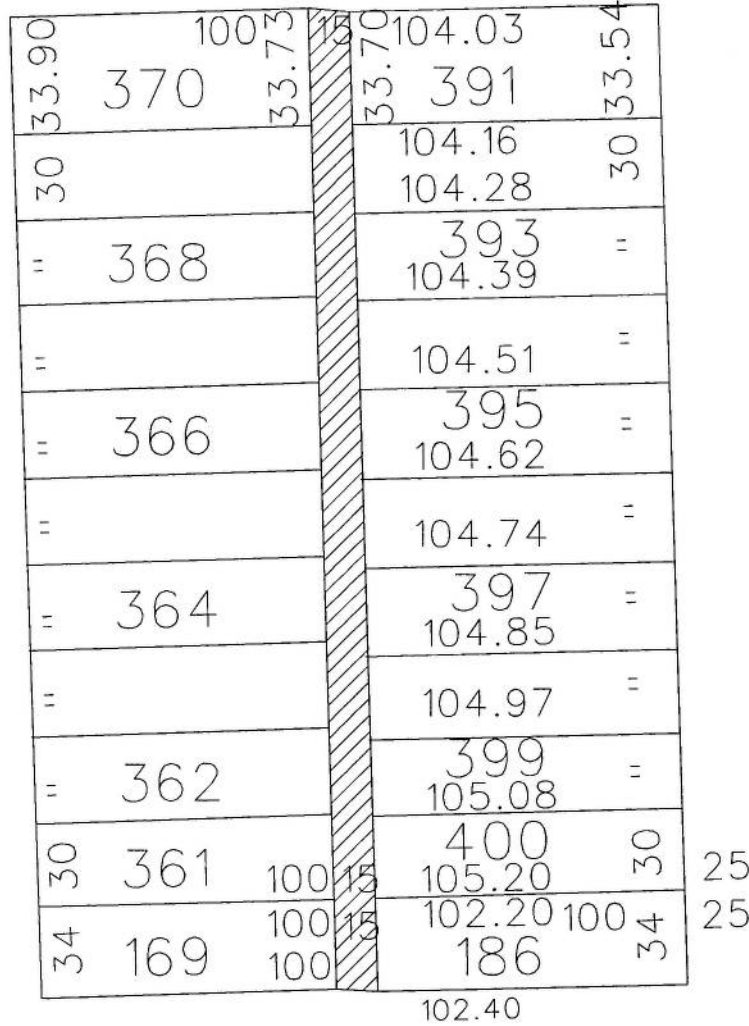

JOHN C. LODGE EXPRESSWAY



- VACATE TO EASEMENT

(FOR OFFICE USE ONLY)

CARTO 25 D

B						REQUEST TO VACATE TO EASEMENT THE NORTH/SOUTH PUBLIC ALLEY, 15 FT. WD. IN THE BLOCK BOUND BY PARKSIDE, MIDLAND, ALDEN AVE. AND JOHN C. LODGE FWY.	CITY OF DETROIT CITY ENGINEERING DEPARTMENT SURVEY BUREAU	
A					JOB NO. 01-01			
DESCRIPTION		DRWN	CHKD	APPD				DATE
DRAWN BY		REVISIONS						
DATE		CHECKED		APPROVED				