

PETITION NO. 1664
 STEFANIE POLK
 15489 ALDEN AVE.
 DETROIT, MICHIGAN 48238
 PHONE NO. 313 461-5759



MIDLAND AVE. 50 FT. WD.

100M

PARKSIDE AVE. 50 FT. WD.

ALDEN AVE. 50 FT. WD.

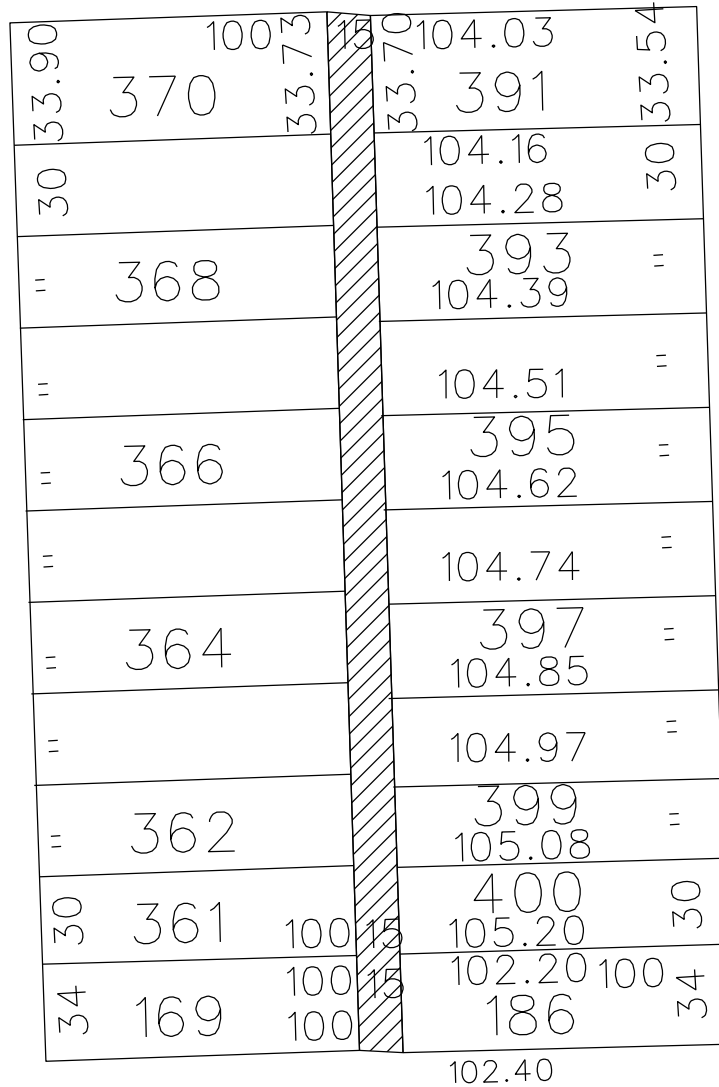

JOHN C. LODGE EXPRESSWAY

- VACATE TO EASEMENT

(FOR OFFICE USE ONLY)

CARTO 25 D

B					
A					
DESCRIPTION		DRWN	CHKD	APPD	DATE
REVISIONS					
DRAWN BY	WLW	CHECKED			
DATE	08-01-17	APPROVED			

**REQUEST TO VACATE TO EASEMENT
 THE NORTH/SOUTH PUBLIC ALLEY, 15 FT. WD.
 IN THE BLOCK BOUND BY
 PARKSIDE, MIDLAND, ALDEN AVE.
 AND JOHN C. LODGE FWY.**

CITY OF DETROIT	
CITY ENGINEERING DEPARTMENT	
SURVEY BUREAU	
JOB NO.	01-01
DRWG. NO.	X 1664