

**City of Detroit
City Engineering Division, Department of Public Works
Survey Bureau**

NOTICE OF PROPOSED CHANGE IN PROPERTY

Date: 07/24/2017

Petition: x1615

- | | |
|---|--|
| <input type="checkbox"/> AT&T Telecommunication | |
| <input type="checkbox"/> Comcast Television (CATV) | <input type="checkbox"/> Berm Use |
| <input type="checkbox"/> Detroit Edison (DTE) | |
| <input type="checkbox"/> Fire Department | <input type="checkbox"/> Dedication |
| <input type="checkbox"/> Great Lakes Water Authority | |
| <input type="checkbox"/> Land Bank Authority | <input type="checkbox"/> Encroachment |
| <input type="checkbox"/> Michcon (DTE) | |
| <input checked="" type="checkbox"/> Planning & Development Department | <input type="checkbox"/> Outright Vacation |
| <input type="checkbox"/> Public Lighting Authority | |
| <input type="checkbox"/> Public Lighting Department | <input type="checkbox"/> Temporary Closing |
| <input type="checkbox"/> Police Department | |
| <input type="checkbox"/> Solid Waste Division, DPW | <input checked="" type="checkbox"/> Vacate to Easement |
| <input type="checkbox"/> Street Design Bureau, DPW | |
| <input type="checkbox"/> Street Maintenance Division, DPW | |
| <input type="checkbox"/> Traffic Engineering Division, DPW | |
| <input type="checkbox"/> Water and Sewerage Department | |
| <input type="checkbox"/> _____ | |

A petition drawing is attached. Property shown on the attached print is proposed to be changed as indicated. Kindly report (using the back of this sheet) the nature of your services, if any affected by the proposed change and the estimated costs of removing and rerouting such services (if necessary).

Please return one copy to City Engineering Division, DPW within two weeks of the submittal date. Retain one copy and print for you file.

Ron Brundidge, Director, Department of Public Works

By: Richard Doherty, CED DPW
City Engineer

**TO: City Engineering Division, DPW
2 Woodward Ave., Suite 642
Detroit, Michigan 48226-3462
Survey Bureau: 313-224-3970**

Petition: x1615

The proposed change in property (referred to on the other side of this sheet) would affect our services as follows:

- Not Involved
- Involved; but asking you to hold action on this petition until further notice.
- Involved; but no objections to the property change.
Vacation to easement being requested to provide better access to parking for residents of St. Rita Apartments. The apartment is conditional in a B4 zoning district. P&DD staff would attend any hearings to establish a use associated with the alley.
- Involved; objection to the property change.
- Involved; but no objections to the property change...provided as easement of the full width of the public right-of-way (street, alley or other public place) is reserved.
- Involved; the nature of our services and the estimated costs of removing and/or rerouting such services are:

Planning and Development Department

(Utility or City Department)



By

Greg Moots-Lead Planner-Office of Zoning Innovation

Title

7/29/17

Date

313-224-1358

Area code – Telephone number

PETITION NO. 1615
 EARLY CONSTRUCTION
 P.O. BOX 839
 NORTHVILLE, MICHIGAN 48167
 C/O JOSEPH EARLY
 PHONE NO. 313 350-5662



WOODWARD AVE. 100 FT. WD.

LEICESTER CT. 60 FT. WD.

JOHN R. ST. 80 FT. WD.

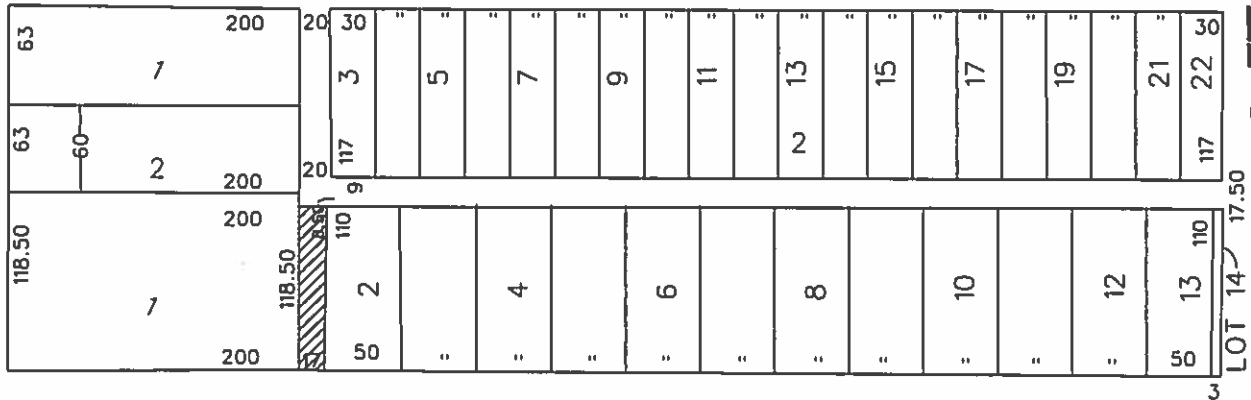

OWEN AVE. 60 FT. WD.



- VACATE TO EASEMENT

(FOR OFFICE USE ONLY)

CARTO 32 F

B				REQUEST TO VACATE TO EASEMENT THE SOUTH PORTION OF THE NORTH/SOUTH PUBLIC ALLEY, 17 FT. WD. IN THE BLOCK BOUND BY OWEN, WOODWARD AVE., LEICESTER CT. AND JOHN R. ST.				CITY OF DETROIT CITY ENGINEERING DEPARTMENT SURVEY BUREAU			
A								JOB NO. 01-01			
DESCRIPTION				DRWN	CHEK	APPD	DATE	DRWG. NO. X 1615			
DRAWN BY				REVISIONS							
DATE				CHECKED							
07-24-17				APPROVED							

