



CITY OF DETROIT
DEPARTMENT OF PUBLIC WORKS
CITY ENGINEERING DIVISION

COLEMAN A. YOUNG MUNICIPAL CENTER
2 WOODWARD AVE. SUITE 601
DETROIT, MICHIGAN 48226
PHONE: (313) 224-3949 • TTY: 711
FAX: (313) 224-3471
WWW.DETROITMI.GOV

March 3rd, 2020

Petitioner,

RE: Petition No. 1615

Petition No. 1615 of "Early Construction" whose address is P.O. Box 839, Northville, Michigan request to vacate and convert to easement the north-south segment of the public alley adjacent to the parcel known as 35 Owen Avenue.

The petition was referred to the City Engineering Division – DPW for investigation (utility review) and report. This is our report.

After reviewing the petitioner's request it was determined that the petitioner, Early Construction, has petitioned to vacate the north-south segment of the public alley adjacent to the parcel known as 35 Owen Avenue for the purpose of improving safety for the apartment building located at 35 Owen Avenue. At this time petitioner has not demonstrated any immediate need for the vacation to occur by way of development or land improvement. The petitioner has not demonstrated that all the required adjacent owners consent to the petition. It is the opinion of the City Engineering Division that the north-south segment of the public alley adjacent to the parcel known as 35 Owen Avenue remain accessible and open for public use.

The Department of Public Works, City Engineering Division denies this petition request. Please receive and file this report for you reference.

Respectfully submitted,

Richard Doherty, City Engineer
City Engineering Division – DPW

JMK/

Cc: Ron Brundidge, Director – DPW
Mayor's Office – City Council Liaison

PETITION NO. 1615
 EARLY CONSTRUCTION
 P.O. BOX 839
 NORTHVILLE, MICHIGAN 48167
 C/O JOSEPH EARLY
 PHONE NO. 313 350-5662



WOODWARD AVE. 100 FT. WD.

LEICESTER CT. 60 FT. WD.

JOHN R. ST. 80 FT. WD.

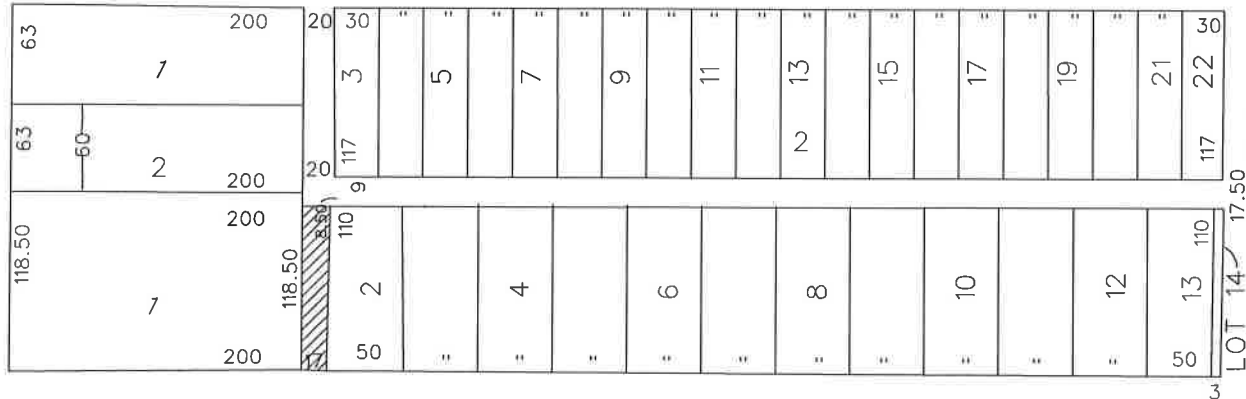

OWEN AVE. 60 FT. WD.



- VACATE TO EASEMENT

(FOR OFFICE USE ONLY)

CARTO 32 F

B					REQUEST TO VACATE TO EASEMENT THE SOUTH PORTION OF THE NORTH/SOUTH PUBLIC ALLEY, 17 FT. WD. IN THE BLOCK BOUND BY OWEN, WOODWARD AVE., LEICESTER CT. AND JOHN R. ST.	CITY OF DETROIT CITY ENGINEERING DEPARTMENT SURVEY BUREAU
	A					
DESCRIPTION		DRWN	CHKD	APPD	DATE	JOB NO. 01-01
DRAWN BY		REVISIONS				DRWG. NO. X 1615
DATE		CHECKED		APPROVED		
07-24-17						