

TO: City Engineering Division, DPW
900 Cadillac Tower Building
65 Cadillac Square
Detroit, Michigan 48226-2873
Survey Bureau: 313-224-3970
Fax: 313-224-3471

Ref. No. 201706027
Petition No. 1554

The proposed change in property (referred to above) would affect our services as follows:

- ☐ Not Involved.
- ☐ Involved; but asking you to hold action on this petition until further notice.
- ☐ Involved; the nature of our services, and the estimated costs of removing and/or rerouting such services are:
- ☒ Involved; have no objection to request to outright vacate the east/west and north/south public alley various widths in the block bound by Bethune, Lothrop, Woodward Ave. and Second Blvd. as shown on drawing no. x1554 dated 06/28/2017 provided that 100% signatures of abutting property owners are secured.

Traffic Engineering Division - DPW
(Utility or City Department)

Ashok Patel
By



City Traffic Engineer
Title

September 11, 2017
Date

313 224-1610
Area code-Telephone number

JL/jl

NORTH
BASED ON CITY OF DETROIT
COORDINATE SYSTEM

WOODWARD AVE. 100 FT. WD.

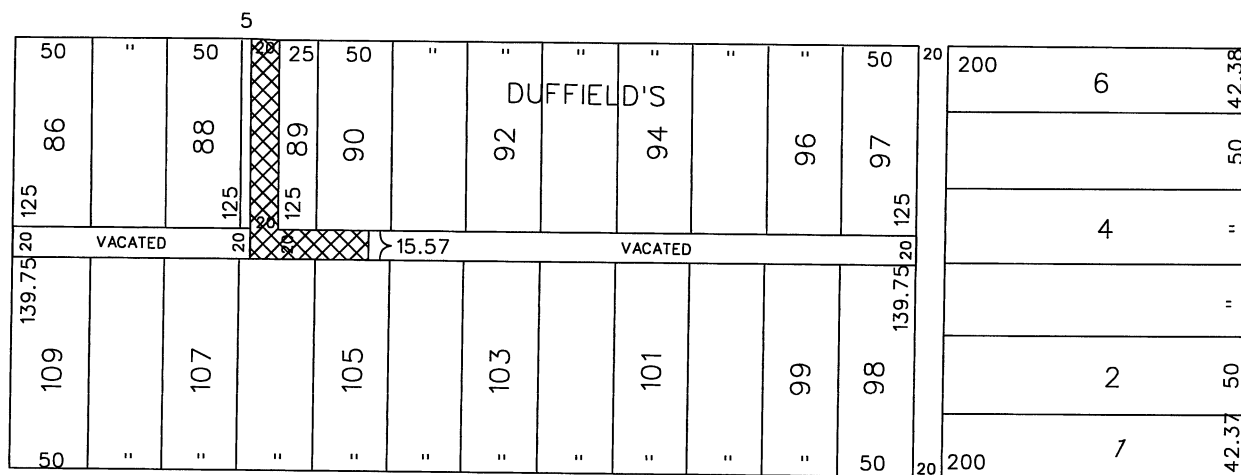

LOTHROP AVE. 80 FT. WD.



- OUTRIGHT VACATION

(FOR OFFICE USE ONLY)

CARTO 31 B

B						<p align="center">REQUEST TO OUTRIGHT VACATE THE EAST/WEST AND NORTH/SOUTH PUBLIC ALLEYS VARIOUS WIDTHS IN THE BLOCK BOUND BY BETHUNE, LOTHROP, WOODWARD AVE. AND SECOND BLVD.</p>	CITY OF DETROIT CITY ENGINEERING DEPARTMENT SURVEY BUREAU		
A							JOB NO.	01-01	
DESCRIPTION		DRWN	CHKD	APPD	DATE				
REVISIONS									
DRAWN BY	WLW		CHECKED						
DATE	06-28-17		APPROVED				DRWG.NO. X 1554		



April 24, 2017

HAND DELIVER

**Honorable Detroit City Council
C/o Detroit City Clerk
2 Woodward Avenue
200 Coleman A. Young Municipal Center
Detroit, Michigan 48226**

RE: Request for outright vacation of the alley bounded by Second Avenue, Bethune Street, Woodward Avenue, and Lothrop Avenue.

Giffels Webster, 28 W. Adams, Suite 1200, Detroit, Michigan 48226 on behalf of Baltimore Station LLC, 3011 W. Grand Boulevard, Suite 2300, Detroit, Michigan 48202, respectfully requests that the City of Detroit outright vacate the 20-foot-wide alley within the block of Second Avenue (80 feet wide), Bethune Street (60 feet wide), Woodward Avenue (120 feet wide), and Lothrop Avenue (80 feet wide). Limits of the vacations can be found in the attachment, enclosed herein.

The vacated alley and adjacent parcel will be converted to parking and loading for the Albert Kahn Building.

Giffels Webster has been asked to facilitate the requested vacation. We will be working with the City of Detroit's Department of Public Works – City Engineering Division, utilities, and stakeholders to achieve a vacation that is satisfactory to all interested parties. Relocation of the combined sewer and water mains within the existing alley will be completed at the expense of the project, and DWSD will be engaged in the coordination of these relocations.

If you should have any questions, please do not hesitate to contact me by phone, at 313.962.4442, or by email, at tdemarco@giffelswebster.com.

Respectfully,

Tricia DeMarco, PE, AICP, LEED AP
Project Manager
Giffels Webster

FD1847 04/25/17