

Janice M. Winfrey  
City Clerk

City of Detroit  
OFFICE OF THE CITY CLERK

Victor A. Hudson  
Deputy City Clerk

**DEPARTMENTAL REFERENCE COMMUNICATION**

Friday, February 24, 2017

To: *The Department or Commission Listed Below*

From: *Janice M. Winfrey, Detroit City Clerk*

---

The following petition is herewith referred to you for report and recommendation to the City Council.

In accordance with that body's directive, kindly return the same with your report in duplicate within four (4) weeks.

---

PLANNING AND DEVELOPMENT DEPARTMENT    DPW - CITY ENGINEERING DIVISION

**1446**    *The Albert in Capitol Park, request to encroach an area located at Griswold Street in order to install bike racks.*

3/16/17 - EMAILED MR. GORDON ADDITIONAL MEASUREMENTS THAT IS NEEDED IN ORDER TO FINISH HIS DRAWING FOR SUBMITTAL.

February 6, 2017



The Honorable City Council  
Attn: Office Of The City Clerk  
200 Coleman A. Young Municipal Center  
Detroit, MI 48226

**RE: The Albert in Capitol Park – Bike Rack**

Dear Honorable City Council,

Thank you very much for your consideration of our encroachment request. We very much look forward to your response.

**Property:** The Albert in Capitol Park 1214 Griswold, Detroit, MI 48226  
**Contact:** Max Gordon, Broder & Sachse Real Estate  
**Address:** 260 East Brown Street, Suite 280, Birmingham, MI 48009  
**Phone:** (d) 248-554-6821 (c) 248-804-7732  
**Email:** mgordon@brodersachse.com

**Who:** The Albert in Capitol Park.  
**What:** A bike rack that is approximately 9' wide, 3'-6" long, and 3'-4" tall.  
**Where:** Please see enclosed plan for requested location.  
**When:** As soon as possible.  
**Why:** There is no secure place for visitors of the new retail tenants at The Albert to park their bikes. A well designed bike rack provided by Detroit Bikes (a retailer at The Albert) that is bolted to the sidewalk in the requested location would make all retailers in Capitol Park more accessible to those who wish to bike to visit the shops. The presence of a bike rack will de-clutter the sidewalk from bikes that are often otherwise left leaning against the building or parked in the sidewalk area.

Thank you very much for your consideration. Please contact me with any questions or for more information.

Best regards,

Broder & Sachse Real Estate  
As Agent For 1214 Griswold Apartments, LLC

*Max Gordon*

Max Gordon  
Property Manager

2017 FEB 15 A 8 51

DETROIT CITY CLERK

OFFICE OF THE

Property Management Acquisitions Development  
260 East Brown Street | Suite 280 | Birmingham, MI 48009  
P: 248.647.4100 | Fax: 248.647.4180

BroderSachse.com

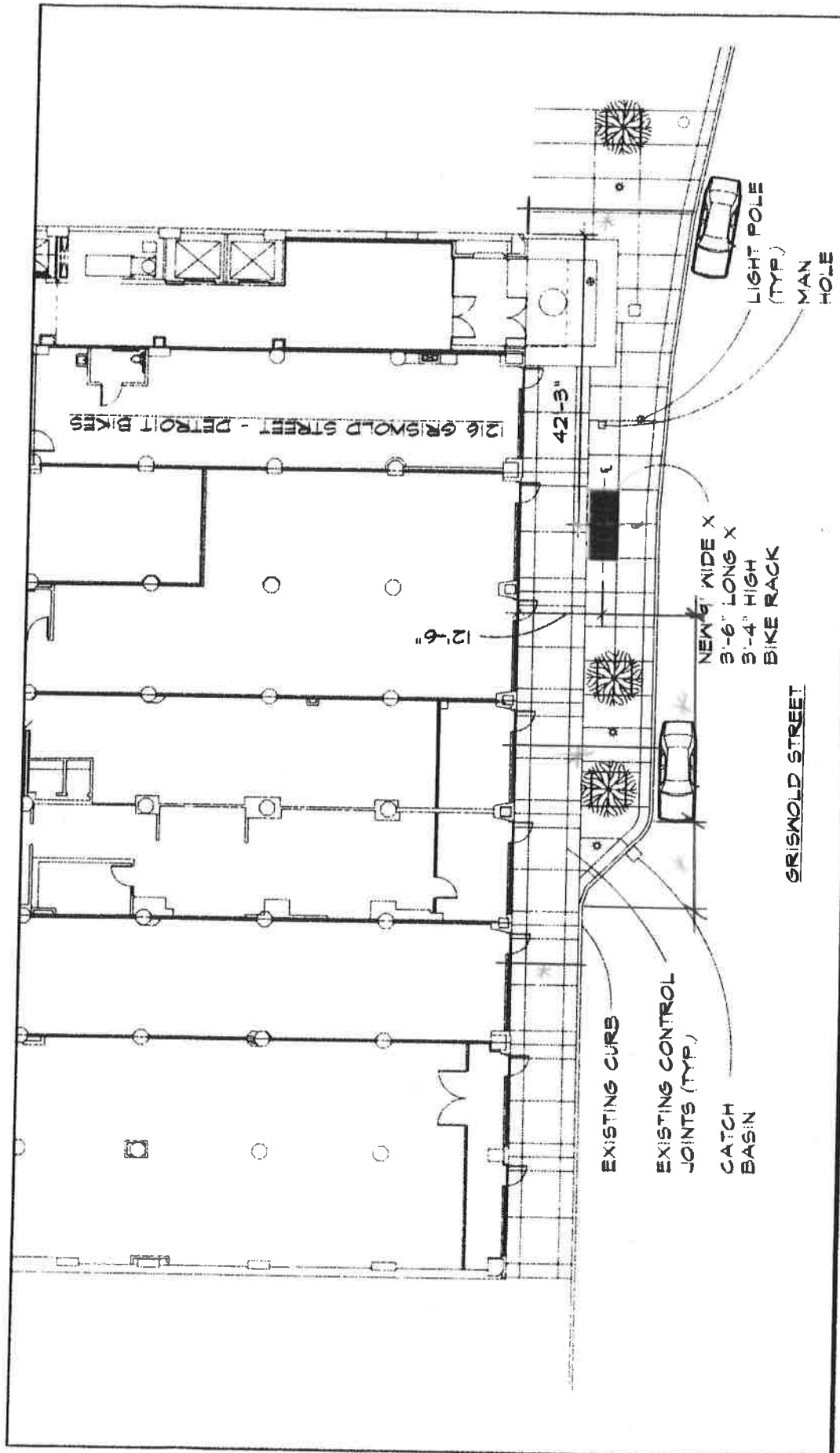

**PROPOSED BIKE RACK LOCATION**

ALBERT BUILDING  
 1214 GRISWOLD STREET  
 1" = 20'-0"  
 2-7-17

**STREET PLAN**

PREPARED FOR  
 BRODER & SACHSE REAL ESTATE SERVICES, INC.



17-00-048

2017-02-24

1446

1446 *Petition of The Albert in Capitol Park, request to encroach an area located at Griswold Street in order to install bike racks.*

**REFERRED TO THE FOLLOWING DEPARTMENT(S)**

PLANNING AND DEVELOPMENT DEPARTMENT DPW.  
CITY ENGINEERING DIVISION