

City of Detroit
City Engineering Division, Department of Public Works
Survey Bureau

NOTICE OF PROPOSED CHANGE IN PROPERTY

Date: 03/28/2017

Petition: x1444

- | | |
|---|--|
| <input type="checkbox"/> AT&T Telecommunication | |
| <input type="checkbox"/> Comcast Television (CATV) | <input type="checkbox"/> Berm Use |
| <input type="checkbox"/> Detroit Edison (DTE) | |
| <input type="checkbox"/> Fire Department | <input type="checkbox"/> Conversion to Easement |
| <input type="checkbox"/> Great Lakes Water Authority | |
| <input type="checkbox"/> Land Bank Authority | <input type="checkbox"/> Dedication |
| <input type="checkbox"/> Michcon (DTE) | |
| <input checked="" type="checkbox"/> Planning & Development Department | <input checked="" type="checkbox"/> Encroachment |
| <input type="checkbox"/> Public Lighting Authority | |
| <input type="checkbox"/> Public Lighting Department | <input type="checkbox"/> Temporary Closing |
| <input type="checkbox"/> Police Department | |
| <input type="checkbox"/> Solid Waste Division, DPW | <input checked="" type="checkbox"/> Vacation |
| <input type="checkbox"/> Street Design Bureau, DPW | |
| <input type="checkbox"/> Street Maintenance Division, DPW | |
| <input type="checkbox"/> Traffic Engineering Division, DPW | |
| <input type="checkbox"/> Water and Sewerage Department | |
| <input type="checkbox"/> _____ | |

A petition drawing is attached. Property shown on the attached print is proposed to be changed as indicated. Kindly report (using the back of this sheet) the nature of your services, if any affected by the proposed change and the estimated costs of removing and rerouting such services (if necessary).

Please return one copy to City Engineering Division, DPW within two weeks of the submittal date. Retain one copy and print for you file.

Ron Brundidge, Director, Department of Public Works

By: Richard Doherty, CED DPW
City Engineer

**TO: City Engineering Division, DPW
2 Woodward Ave., Suite 642
Detroit, Michigan 48226-3462
Survey Bureau: 313-224-3970**

Petition: x1444

The proposed change in property (referred to on the other side of this sheet) would affect our services as follows:

- ☒ Not Involved
Encroachment and Vacation within The District. Encroachment along Clifford requested for DTE Power placement. Vacation on Park for pedestrian promenade.
- ☐ Involved; but asking you to hold action on this petition until further notice.
- ☐ Involved; but no objections to the property change.
- ☐ Involved; objection to the property change.
- ☐ Involved; but no objections to the property change...provided as easement of the full width of the public right-of-way (street, alley or other public place) is reserved.
- ☐ Involved; the nature of our services and the estimated costs of removing and/or rerouting such services are:

Planning and Development Department
(Utility or City Department)

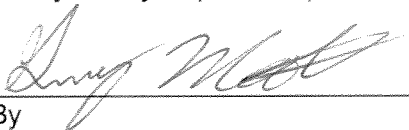
By 

Greg Moots-Lead Planner-Office of Zoning Innovation
Title

4-20-17
Date

313-224-1358
Area code – Telephone number

PETITION NO. 1444
 GIFFELS WEBSTER
 28 W. ADAMS, SUITE 1200
 DETROIT, MICHIGAN 48226
 C/O BRIAN ELLISON
 PHONE NO. 313 397-5863

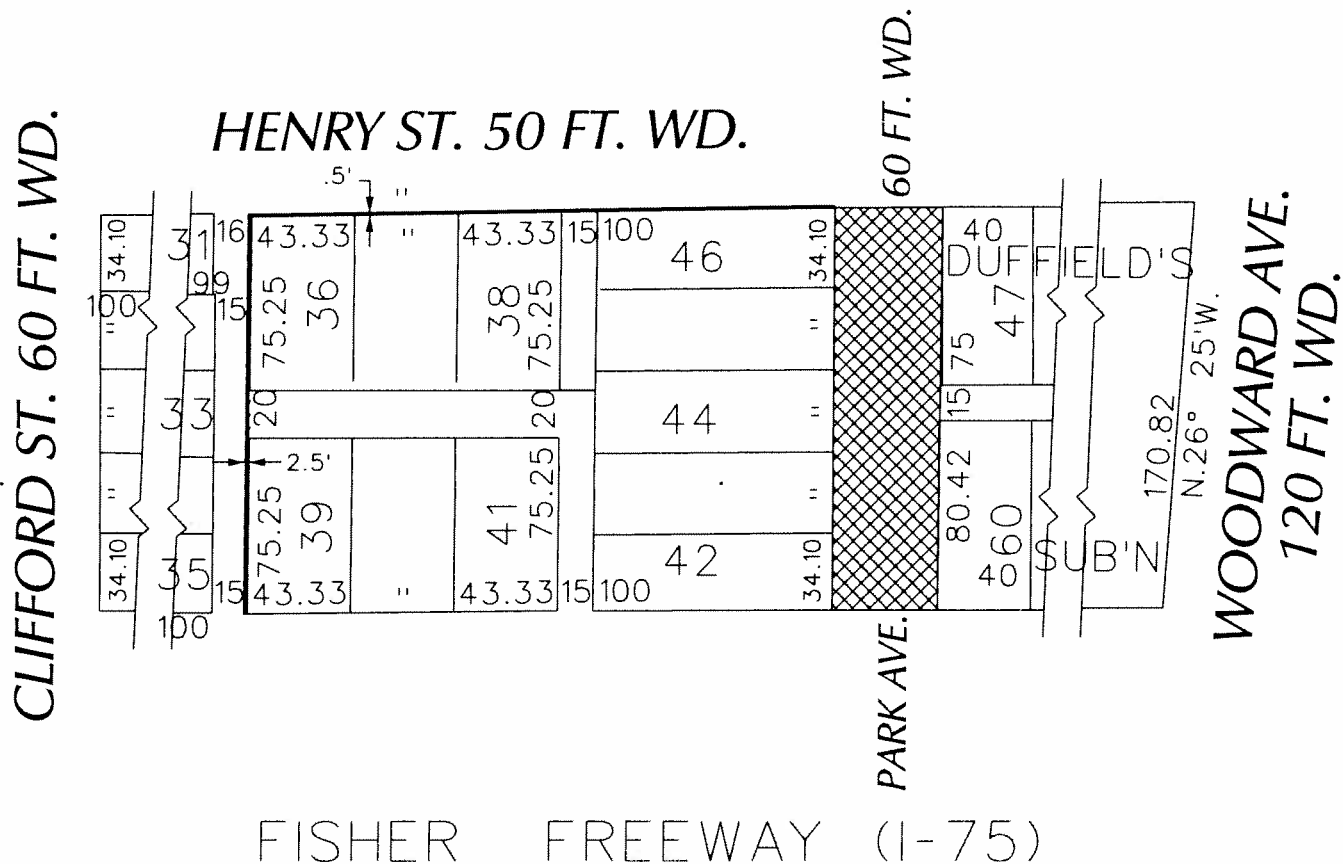

- REQUEST ENCROACHMENT

- OUTRIGHT VACATION

(FOR OFFICE USE ONLY)

CARTO 29 E

B										REQUEST ENCROACHMENT (Sub-Surface) A PORTION OF THE NORTH/SOUTH PUBLIC ALLEY 15 FT. WD. A PORTION OF THE HENRY ST. 50 FT. WD. OUTRIGHT VACATION PARK AVE., 60 FT. WD. IN THE AREA BOUND BY CLIFFORD AND HENRY ST., WOODWARD AVE. AND FISHER FWY. SERVICE DR.		CITY OF DETROIT CITY ENGINEERING DEPARTMENT SURVEY BUREAU	
A												JOB NO. 01-01	
DESCRIPTION		DRWN	CHKD	APPD	DATE	REVISIONS						DRWG. NO. X 1444	
DRAWN BY WLW		CHECKED				DATE 03-28-17		APPROVED					

