

City of Detroit
**City Engineering Division, Department of Public Works
Survey Bureau**

NOTICE OF PROPOSED CHANGE IN PROPERTY

Date: 03/28/2017

Petition: x1432

- | | |
|---|--|
| <input type="checkbox"/> AT&T Telecommunication | <input type="checkbox"/> Berm Use |
| <input type="checkbox"/> Comcast Television (CATV) | <input checked="" type="checkbox"/> Conversion to Easement |
| <input type="checkbox"/> Detroit Edison (DTE) | <input type="checkbox"/> Dedication |
| <input type="checkbox"/> Fire Department | <input type="checkbox"/> Encroachment |
| <input type="checkbox"/> Great Lakes Water Authority | <input type="checkbox"/> Temporary Closing |
| <input type="checkbox"/> Land Bank Authority | <input type="checkbox"/> Vacation |
| <input type="checkbox"/> Michcon (DTE) | |
| <input checked="" type="checkbox"/> Planning & Development Department | |
| <input type="checkbox"/> Public Lighting Authority | |
| <input type="checkbox"/> Public Lighting Department | |
| <input type="checkbox"/> Police Department | |
| <input type="checkbox"/> Solid Waste Division, DPW | |
| <input type="checkbox"/> Street Design Bureau, DPW | |
| <input type="checkbox"/> Street Maintenance Division, DPW | |
| <input type="checkbox"/> Traffic Engineering Division, DPW | |
| <input type="checkbox"/> Water and Sewerage Department | |
| <input type="checkbox"/> _____ | |

A petition drawing is attached. Property shown on the attached print is proposed to be changed as indicated. Kindly report (using the back of this sheet) the nature of your services, if any affected by the proposed change and the estimated costs of removing and rerouting such services (if necessary).

Please return one copy to City Engineering Division, DPW within two weeks of the submittal date. Retain one copy and print for you file.

Ron Brundidge, Director, Department of Public Works

By: Richard Doherty, CED DPW
City Engineer

**TO: City Engineering Division, DPW
2 Woodward Ave., Suite 642
Detroit, Michigan 48226-3462
Survey Bureau: 313-224-3970**

Petition: x1432

The proposed change in property (referred to on the other side of this sheet) would affect our services as follows:

- Not Involved

- Involved; but asking you to hold action on this petition until further notice.

- Involved; but no objections to the property change.
Applicant is requesting conversion to easement in order to conform to the request of Olympia Development for the District. The main objective is to vacate Henry all the way to Clifford, and Clifford to the service drive maintaining and preserving pedestrian access.
- Involved; objection to the property change.

- Involved; but no objections to the property change...provided as easement of the full width of the public right-of-way (street, alley or other public place) is reserved.

- Involved; the nature of our services and the estimated costs of removing and/or rerouting such services are:

Planning and Development Department
(Utility or City Department)



By

Greg Moots-Lead Planner-Office of Zoning Innovation
Title

4-20-17
Date

313-224-1358
Area code – Telephone number

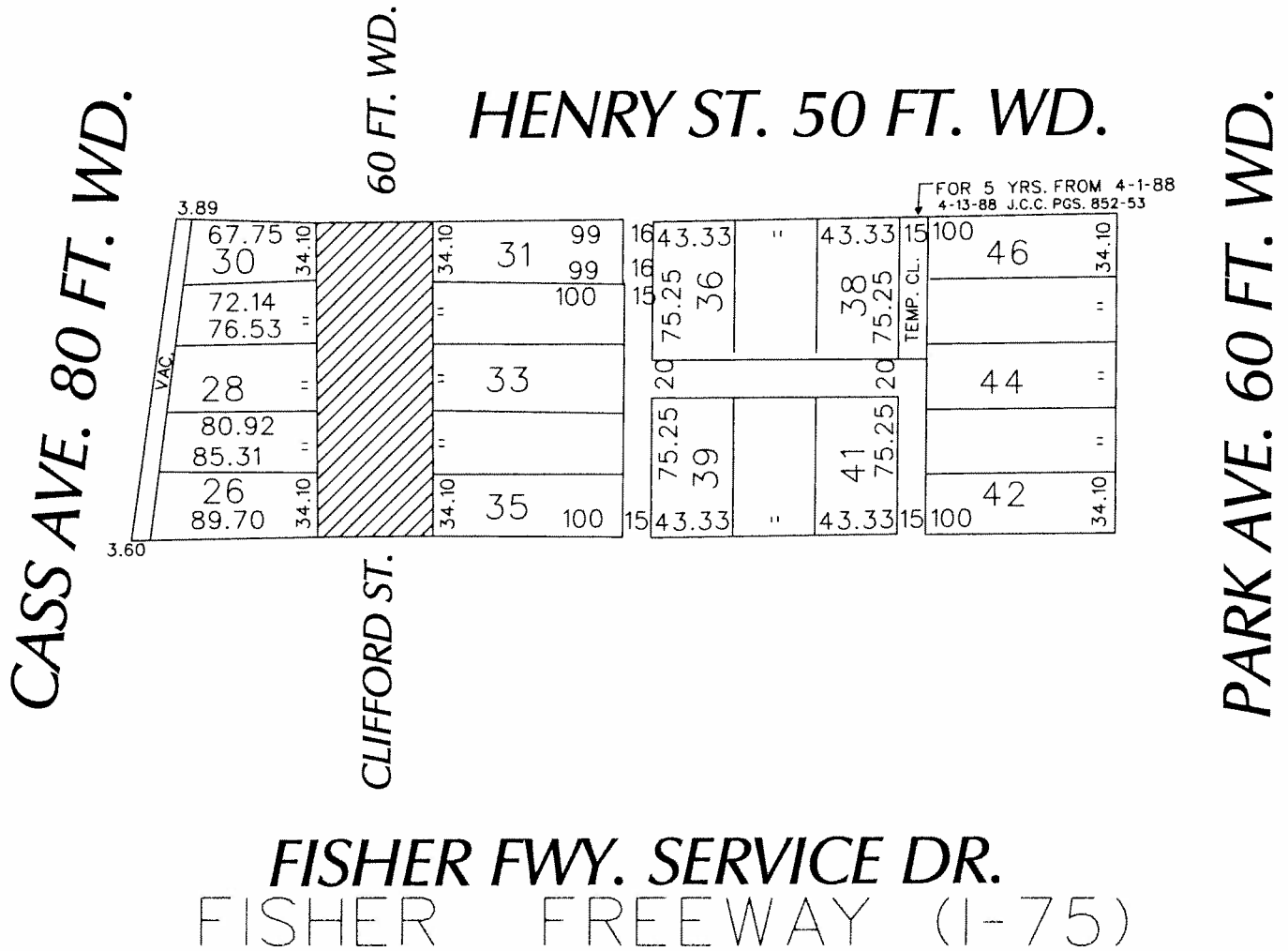
PETITION NO. 1432
 HARRY'S DETROIT BAR
 C/O DYKEMA GOSSETT PLLC
 2482 CLIFFORD ST.
 DETROIT, MICHIGAN 48201
 C/O CARL GOSSETT
 PHONE NO. 313 568-5422



FISHER FWY. SERVICE DR.
 FISHER FREEWAY (I-75)



- REQUESTED CONVERSION TO EASEMENT

(FOR OFFICE USE ONLY)

CARTO 29 E

| | | | | | | | | |
|-------------|--|-----------|------|------|------|--|--|--|
| B | | | | | | REQUEST TO CONVERT TO EASEMENT CLIFFORD AVE. 60 FT. WD. IN THE AREA BOUND BY CASS, PARK AVE., HENRY ST. AND FISHER FWY. SERVICE DR. | CITY OF DETROIT CITY ENGINEERING DEPARTMENT SURVEY BUREAU | |
| A | | | | | | | JOB NO. 01-01 | |
| DESCRIPTION | | DRWN | CHKD | APPD | DATE | | DRWG. NO. X 1432 | |
| DRAWN BY | | REVISIONS | | | | | | |
| DATE | | CHECKED | | | | | | |
| 03-28-17 | | APPROVED | | | | | | |