

TO: City Engineering Division, DPW  
2 Woodward Ave., Suite 642  
Detroit, Michigan 48226-3462  
Survey Bureau: 313-224-3970

Petition: x1432

The proposed change in property (referred to on the other side of this sheet) would affect our services as follows:

- Not Involved
- Involved; but asking you to hold action on this petition until further notice.
- Involved; but no objections to the property change.
- Involved; objection to the property change."
- Involved; but no objections to the property change...provided as easement of the full width of the public right-of-way (street, alley or other public place) is reserved.
- Involved; the nature of our services and the estimated costs of removing and/or rerouting such services are:

DETROIT POLICE DEPT 3RD PCT  
(Utility or City Department)

CHRIS GIBSON 4649  
By

POLICE OFFICER CODE ENFORCEMENT  
Title

3-30-2017  
Date

313 596-1310, 596-1363  
Area code - Telephone number

Captain Donn Szilagyi

A P P R O V E D  
MAY 1 2017  
THIRD PRECINCT



PETITION NO. 1432  
 HARRY'S DETROIT BAR  
 C/O DYKEMA GOSSETT PLLC  
 2482 CLIFFORD ST.  
 DETROIT, MICHIGAN 48201  
 C/O CARL GOSSETT  
 PHONE NO. 313 568-5422

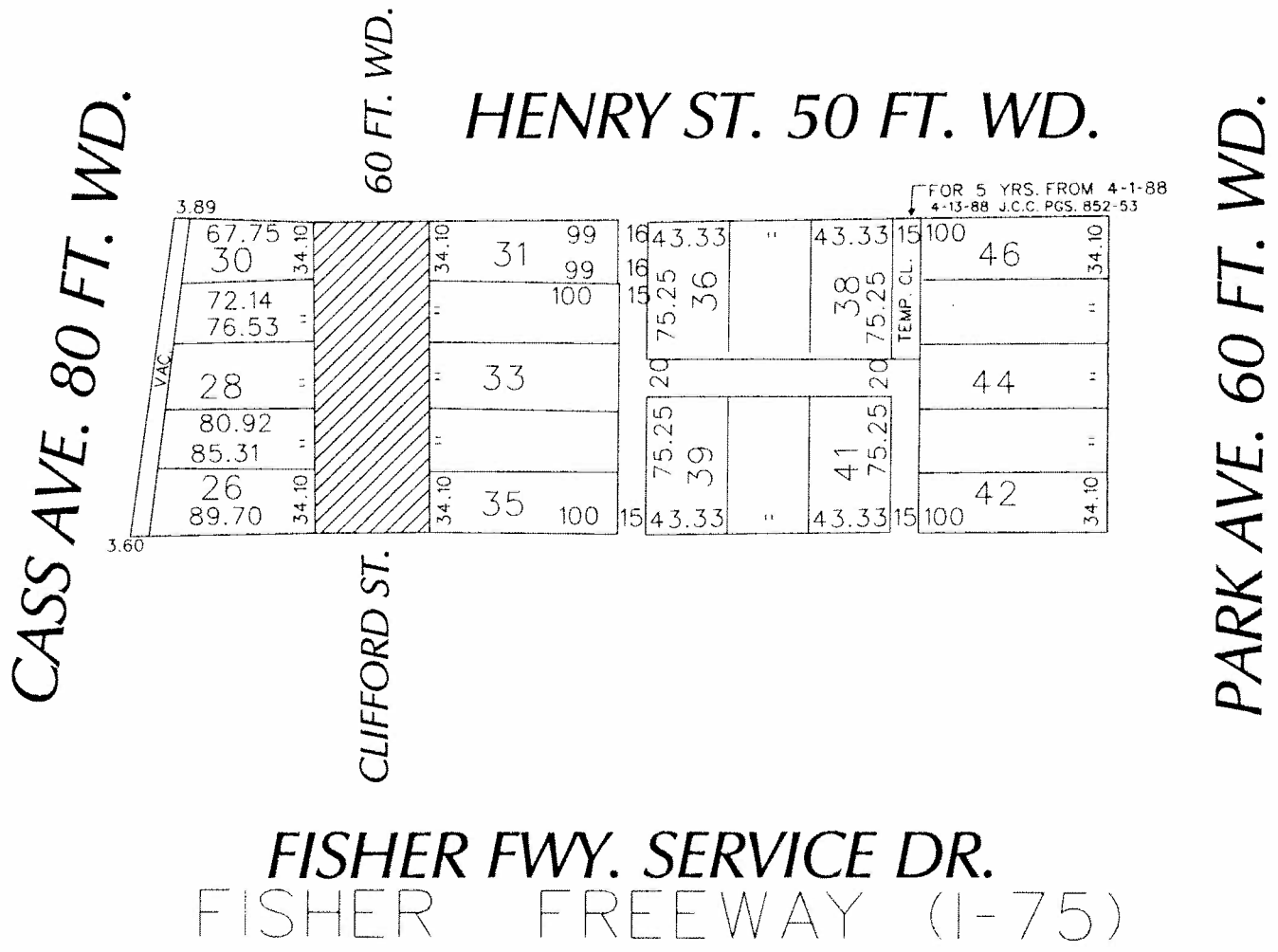

- REQUESTED CONVERSION TO EASEMENT

(FOR OFFICE USE ONLY)

CARTO 29 E

B						<b>REQUEST TO CONVERT TO EASEMENT</b> <b>CLIFFORD AVE. 60 FT. WD.</b> <b>IN THE AREA BOUND BY</b> <b>CASS, PARK AVE., HENRY ST.</b> <b>AND FISHER FWY. SERVICE DR.</b>	<b>CITY OF DETROIT</b> CITY ENGINEERING DEPARTMENT SURVEY BUREAU
A							JOB NO. 01-01
DESCRIPTION		DRWN	CHKD	APPD	DATE		DRWG. NO. X 1432
DRAWN BY		REVISIONS					
DATE		CHECKED					
03-28-17		APPROVED					



City of Detroit  
**City Engineering Division, Department of Public Works  
Survey Bureau**

NOTICE OF PROPOSED CHANGE IN PROPERTY

Date: 03/28/2017

Petition: x1432

- |  |  |
|--|--|
| <input type="checkbox"/> AT&T Telecommunication            | <input type="checkbox"/> Berm Use                          |
| <input type="checkbox"/> Comcast Television (CATV)         | <input checked="" type="checkbox"/> Conversion to Easement |
| <input type="checkbox"/> Detroit Edison (DTE)              | <input type="checkbox"/> Dedication                        |
| <input type="checkbox"/> Fire Department                   | <input type="checkbox"/> Encroachment                      |
| <input type="checkbox"/> Great Lakes Water Authority       | <input type="checkbox"/> Temporary Closing                 |
| <input type="checkbox"/> Land Bank Authority               | <input type="checkbox"/> Vacation                          |
| <input type="checkbox"/> Michcon (DTE)                     |  |
| <input type="checkbox"/> Planning & Development Department |  |
| <input type="checkbox"/> Public Lighting Authority         |  |
| <input type="checkbox"/> Public Lighting Department        |  |
| <input checked="" type="checkbox"/> Police Department      |  |
| <input type="checkbox"/> Solid Waste Division, DPW         |  |
| <input type="checkbox"/> Street Design Bureau, DPW         |  |
| <input type="checkbox"/> Street Maintenance Division, DPW  |  |
| <input type="checkbox"/> Traffic Engineering Division, DPW |  |
| <input type="checkbox"/> Water and Sewerage Department     |  |
| <input type="checkbox"/> _____                             |  |

A petition drawing is attached. Property shown on the attached print is proposed to be changed as indicated. Kindly report (using the back of this sheet) the nature of your services, if any affected by the proposed change and the estimated costs of removing and rerouting such services (if necessary).

Please return one copy to City Engineering Division, DPW within two weeks of the submittal date. Retain one copy and print for you file.

Ron Brundidge, Director, Department of Public Works

By: Richard Doherty, CED DPW  
City Engineer

