

City of Detroit  
**City Engineering Division, Department of Public Works**  
**Survey Bureau**

4th Notice 7/6/16  
3rd Notice 6/1/16  
2nd Notice 4/26/16

**NOTICE OF PROPOSED CHANGE IN PROPERTY**

**Date:** 02/26/2016

**Petition:** x980

- |  |  |
|--|--|
| <input type="checkbox"/> AT&T Telecommunication            | <input type="checkbox"/> Berm Use                |
| <input type="checkbox"/> Comcast Television (CATV)         | <input type="checkbox"/> Conversion to Easement  |
| <input type="checkbox"/> Detroit Edison (DTE)              | <input type="checkbox"/> Dedication              |
| <input checked="" type="checkbox"/> Fire Department        | <input checked="" type="checkbox"/> Encroachment |
| <input type="checkbox"/> Michcon (DTE)                     | <input type="checkbox"/> Temporary Closing       |
| <input type="checkbox"/> Planning & Development Department | <input type="checkbox"/> Vacation                |
| <input type="checkbox"/> Public Lighting Authority         |  |
| <input type="checkbox"/> Public Lighting Department        |  |
| <input type="checkbox"/> Police Department                 |  |
| <input type="checkbox"/> Recreation Department             |  |
| <input type="checkbox"/> Solid Waste Division, DPW         |  |
| <input type="checkbox"/> Street Design Bureau, DPW         |  |
| <input type="checkbox"/> Street Maintenance Division, DPW  |  |
| <input type="checkbox"/> Traffic Engineering Division, DPW |  |
| <input type="checkbox"/> Water and Sewerage Department     |  |
| <input type="checkbox"/> _____                             |  |

A petition drawing is attached. Property shown on the attached print is proposed to be changed as indicated. Kindly report (using the back of this sheet) the nature of your services, if any affected by the proposed change and the estimated costs of removing and rerouting such services (if necessary).

Please return one copy to City Engineering Division, DPW within two weeks of the submittal date. Retain one copy and print for you file.

Ron Brundidge, Director, Department of Public Works

By: Richard Doherty, CED DPW  
City Engineer

TO: City Engineering Division, DPW  
2 Woodward Ave., Suite 642  
Detroit, Michigan 48226-3462  
Survey Bureau: 313-224-3970

Petition: x980

The proposed change in property (referred to on the other side of this sheet) would affect our services as follows:

- Not Involved
- Involved; but asking you to hold action on this petition until further notice.
- Involved; but no objections to the property change.
- Involved; but no objections to the property change...provided as easement of the full width of the public right-of-way (street, alley or other public place) is reserved.
- Involved; the nature of our services and the estimated costs of removing and/or rerouting such services are:

Final

\_\_\_\_\_  
(Utility or City Department)

Luigi Gburek

By

Chief

\_\_\_\_\_  
Title

7-8-16

\_\_\_\_\_  
Date

313-224-1311

\_\_\_\_\_  
Area code - Telephone number

PETITION NO. 980  
 GIFFELS WEBSTER  
 28 W. ADAMS AVE., SUITE 1200  
 DETROIT, MICHIGAN 48226  
 C/O DEIRDRE CLEIN  
 PHONE NO. 313 962-4442

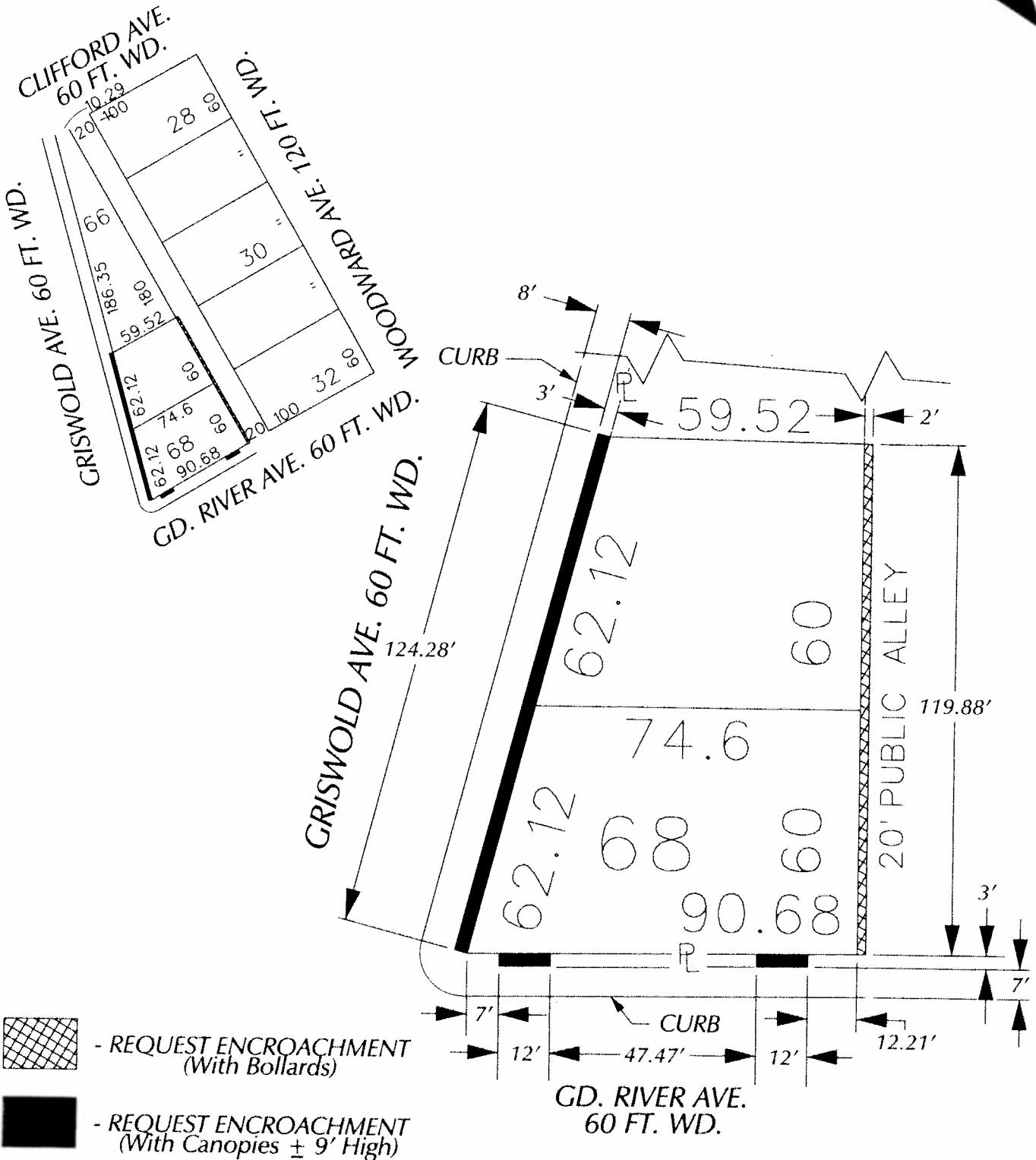

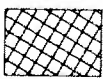
 - REQUEST ENCROACHMENT  
 (With Bollards)

 - REQUEST ENCROACHMENT  
 (With Canopies ± 9' High)

(FOR OFFICE USE ONLY)

CARTO 28 B

B					
A					
DESCRIPTION		DRWN	CHKD	APPD	DATE
REVISIONS					
DRAWN BY		CHECKED			
DATE		APPROVED			
02-25-16					

REQUEST ENCROACHMENT  
 INTO GRISWOLD AND GD. RIVER AVE.  
 AT 28 W. GD. RIVER AVE.  
 (With Canopies)  
 AND A PORTION OF THE NORTH/SOUTH PUBLIC ALLEY  
 (With Bollards)  
 BETWEEN GD. RIVER AND CLIFFORD AVE.

CITY OF DETROIT	
CITY ENGINEERING DEPARTMENT	
SURVEY BUREAU	
JOB NO.	01-01
DRWG. NO.	X 980